

15-137-00670-00-00

STATE OF KANSAS  
STATE CORPORATION COMMISSION  
130 South Market, Room 2078  
Wichita, KS 67202

WELL PLUGGING RECORD  
K.A.R.-82-3-117

API NUMBER Drilled Sept., 1953

LEASE NAME Lawson "B"

TYPE OR PRINT  
NOTICE: Fill out completely  
and return to Cons. Div.  
office within 60 days.

WELL NUMBER #1

2310 Ft. from S Section Line  
2310 Ft. from W Section Line

LEASE OPERATOR John O. Farmer, Inc.

SEC. 36 TWP. 3S RGE. 24 XXXXXX (W)

ADDRESS P.O. Box 352, Russell, KS 67665

COUNTY Norton

PHONE# (913) 483-3144 OPERATORS LICENSE NO. 5135

Date Well Completed 9-9-53

Character of Well Oil  
(Oil, Gas, D&A, SWD, Input, Water Supply Well)

Plugging Commenced 10:45 A.M., 4-1-96

Plugging Completed 1:00 P.M., 4-1-96

The plugging proposal was approved on March 20, 1996 (date)  
by District #4 Office (Carl Goodrow witnessed plugging) (KCC District Agent's Name).

Is ACO-1 filed? No If not, is well log attached? (submitted w/CP-1 form)

Producing Formation Arbuckle Depth to Top 3773' Bottom 3775' T.D. 3775'

Show depth and thickness of all water, oil and gas formations.

OIL, GAS OR WATER RECORDS | CASING RECORD

Formation	Content	From	To	Size	Put in	Pulled out
				8-5/8"	290'	-0-
Arbuckle	oil/water	3773'	3775'	7"	3773'	-0-

Describe in detail the manner in which the well was plugged, indicating where the mud fluid was placed and the method or methods used in introducing it into the hole. If cement or other plugs were used, state the character of same and depth placed, from      feet to      feet each set.

The casing was perforated 2 shots @ 2350' and 2 shots @ 1300' prior to plugging. Spotted 100 sks. 60-40 Pozmix, 10% gel, 1/4# flocele, and 200# hulls @ 2076'. Pulled the tubing to 1301' and spotted 120 sks. 60-40 Pozmix, 10% gel, 1/4# flocele, and 200# hulls. Pumped 50 sks. 60-40 Pozmix, 10% gel, 1/4# flocele, and 100# hulls down the backside. Topped off the casing w/70 sks. 60-40 Pozmix, 10% gel, 1/4# flocele.

(If additional description is necessary, use BACK of this form.)

Name of Plugging Contractor Allied Cementing Company, Inc. License No.                     

Address P.O. Box 31, Russell, KS 67665

NAME OF PARTY RESPONSIBLE FOR PLUGGING FEES: John O. Farmer, Inc.

STATE OF Kansas COUNTY OF Russell, ss.

John O. Farmer III XXXXXXXXXXXXXXXXXXXXXXXXXXXX (Operator) of above-described well, being first duly sworn on oath, says: That I have knowledge of the facts, statements, and matters herein contained and the log of the above-described well as filed that the same are true and correct, so help me God.

(Signature) John O. Farmer III

(Address) P.O. Box 352, Russell, KS 67665

RECEIVED  
KANSAS CORPORATION COMMISSION

APR 08 1996  
4-8-96  
CONSERVATION DIVISION  
WICHITA, KS

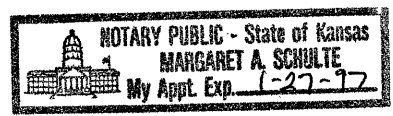

Margaret A. Schulte  
Notary Public  
Margaret A. Schulte

SUBSCRIBED AND SWORN TO before me this 4th day of April, 19 96

OPERATOR Benson-Montin  
ADDRESS Oklahoma City, Oklahoma

FORMATION RECORD

Give detailed description and thickness of all formations drilled through, contents of sand, whether dry, water, oil or gas.

FARM NAME Lawson SECTION 36 TWP 3 RGE 24 COUNTY Norton WELL NO. 1

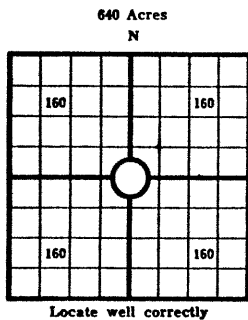

COUNTY Norton, SEC 36, TWP 3, RGE 24  
COMPANY OPERATING Benson-Montin  
OFFICE ADDRESS Oklahoma City, Oklahoma  
FARM NAME Lawson WELL NO. 1  
DRILLING STARTED 9-1, 1953 DRILLING FINISHED 9-9, 1953  
DATE OF FIRST PRODUCTION..... COMPLETED.....  
WELL LOCATED NE 1/4 NE 1/4 SW 1/4, North of South Line and..... ft. East of West Line of Quarter Section  
Elevation (Relative to sea level) DERRICK FLOOR 2458 GROUND.....  
CHARACTER OF WELL (Oil, gas or dryhole) Oil

Formation	Top	Bottom	Formation	Top	Bottom
Shale					
Shale & shells	286	890			
Shale & sand & shells	890	1590			
Shale-lime-shells	1590	1925			
Shale & shells	1925	2037			
Anhydrite	2037	2070			
Shale & shells	2070	2335			
Shale-lime-shells	2335	2425			
Shale & shells	2425	2750			
Shale & lime	2750	3105			
Lime & shale	3105	3515			
Lime	3515	3565			
Lime & shale	3565	3772			
Arbuckle	3772	3775			

RECEIVED KANSAS CORP  
MAR 20 A 11:40

3-20-96

15-137-00670-00-00

Name	From	To	Name	From	To
1			4		
2			5		
3			6		

Formation	From	To	No. of Shots	Formation	From	To	Size of Shot

Amount Set								Amount Pulled			Packer Record	
Size	Wt.	Thds.	Make	Ft.	In.	Ft.	In.	Size	Length	Depth Set	Make	
8 5/8				290								
5 1/2												

Liner Record: Amount \_\_\_\_\_ Kind \_\_\_\_\_ Top \_\_\_\_\_ Bottom \_\_\_\_\_

Size	Amount Set		Sacks Cement	Chemical		Method of Cementing	Amount	Mudding Method	Results (See Note)
	Ft.	In.		Gal.	Make				
8 5/8	290		125						
5 1/2									

Note: What method was used to protect sands if outer strings were pulled? \_\_\_\_\_

NOTE: Were bottom hole plugs used? \_\_\_\_\_ If so, state kind, depth set and results obtained \_\_\_\_\_

TOOLS USED  
Rotary Tools were used from \_\_\_\_\_ feet to \_\_\_\_\_ Cable tools were used from \_\_\_\_\_ feet to \_\_\_\_\_ feet, and from \_\_\_\_\_ feet to \_\_\_\_\_ feet, and from \_\_\_\_\_ feet to \_\_\_\_\_ feet to \_\_\_\_\_  
Type Rig \_\_\_\_\_

INITIAL PRODUCTION TEST  
Describe initial test: whether by flow through tubing or casing or by pumping \_\_\_\_\_  
Amount of Oil Production \_\_\_\_\_ bbls. Size of choke, if any \_\_\_\_\_ Length of test \_\_\_\_\_ Water Production \_\_\_\_\_ bbls. Gravity of oil \_\_\_\_\_ Type of Pump if pump is used, describe \_\_\_\_\_

TOPS:  
Elevation 2460 R. B.  
Heebner 3483  
Toronto 3504  
Lansing 3523  
Arbuckle 3772  
T. D. 3775

COPY

I, the undersigned, being first duly sworn upon oath, state that this well record is true, correct and complete according to the records of this office and to the best of my knowledge and belief.  
Name and title of representative of company: John J. James - Pres.  
Subscribed and sworn to before me this 14th day of September, 1953, 19\_\_\_\_  
My Commission expires April 23, 1956. Bonnie Perryhill Notary Public.