

15-039-00109-00-00

STATE OF KANSAS
STATE CORPORATION COMMISSION
CONSERVATION DIVISION
211 NORTH BROADWAY
WICHITA, KANSAS

WELL PLUGGING APPLICATION FORM
File One Copy

Lease Owner Jones, Shelburne & Farmer, Inc. Address Russell, Kansas
(Applicant)
Lease (Farm Name) SODERLUND Well No. 1

Well Location SE SE NE Sec. 3 Twp 3 Rge. (E) - (W) 27

County Decatur Field Name (if any) Wildcat

Total Depth 4106 Oil Gas Dry Hole Dry

Was well log filed with application? Yes If not, explain: _____

Date and hour plugging is desired to begin 6-27-55 11:00 P.M.

Plugging of the well will be done in accordance with the Rules and Regulations of the State Corporation Commission.

Name of the person on the lease in charge of well for owner _____

Dale Buchheister Address Plainville, Kansas

Plugging Contractor Jones, Shelburne & Farmer, Inc.

Plugging Contractor's License No. _____

Address Russell, Kansas

Invoice covering assessment for plugging this well should be sent to _____

Jones, Shelburne & Farmer, Inc. Address Russell, Kansas

and payment will be guaranteed by applicant.

RECEIVED
STATE CORPORATION COMMISSION

JUL 11 1955

CONSERVATION DIVISION
Wichita, Kansas

7-11-55

John W. Farmer
Applicant or Acting Agent

Date July 1, 1955

PLUGGING
FILE SEC 3 T 3 R 27W
BOOK PAGE 130 LINE 34

OPERATOR Jones, Shelburne & Farmer, Inc.

FORMATION RECORD

ADDRESS Russell, Kansas

Give detailed description and thickness of all formations drilled through, contents of sand, whether dry, water, oil or gas.

FARM NAME SODERLUND WELL NO. 1 COUNTY Decatur SEC. 3 TWP. 3 RGE. 27

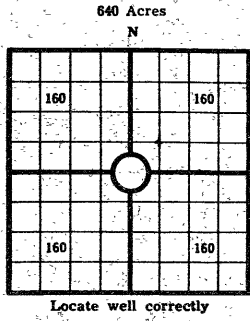

COUNTY Decatur SEC. 3 TWP. 3 RGE. 27
 COMPANY OPERATING Jones, Shelburne & Farmer, Inc.
 OFFICE ADDRESS Russell, Kansas
 FARM NAME SODERLUND WELL NO. 1
 DRILLING STARTED 6-17-55 DRILLING FINISHED 6-27-55
 DATE OF FIRST PRODUCTION _____ COMPLETED _____
 WELL LOCATED S 1/4, S E 1/4, NE 1/4 North of South
 Line and _____ ft. East of West Line of Quarter Section
 Elevation (Relative to sea level) DERRICK FLOOR 2657 GROUND 2650
 CHARACTER OF WELL (Oil, gas or dryhole) Dry

OIL OR GAS SANDS OR ZONES

Name	From	To	Name	From	To
1			4		
2			5		
3			6		

Perforating Record If Any

Shot Record

Perforating Record If Any				Shot Record			
Formation	From	To	No. of Shots	Formation	From	To	Size of Shot

CASING RECORD

Amount Set								Amount Pulled		Packer Record	
Size	Wt.	Thds.	Make	Ft.	In.	Ft.	In.	Size	Length	Depth Set	Make
<u>8-5/8</u>				<u>224</u>							

Liner Record: Amount _____ Kind _____ Top _____ Bottom _____

CEMENTING AND MUDDING

Size	Amount Set		Sacks Cement	Chemical		Method of Cementing	Amount	Mudding Method	Results (See Note)
	Ft.	In.		Gal.	Make				
<u>8-5/8</u>	<u>224</u>		<u>135</u>						

Note: What method was used to protect sands if outer strings were pulled? _____

NOTE: Were bottom hole plugs used? _____ If so, state kind, depth set and results obtained _____

TOOLS USED

Rotary Tools were used from _____ feet to _____ Cable tools were used from _____ feet to _____ feet, and from _____ feet to _____ feet, and from _____ feet to _____ feet to _____

Type Rig _____

INITIAL PRODUCTION TEST

Describe initial test: whether by flow through tubing or casing or by pumping _____

Amount of Oil Production _____ bbls. Size of choke, if any _____ Length of test _____ Water

Production _____ bbls. Gravity of oil _____ Type of Pump if pump is used, describe _____

Formation	Top		Bottom		Formation	Top		Bottom	
<u>Shale, Flint Rock, Sand & Shale</u>	<u>0</u>	<u>224</u>	<u>224</u>	<u>825</u>					
<u>Shale</u>			<u>825</u>	<u>1450</u>					
<u>Shale Sand & shells</u>			<u>1450</u>	<u>1725</u>					
<u>Shale Sand & Shells</u>			<u>1725</u>	<u>1925</u>					
<u>Shale & shells</u>			<u>1925</u>	<u>1975</u>					
<u>Red Bed & shells</u>			<u>1975</u>	<u>2263</u>					
<u>Shale Shells (Red Bed)</u>			<u>2263</u>	<u>2297</u>					
<u>Anhydrite</u>			<u>2297</u>	<u>2535</u>					
<u>Shale & shells</u>			<u>2535</u>	<u>3595</u>					
<u>Shale & lime</u>			<u>3595</u>	<u>3900</u>					
<u>Lime & shale</u>			<u>3900</u>	<u>4066</u>					
<u>Shale & lime</u>			<u>4066</u>	<u>4106</u>					
<u>Arbuckle & sand</u>			<u>4106</u>	<u>4106</u>					
<u>T.D.</u>									

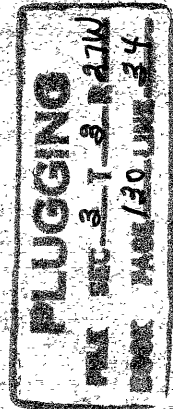

CONSULT 17-11-55
15-039-00109-00-00

TOPS:
 Elevation RB 2659
 Anhydrite 2263
 Heebner 3590
 Lansing 3629
 B. Kansas City 3828
 Arbuckle 4059
 T.D. 4106
 D & A

I, the undersigned, being first duly sworn upon oath, state that this well record is true, correct and complete according to the records of this office and to the best of my knowledge and belief.

John J. Fernandez - Pres.
 Name and title of representative of company

Subscribed and sworn to before me this 1st day of July, 19 55
Lucille Ramsey
 Notary Public



STATE OF KANSAS
STATE CORPORATION COMMISSION
CONSERVATION DIVISION
800 BITTING BUILDING
WICHITA 2, KANSAS

15-039-00109-00-00

211 N. Broadway

June 29, 1935

Well No.	1
Lease	Bedfordland
Description	SE 1/4 Sec. 1-2-27N
County	Decatur
File No.	170-21

Joest, Shollman & Farnum, Inc.
Russell
Kansas

Gentlemen:

This letter is your authority to plug the above subject well, in accordance with the Rules and Regulations of the State Corporation Commission. When you are ready to plug this well, please contact our District Plugging Supervisor, Mr. Eldon Fatty, Box 326, Hays, Kansas.

STATE CORPORATION COMMISSION
CONSERVATION DIVISION

BY: J. P. Roberts
J. P. ROBERTS

cc: District Plugging Supervisor