

KANSAS

WELL COMPLETION REPORT AND  
DRILLER'S LOG

S. 6 T. 3 S.R. 29 <sup>NE</sup> W

API No. 15 — 039 — 20524 - 0000  
County Number

Loc. \_\_\_\_\_

County Decatur

Operator Tenneco Oil Company

Address Suite 139, Ciudad Bldg., 3000 United Founders Blvd.  
Oklahoma City, Oklahoma, 73112

Well No. 3-6 Lease Name Pollnow

Footage Location 1870 feet from (X) (S) line 1430 feet from (E) (W) line

Principal Contractor Emphasis Drlg. Co. Geologist \_\_\_\_\_

Spud Date 10-29-80 Date Completed 11-6-80 Total Depth 4035 P.B.T.D. \_\_\_\_\_

Directional Deviation \_\_\_\_\_ Oil and/or Gas Purchaser \_\_\_\_\_

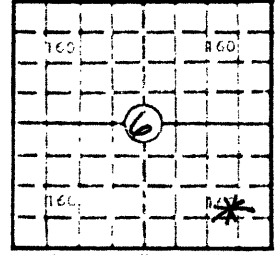

Elev.: Gr. \_\_\_\_\_

DF \_\_\_\_\_ KB \_\_\_\_\_

CASING RECORD

Report of all strings set — surface, intermediate, production, etc.

Purpose of string	Size hole drilled	Size casing set (in O.D.)	Weight lbs/ft.	Setting depth	Type cement	Sacks	Type and percent additives
Surface	12-1/4"	8-5/8"	K-55	605	60/40 Poz	250	3% CaCl <sub>2</sub> + 2% Gel
					Common	200	3% CaCl <sub>2</sub> + 2% Gel

LINER RECORD

PERFORATION RECORD

Top, ft.	Bottom, ft.	Sacks cement	Shots per ft.	Size & type	Depth interval

TUBING RECORD

Size	Setting depth	Packer set at

ACID, FRACTURE, SHOT, CEMENT SQUEEZE RECORD

Amount and kind of material used	Depth interval treated

INITIAL PRODUCTION

Date of first production Dry Producing method (flowing, pumping, gas lift, etc.) Dry

RATE OF PRODUCTION PER 24 HOURS Oil Dry bbls. Gas Dry MCF Water \_\_\_\_\_ Gas-oil ratio \_\_\_\_\_

Disposition of gas (vented, used on lease or sold) \_\_\_\_\_ Producing interval(s) \_\_\_\_\_

RECEIVED  
STATE CORPORATION COMMISSION

1111 20 JUN 1981 7-20-81

CONSERVATION DIVISION CFPB  
Wichita, Kansas

INSTRUCTIONS: As provided in KCC Rule 82-2-125, within 90 days after completion of a well, one completed copy of this Drillers Log shall be transmitted to the State Geological Survey of Kansas, 4150 Monroe Street, Wichita, Kansas 67209. Copies of this form are available from the Conservation Division, State Corporation Commission, 245 No. Water, Wichita, Kansas 67202. Phone AC 316-522-2206. If confidential custody is desired, please note Rule 82-2-125. Drillers Logs will be on open file in the Oil and Gas Division, State Geological Survey of Kansas, Lawrence, Kansas 66044.

Operator Tenneco Oil Company

DESIGNATE TYPE OF COMP.: OIL, GAS, DRY HOLE, SWDW, ETC.:

Well No. 3-6

Lease Name Pollnow

Dry

S 6 T 3 S R <sup>EX</sup> W

WELL LOG

Show all important zones of porosity and contents thereof; cored intervals, and all drill-stem tests, including depth interval tested, cushion used, time tool open, flowing and shut-in pressures, and recoveries.

SHOW GEOLOGICAL MARKERS, LOGS RUN, OR OTHER DESCRIPTIVE INFORMATION.

FORMATION DESCRIPTION, CONTENTS, ETC.	TOP	BOTTOM	NAME	DEPTH
Soil & Clay	40			
Shale & Sand	650			
Sand & Shale	1875			
Shale	2511			
Anhydrite	2542			
Shale	3400			
Shale & Lime	3710			
Lime & Shale	4035	TD		

USE ADDITIONAL SHEETS, IF NECESSARY, TO COMPLETE WELL RECORD.

Date Received

*Carolyn S. Arnold*  
Signature

Carolyn S. Arnold

Production Analyst

July 14, 1981

Date

KANSAS CORPORATION COMMISSION  
WELL RECORD

(Mail to Kansas Geological Survey, 4150 Monroe Street, Wichita, Kansas 67209)

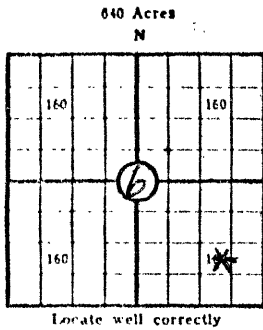

Lease Name: Pollnow Well No. 3-6  
 Well Located: 1870' ESL & 1430' FEL  
Decatur SEC 6 TWP 3S RGE 29W  
 Operator: Tenneco Oil Company Okla. City, OK, 73112  
 Address: Suite 139, Ciudad Bldg., 3000 United Founders Blvd./  
 Elevation: Ground D.F.          K.B.           
 Type Well: (Oil, gas, dry hole) Dry Hole

Drilling Commenced: 10-29 19 80 Drilling Completed: 11-06 19 80  
 Well Completed: 11-06 19 80 Total Depth 4035'  
 Initial Production:          Dry Hole

Casing Record

Size: 8-5/8" Set at 650 Size:          Set at           
 Size:          Set at          Size:          Set at         

Liner Record

Size: None Set from          To         

Cementing

Casing Size	Sacks	Type Cement and Additives
<u>8-5/8"</u>	<u>250</u>	<u>60/40 Poz W/3% CACL 2% Gel</u>
<u>        </u>	<u>200</u>	<u>Common W/3% CACL 2% Gel</u>
<u>        </u>	<u>        </u>	<u>        </u>

Perforations

Formation	Perforated Interval and Number Shots
<u>N/A</u>	<u>        </u>
<u>        </u>	<u>        </u>
<u>        </u>	<u>        </u>
<u>        </u>	<u>        </u>

Electric Log Run (Show type log and depths covered)

RECEIVED  
STATE CORPORATION COMMISSION

(Fill in formation and related information on reverse side)

20  
CONSERVATION DIVISION  
Wichita, Kansas

FORMATION, TESTING AND COMPLETION RECORD

Show Drill Stem Tests,  
Well Stimulation and  
Production Tests

Formation	Top	Bottom	
Soil & Clay	40		
Shale & Sand	650		
Sand & Shale	1875		
Shale	2511		
Anhydrite	2542		
Shale	3400		
Shale & Lime	3710		
Lime & Shale	4035		
(R.T.D.)			