

EFFECTIVE DATE 9-3-91 **NOTICE OF INTENTION TO DRILL**
Approved by the State of Kansas five (5) days prior to commencing well

Expected Spud Date September 15, 1991 month day year
SW¹/₄ NW¹/₄ SW¹/₄ Sec 8 Twp 3 S, Rg 28 East West

OPERATOR: License # 03637
Name: Northland Royalty Operating Company
Address: 3030 Fourth Avenue North
City/State/Zip: Billings, Montana 59101
Contact Person: Joe Glennon/Peter Sheehan
Phone: (406) 259-5400

1650' feet from South line of Section
4950' feet from East line of Section
(Note: Locate well on Section Plat on Reverse Side)

CONTRACTOR: License #: To be provided on
Name: AC-01 Completion Form

County: Decatur
Lease Name: Waller Well #: 12-8
Field Name: Decatur Center Northwest
Is this a Prorated Field? yes no
Target Formation(s): Lansing
Nearest lease or unit boundary: 330'
Ground Surface Elevation: 2687' feet MSL
Domestic well within 330 feet: yes no
Municipal well within one mile: yes no
Depth to bottom of fresh water: 125'
Depth to bottom of usable water: 250'
Surface Pipe by Alternate: 1 2
Length of Surface Pipe Planned to be set: 300'
Length of Conductor pipe required: None
Projected Total Depth: 4130'
Formation at Total Depth: Lansing F
Water Source for Drilling Operations:
well farm pond other

Well Drilled For: Well Class: Type Equipment:
 Oil Inj Infield Mud Rotary
 Gas Storage Pool Ext. Air Rotary
 OWWO Disposal Wildcat Cable
 Seismic; 1 # of Holes

If OWWO: old well information as follows:
Operator: N/A
Well Name: _____
Comp. Date: _____ Old Total Depth _____

Directional, Deviated or Horizontal wellbore? yes no
If yes, total depth location: N/A

Water for drilling to be provided by contractor.

AFFIDAVIT

The undersigned hereby affirms that the drilling, completion and eventual plugging of this well will comply with K.S.A. 55-101, et. seq.

- It is agreed that the following minimum requirements will be met:
1. The appropriate district office shall be notified before setting surface pipe;
 2. The minimum amount of surface pipe as specified above shall be set by circulating cement to the top; in all cases surface pipe shall be set through all unconsolidated materials plus a minimum of 20 feet into the underlying formation;
 3. If the well is dry, a plugging proposal shall be submitted to the district office. An agreement between the operator and the district office on plug length and placement is necessary prior to plugging;
 4. The appropriate district office will be notified before well is either plugged or production casing is cemented in;
 5. If an Alternate II completion, production pipe shall be cemented from below any usable water to surface within 120 days of spud date. In all cases, notify district office prior to any cementing.

I hereby certify that the statements made herein are true and to the best of my knowledge and belief.
Date: 8/29/91 Signature of Operator or Agent: Joe Glennon Title: Landman

FOR KCC USE:
API # 15-039-20,876-00-00
Conductor pipe required None feet
Minimum surface pipe required 300 feet per Alt. 1
Approved by: MW 8-29-91
EFFECTIVE DATE: 9-3-91
This authorization expires: 2-29-92
(This authorization void if drilling not started within 6 months of effective date.)
Spud date: _____ Agent: _____

RECEIVED
STATE CORPORATION COMMISSION
08-29-1991
AUG 29 1991
CONSERVATION DIVISION
Wichita, Kansas

REMEMBER TO:

- File Drill Pit Application (form CDP-1) with Intent to Drill;
- File Completion Form ACO-1 within 120 days of spud date;
- File acreage attribution plat according to field proration orders;
- Notify appropriate district office 48 hours prior to workover or re-entry;
- Submit plugging report (CP-4) after plugging is completed;
- Obtain written approval before disposing or injecting salt water.

2
3
280

PLAT OF ACREAGE ATTRIBUTABLE TO A WELL

State Corporation Commission, Conservation Division
 200 Colorado Derby Bldg. Wichita, Kansas 67202

OPERATOR Northland Royalty Operating Co. LOCATION OF WELL: SW $\frac{1}{4}$ NW $\frac{1}{4}$ SW $\frac{1}{4}$
 LEASE Waller 1650' feet north of SE corner
 WELL NUMBER Waller 12-8 4950' feet west of SE corner
 FIELD Decatur Center Northwest Sec. 8 T 3 So. R 28 ~~SE~~W
 COUNTY Decatur
 NO. OF ACRES ATTRIBUTABLE TO WELL _____ IS SECTION x REGULAR _____ IRREGULAR?
 DESCRIPTION OF ACREAGE SW $\frac{1}{4}$ NW $\frac{1}{4}$ SW $\frac{1}{4}$ IF IRREGULAR, LOCATE WELL FROM NEAREST CORNER BOUNDARY.

NOTE: If plat depicted is insufficient for your circumstances, you may attach your own scaled or surveyed plat.

PLAT

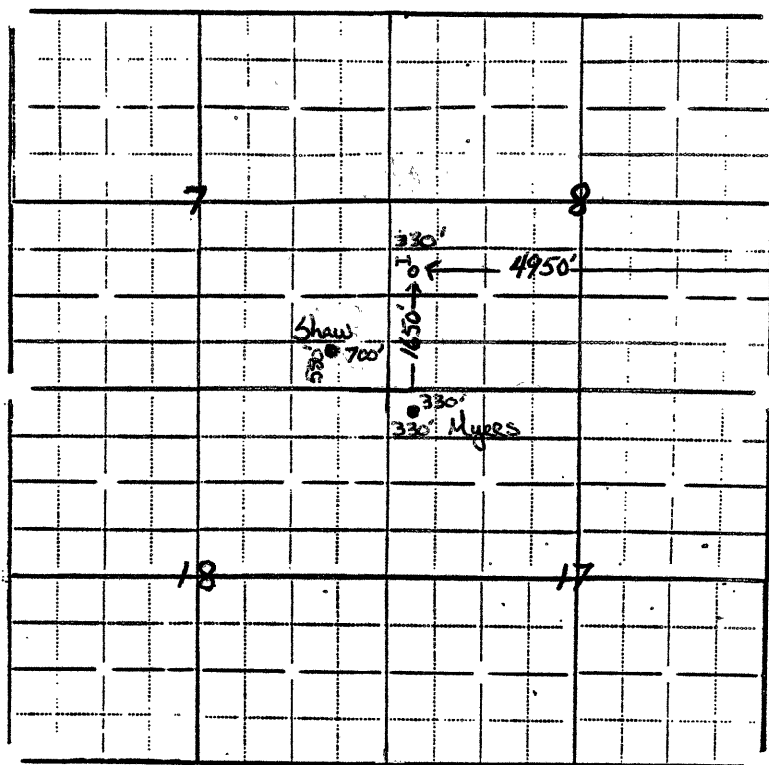

In plotting the proposed location of the well, you must show:

- 1) The manner in which you are using the depicted plat by identifying section lines, i.e. 1 section, 1 section with 8 surrounding partial sections, 4 sections, 16 sections, etc.;
- 2) the well's location relative to the location of other wells producing from the same common source of supply in adjoining drilling units, pursuant to K.A.R. 82-3-108, 82-3-207, 82-3-312, or special orders of the Commission;
- 3) the distance of the proposed drilling location from the section's east and south lines; and
- 4) the distance to the nearest lease or unit boundary line.

I hereby certify that the statements made herein are true and to the best of my knowledge and belief.

Signature of Operator or Agent Joe L. Lamm
 Date 8/23/91 Title Landman