

STATE CORPORATION COMMISSION OF KANSAS
OIL & GAS CONSERVATION DIVISION
WELL COMPLETION OR RECOMPLETION FORM
ACO-1 WELL HISTORY
DESCRIPTION OF WELL AND LEASE

Operator: License # 8793
Name James Dillie
Address 4469 So. Winona Ct.
Denver, Colorado 80236
City/State/Zip

Purchaser None

Operator Contact Person James Dillie
Phone 303-795-2955

Contractor: License # 8682
Name Golden Eagle Drilling

Wellsite Geologist James Dillie
Phone 303-795-2955

Designate Type of Completion
 New Well Re-Entry Workover
 Oil SWD Temp Abd
 Gas Inj Delayed Comp.
 Dry Other (Core, Water Supply etc.)
If **OWWO**: old well info as follows:
Operator
Well Name
Comp. Date Old Total Depth

WELL HISTORY

Drilling Method:
 Mud Rotary Air Rotary Cable
.8/19/86... ..8/29/86... ..8/28/86...
Spud Date Date Reached TD Completion Date
4740' 4740'
Total Depth PBTD

Amount of Surface Pipe Set and Cemented at 370 feet
Multiple Stage Cementing Colliar Used? Yes No
If yes, show depth set...feet
If alternate 2 completion, cement circulated
from...feet depth to...w/...SX cmt
Cement Company Name
Invoice #

API NO. 15-...153-20,655-0000
County Rawlins
SE NW Sec 10 Twp 3S Rge 36 East
XX West

3300 Ft North from Southeast Corner of Section
3300 Ft West from Southeast Corner of Section
(Note: Locate well in section plat below)

Lease Name Miller Well # 1-D

Field Name Wildcat

Producing Formation None

Elevation: Ground 3322' KB 3327'

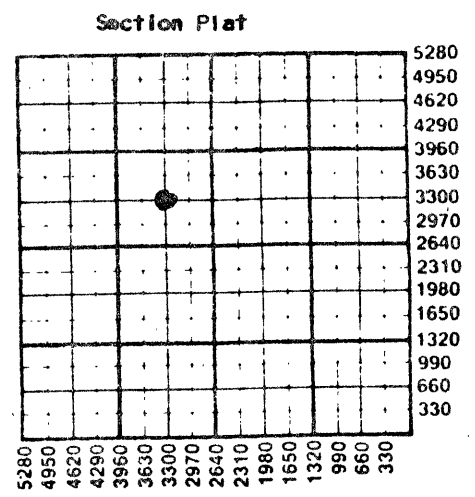

WATER SUPPLY INFORMATION
Disposition of Produced Water: Disposal
Docket # Repressuring

Questions on this portion of the ACO-1 call:
Water Resources Board (913) 296-3717
Source of Water:
Division of Water Resources Permit #
 Groundwater...Ft North from Southeast Corner
(Well) ...Ft West from Southeast Corner of
Sec Twp Rge East West
 Surface Water...Ft North from Southeast Corner
(Stream, pond etc)...Ft West from Southeast Corner
Sec Twp Rge East West
 Other (explain) Purchased from Jack Poore
(purchased from city, R.W.D. #)

INSTRUCTIONS: This form shall be completed in triplicate and filed with the Kansas Corporation Commission, 200 Colorado Derby Building, Wichita, Kansas 67202, within 120 days of the spud date of any well. Rule 82-3-130, 82-3-107 and 82-3-106 apply. Information on side two of this form will be held confidential for a period of 12 months if requested in writing and submitted with the form. See rule 82-3-107 for confidentiality in excess of 12 months. One copy of all wireline logs and drillers time log shall be attached with this form. Submit CP-4 form with all plugged wells. Submit CP-111 form with all temporarily abandoned wells.

All requirements of the statutes, rules and regulations promulgated to regulate the oil and gas industry have been fully complied with and the statements herein are complete and correct to the best of my knowledge.

Signature James Dillie
Title Operator Date 9/11/86

K.C.C. OFFICE USE ONLY
 Letter of Confidentiality Attached
 Wireline Log Received
 Drillers Timelog Received
Distribution
 KCC SWD/Rep NGPA
 KGS Plug Other
(Specify)



Subscribed and sworn to before me this 11th day of September 1986
Notary Public Nancy L. Wright
Date Commission Expires 12-12-88

9-15-86

Sec 10 Twp 3S Rge 36W

Operator Name James Dillie Lease Name..... Miller Well #..... 1-D

Sec... 10 Twp... 3S Rge... 36 East West County... Rawlins

WELL LOG

INSTRUCTIONS: Show important tops and base of formations penetrated. Detail all cores. Report all drill stem tests giving interval tested, time tool open and closed, flowing and shut-in pressures, whether shut-in pressure reached static level, hydrostatic pressures, bottom hole temperature, fluid recovery, and flow rates if gas to surface during test. Attach extra sheet if more space is needed. Attach copy of log.

Drill Stem Tests Taken Yes No
Samples Sent to Geological Survey Yes No
Cores Taken Yes No

Formation Description
 Log Sample

DST #1 4314'-4387'
Times: 30-60-15-60
Recovered 15' Mud
IHP 2206 FHP 2195 IFP 76-76 FFP 85-85
ISIP 336 FSIP 271 BHT 128°
DST #2 4592'-4646'
Times: 30-60-30-60
Recovered 120' OSM plus 30' slightly oil cut
Mud.
IHP 2387 FHP 2365 IFP 97-97 FFP 119-119
ISIP 1169 FSIP 1062 BHT 132°

Name	Top	Bottom
Topeka	4041	
Deer Creek	4087	
Oread	4143	
Douglas	4198	
L-KC	4230	
Marmaton	4528	
Pawnee	4578	
Ft. Scott	4623	
Cherokee	4645	

RELEASED
10-20-87
OCT 20 1987

FROM CONFIDENTIAL

<p align="center">CASING RECORD <input type="checkbox"/> New <input type="checkbox"/> Used</p> <p align="center">Report all strings set-conductor, surface, intermediate, production, etc.</p>							
Purpose of String	Size Hole Drilled	Size Casing Set (in O.D.)	Weight Lbs/Ft.	Setting Depth	Type of Cement	#Sacks Used	Type and Percent Additives
Surface	12 1/4	8 5/8	20	370	60/40 poe	240	
.....
.....
.....
<p align="center">PERFORATION RECORD</p>				<p align="center">Acid, Fracture, Shot, Cement Squeeze Record</p>			
Shots Per Foot	Specify Footage of Each Interval Perforated			Amount and Kind of Material Used			Depth
.....
.....
.....
.....
<p>TUBING RECORD</p>				<p>Liner Run <input type="checkbox"/> Yes <input type="checkbox"/> No</p>			
Date of First Production		Producing Method					
		<input type="checkbox"/> Flowing <input type="checkbox"/> Pumping <input type="checkbox"/> Gas Lift <input type="checkbox"/> Other (explain).....					
Estimated Production Per 24 Hours	Oil	Gas	Water	Gas-Oil Ratio	Gravity		
	Bbls	MCF	Bbls	CFPB			

METHOD OF COMPLETION

Production Interval

Disposition of gas: Vented Open Hole Perforation
 Sold Other (Specify)
 Used on Lease Dually Completed
 Commingled