

STATE OF KANSAS
STATE CORPORATION COMMISSION
CONSERVATION DIVISION
P. O. BOX 17027
Wichita, Kansas 67217

Rev. 3-15-72
FORM CP-1
RECEIVED
STATE CORPORATION COMMISSION

WELL PLUGGING APPLICATION FORM
File One Copy

OCT 15 1974
10-15-74
CONSERVATION DIVISION
Wichita, Kansas

15-153-20184-00-00

Lease Owner Abercrombie Drilling, Inc.
Address 801 Union Center Bldg., Wichita, Kansas 67202
Lease (Farm Name) WRIGHT Well No. #1
Well Location C NE NE Sec. 14 Twp. 3S Rge. (X) 35 (W)
County Rawlins Total Depth 4640' Field Name
Oil Well Gas Well Input Well SWD Well Rotary D & A X
Well Log filed with application as required Yes
Date and hour plugging is desired to begin @9:15 p.m. October 6, 1974

PLUGGING OF THIS WELL WILL BE DONE IN ACCORDANCE WITH K.S.A. 55-128 OF THE RULES AND REGULATIONS OF THE STATE CORPORATION COMMISSION.

Name of company representative authorized to be in charge of plugging operations:

DON FAVINGER

Address HILL CITY, KANSAS

Plugging Contractor Abercrombie Drilling, Inc. License No.

Address 801 Union Center, Wichita, Kansas 67202

Invoice covering assessment for plugging this well should be sent to:

Name Abercrombie Drilling, Inc.

Address 801 Union Center, Wichita, Kansas 67202

and payment will be guaranteed by applicant or acting agent.

Signed: Jack K. Wharton
Applicant or Acting Agent

Jack K. Wharton
Date: October 9, 1974

IMPORTANT
 Kans. Geo. Survey request
 samples on this well.

KANSAS DRILLERS LOG

S. 14 T. 3 R. 35 E W

API No. 15 — 153 — 20,184 00-00
 County Number

Loc. NE NE

County Rawlins

Operator
Abercrombie Drilling, Inc.

Address 801 Union Center Wichita 67202

Well No. #1 Lease Name Wright

Footage Location
660 feet from (N) (S) line 660 feet from (E) (W) line

Principal Contractor Abercrombie Drilling, Inc. Geologist Orlin R. Phelps

Spud Date September 27, 1974 Total Depth 4640' P.B.T.D.

Date Completed October 6, 1974 Oil Purchaser None

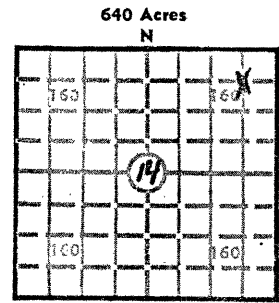

Locate well correctly
 Elev.: Gr. 3025'

DF 3028' KB 3030'

CASING RECORD

Report of all strings set — surface, intermediate, production, etc.

Purpose of string	Size hole drilled	Size casing set (in O.D.)	Weight lbs/ft.	Setting depth	Type cement	Sacks	Type and percent additives
Surface	12 1/4"	8-5/8"		289'	Sunset	225	

LINER RECORD

PERFORATION RECORD

Top, ft.	Bottom, ft.	Sacks cement	Shots per ft.	Size & type	Depth interval

TUBING RECORD

Size	Setting depth	Packer set at

RECEIVED
 STATE CORPORATION COMMISSION
 OCT 15 1974 *10-15-74*

ACID, FRACTURE, SHOT, CEMENT SQUEEZE RECORD

Amount and kind of material used

CONSERVATION DIVISION
 Wichita, Kansas

INITIAL PRODUCTION

Date of first production _____ Producing method (flowing, pumping, gas lift, etc.) _____

RATE OF PRODUCTION PER 24 HOURS	Oil	Gas	Water	Gas-oil ratio
	bbls.	MCF	bbls.	CFPB

Disposition of gas (vented, used on lease or sold) _____ Producing interval (s) _____

INSTRUCTIONS: As provided in KCC Rule 82-2-125, within 90 days after completion of a well, one completed copy of this Drillers Log shall be transmitted to the State Geological Survey of Kansas, 4150 Monroe Street, Wichita, Kansas 67209. Copies of this form are available from the Conservation Division, State Corporation Commission, 3830 So. Meridian (P.O. Box 17027), Wichita, Kansas 66217. Phone AC 316-522-2206. If confidential custody is desired, please note Rule 82-2-125. Drillers Logs will be on an open file in the Oil and Gas Division, State Geological Survey of Kansas, Lawrence, Kansas 66044.

Operator
Abercrombie Drilling, Inc.

DESIGNATE TYPE OF COMP.: OIL, GAS,
DRY HOLE, SWDW, ETC.:

Well No. #1 Lease Name WRIGHT

Dry Hole

S 14 T 3S R 35 ^{EX}_W

WELL LOG

Show all important zones of porosity and contents thereof; cored intervals, and all drill-stem tests, including depth interval tested, cushion used, time tool open, flowing and shut-in pressures, and recoveries.

SHOW GEOLOGICAL MARKERS, LOGS RUN,
OR OTHER DESCRIPTIVE INFORMATION.

FORMATION DESCRIPTION, CONTENTS, ETC.	TOP	BOTTOM	NAME	DEPTH
Surface dirt & Sand	0	240	<u>ELECTRIC LOG TOPS</u>	
Shale	240	289		
Shale & Shells	289	1445	Anhydrite	2778
Shale	1445	2180	B/Anhydrite	2838
Shale & hard sand	2180	2730	Heebner	3901
Shale	2730	3174	Lansing	3948
Anhydrite	3174	3216	B/Kansas City	4222
Shale	3216	3610	Fort Scott	4355
Shale & Lime	3610	3725	Mississippian	4595
Lime	3725	4640	ELTD	4636
Rotary Total Depth		4640		
<p>DST #1 (3961-4018) 30", 45", 60", 60" Recovered 150' oil spotted mud and 35' slightly OCM. FFP's 95# - 158#; IBHP 1311#; FBHP 1269#.</p> <p>DST #2 (4013-4060) 30", 45", 60", 60" Recovered 600' Muddy SW. FFP's 135# - 332#; IBHP 1285#; FBHP 1182#.</p> <p>DST #3 (4115-4225) 30", 30", 30", 30" Weak blow for 20 Min. Recovered 40' Mud. No Shows. FFP's 105#-126#; IBHP 1186#; FBHP 1112#; BHT 139°.</p> <p>Plugged to Abandon.</p>				

USE ADDITIONAL SHEETS, IF NECESSARY, TO COMPLETE WELL RECORD.

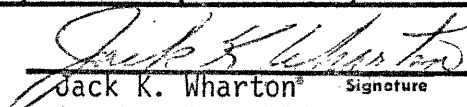
Date Received	 Jack K. Wharton Signature
	October 11, 1974 Title
	Date

State of Kansas



15-153-20184-00-00

State Corporation Commission

CONSERVATION DIVISION

(Oil, Gas and Water)

P. O. Box 17027 3830 S. Meridian
WICHITA, KANSAS 67217

October 11, 1974

WELL PLUGGING AUTHORITY

Well No.	1
Lease	Wright
Description	NE NE 14-3-35W
County	Rawlins
Total Depth	4640'
Plugging Contractor	Abercrombie Drilling, Inc.

Abercrombie Drilling, Inc.
801 Union Center
Wichita, Kansas 67202

Gentlemen:

This is your authority to plug the above subject well in accordance with the Rules and Regulations of the State Corporation Commission.

This authority is void after 90 days from the above date.

Yours very truly,

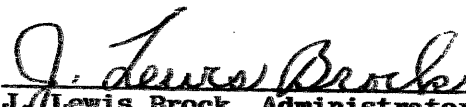
J. Lewis Brock, Administrator

Mr. W. L. Nichols, P. O. Box 157, Morland, Kansas 67650
is hereby assigned to supervise the plugging of the above named well.