

STATE CORPORATION COMMISSION OF KANSAS  
OIL & GAS CONSERVATION DIVISION  
WELL COMPLETION OR RECOMPLETION FORM  
ACO-1 WELL HISTORY  
DESCRIPTION OF WELL AND LEASE

Operator: License # 6593  
Name Coastal Oil & Gas Corp.  
Address c/o ANR Production Company, 211  
N. Robinson, One Leadership Square, Suite 1700  
City/State/Zip Okla. City, OK 73102

Purchaser Permian Oil Corp.

Operator Contact Person Brad Crouch  
Phone (405) 239-7031

Contractor: License # 6033  
Name Murfin Drilling Company

Wellsite Geologist John Busch  
Phone

Designate Type of Completion  
 New Well  Re-Entry  Workover  
 Oil  SWD  Temp Abd  
 Gas  Inj  Delayed Comp.  
 Dry  Other (Core, Water Supply etc.)

If OWWO: old well info as follows:  
Operator  
Well Name  
Comp. Date Old Total Depth

WELL HISTORY

Drilling Method:  
 Mud Rotary  Air Rotary  Cable  
9-25-85 10-1-85 10-18-85  
Spud Date Date Reached TD Completion Date  
4825 4783  
Total Depth PBTD

Amount of Surface Pipe Set and Cemented at 410 feet  
Multiple Stage Cementing Collar Used?  Yes  No  
If yes, show depth set feet  
If alternate 2 completion, cement circulated from feet depth to w/ SX cmt  
Cement Company Name Halliburton  
Invoice #

API No. 15-153-20636-00-00  
County Rawlins  
SE NW Sec. 33 Twp. 3 Rge. 36 East  
X West

3300 Ft North from Southeast Corner of Section  
3300 Ft West from Southeast Corner of Section  
(Note: Locate well in section plat below)

Lease Name Hubbard Well # 2-33  
Field Name Celia South

Producing Formation Cherokee  
Elevation: Ground 3323 3328 KB

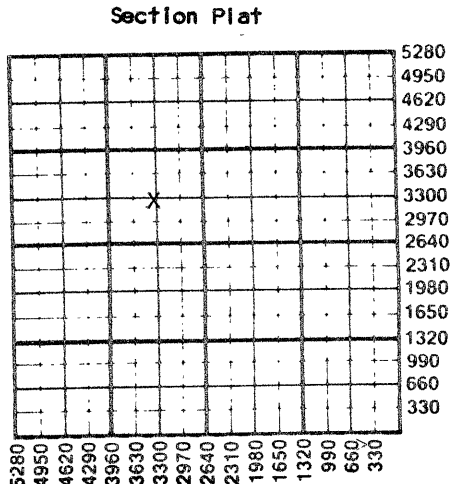

WATER SUPPLY INFORMATION  
Disposition of Produced Water:  Disposal  
Docket #  Repressuring

Questions on this portion of the ACO-1 call:  
Water Resources Board (913) 296-3717  
Source of Water:  
Division of Water Resources Permit #  
 Groundwater 3960 Ft North from Southeast Corner  
(Well) 2640 Ft West from Southeast Corner of  
Sec 33 Twp 3 Rge 36 East X West  
 Surface Water Ft North from Southeast Corner  
(Stream, pond etc) Ft West from Southeast Corner  
Sec Twp Rge East West  
 Other (explain)  
(purchased from city, R.W.D. #)

INSTRUCTIONS: This form shall be completed in duplicate and filed with the Kansas Corporation Commission, 200 Colorado Derby Building, Wichita, Kansas 67202, within 90 days after completion or recompletion of any well. Rule 82-3-130 and 82-3-107 apply.  
Information on side two of this form will be held confidential for a period of 12 months if requested in writing and submitted with the form. See rule 82-3-107 for confidentiality in excess of 12 months.  
One copy of all wireline logs and drillers time log shall be attached with this form. Submit CP-4 form with all plugged wells. Submit CP-111 form with all temporarily abandoned wells.

All requirements of the statutes, rules and regulations promulgated to regulate the oil and gas industry have been fully complied with and the statements herein are complete and correct to the best of my knowledge.

Signature [Signature]  
Title District Engineer Date 10-29-85

Subscribed and sworn to before me this 29th day of October 1985.  
Notary Public [Signature]  
Date Commission Expires Jan 14 1987

K.C.C. OFFICE USE ONLY  
F  Letter of Confidentiality Attached  
C  Wireline Log Received  
C  Drillers Timelog Received  
Distribution  
 KCC  SWD/Rep  NGPA  
 KGS  Plug  Other  
(Specify)  
RECEIVED RECEIVED

**SIDE TWO**

Operator Name Coastal Oil & Gas Lease Name Hubbard Well # 2-33

Sec. 33 Twp. 3 Rge. 36  East  West County Rawlins

**WELL LOG**

**INSTRUCTIONS:** Show important tops and base of formations penetrated. Detail all cores. Report all drill stem tests giving interval tested, time tool open and closed, flowing and shut-in pressures, whether shut-in pressure reached static level, hydrostatic pressures, bottom hole temperature, fluid recovery, and flow rates if gas to surface during test. Attach extra sheet if more space is needed. Attach copy of log.

Drill Stem Tests Taken  Yes  No  
 Samples Sent to Geological Survey  Yes  No  
 Cores Taken  Yes  No

**Formation Description**  
 Log  Sample

Lansing "B" - Ls-wh micro xtaln, chalky ip, fair interxln porosity, gils., dead oil, trace of free brn oil, fast bright yellow strming cut, pyr ip fair-gd show

Cherokee Ls - Cr, wh, tan, micro xtln, foss, chalky ip, fair-gd interpart porosity, trace of pin pt porosity, good trace of free brn oil, v. sli odor, no gas bubbles, no fluor, gd strming br yellow cut <5% smp1.

Name	Top	Bottom
Anhydrite	3104	
B/Anhydrite	3146	
Topeka	4030	
Heebner	4170	
Lansing	4224	
Marmaton	4516	
Cherokee Sh	4656	
Cherokee Ls	4683	

CASING RECORD <input type="checkbox"/> New <input type="checkbox"/> Used							
Report all strings set-conductor, surface, intermediate, production, etc.							
Purpose of String	Size Hole Drilled	Size Casing Set (in O.D.)	Weight Lbs/Ft.	Setting Depth	Type of Cement	#Sacks Used	Type and Percent Additives
Surface	12 1/4	8 5/8	24	410	60:40 POZ	280	2% gel 3% CaC
Production	7 7/8	5 1/2	14	4825	60:40 POZ Lite	200 280	10% salt 2% gel 7# gilsonite
PERFORATION RECORD				Acid, Fracture, Shot, Cement Squeeze Record			
Shots Per Foot	Specify Footage of Each Interval Perforated			(Amount and Kind of Material Used)		Depth	
2	4682-4692			4500 gal acid, 6000 gal 2% KCl			
TUBING RECORD				Liner Run <input type="checkbox"/> Yes <input checked="" type="checkbox"/> No			
Size	Set At	Packer at					
2 7/8	4693						
Date of First Production	Producing Method						
10-16-85	<input type="checkbox"/> Flowing <input checked="" type="checkbox"/> Pumping <input type="checkbox"/> Gas Lift <input type="checkbox"/> Other (explain).....						
Estimated Production Per 24 Hours	Oil	Gas	Water	Gas-Oil Ratio		Gravity	
	69 Bbls	TSTM MCF	3.5 Bbls	--	CFPB	29	

**METHOD OF COMPLETION** Production Interval

Disposition of gas:  Vented  Open Hole  Perforation 4682-4692  
 Sold  Other (Specify) .....  
 Used on Lease  Dually Completed .....  
 Commingled .....