

EFFECTIVE DATE: 5-11-99  
DISTRICT # 4  
SGA?  Yes...  No

State of Kansas  
CATHODIC PROTECTION BOREHOLE INTENT DRAFT

FORM MUST BE SIGNED  
ALL BLANKS MUST BE FILLED IN

Must be approved by the K.C.C. sixty (60) days prior to commencing well.

Expected Spud (Starting) Date 6 25 99  
month day year

Spot (Location) Q/Q/Q East  
SE-SE Sec 21 Twp 3 S, Rg 40 West  
175 feet from South / North line of Section  
312 feet from East / West line of Section  
(Circle directions from nearest outside corner boundary)

OPERATOR: License # 31089

IS SECTION  REGULAR  IRREGULAR?  
(Spot well on the Section Plat on Reverse Side)  
County: Cheyenne

Name: Midwest Energy, Inc.  
Address: 1330 Canterbury Rd  
City/State/Zip: Hays, Ks 67601

Contact Person: De Sultzer

Phone: 785-625-1437

Lease Name: N/A Well #: N/A

Facility Name: St. Francis West #CPZ

Ground Surface Elevation: 3300 (TOPO MAP) MSL

Cathodic Borehole Total Depth 200 ft.

Depth to Bedrock \_\_\_\_\_ ft.

CONTRACTOR: License #: 31308

Name: Rick Young Drilling

Type Drilling Equipment:  Mud Rotary  Cable  
 Air Rotary  Other

WATER INFORMATION:

Aquifer Penetration:  None  Single  Multiple

Depth to bottom of fresh water: TOP OF FRESH WATER

Depth to bottom of usable water: APPROX 13'

Water well within one-quarter mile:  yes  no

\* Public water supply well within one mile:  yes  no

Water Source for Drilling Operations:

well  farm pond  stream  other

Water Well Location: \_\_\_\_\_

DWR Permit #: \_\_\_\_\_

Standard Dimension Ratio (SDR) is = 26 SDR = 26

(cathodic surface OD csg. in inches / MWT in inches = SDR)

Annular space between borehole and casing will be grouted

with:  Concrete  Bentonite Cement

Neat cement  Bentonite clay

Anode vent pipe will be set at: .3 ft. above surface

Anode conductor (backfill) material TYPE: Ioresco DW-1

Depth to BASE of Backfill installation material: 60

Depth to TOP of Backfill installation material: 200

AFFIDAVIT

\* PUBLIC WATER SUPPLY LOCATED SE SE OF SEC 21-3-40W. TD = 33'

The undersigned hereby affirms that the drilling, completion and eventual plugging of this well will comply with K.S.A. 55-101, et. seq. It is agreed that the following minimum requirements will be met:

1. Notify the appropriate district office prior to spudding of and again before plugging well;
2. A copy of the approved notice of intent to drill shall be posted on each drilling rig;
3. The minimum amount of cathodic surface casing as specified below shall be set by grouting to the top.
4. An agreement between the operator and the district office on plugs and placement is necessary prior to plugging;
5. The appropriate district office will be notified before well is either plugged or casing is grouted in;
6. IN ALL CASES, NOTIFY DISTRICT OFFICE PRIOR TO ANY CEMENTING.

I hereby certify that the statements made herein are true and to the best of my knowledge and belief.

Date: 4-30-99 Signature of Operator or Agent: De Sultzer Title: CORROSION TECH.

FOR KCC USE:  
 API # 15- 023-203590000  
 Conductor pipe required NONE feet  
 Minimum cathodic surface casing required 60 feet (ALT 3)  
 Approved by: JK 5-6-99  
 This authorization expires: 11-6-99  
 (This authorization void if drilling not started within 6 months of effective date.)  
 Spud date: \_\_\_\_\_ Agent: \_\_\_\_\_

\*\* MAX. CATHODIC BOREHOLE DEPTH = 200'

RECEIVED STATE CORPORATION COMMISSION

MAY 05 1999  
5-3-99  
CONSERVATION DIVISION  
Wichita, Kansas

REMEMBER TO:

- File Drill Pit Application (form CDP-1) with Intent to Install;
- File Completion Form CB-2 within 30 days of spud date;
- Notify appropriate district office 48 hours prior to workover or re-entry;
- Submit plugging report (CB-4) within 30 days after plugging is completed.

Mail to: Conservation Division, 200 Colorado Derby Building, 202 W. First St., Wichita, Kansas 67202-1286.

21  
3  
MOT

cathodic borehole. Please show all the wells, existing cathodic boreholes, pipelines or facilities within 1/2 mile of the proposed borehole.

API NO. 15- \_\_\_\_\_  
 OPERATOR Midwest Energy, Inc.  
 LEASE N/A  
 WELL NUMBER N/A  
 FACILITY NAME St. Francis West

LOCATION OF WELL: COUNTY Cheyenne  
 \_\_\_\_\_ 175 feet from south/~~XXXX~~ line of section  
 \_\_\_\_\_ 312 feet from east/~~XXXX~~ line of section  
 SECTION 21 TWP 3 RG 40

SPOT: QTR/QTR/QTR/QTR OF ACREAGE  
SE - SE - SE - SE

IS SECTION X REGULAR or \_\_\_\_\_ IRREGULAR  
IF SECTION IS IRREGULAR, LOCATE WELL FROM NEAREST  
CORNER BOUNDARY.

Section corner used: \_\_\_\_\_ NE \_\_\_\_\_ NW X SE \_\_\_\_\_ SW

**PLAT**

(Show location of intended cathodic borehole.)

(Show footage from nearest lease, unit or outside section boundary line.)

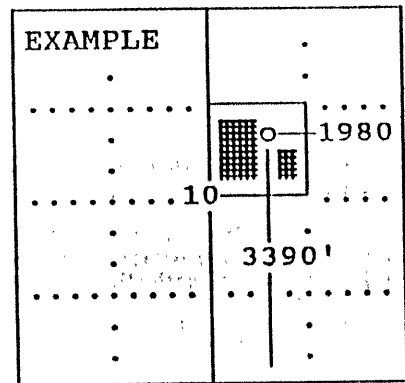
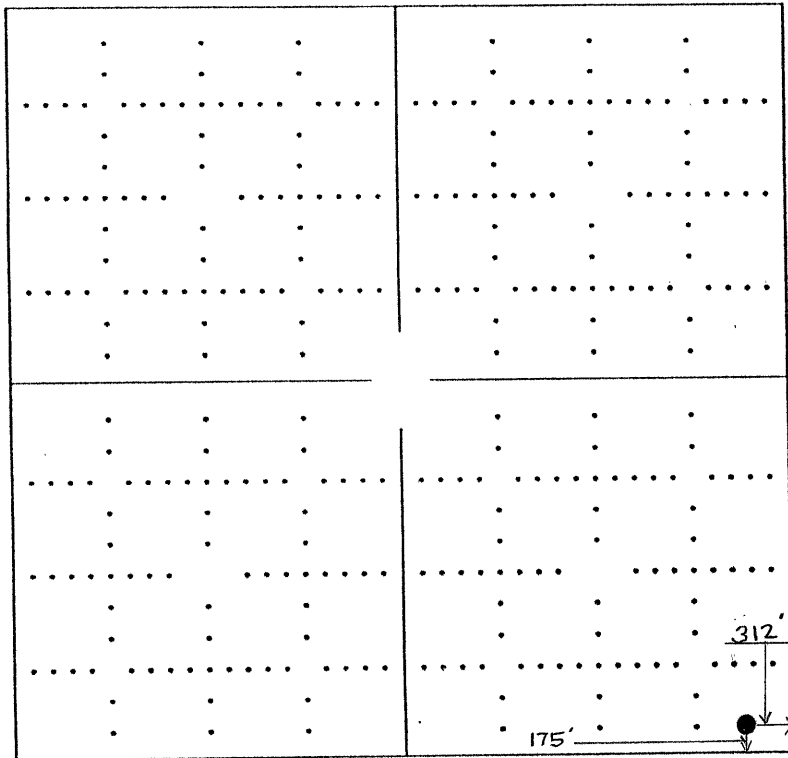

SEWARD CO.

In plotting the proposed location of the well, you must show:

- 1) The manner in which you are using the depicted plat by identifying section lines, i.e. 1 section, 1 section with 8 surrounding sections, 4 sections, etc.;
- 2) the distance of the proposed drilling location from the section's south/north and east/west; and
- 3) the distance to the nearest lease, unit or outside section boundary line.