

EFFECTIVE DATE:

State of Kansas

NOTICE OF INTENTION TO DRILL

Must be approved by the K.C.C. five (5) days prior to commencing well

Expected Spud Date May 1, 1991
month day year

APP
NW SW Sec 3. Twp 3. S, Rg 39 East West

OPERATOR: License # 03628
Name: Harvest Energy Company
Address: P.O. Box 620006
City/State/Zip: Littleton, CO 80162
Contact Person: Alan I. Nackerud
Phone: (303) 972-8750

2028 feet from South line of Section
est. 4584 feet from East line of Section
(Note: Locate well on Section Plat on Reverse Side)

CONTRACTOR: License #: to be announced
Name: to be announced

County: Cheyenne
Lease Name: Shay Well #: 2-3
Field Name: Bird City

Well Drilled For: Well Class: Type Equipment:
... Oil ... Inj Infield Mud Rotary
 Gas ... Storage ... Pool Ext. ... Air Rotary
... OWMO ... Disposal ... Wildcat ... Cable
... Seismic; ... # of Holes

Is this a Prorated Field? ... yes no
Target Formation(s): Niobrara (Beecher Island)
Nearest lease or unit boundary: 696'
Ground Surface Elevation: 3360 feet MSL

If OWMO: old well information as follows:
Operator: _____
Well Name: _____
Comp. Date: _____ Old Total Depth _____

Domestic well within 330 feet: ... yes no
Municipal well within one mile: ... yes no
Depth to bottom of fresh water: 150' 170'
Depth to bottom of usable water: 320' 200'
Surface Pipe by Alternate: 1 ... 2

Directional, Deviated or Horizontal wellbore? ... yes no
If yes, total depth location: _____

Length of Surface Pipe Planned to be set: 350'
Length of Conductor pipe required: _____
Projected Total Depth: 1,450'
Formation at Total Depth: Niobrara
Water Source for Drilling Operations: contractor
... well ... farm pond other
DWR Permit #: contractor to supply water
Will Cores Be Taken?: ... yes no
If yes, proposed zone: _____

AFFIDAVIT

The undersigned hereby affirms that the drilling, completion and eventual plugging of this well will comply with K.S.A. 55-101, et. seq.

- It is agreed that the following minimum requirements will be met:
1. The appropriate district office shall be notified before setting surface pipe;
 2. The minimum amount of surface pipe as specified above shall be set by circulating cement to the top; in all cases surface pipe shall be set through all unconsolidated materials plus a minimum of 20 feet into the underlying formation;
 3. If the well is dry, a plugging proposal shall be submitted to the district office. An agreement between the operator and the district office on plug length and placement is necessary prior to plugging;
 4. The appropriate district office will be notified before well is either plugged or production casing is cemented in;
 5. If an Alternate II completion, production pipe shall be cemented from below any usable water to surface within 120 days of spud date. In all cases, notify district office prior to any cementing.
- I hereby certify that the statements made herein are true and to the best of my knowledge and belief.

Date: 4/23/91 Signature of Operator or Agent: _____ Title: Owner

450
RECEIVED
STATE CORPORATION COMMISSION
APR 29 1991
CONSERVATION DIVISION
Wichita, Kansas
4-29-91

FOR KCC USE:
API # 15- 023-20,309-00-00
Conductor pipe required None feet
Minimum surface pipe required 250 feet per Alt. D
Approved by: MSY-29-91
EFFECTIVE DATE: 3-4-91
This authorization expires: 10-29-91
(This authorization void if drilling not started within 6 months of effective date.)
Spud date: _____ Agent: _____

W
3
39W

- REMEMBER TO:
- File Drill Pit Application (form CDP-1) with Intent to Drill;
 - File Completion Form ACO-1 within 120 days of spud date;
 - File acreage attribution plat according to field proration orders;
 - Notify appropriate district office 48 hours prior to workover or re-entry;
 - Submit plugging report (CP-4) after plugging is completed;
 - Obtain written approval before disposing or injecting salt water.

PLAT OF ACREAGE ATTRIBUTABLE TO A WELL

State Corporation Commission, Conservation Division
200 Colorado Derby Bldg. Wichita, Kansas 67202

OPERATOR Harvest Energy Company LOCATION OF WELL:
 LEASE Shay 2028 feet north of SE corner
 WELL NUMBER 2-3 est. 4584 feet west of SE corner
 FIELD Bird City NWSW Sec. 3 T 3S R 39 E/W
 COUNTY Cheyenne
 NO. OF ACRES ATTRIBUTABLE TO WELL 640 IS SECTION REGULAR x IRREGULAR?
 IF IRREGULAR, LOCATE WELL FROM NEAREST
 DESCRIPTION OF ACREAGE All of Sec. 3 CORNER BOUNDARY.

NOTE: If plat depicted is insufficient for your circumstances, you may attach your own scaled or surveyed plat. Survey plat enclosed.

PLAT

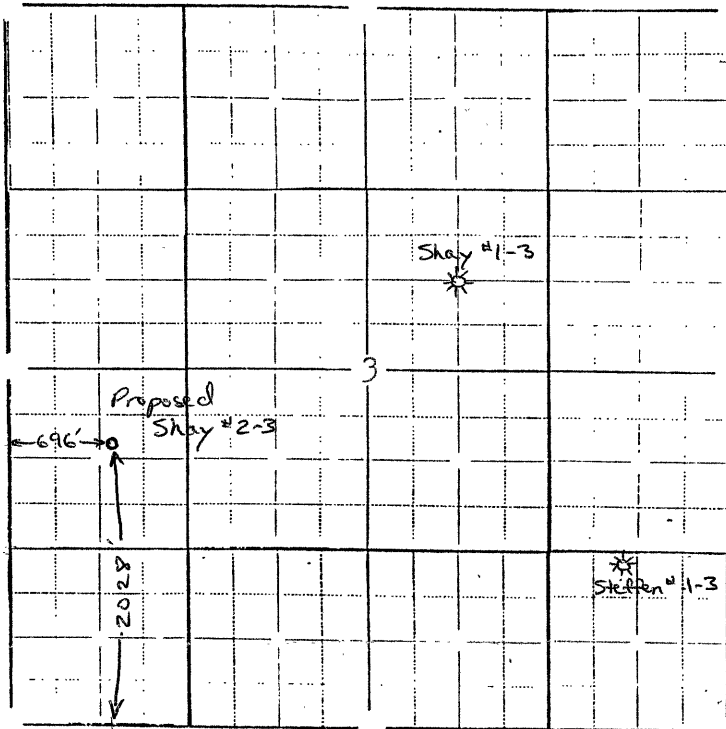

In plotting the proposed location of the well, you must show:

- 1) The manner in which you are using the depicted plat by identifying section lines, i.e. 1 section, 1 section with 8 surrounding partial sections, 4 sections, 16 sections, etc.;
- 2) the well's location relative to the location of other wells producing from the same common source of supply in adjoining drilling units, pursuant to K.A.R. 82-3-108, 82-3-207, 82-3-312, or special orders of the Commission;
- 3) the distance of the proposed drilling location from the section's east and south lines; and
- 4) the distance to the nearest lease or unit boundary line.

I hereby certify that the statements made herein are true and to the best of my knowledge and belief.

Signature of Operator or Agent *Allen Starbuck*

Date 4/23/91 Title Owner