

For K&C Use:
 Effective Date: 12-21-02
 District #: 4
 SGA? Yes No

KANSAS CORPORATION COMMISSION
 OIL & GAS CONSERVATION DIVISION

RECEIVED
 12-16-2002
 DEC 16 2002
 KCC WICHITA

Form C-1
 September 1999
 Form must be Typed
 Form must be Signed
 All blanks must be Filled

NOTICE OF INTENT TO DRILL

Must be approved by KCC five (5) days prior to commencing well

Ap 50's # 63' E of

Expected Spud Date December 30, 2002
 month day year

Spot East West
S/2 NW Sec. 2 Twp. 3 S. R. 42
2031 feet from X / (N) (circle one) Line of Section
1383 feet from Z / (W) (circle one) Line of Section
 Is SECTION Regular Irregular?

OPERATOR: License# 31609
 Name: Priority Oil & Gas LLC
 Address: PO Box 27798
 City/State/Zip: Denver, CO 80227-0798
 Contact Person: Robbie Gries
 Phone: 303-296-3435

(Note: Locate well on the Section Plat on reverse side)
 County: Cheyenne
 Lease Name: Raile Well #: 1-2
 Field Name: Cherry Creek
 Is this a Prorated / Spaced Field? Yes No
 Target Formation(s): Niobrara

CONTRACTOR: License# 8273
 Name: Excell Drilling Company

<u>Well Drilled For:</u>	<u>Well Class:</u>	<u>Type Equipment:</u>
<input type="checkbox"/> Oil	<input type="checkbox"/> Enh Rec	<input checked="" type="checkbox"/> Infield
<input checked="" type="checkbox"/> Gas	<input type="checkbox"/> Storage	<input checked="" type="checkbox"/> Mud Rotary
<input type="checkbox"/> OWWO	<input type="checkbox"/> Disposal	<input type="checkbox"/> Air Rotary
<input type="checkbox"/> Seismic;	<input type="checkbox"/> # of Holes	<input type="checkbox"/> Cable
<input type="checkbox"/> Other	<input type="checkbox"/> Other	

Nearest Lease or unit boundary: 613' fsl
 Ground Surface Elevation: 3734 feet MSL
 Water well within one-quarter mile: Yes No
 Public water supply well within one mile: Yes No
 Depth to bottom of fresh water: 150' 230
 Depth to bottom of usable water: 250' 294
 Surface Pipe by Alternate: X 1 2
 Length of Surface Pipe Planned to be set: 300' 350 MIN
 Length of Conductor Pipe required: NONE
 Projected Total Depth: 1896'
 Formation at Total Depth: Niobrara
 Water Source for Drilling Operations:
 Well Farm Pond X Other

If OWWO: old well information as follows:
 Operator: _____
 Well Name: _____
 Original Completion Date: _____ Original Total Depth: _____

Directional, Deviated or Horizontal wellbore? Yes No
 If Yes, true vertical depth: _____
 Bottom Hole Location: _____
 KCC DKT #: _____

(Note: Apply for Permit with DWR)
 Will Cores be taken? Yes No
 If Yes, proposed zone: _____

AFFIDAVIT

The undersigned hereby affirms that the drilling, completion and eventual plugging of this well will comply with K.S.A. 55-101, et. seq.
 It is agreed that the following minimum requirements will be met:

1. Notify the appropriate district office **prior** to spudding of well;
2. A copy of the approved notice of intent to drill **shall be** posted on each drilling rig;
3. The minimum amount of surface pipe as specified below **shall be set** by circulating cement to the top; in all cases surface pipe **shall be set** through all unconsolidated materials plus a minimum of 20 feet into the underlying formation.
4. If the well is dry hole, an agreement between the operator and the district office on plug length and placement is necessary **prior to plugging**;
5. The appropriate district office will be notified before well is either plugged or production casing is cemented in;
6. If an ALTERNATE II COMPLETION, production pipe shall be cemented from below any usable water to surface within **120 days** of spud date. **In all cases, NOTIFY district office** prior to any cementing.

I hereby certify that the statements made herein are true and to the best of my knowledge and belief.

Date: 12-13-02 Signature of Operator or Agent: _____ Title: Office Manager

For KCC Use ONLY
 API # 15 - 023-20448-00-00
 Conductor pipe required NONE feet
 Minimum surface pipe required 350 feet per Alt. 1
 Approved by: RJP 12-16-02
 This authorization expires: 6-16-03
 (This authorization void if drilling not started within 6 months of effective date.)
 Spud date: _____ Agent: _____

Remember to:

- File Drill Pit Application (form CDP-1) with Intent to Drill;
- File Completion Form ACO-1 within 120 days of spud date;
- File acreage attribution plat according to field proration orders;
- Notify appropriate district office 48 hours prior to workover or re-entry;
- Submit plugging report (CP-4) after plugging is completed;
- Obtain written approval before disposing or injecting salt water.

2
 3
 42W

RECEIVED

Side Two

DEC 16 2012

KCC WICHITA

IN ALL CASES PLOT THE INTENDED WELL ON THE PLAT BELOW

Plat of acreage attributable to a well in a prorated or spaced field

If the intended well is in a prorated or spaced field, please fully complete this side of the form. If the intended well is in a prorated or spaced field complete the plat below showing that the well will be properly located in relationship to other wells producing from the common source of supply. Please show all the wells and within 1 mile of the boundaries of the proposed acreage attribution unit for gas wells and within 1/2 mile of the boundaries of the proposed acreage attribution unit for oil wells.

API No. 15 - _____
Operator: _____
Lease: _____
Well Number: _____
Field: _____

Location of Well: County: Cheyenne
2031 _____ feet from S / (N) (circle one) Line of Section
1383 _____ feet from E / (W) (circle one) Line of Section
Sec. 2 Twp. 3 S. R. 42 East West

Number of Acres attributable to well: _____
QTR / QTR / QTR of acreage: SW - SE - NW

Is Section Regular or _____ Irregular

If Section is Irregular, locate well from nearest corner boundary.

Section corner used: ___ NE ___ NW ___ SE ___ SW

PLAT

*(Show location of the well and shade attributable acreage for prorated or spaced wells.)
(Show footage to the nearest lease or unit boundary line.)*

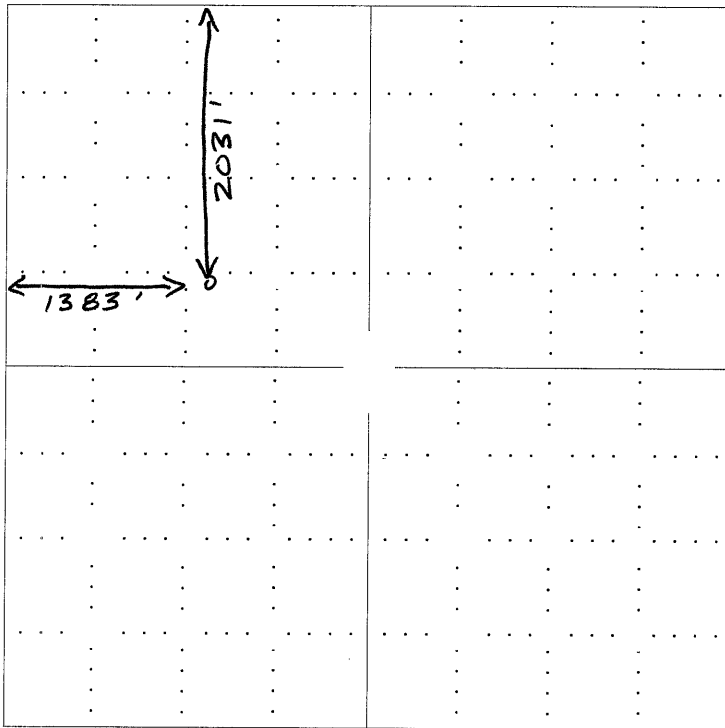

*1-2 Raik
2031' fnl
1383' fw
Elev. 3734 msl*

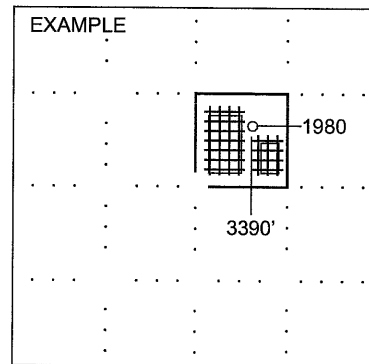

SEWARD CO.

NOTE: In all cases locate the spot of the proposed drilling locaton.

In plotting the proposed location of the well, you must show:

1. The manner in which you are using the depicted plat by identifying section lines, i.e. 1 section, 1 section with 8 surrounding sections, 4 sections, etc.
2. The distance of the proposed drilling location from the section's south / north and east / west.
3. The distance to the nearest lease or unit boundary line.
4. If proposed location is located within a prorated or spaced field a certificate of acreage attribution plat must be attached: (CO-7 for oil wells; CG-8 for gas wells).