

OWWO

For KCC Use:

Effective Date: 9-15-04District # 4SGA? ☒ Yes ☐ NoKANSAS CORPORATION COMMISSION
OIL & GAS CONSERVATION DIVISION

NOTICE OF INTENT TO DRILL

Must be approved by KCC five (5) days prior to commencing well

Form C-1

December 2002

Form must be Typed

Form must be Signed

All blanks must be Filled

Expected Spud Date 11 01 2004
month day yearOPERATOR: License# 31714
Name: Novy Oil & Gas, Inc.
Address: 125 N. Market, Suite 1230
City/State/Zip: Wichita, KS 67202
Contact Person: Michael Novy
Phone: 316-265-4651CONTRACTOR: License# 5892
Name: Berentz Drilling Company

Well Drilled For:	Well Class:	Type Equipment:
<input type="checkbox"/> Oil	<input type="checkbox"/> Enh Rec	<input checked="" type="checkbox"/> Infield
<input type="checkbox"/> Gas	<input type="checkbox"/> Storage	<input type="checkbox"/> Pool Ext.
<input checked="" type="checkbox"/> OWWO	<input type="checkbox"/> Disposal	<input type="checkbox"/> Wildcat
<input type="checkbox"/> Seismic; # of Holes	<input type="checkbox"/> Other	<input type="checkbox"/> Cable
<input type="checkbox"/> Other		

If OWWO: old well information as follows:

Operator: Sinclair Prairie Oil
Well Name: M. Isern
Original Completion Date: 10-12-36 Original Total Depth: 3297'Directional, Deviated or Horizontal wellbore? ☐ Yes ☒ No

If Yes, true vertical depth: _____

Bottom Hole Location: _____

KCC DKT #: _____

* 200' 13" Cond. Pipe set

Spot SE - SW - SW Sec. 25 Twp. 19 S. R. 11 ☐ East ☐ West330 feet from ☐ N / ☐ S Line of Section990 feet from ☐ E / ☐ W Line of Section

Is SECTION _____ Regular _____ Irregular?

(Note: Locate well on the Section Plat on reverse side)

County: BartonLease Name: Isern Well #: 4Field Name: Kraft Bruce Pool Chase SilicaIs this a Prorated / Spaced Field? ☐ Yes ☒ NoTarget Information(s): ArbuckleNearest Lease or unit boundary: 330'Ground Surface Elevation: 1765 feet MSLWater well within one-quarter mile: ☒ Yes ☐ NoPublic water supply well within one mile: ☐ Yes ☒ NoDepth to bottom of fresh water: 90'Depth to bottom of usable water: 230'Surface Pipe by Alternate: ☒ 1 ☐ 2Length of Surface Pipe Planned to be set: 200' 8 5/8" in hole 250' min* Length of Conductor Pipe required: none 200' set (13")Projected Total Depth: 3297'Formation at Total Depth: Arbuckle

Water Source for Drilling Operations:

☐ Well ☐ Farm Pond ☐ Other Truck

DWR Permit #: _____

(Note: Apply for Permit with DWR ☐)Will Cores be taken? ☐ Yes ☒ No

If Yes, proposed zone: _____

AFFIDAVIT

The undersigned hereby affirms that the drilling, completion and eventual plugging of this well will comply with K.S.A. 55 et. seq.

It is agreed that the following minimum requirements will be met:

1. Notify the appropriate district office **prior** to spudding of well;
2. A copy of the approved notice of intent to drill **shall be** posted on each drilling rig;
3. The minimum amount of surface pipe as specified below **shall be set** by circulating cement to the top; in all cases surface pipe **shall be set** through all unconsolidated materials plus a minimum of 20 feet into the underlying formation.
4. If the well is dry hole, an agreement between the operator and the district office on plug length and placement is necessary **prior to plugging**;
5. The appropriate district office will be notified before well is either plugged or production casing is cemented in;
6. If an ALTERNATE II COMPLETION, production pipe shall be cemented from below any usable water to surface within **120 days** of spud date. Or pursuant to Appendix "B" - Eastern Kansas surface casing order #133,891-C, which applies to the KCC District 3 area, alternate II cementing must be completed within 30 days of the spud date or the well shall be plugged. **In all cases, NOTIFY district office** prior to any cementing.

I hereby certify that the statements made herein are true and to the best of my knowledge and belief.

Date: 09/08/04 Signature of Operator or Agent: Michael E. Novy Title: Vice PresidentRECEIVED
SEP 09 2004
KCC WICHITA

For KCC Use ONLY

API # 15 - 009-14928-00-01Conductor pipe required 200' set feetMinimum surface pipe required 250' feet per Alt. 1Approved by: RJP 9-10-04This authorization expires: 3-10-05

(This authorization void if drilling not started within 6 months of effective date.)

Spud date: _____ Agent: _____

Remember to:

- File Drill Pit Application (form CDP-1) with Intent to Drill;
- File Completion Form ACO-1 within 120 days of spud date;
- File acreage attribution plat according to field proration orders;
- Notify appropriate district office 48 hours prior to workover or re-entry;
- Submit plugging report (CP-4) after plugging is completed;
- Obtain written approval before disposing or injecting salt water.

☐ Well Not Drilled - Permit Expired

Signature of Operator or Agent: _____

Date: _____

Mail to: KCC - Conservation Division, 130 S. Market - Room 2078, Wichita, Kansas 67202

25
19
11
3

IN ALL CASES PLOT THE INTENDED WELL ON THE PLAT BELOW*Plat of acreage attributable to a well in a prorated or spaced field*

If the intended well is in a prorated or spaced field, please fully complete this side of the form. If the intended well is in a prorated or spaced field complete the plat below showing that the well will be properly located in relationship to other wells producing from the common source of supply. Please show all the wells and within 1 mile of the boundaries of the proposed acreage attribution unit for gas wells and within 1/2 mile of the boundaries of the proposed acreage attribution unit for oil wells.

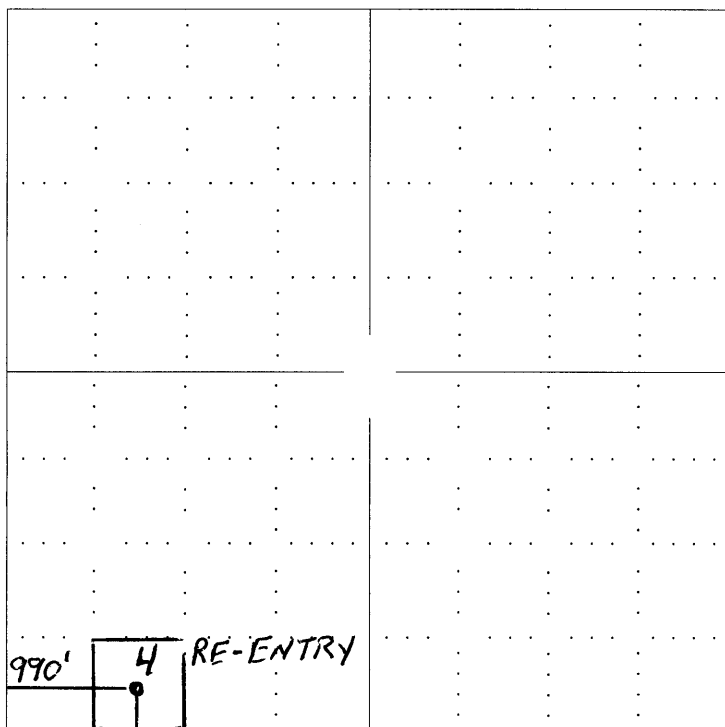
API No. 15 - N.A.Operator: Novy Oil & Gas, Inc.Lease: IsernWell Number: 4Field: ~~Kraft Prusa Pool~~ Chase SilicaNumber of Acres attributable to well: 10QTR / QTR / QTR of acreage: SE - SW - SWLocation of Well: County: Barton330 feet from ☐ N / ☒ S Line of Section990 feet from ☐ E / ☒ W Line of SectionSec. 25 Twp. 19 S. R. 11 ☐ East ☒ WestIs Section: ☒ Regular or ☐ Irregular**If Section is Irregular, locate well from nearest corner boundary.**Section corner used: ☐ NE ☐ NW ☐ SE ☐ SW**PLAT***(Show location of the well and shade attributable acreage for prorated or spaced wells.)**(Show footage to the nearest lease or unit boundary line.)***NOTE: In all cases locate the spot of the proposed drilling location.**

330'

In plotting the proposed location of the well, you must show:

1. The manner in which you are using the depicted plat by identifying section lines, i.e. 1 section, 1 section with 8 surrounding sections, 4 sections, etc.
2. The distance of the proposed drilling location from the section's south / north and east / west.
3. The distance to the nearest lease or unit boundary line.
4. If proposed location is located within a prorated or spaced field a certificate of acreage attribution plat must be attached: (C0-7 for oil wells; CG-8 for gas wells).

RECEIVED
SEP 09 2004
KCC WICHITA

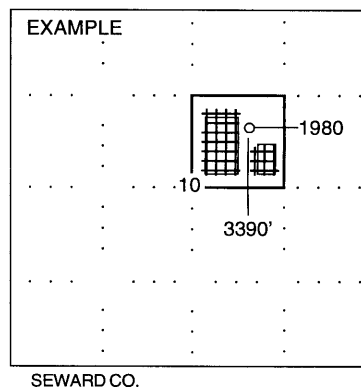

KANSAS

CORPORATION COMMISSION

KATHLEEN SEBELIUS, GOVERNOR

BRIAN J. MOLINE, CHAIR

ROBERT E. KREHBIEL, COMMISSIONER

MICHAEL C. MOFFET, COMMISSIONER

September 10, 2004

Mr. Michael Novy
Novy Oil & Gas, Inc.
125 N. Market Ste 1230
Wichita, KS 67202

RE: Drilling Pit Application
Isern Lease Well No. 4
SW/4 Sec. 25-19S-11W
Barton County, Kansas

Dear Mr. Novy:

District staff has inspected the above referenced location and has determined that the reserve pit shall be constructed **without slots**, the bottom shall be flat and reasonably level, and the free fluids must be removed. The fluids are to be removed from the reserve pit as soon as practical after drilling operations have ceased.

If production casing is set all completion fluids shall be removed on a daily basis.

The fluids should be taken to an authorized disposal well. Please call the District Office at (785) 625-0550 when the fluids have been removed. Also, please file the enclosed CDP-5 form, Surface Pond Waste Transfer, within 30 days of fluid removal.

A copy of this letter should be posted in the doghouse along with the approved Intent to Drill. If you have any questions or concerns please feel free to contact the undersigned at the above address.

Sincerely,



Kathy Haynes
Environmental Protection and Remediation Department

cc: H Deines