

For KCC Use: 8-23-04
Effective Date: 4
District #
SGA? Yes No

KANSAS CORPORATION COMMISSION
OIL & GAS CONSERVATION DIVISION

FIRST
CORRECTED

Form C-1
December 2002

Form must be Typed
Form must be Signed
All blanks must be Filled

NOTICE OF INTENT TO DRILL

Must be approved by KCC five (5) days prior to commencing well

Expected Spud Date September 7 2004
month day year

OPERATOR: License# KLN 4767
Name: Ritchie Explorations, Inc.
Address: P.O. Box 783188
City/State/Zip: Wichita, Kansas 67278-3188
Contact Person: Craig Caulk
Phone: (316) 691-9500

CONTRACTOR: License# KLN 5929
Name: Duke Drilling

Spot C E/2 SE Sec. 18 Twp. 20 S. R. 11
1320 feet from N / S Line of Section
660 feet from E / W Line of Section
Is SECTION Regular Irregular?

(Note: Locate well on the Section Plat on reverse side)

County: Barton
Lease Name: Kowalsky B/P Well #: 8
Field Name: Chase - Silica

Is this a Prorated / Spaced Field? Yes No

Target Formation(s): Lansing / Arbuckle

Nearest Lease or unit boundary: 660'

Ground Surface Elevation: 1780 feet MSL

Water well within one-quarter mile: Yes No

Public water supply well within one mile: Yes No

Depth to bottom of fresh water: 180'

Depth to bottom of usable water: 230'

Surface Pipe by Alternate: 1 2

Length of Surface Pipe Planned to be set: 250' of 8 5/8"

Length of Conductor Pipe required: NONE

Projected Total Depth: 3300'

Formation at Total Depth: Arbuckle

Water Source for Drilling Operations:

Well Farm Pond Other X

DWR Permit #:

(Note: Apply for Permit with DWR)

Will Cores be taken? Yes No

If Yes, proposed zone:

Well Drilled For: Well Class: Type Equipment:

Oil Enh Rec Infield Mud Rotary
 Gas Storage Pool Ext. Air Rotary
 OWD Disposal Wildcat Cable
 Seismic; # of Holes Other
 Other

If OWWO: old well information as follows:

Operator:

Well Name:

Original Completion Date: Original Total Depth:

Directional, Deviated or Horizontal wellbore? Yes No

If Yes, true vertical depth:

Bottom Hole Location:

KCC DKT #:

*WAS: KOWALSKY P
IS: KOWALSKY B/P

AFFIDAVIT

The undersigned hereby affirms that the drilling, completion and eventual plugging of this well will comply with K.S.A. 55 et. seq.
It is agreed that the following minimum requirements will be met:

1. Notify the appropriate district office **prior** to spudding of well;
2. A copy of the approved notice of intent to drill **shall be posted** on each drilling rig;
3. The minimum amount of surface pipe as specified below **shall be set** by circulating cement to the top; in all cases surface pipe **shall be set** through all unconsolidated materials plus a minimum of 20 feet into the underlying formation.
4. If the well is dry hole, an agreement between the operator and the district office on plug length and placement is necessary **prior to plugging**;
5. The appropriate district office will be notified before well is either plugged or production casing is cemented in;
6. If an ALTERNATE II COMPLETION, production pipe shall be cemented from below any usable water to surface within **120 days** of spud date.
Or pursuant to Appendix "B" - Eastern Kansas surface casing order #133,891-C, which applies to the KCC District 3 area, alternate II cementing must be completed within 30 days of the spud date or the well shall be plugged. **In all cases, NOTIFY district office** prior to any cementing.

I hereby certify that the statements made herein are true and to the best of my knowledge and belief.

Date: September 7, 2004 Signature of Operator or Agent: Title: GIS Specialist/ Geological Technician

For KCC Use ONLY

API # 15 - 009-24802-00-00

Conductor pipe required NONE feet

Minimum surface pipe required 250 feet per Alt. 1

Approved by: RJP 8.18.04 / RJP 9.8.04

This authorization expires: 2.18.05

(This authorization void if drilling not started within 6 months of effective date.)

Spud date: Agent:

Remember to:

- File Drill Pit Application (form CDP-1) with Intent to Drill;
- File Completion Form ACO-1 within 120 days of spud date;
- File acreage attribution plat according to field proration orders;
- Notify appropriate district office 48 hours prior to workover or re-entry;
- Submit plugging report (CP-4) after plugging is completed;
- Obtain written approval before disposing or injecting salt water.
- If this permit has expired (See: authorized expiration date) please check the box below and return to the address below.

Well Not Drilled - Permit Expired

Signature of Operator or Agent:

Date:

RECEIVED
SEP 08 2004
KCC WICHITA

18
20
11W

IN ALL CASES PLOT THE INTENDED WELL ON THE PLAT BELOW

Plat of acreage attributable to a well in a prorated or spaced field

If the intended well is in a prorated or spaced field, please fully complete this side of the form. If the intended well is in a prorated or spaced field complete the plat below showing that the well will be properly located in relationship to other wells producing from the common source of supply. Please show all the wells and within 1 mile of the boundaries of the proposed acreage attribution unit for gas wells and within 1/2 mile of the boundaries of the proposed acreage attribution unit for oil wells.

API No. 15 - 009.24802.00-00
Operator: Ritchie Explortation, Inc.
Lease: Kowalsky B/P
Well Number: 8
Field: Chase - Silica

Number of Acres attributable to well: _____
QTR / QTR / QTR of acreage: C - E/2 - SE

Location of Well: County: Barton
1320 feet from N / S Line of Section
660 feet from E / W Line of Section
Sec. 18 Twp. 20 S. R. 11 East West

Is Section: Regular or Irregular

If Section is Irregular, locate well from nearest corner boundary.
Section corner used: NE NW SE SW

CORRECTED

PLAT

(Show location of the well and shade attributable acreage for prorated or spaced wells.)
(Show footage to the nearest lease or unit boundary line.)

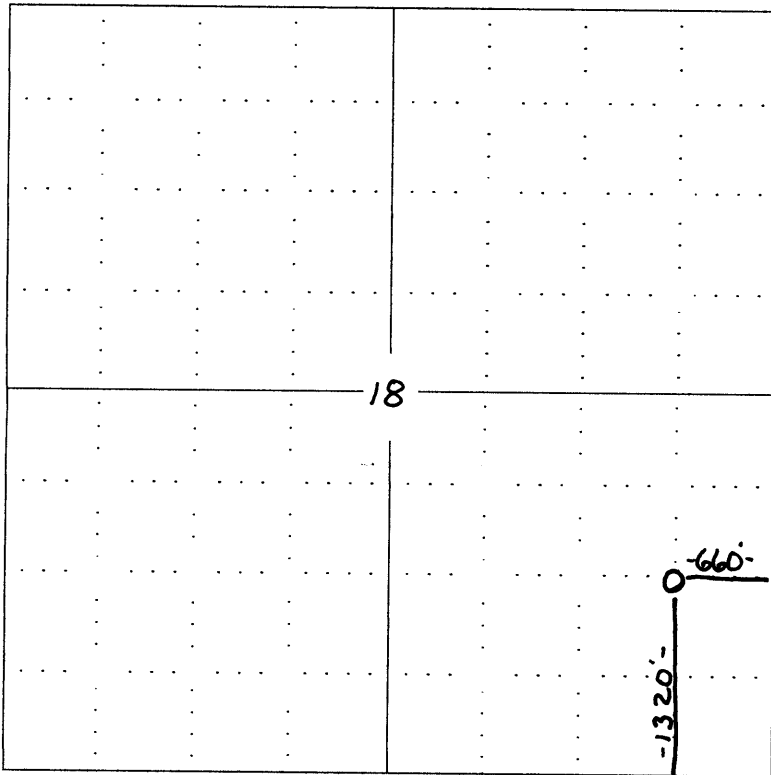

RECEIVED
SEP 08 2004
KCC WICHITA

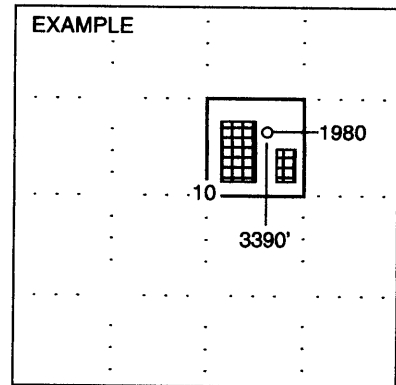

NOTE: In all cases locate the spot of the proposed drilling locaton.

In plotting the proposed location of the well, you must show:

1. The manner in which you are using the depicted plat by identifying section lines, i.e. 1 section, 1 section with 8 surrounding sections, 4 sections, etc.
2. The distance of the proposed drilling location from the section's south / north and east / west.
3. The distance to the nearest lease or unit boundary line.
4. If proposed location is located within a prorated or spaced field a certificate of acreage attribution plat must be attached: (CO-7 for oil wells: