

For KCC Use:
Effective Date: 10-30-04
District #: 3
SGA? Yes No

KANSAS CORPORATION COMMISSION
OIL & GAS CONSERVATION DIVISION
NOTICE OF INTENT TO DRILL

Form C-1
December 2002
Form must be Typed
Form must be Signed
All blanks must be Filled

Must be approved by KCC five (5) days prior to commencing well

Expected Spud Date October 30, 2004
month day year

Spot Adiso'e of
nw ne Sec. 25 Twp. 29 S. R. 16
660 feet from N / S Line of Section
1830 feet from E / W Line of Section
Is SECTION Regular Irregular?

OPERATOR: License# 33344
Name: Quest Cherokee, LLC
Address: P. O. Box 100
City/State/Zip: Benedict, Ks 66714
Contact Person: Doug Lamb
Phone: 620-698-2250

(Note: Locate well on the Section Plat on reverse side)
County: Wilson
Lease Name: Stephens Trust Well #: 25-1
Field Name: Cherokee Basin CBM

CONTRACTOR: License# Will be licensed by KCC
Name: Will Advise on ACO -1

Is this a Prorated / Spaced Field? Yes No
Target Information(s): Arbuckle Dolomite

Well Drilled For: Oil Gas OWWO Seismic; # of Holes Other
Well Class: Enh Rec Storage Disposal Infield Pool Ext Wildcat Other
Type Equipment: Mud Rotary Air Rotary Cable

Nearest Lease or unit boundary: 510
Ground Surface Elevation: 860 feet MSL
Water well within one-quarter mile: Yes No

If OWWO: old well information as follows:
Operator:
Well Name:
Original Completion Date: Original Total Depth:

Public water supply well within one mile: Yes No
Depth to bottom of fresh water: 100 +
Depth to bottom of usable water: 200 +

Directional, Deviated or Horizontal wellbore? Yes No
If Yes, true vertical depth:
Bottom Hole Location:
KCC DKT #:

Surface Pipe by Alternate: 1 2
Length of Surface Pipe Planned to be set: 25
Length of Conductor Pipe required: NONE

Projected Total Depth: 1500
Formation at Total Depth: Arbuckle Dolomite
Water Source for Drilling Operations: Well Farm Pond Other Air

DWR Permit #:
(Note: Apply for Permit with DWR)
Will Cores be taken? Yes No
If Yes, proposed zone:

AFFIDAVIT

The undersigned hereby affirms that the drilling, completion and eventual plugging of this well will comply with K.S.A. 55-81-900.
It is agreed that the following minimum requirements will be met:

RECEIVED
KANSAS CORPORATION COMMISSION
OCT 25 2004
CONSERVATION DIVISION
WICHITA, KS

- 1. Notify the appropriate district office prior to spudding of well;
2. A copy of the approved notice of intent to drill shall be posted on each drilling rig;
3. The minimum amount of surface pipe as specified below shall be set by circulating cement to the top; in all cases, surface pipe shall be set through all unconsolidated materials plus a minimum of 20 feet into the underlying formation.
4. If the well is dry hole, an agreement between the operator and the district office on plug length and placement is necessary prior to plugging;
5. The appropriate district office will be notified before well is either plugged or production casing is cemented in;
6. If an ALTERNATE II COMPLETION, production pipe shall be cemented from below any usable water to surface within 120 days of spud date.
Or pursuant to Appendix "B" - Eastern Kansas surface casing order #133,891-C, which applies to the KCC District 3 area, alternate II cementing must be completed within 30 days of the spud date or the well shall be plugged. In all cases, NOTIFY district office prior to any cementing.

I hereby certify that the statements made herein are true and to the best of my knowledge and belief.

Date: 10/22/04 Signature of Operator or Agent: Richard Marlow Title: Engineering Manager

For KCC Use ONLY
API # 15 - 205-25900-0000
Conductor pipe required NONE feet
Minimum surface pipe required 20 feet per Alt. 1 2
Approved by: RTR 10-25-04
This authorization expires: 4-25-05
(This authorization void if drilling not started within 6 months of effective date.)
Spud date: Agent:

Remember to:

- File Drill Pit Application (form CDP-1) with Intent to Drill;
- File Completion Form ACO-1 within 120 days of spud date;
- File acreage attribution plat according to field proration orders;
- Notify appropriate district office 48 hours prior to workover or re-entry;
- Submit plugging report (CP-4) after plugging is completed;
- Obtain written approval before disposing or injecting salt water.
- If this permit has expired (See: authorized expiration date) please check the box below and return to the address below.

Well Not Drilled - Permit Expired
Signature of Operator or Agent:
Date:

Mail to: KCC - Conservation Division, 130 S. Market - Room 2078, Wichita, Kansas 67202

25
29
16E

IN ALL CASES PLOT THE INTENDED WELL ON THE PLAT BELOW

Plat of acreage attributable to a well in a prorated or spaced field

If the intended well is in a prorated or spaced field, please fully complete this side of the form. If the intended well is in a prorated or spaced field complete the plat below showing that the well will be properly located in relationship to other wells producing from the common source of supply. Please show all the wells and within 1 mile of the boundaries of the proposed acreage attribution unit for gas wells and within 1/2 mile of the boundaries of the proposed acreage attribution unit for oil wells.

API No. 15 - _____
 Operator: Quest Cherokee, LLC
 Lease: Stephens Trust
 Well Number: 25-1
 Field: Cherokee Basin CBM
 Number of Acres attributable to well: 40
 QTR / QTR / QTR of acreage: _____ - nw - ne

Location of Well: County: Wilson
660 feet from N / S Line of Section
1830 feet from E / W Line of Section
 Sec. 25 Twp. 29 S. R. 16 East West

Is Section: Regular or Irregular

If Section is Irregular, locate well from nearest corner boundary.

Section corner used: NE NW SE SW

PLAT

*(Show location of the well and shade attributable acreage for prorated or spaced wells.)
 (Show footage to the nearest lease or unit boundary line.)*

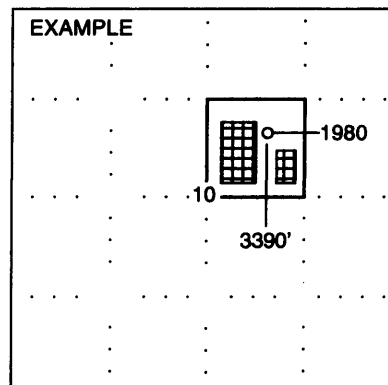
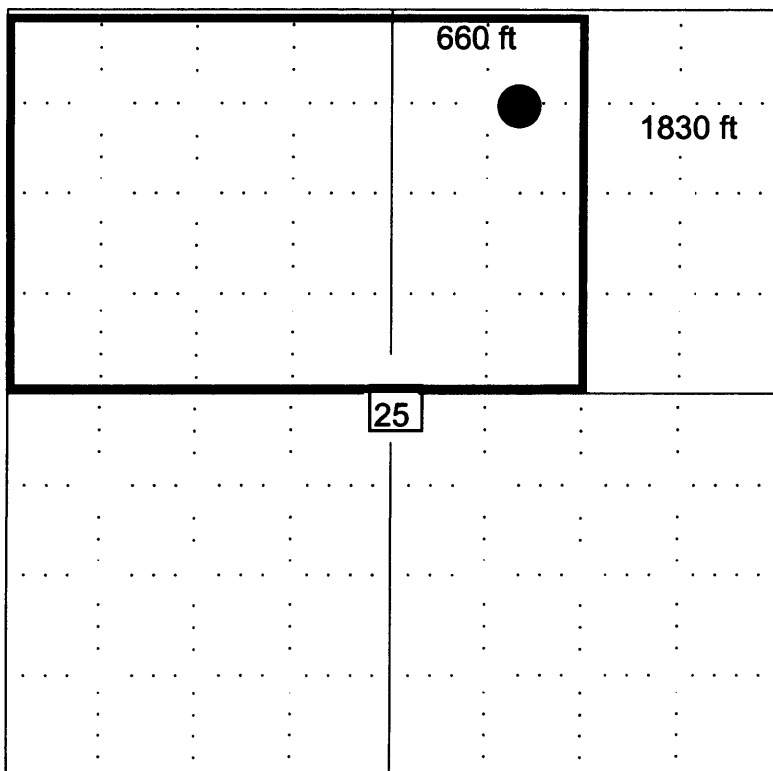

SEWARD CO.

NOTE: In all cases locate the spot of the proposed drilling location.

In plotting the proposed location of the well, you must show:

1. The manner in which you are using the depicted plat by identifying section lines, i.e. 1 section, 1 section with 8 surrounding sections, 4 sections, etc.
2. The distance of the proposed drilling location from the section's south / north and east / west.
3. The distance to the nearest lease or unit boundary line.
4. If proposed location is located within a prorated or spaced field a certificate of acreage attribution plat must be attached: (CO-7 for oil wells; CG-8 for gas wells).