

For KCC Use: 10-12-04  
Effective Date: \_\_\_\_\_  
District #: 1  
SGA?  Yes  No

KANSAS CORPORATION COMMISSION  
OIL & GAS CONSERVATION DIVISION

NOTICE OF INTENT TO DRILL

Must be approved by KCC five (5) days prior to commencing well

Form C-1  
September 1999  
Form must be Typed  
Form must be Signed  
All blanks must be Filled

Expected Spud Date October 13 2004  
month day year

Spot C - SW - SW Sec. 30 Twp. 26 S. R. 16  East  West

OPERATOR: License# 5004  
Name: Vincent Oil Corporation  
Address: 125 N. Market, Suite 1075  
City/State/Zip: Wichita, Kansas 67202  
Contact Person: Rick Hiebsch  
Phone: 316-262-3573

660 feet from S / N (circle one) Line of Section  
660 feet from E / W (circle one) Line of Section  
Is SECTION  Regular  Irregular?

(Note: Locate well on the Section Plat on reverse side)

CONTRACTOR: License# 4958  
Name: Mallard JV, Inc.

County: Edwards  
Lease Name: Thompson Well #: 4  
Field Name: Trousdale West ext.

Is this a Prorated / Spaced Field?  Yes  No

Target Formation(s): Kinderhook

Nearest Lease or unit boundary: 660 ft.

Ground Surface Elevation: 2106 feet MSL

Water well within one-quarter mile:  Yes  No

Public water supply well within one mile:  Yes  No

Depth to bottom of fresh water: 280 ft. 340

Depth to bottom of usable water: 340 ft. 360

Surface Pipe by Alternate: X 1 2

Length of Surface Pipe Planned to be set: 400 ft.

Length of Conductor Pipe required: none

Projected Total Depth: 4700 ft.

Formation at Total Depth: Kinderhook Sand

Water Source for Drilling Operations:

Well X Farm Pond \_\_\_\_\_ Other \_\_\_\_\_

DWR Permit #: 20040220

(Note: Apply for Permit with DWR )

Will Cores be taken?  Yes  No

If Yes, proposed zone: \_\_\_\_\_

Well Drilled For:  Oil  Enh Rec  Infield  Mud Rotary  
 Gas  Storage  Pool Ext.  Air Rotary  
 OWWO  Disposal  Wildcat  Cable  
 Seismic; # of Holes \_\_\_\_\_  Other \_\_\_\_\_  
 Other \_\_\_\_\_

If OWWO: old well information as follows:  
Operator: \_\_\_\_\_  
Well Name: \_\_\_\_\_  
Original Completion Date: \_\_\_\_\_ Original Total Depth: \_\_\_\_\_

Directional, Deviated or Horizontal wellbore?  Yes  No

If Yes, true vertical depth: \_\_\_\_\_

Bottom Hole Location: \_\_\_\_\_

KCC DKT #: \_\_\_\_\_

AFFIDAVIT

The undersigned hereby affirms that the drilling, completion and eventual plugging of this well will comply with K.S.A. 55-101, et. seq.  
It is agreed that the following minimum requirements will be met:

1. Notify the appropriate district office **prior** to spudding of well;
2. A copy of the approved notice of intent to drill **shall be posted** on each drilling rig;
3. The minimum amount of surface pipe as specified below **shall be set** by circulating cement to the top; in all cases surface pipe **shall be set** through all unconsolidated materials plus a minimum of 20 feet into the underlying formation.
4. If the well is dry hole, an agreement between the operator and the district office on plug length and placement is necessary **prior to plugging**;
5. The appropriate district office will be notified before well is either plugged or production casing is cemented in;
6. If an ALTERNATE II COMPLETION, production pipe shall be cemented from below any usable water to surface within **120 days** of spud date. **In all cases, NOTIFY district office** prior to any cementing.

I hereby certify that the statements made herein are true and to the best of my knowledge and belief.

Date: 10-04-04 Signature of Operator or Agent: Richard H. Diebel Title: President

For KCC Use ONLY  
API # 15 - 047-21498-00-00  
Conductor pipe required NONE feet  
Minimum surface pipe required 380 feet per Alt. 1  
Approved by: RJP 10-7-04  
This authorization expires: 4-7-05  
(This authorization void if drilling not started within 6 months of effective date.)  
Spud date: \_\_\_\_\_ Agent: \_\_\_\_\_

Remember to:

- File Drill Pit Application (form CDP-1) with Intent to Drill;
- File Completion Form ACO-1 within 120 days of spud date;
- File acreage attribution plat according to field proration orders;
- Notify appropriate district office 48 hours prior to workover or re-entry;
- Submit plugging report (CP-4) after plugging is completed;
- Obtain written approval before disposing or injecting salt water.

Mail to: KCC - Conservation Division, 130 S. Market - Room 2078, Wichita, Kansas 67202

30 26 Low

## IN ALL CASES PLOT THE INTENDED WELL ON THE PLAT BELOW

*Plat of acreage attributable to a well in a prorated or spaced field*

**If the intended well is in a prorated or spaced field, please fully complete this side of the form.** If the intended well is in a prorated or spaced field complete the plat below showing that the well will be properly located in relationship to other wells producing from the common source of supply. Please show all the wells and within 1 mile of the boundaries of the proposed acreage attribution unit for gas wells and within 1/2 mile of the boundaries of the proposed acreage attribution unit for oil wells.

API No. 15 - \_\_\_\_\_  
 Operator: \_\_\_\_\_  
 Lease: \_\_\_\_\_  
 Well Number: \_\_\_\_\_  
 Field: \_\_\_\_\_  
 Number of Acres attributable to well: \_\_\_\_\_  
 QTR / QTR / QTR of acreage: \_\_\_\_\_ - SW - SW

Location of Well: County: Edwards  
 \_\_\_\_\_ 660 \_\_\_\_\_ feet from (S) / N (circle one) Line of Section  
 \_\_\_\_\_ 660 \_\_\_\_\_ feet from E (W) (circle one) Line of Section  
 Sec. 30 Twp. 26 S. R. 16  East  West

Is Section  Regular or \_\_\_\_\_ Irregular

**If Section is Irregular, locate well from nearest corner boundary.**

Section corner used: \_\_\_NE \_\_\_NW \_\_\_SE \_\_\_SW

### PLAT

(Show location of the well and shade attributable acreage for prorated or spaced wells.)  
 (Show footage to the nearest lease or unit boundary line.)

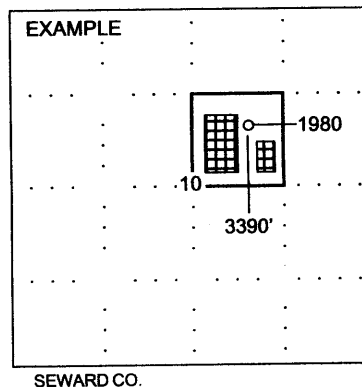
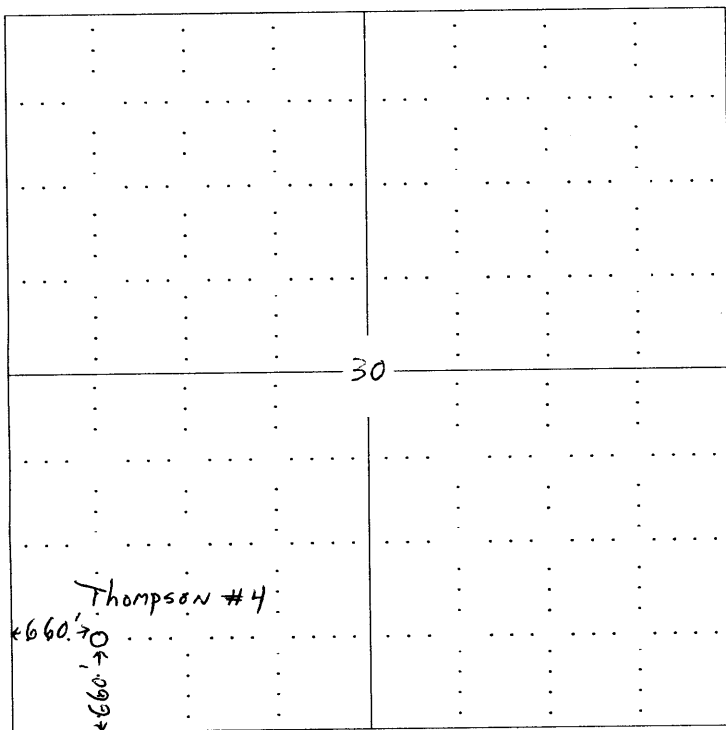

**NOTE: In all cases locate the spot of the proposed drilling location.**

**In plotting the proposed location of the well, you must show:**

1. The manner in which you are using the depicted plat by identifying section lines, i.e. 1 section, 1 section with 8 surrounding sections, 4 sections, etc.
2. The distance of the proposed drilling location from the section's south / north and east / west.
3. The distance to the nearest lease or unit boundary line.
4. If proposed location is located within a prorated or spaced field a certificate of acreage attribution plat must be attached: (C0-7 for oil wells; CG-8 for gas wells).

# KANSAS

CORPORATION COMMISSION

KATHLEEN SEBELIUS, GOVERNOR  
BRIAN J. MOLINE, CHAIR  
ROBERT E. KREHBIEL, COMMISSIONER  
MICHAEL C. MOFFET, COMMISSIONER

October 6, 2004

Mr. Rick Hiebsch  
Vincent Oil Corporation  
125 N. Market Ste 1075  
Wichita, KS 67202

RE: Drilling Pit Application  
Thompson Lease Well No. 4  
SW/4 Sec. 30-26S-16W  
Edwards County, Kansas

Dear Mr. Hiebsch:

District staff has inspected the above referenced location and has determined that the reserve pit shall be constructed **without slots**, the bottom shall be flat and reasonably level, and the free fluids must be removed. The fluids are to be removed from the reserve pit as soon as the Hutchinson Salt section has been drilled through and displacement of the fluids into the reserve pit has occurred. The fluids should be removed again as soon as practical after drilling operations have ceased.

**If production casing is set all completion fluids shall be removed on a daily basis.**

The fluids should be taken to an authorized disposal well. Please call the District Office at (620) 225-8888 when the fluids have been removed. Also please file the enclosed CDP-5 form, Surface Pond Waste Transfer, within 30 days of fluid removal.

**A copy of this letter should be posted in the doghouse along with the approved Intent to Drill.**

If you have any questions or concerns please feel free to contact the undersigned at the above address.

Sincerely,



Kathy Haynes  
Environmental Protection and Remediation Department

cc: S Durrant