

For KCC Use: 11-21-2004
Effective Date: 11-21-2004
District # 3
SGA? Yes No

KANSAS CORPORATION COMMISSION
OIL & GAS CONSERVATION DIVISION
NOTICE OF INTENT TO DRILL

Form C-1
December 2002
Form must be Typed
Form must be Signed
All blanks must be Filled

Must be approved by KCC five (5) days prior to commencing well

Expected Spud Date November 13, 2004
month day year

Spot NW - NE - SW Sec. 28 Twp. 21 S. R. 14 East West
354 2994 feet from N / S Line of Section
1615 feet from E / W Line of Section
Is SECTION Regular Irregular?

OPERATOR: License# 32811
Name: Osage Resources, L.L.C.
Address: 1605 E. 56th Avenue
City/State/Zip: Hutchinson, Kansas 67502
Contact Person: Ben Crouch
Phone: 620-664-9622

RECEIVED
OCT 29 2004
KCC WICHITA

CONTRACTOR: License# 33217
Name: Three Rivers Exploration, L.L.C.

Well Drilled For: Well Class: Type Equipment:
 Oil Enh Rec Infield Mud Rotary
 Gas Storage Pool Ext. Air Rotary
 OWWO Disposal Wildcat Cable
 Seismic; # of Holes Other
 Other CBM

(Note: Locate well on the Section Plat on reverse side)
County: Coffey
Lease Name: Osage Well #: 19
Field Name: Big Creek
Is this a Prorated / Spaced Field? Yes No
Target Information(s): Pennsylvanian, Mississippian
Nearest Lease or unit boundary: 354
Ground Surface Elevation: 1130 feet MSL
Water well within one-quarter mile: Yes No
Public water supply well within one mile: Yes No
Depth to bottom of fresh water: 100 Feet
Depth to bottom of usable water: 200 Feet
Surface Pipe by Alternate: 1 2
Length of Surface Pipe Planned to be set: 40 Feet
Length of Conductor Pipe required: None
Projected Total Depth: 1850' Feet
Formation at Total Depth: Mississippian
Water Source for Drilling Operations:
 Well Farm Pond Other County Rural Water
DWR Permit #: _____

If OWWO: old well information as follows:
Operator: _____
Well Name: _____
Original Completion Date: _____ Original Total Depth: _____
Directional, Deviated or Horizontal wellbore? Yes No
If Yes, true vertical depth: _____
Bottom Hole Location: _____
KCC DKT #: _____

AFFIDAVIT

The undersigned hereby affirms that the drilling, completion and eventual plugging of this well will comply with K.S.A. 55 et. seq.
It is agreed that the following minimum requirements will be met:
1. Notify the appropriate district office **prior** to spudding of well;
2. A copy of the approved notice of intent to drill **shall be** posted on each drilling rig;
3. The minimum amount of surface pipe as specified below **shall be set** by circulating cement to the top; in all cases surface pipe **shall be set** through all unconsolidated materials plus a minimum of 20 feet into the underlying formation.
4. If the well is dry hole, an agreement between the operator and the district office on plug length and placement is necessary **prior to plugging**;
5. The appropriate district office will be notified before well is either plugged or production casing is cemented in;
6. If an ALTERNATE II COMPLETION, production pipe shall be cemented from below any usable water to surface within **120 days** of spud date.
Or pursuant to Appendix "B" - Eastern Kansas surface casing order #133,891-C, which applies to the KCC District 3 area, alternate II cementing must be completed within 30 days of the spud date or the well shall be plugged. **In all cases, NOTIFY district office** prior to any cementing.

I hereby certify that the statements made herein are true and to the best of my knowledge and belief.
Date: 10/27/2004 Signature of Operator or Agent: [Signature] Title: Managing Member

For KCC Use ONLY
API # 15 - 031-22082-00-00
Conductor pipe required NONE feet
Minimum surface pipe required 40 feet per Alt. **2**
Approved by: RJP 11-16-04
This authorization expires: 5-16-05
(This authorization void if drilling not started within 6 months of effective date.)
Spud date: _____ Agent: _____

Remember to:
- File Drill Pit Application (form CDP-1) with Intent to Drill;
- File Completion Form ACO-1 within 120 days of spud date;
- File acreage attribution plat according to field proration orders;
- Notify appropriate district office 48 hours prior to workover or re-entry;
- Submit plugging report (CP-4) after plugging is completed;
- Obtain written approval before disposing or injecting salt water.
- If this permit has expired (See: authorized expiration date) please check the box below and return to the address below.
 Well Not Drilled - Permit Expired
Signature of Operator or Agent: _____
Date: _____

Mail to: KCC - Conservation Division, 130 S. Market - Room 2078, Wichita, Kansas 67202

20
21
145

IN ALL CASES PLOT THE INTENDED WELL ON THE PLAT BELOW

Plat of acreage attributable to a well in a prorated or spaced field

If the intended well is in a prorated or spaced field, please fully complete this side of the form. If the intended well is in a prorated or spaced field complete the plat below showing that the well will be properly located in relationship to other wells producing from the common source of supply. Please show all the wells and within 1 mile of the boundaries of the proposed acreage attribution unit for gas wells and within 1/2 mile of the boundaries of the proposed acreage attribution unit for oil wells.

API No. 15 - _____
 Operator: Osage Resources, L.L.C.
 Lease: Osage
 Well Number: 19
 Field: Big Creek

Location of Well: County: Coffey
 354 _____ feet from N / S Line of Section
 1615 _____ feet from E / W Line of Section
 Sec. 28 Twp. 21 S. R. 14 East West

Number of Acres attributable to well: _____
 QTR / QTR / QTR of acreage: NW - NE - SW

Is Section: Regular or Irregular

If Section is Irregular, locate well from nearest corner boundary.

Section corner used: NE NW SE SW

PLAT

*(Show location of the well and shade attributable acreage for prorated or spaced wells.)
 (Show footage to the nearest lease or unit boundary line.)*

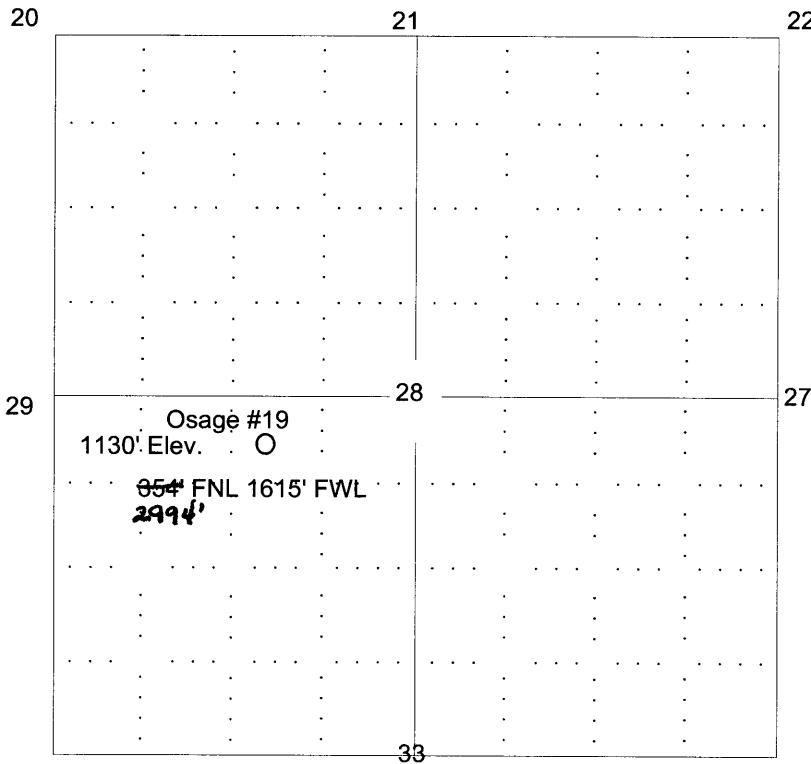

RECEIVED
 OCT 29 2004
 KCC WICHITA

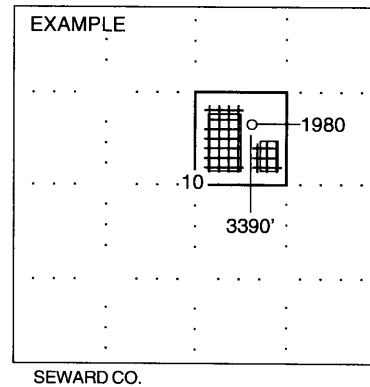

32 **NOTE: In all cases locate the spot of the proposed drilling locaton.** 34

In plotting the proposed location of the well, you must show:

1. The manner in which you are using the depicted plat by identifying section lines, i.e. 1 section, 1 section with 8 surrounding sections, 4 sections, etc.
2. The distance of the proposed drilling location from the section's south / north and east / west.
3. The distance to the nearest lease or unit boundary line.
4. If proposed location is located within a prorated or spaced field a certificate of acreage attribution plat must be attached: (C0-7 for oil wells; CG-8 for gas wells).