

Give All Information Completely
Make Required Affidavit
Mail or Deliver Report to:
Conservation Division
State Corporation Commission
800 Bittling Building
Wichita, Kansas

15-137-00078-00-00

WELL PLUGGING RECORD

NORTH

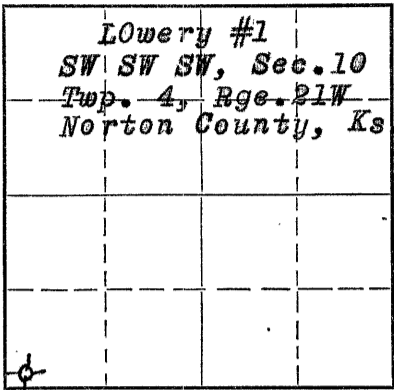

Locate well correctly on above Section Plat

Location as "NE/CNW $\frac{1}{4}$ /SW $\frac{1}{4}$ " or footage from lines SW SW SW
 County. Sec. 10 Twp. 4 Rge. 21 (E) W (W)
 Lease Owner Murfin Drlg. Co & Vernon Oil & Gas Co.
 Lease Name Lowery Well No. #1
 Office Address 910 Union Nat'l Bank Bldg. Wichita, Ks.
 Character of Well (completed as Oil, Gas or Dry Hole) Dry Hole
 Date well completed 9-28- 19 51
 Application for plugging filed 9-28-51 19 51
 Application for plugging approved 9-28 19 51
 Plugging commenced 9-28 8:00 A.M. 19 51
 Plugging completed 9-28 19 51
 Reason for abandonment of well or producing formation Dry Hole

If a producing well is abandoned, date of last production _____ 19____
 Was permission obtained from the Conservation Division or its agents before plugging was commenced? Yes Verbal

Name of Conservation Agent who supervised plugging of this well Eldon Petty
 Producing formation _____ Depth to top _____ Bottom _____ Total Depth of Well 3738 Feet
 Show depth and thickness of all water, oil and gas formations.

OIL, GAS OR WATER RECORDS

CASING RECORD

Formation	Content	From	To	Size	Put In	Pulled Out
<u>Soil, Clay Shale.</u>		<u>0</u>	<u>215</u>	<u>8 5/8"</u>	<u>215'</u>	<u>None</u>
<u>Lansing (K.C.)</u>		<u>3474</u>	<u>3675</u>		<u>Dry</u>	<u>Dry</u>
<u>Arbuckle</u>		<u>3738'</u>	<u>3788</u>		<u>Dry</u>	<u>Dry</u>

Describe in detail the manner in which the well was plugged, indicating where the mud fluid was placed and the method or methods used in introducing it into the hole. If cement or other plugs were used, state the character of same and depth placed, from _____ feet to _____ feet for each plug set.

Stirred Pits and filled hole with heavy mud, placed wood plug at 200' 1/2 sack hulls and 15 sacks of cement on same. Filled hole with mud to 40 feet. Placed wood plug at 40', 1/2 sack hulls 10 sacks of cement, filling hole to bottom of cellar with cement.

(If additional description is necessary, use BACK of this sheet)

Name of Plugging Contractor Strain Drilling Company
 Address Box 188, Hays, Kansas.

STATE OF Kansas, COUNTY OF Ellis, ss.
T.C. Strain (employee of owner) or (owner or operator) of the above-described well,
 being first duly sworn on oath, says: That I have knowledge of the facts, statements, and matters herein contained and the log of the above-described well as filed and that the same are true and correct. So help me God.

(Signature) T.C. Strain

Box 188, Hays, Kansas.
 (Address)

SUBSCRIBED AND SWORN to before me this 29 day of September, 19 51

My commission expires July 18, 1955

Delores Ann Linn
 Notary Public.

PLUGGING
 FILE SEC T R
 BOOK PAGE _____

RECEIVED
 STATE CORPORATION COMMISSION
 OCT 1 1951
 CONSERVATION DIVISION
 Wichita, Kansas

15-137-00078-00-00

WELL LOG

COMPANY: MURFIN DRILLING COMPANY

SW SW SW Sec. 10
Twp. 4, Rge 21W,
Norton County, Ks.

LEASE: Lowery #1

ELEVATION: 2222 R.B.

Note: All Meas. rotary bushings

0	90 Clay & Post Rock
90	215 Shale, Sand, Blue Shale
2215	500 Shale & Shells
500	1210 Shale
1210	1220 Shale
1220	1405 Sand & Shale
1405	1610 Sand
1610	1635 Shale & Red Bed
1635	1890 Red Bed
1890	1920 Anhydrite
1920	1925 Shale
1925	2265 Shale & Shells
2265	2425 Shale & Shells
2425	2475 Shale & Br Lime
2475	2575 Shale & Br Lime
2575	2785 Shale
2785	2820 Lime
2820	2885 Lime
2885	3010 Lime & Shale
3010	3175 Shale & Lime
3175	3275 Shale & Lime
3275	3300 Lime & Shale
3300	3375 Shale & Lime
3375	3400 Lime
3400	3437 Lime & Shale
3437	3441 Heebner
3441	3468 Shale & Lime
3468	3485 Lime
3485	3545 Lime
3545	3585 Lime
3585	3650 Lime
3650	3720 Lime
3720	3738 Congloerate
3738	3760 Arbuckle
3760	3788 Arbuckle
3788	TD (R.B. Meas.)

COMMENCED: 9-19-51
COMPLETED: 9-28-51

CASING RECORD:

8 5/8" Surface casing set at
215 Ft. w/125 lbs cement by
Globe Cementing Company.

No drill stem tests.

Ran Schlumberger log to total
depth.

TOPS:

Anhydrite	1890	Lansing (KC)	3474
Topoka	3269	Base (KC)	3675
Heebner	3437	Arbuckle	3738
Tronto	3458	Total Depth	3788

RECEIVED
OCT 1 1951

10-1-51

STATE OF KANSAS) SS
COUNTY OF ELLIS)

I hereby affirm that the above and foregoing is a true and
correct copy of the log of the Lowery #1, located SW SW SW Sec. 10,
Twp. 4, Rge 21W, Norton County, Kansas

PLUGGING
FILE SEC 10T 4 R 21W
BOOK PAGE 113 LINE 3

Contractor Strain Drilling Company

By F. C. Strain
F. C. Strain

Subscribed and sworn to before me this 28 day of September, 1951
My commission expires July 18, 1955.

[Signature]

NOTARY PUBLIC.