

15-137-20082-00-00

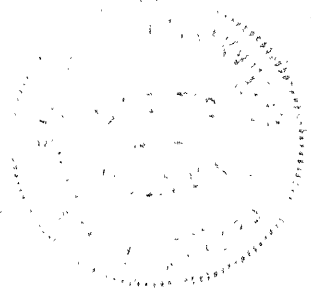

STATE OF KANSAS
STATE CORPORATION COMMISSION
CONSERVATION DIVISION
P. O. BOX 17027
Wichita, Kansas 67217

Rev. 3-15-72
FORM CP-1

RECEIVED
STATE CORPORATION COMMISSION

JUL 18 1972

7-18-72

CONSERVATION DIVISION
Wichita, Kansas

WELL PLUGGING APPLICATION FORM
File One Copy

Lease Owner JOHN O. FARMER, INC.
Address P.O. Box 352, Russell, Kansas 67665
Lease (Farm Name) KNAPE #1 Well No. _____
Well Location C SE SE Sec. 26 Twp. 4S Rge. 23W (E) _____ (W) _____
County NORTON Total Depth 3711' Field Name _____
Oil Well _____ Gas Well _____ Input Well _____ SWD Well _____ Rotary D & A X
Well Log filed with application as required yes
Date and hour plugging is desired to begin 7-11-72

PLUGGING OF THIS WELL WILL BE DONE IN ACCORDANCE WITH K.S.A. 55-128 OF THE RULES AND REGULATIONS OF THE STATE CORPORATION COMMISSION.

Name of company representative authorized to be in charge of plugging operations:
Dale Buchheister Address Plainville, Kansas
Plugging Contractor John O. Farmer, Inc. License No. _____
Address Russell, Kansas

Invoice covering assessment for plugging this well should be sent to:
Name John O. Farmer, Inc.
Address P.O. Box 352, Russell, Kansas 67665
and payment will be guaranteed by applicant or acting agent.

Signed: John O. Farmer
Applicant or Acting Agent
Date: July 17, 1972

FARM NAME **KNAPE** WELL NO. **1** COUNTY **NORTON** SEC. **26** TWP. **4S** RGE. **23W**

OPERATOR JOHN O. FARMER, INC.

ADDRESS RUSSELL, KANSAS

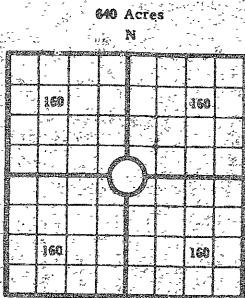

COUNTY Norton SEC. 26 TWP. 4S RGE. 23W
 COMPANY OPERATING John O. Farmer, Inc.
 OFFICE ADDRESS Box 352, Russell, Ks. 67665
 DRILLING STARTED 7-6, 1972 DRILLING FINISHED 7-11-72
 DATE OF FIRST PRODUCTION _____ COMPLETED _____
 WELL LOCATED 1/4 1/4 1/4 North of South
 Line and C SE SE ft. East of West Line of Quarter Section
 Elevation (Relative to sea level) DERRICK FLOOR 2278 GROUND, 2273
 CHARACTER OF WELL (Oil, gas or dryhole) Dry Hole

OIL OR GAS SANDS OR ZONES

Name	From	To	Name	From	To
1			4		
2			5		
3			6		

Perforating Record If Any

Shot Record

Formation	From	To	No. of Shots	Formation	From	To	Size of Shot

CASING RECORD

Amount Set						Amount Pulled			Packer Record		
Size	Wt.	Thds.	Make	Ft.	In.	Ft.	In.	Size	Length	Depth Set	Make

Liner Record: Amount _____ Kind _____ Top _____ Bottom _____

CEMENTING AND MUDDING

Size	Amount Set		Sacks Cement	Chemical		Method of Cementing	Amount	Mudding Method	Results (See Note)
	Ft.	In.		Gal.	Make				
8-5/8	211		150						

Note: What method was used to protect sands if outer strings were pulled? _____

NOTE: Were bottom hole plugs used? _____ If so, state kind, depth set and results obtained _____

TOOLS USED

Rotary Tools were used from 0 feet to 3711 feet. Cable tools were used from _____ feet to _____ feet, and from _____ feet to _____ feet, and from _____ feet to _____ feet.

Type Rig Rotary

INITIAL PRODUCTION TEST

Describe initial test: whether by flow through tubing or casing or by pumping _____

Amount of Oil Production _____ bbls. Size of choke, if any _____ Length of test _____ Water

Production _____ bbls. Gravity of oil _____ Type of Pump if pump is used, describe _____

FORMATION RECORD

Give detailed description and thickness of all formation drilled through, contents of sand, whether dry, water, oil or gas.

Formation	Top	Bottom	Formation	Top	Bottom
Anhydrite	1862				
Heebner	3368				
Toronto	3400				
Lansing	3416				
B/Kansas C.	3600				
Basal Sand	3674				
LOG TOPS					
			Heebner	3365	
			Toronto	3402	
			Lansing	3413	
			B/K. City	3598	
			Basal Sand	3670	
			Reagan Sand	3699	
			Granite	3702	
			Log T.D.	3708	
			Rotary T.D.	3711	
SAMPLE TOPS					
			Shale	0	380
			Sand & Shale	380	1380
			Sand	1380	1610
			Red Bed	1610	1862
			Anhydrite	1862	1893
			Shale & Shells	1893	2470
			Shale & Lime	2470	3070
			Lime & Shale	3070	3711
			R.T.D.	3711	

RECEIVED STATE CORPORATION COMMISSION

JUL 18 1972

CONSERVATION DIVISION
Wichita, Kansas

7-18-72

15-137-20082-00-00

I, the undersigned, being first duly sworn upon oath, state that this well record is true, correct and complete according to the records of this office and to the best of my knowledge and belief.

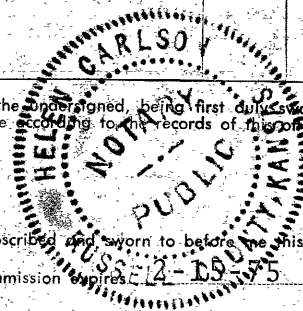

John O. Farmer
Name and title of representative of company
President

Subscribed and sworn to before me this 17 day of July, 1972

My Commission Expires 12-19-75
Helen Carlson
Notary Public.

Helen Carlson

State of Kansas



15-137-20082-00-00

State Corporation Commission

CONSERVATION DIVISION

(Oil, Gas and Water)

P. O. Box 17027 3830 S. Meridian
WICHITA, KANSAS 67217

July 18, 1972

WELL PLUGGING AUTHORITY

Well No.	1
Lease	Knape
Description	C SE SE Sec. 26-4-23W
County	Norton
Total Depth	3711'
Plugging Contractor	Co. Tools

John O. Farmer, Inc.
P. O. Box 352
Russell, Kansas 67665

Gentlemen:

This is your authority to plug the above subject well in accordance with the Rules and Regulations of the State Corporation Commission.

This authority is void after 90 days from the above date.

Yours very truly,



J. Lewis Brock, Administrator

Mr. Leo Massey, P. O. Box 582, Hays, Kansas 67601
is hereby assigned to supervise the plugging of the above named well.