

STATE OF KANSAS
STATE CORPORATION COMMISSION
CONSERVATION DIVISION
P. O. BOX 17027
Wichita, Kansas 67217

Rev. 3-15-72
FORM CP-1

RECEIVED
STATE CORPORATION COMMISSION

JUL 12 1972

CONSERVATION DIVISION
Wichita, Kansas

7-12-72

WELL PLUGGING APPLICATION FORM
File One Copy

15-137-20080-00-00

Lease Owner JOHN O. FARMER, INC.
Address P.O. BOX 352, Russell, Kansas 67665
Lease (Farm Name) HARTING Well No. 1
Well Location C SE SE Sec. 11 Twp. 4S Rge. 23W (E) (W) _____
County Norton Total Depth 3670' Field Name _____
Oil Well _____ Gas Well _____ Input Well _____ SWD Well _____ Rotary D & A X
Well Log filed with application as required yes
Date and hour plugging is desired to begin 7-5-72

PLUGGING OF THIS WELL WILL BE DONE IN ACCORDANCE WITH K.S.A. 55-128 OF THE RULES AND REGULATIONS OF THE STATE CORPORATION COMMISSION.

Name of company representative authorized to be in charge of plugging operations:

Dale Buchheister Address Plainville, Kansas

Plugging Contractor John O. Farmer, Inc. License No. _____

Address Russell, Kansas

Invoice covering assessment for plugging this well should be sent to:

Name JOHN O. FARMER, INC.

Address P.O. BOX 352, Russell, Kansas 67665

and payment will be guaranteed by applicant or acting agent.

Signed: John O. Farmer
Applicant or Acting Agent

Date: July 10, 1972

FARM NAME HARTING COUNTY Norton TWP 4S RGE. 23W SEC 11 WELL NO. 1

OPERATOR JOHN O. FARMER, INC.
 ADDRESS P.O. Box 352, Russell, Ks.
67665

FORMATION RECORD

Give detailed description and thickness of all formation drilled through, contents of sand, whether dry, water, oil or gas.

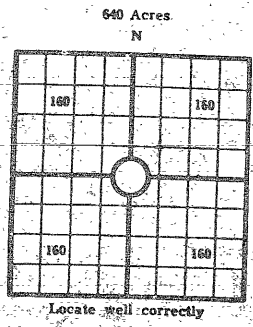

COUNTY Norton, SEC. 11, TWP. 4S, RGE. 23W
 COMPANY OPERATING John O. Farmer, Inc.
 OFFICE ADDRESS Russell, Kansas
 DRILLING STARTED 6/29, 19 72 DRILLING FINISHED 7/5, 19 72
 DATE OF FIRST PRODUCTION _____ COMPLETED _____
 WELL LOCATED 1/4 1/4 1/4 North of South
 Line and C SE SE ft. East of West Line of Quarter Section
 Elevation (Relative to sea level) DERRICK FLOOR 2302 ft
 CHARACTER OF WELL (Oil, gas or dryhole) Dry Hole

Formation	Top	Bottom	Formation	Top	Bottom
Anhydrite	1890				
Heebner	3380				
Toronto	3408				
Lansing	3433				
B/Kansas City	3607				
Reagan Sand	3653				
Granite Wash	3667				
R.T.D.	3670				

OIL OR GAS SANDS OR ZONES

Name	From	To	Name	From	To
1			4		
2			5		
3			6		

Perforating Record If Any

Formation	From	To	No. of Shots

Shot Record

Formation	From	To	Size of Shot

CASING RECORD

Amount Set						Amount Pulled		Packer Record			
Size	Wt.	Thds.	Make	Ft.	In.	Ft.	In.	Size	Length	Depth Set	Make

Liner Record: Amount _____ Kind _____ Top _____ Bottom _____

CEMENTING AND MUDDING

Size	Amount Set Ft.	In.	Sacks Cement	Chemical Gal.	Make	Method of Cementing	Amount	Mudding Method	Results (See Note)
8-5/8	223		160						

Note: What method was used to protect sands if outer strings were pulled?

NOTE: Were bottom hole plugs used? _____ If so, state kind, depth set and results obtained.

TOOLS USED

Rotary Tools were used from 0 feet to 3670 Cable tools were used from _____ feet to _____ feet, and from _____ feet to _____ feet, and from _____ feet to _____ feet

Type Rig Rotary

INITIAL PRODUCTION TEST

Describe initial test: whether by flow through tubing or casing or by pumping _____

Amount of Oil Production _____ bbls. Size of choke, if any _____ Length of test _____ Water Production _____ bbls. Gravity of oil _____ Type of Pump if pump is used, describe _____

SAMPLE TOPS

Shale & Sand	0	125
Shale	125	1450
Sand	1450	1635
Shale	1635	1675
Red Bed	1675	1890
Anhydrite	1890	1924
Shale & Shell	1924	2440
Shale & Lime	2440	3085
Lime & Shale	3085	3450
Lime	3450	3515
Lime & Shale	3515	3670
R.T.D.	3670	

RECEIVED
 STATE CORPORATION COMMISSION
 JUL 12 1972
 CONSERVATION DIVISION
 WICHITA, KANSAS

17-12-72

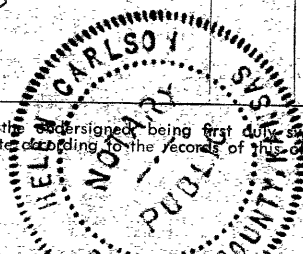

Name and title of representative of company
John O. Farmer
 President

I, the undersigned, being first duly sworn upon oath, state that this well record is true, correct and complete according to the records of this office and to the best of my knowledge and belief.

Subscribed and sworn to before me this 10th day of July, 19 72
 My Commission expires 7-19-75

 Helen Carlson
 Notary Public

15-137-20080-00-01

State of Kansas



15-137-20080-00-00

State Corporation Commission

CONSERVATION DIVISION

(Oil, Gas and Water)

P. O. Box 17027 3830 S. Meridian
WICHITA, KANSAS 67217

July 7, 1972

WELL PLUGGING AUTHORITY

Well No.	1
Lease	Harting
Description	SE SE 11-4-23W
County	Norton
Total Depth	3670
Plugging Contractor	Co. Tools

John O. Farmer, Inc.
370 W. Wichita
Russell, Kansas 67665

Gentlemen:

This is your authority to plug the above subject well in accordance with the Rules and Regulations of the State Corporation Commission.

This authority is void after 90 days from the above date.

Yours very truly,

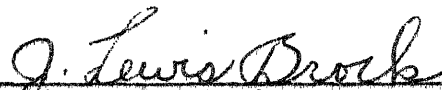

J. Lewis Brock, Administrator

Mr. Leo Massey Box 582 Hays, Kansas 67601
is hereby assigned to supervise the plugging of the above named well.