

CORRECTION

FOR KCC USE:

FORM CB-1 12/93

FORM MUST BE TYPED

FORM MUST BE SIGNED

ALL BLANKS MUST BE FILLED IN

EFFECTIVE DATE: 8-2-95

State of Kansas

DISTRICT # 4

CATHODIC PROTECTION BOREHOLE INTENT DRAFT

SGA? ... Yes  No

Must be approved by the K.C.C. sixty (60) days prior to commencing well.

Expected Spud (Starting) Date 7.....24.....95.....  
month day year

OPERATOR: License # 5952

Spot (Location) Q/Q/Q  
NE.- NE.- NW. Sec 14.. Twp 4... S, Rg27... X West  
49 feet from South / (North) line of Section  
2596 feet from East / (West) line of Section  
(Circle directions from nearest outside corner boundaries)

IS SECTION X REGULAR \_\_\_\_\_ IRREGULAR?  
(Spot well on the Section Plat on Reverse Side)  
County: Decatur

Name: Amoco Pipeline Company  
Address: P.O. Box 246  
City/State/Zip: Watkins, CO 80137  
Contact Person: Bob Gilmister  
Phone: (303)261-0453

Lease Name: APL #0066 Well #: 2

Facility Name: Ft. Laramie-Freeman 22"  
Ground Surface Elevation: 2595' MSL  
\* Cathodic Borehole Total Depth 280' ft.  
Depth to Bedrock \_\_\_\_\_ ft.

CONTRACTOR: License #: Will advise on ACO-1

Name: \_\_\_\_\_  
Type Drilling Equipment: X Mud Rotary .... Cable  
..... Air Rotary .... Other

WATER INFORMATION:

Aquifer Penetration: .... None .... Single X Multiple  
Depth to bottom of fresh water: 100'  
Depth to bottom of usable water: 100'  
Water well within one-quarter mile: X yes .... no  
Public water supply well within one mile: .... yes X no  
Water Source for Drilling Operations:  
.... well .... farm pond .... stream .... other

CONSTRUCTION FEATURES  
Length of Cathodic Surface (Non-Metallic) Casing  
Planned to be set: 120' ft.  
Length of Conductor pipe (if any?): n/a ft.  
Size of the borehole (I.D.): 7-7/8" inches  
Cathodic surface casing size: 14" inches  
Cathodic surface casing centralizers set at depths of: 2.0;

DWR Permit #: \_\_\_\_\_  
Standard Dimension Ratio (SDR) is = SC40 PVC  
(cathodic surface OD csg.in inches / MWT in inches = SDR)

Cathodic surface casing will terminate at:  
... Above surface ... Surface Vault X Below Surface Vault  
Pitless casing adaptor will be used: X (Yes) No at Depth 2 ft.  
Anode installation depths are: 110; 120; 130; 140; 150  
160; 170; 180; 190; 200; 210; 220; 230; 240;  
250

Annular space between borehole and casing will be grouted  
with: .... Concrete .... Bentonite Cement  
..... Neat cement .. X Bentonite clay

Anode vent pipe will be set at: 4 ft. above surface

Anode conductor (backfill) material TYPE: Loresco SC-2

Depth to BASE of Backfill installation material: 250 ft.  
Depth to TOP of Backfill installation material: 90 ft.

\* TOTAL DEPTH WAS: 250' IS: 280'

AFFIDAVIT

The undersigned hereby affirms that the drilling, completion and eventual plugging of this well will comply with K.S.A. 55-101, et. seq. It is agreed that the following minimum requirements will be met:

1. Notify the appropriate district office prior to spudding of and again before plugging well;
2. A copy of the approved notice of intent to drill shall be posted on each drilling rig;
3. The minimum amount of cathodic surface casing as specified below shall be set by grouting to the top.
4. An agreement between the operator and the district office on plugs and placement is necessary prior to plugging;
5. The appropriate district office will be notified before well is either plugged or casing is grouted in;
6. IN ALL CASES, NOTIFY DISTRICT OFFICE PRIOR TO ANY CEMENTING.

I hereby certify that the statements made herein are true and to the best of my knowledge and belief.

Date: 6/6/95 Signature of Operator or Agent: [Signature] Title: Corrosion Specialist

FOR KCC USE:  
 API # 15- 039-208930000  
 Conductor pipe required NONE feet  
 Minimum cathodic surface casing required 120' feet  
 Approved by: JK 7-28-95 / JK 8-195  
 MAX. TOTAL DEPTH = 280  
 This authorization expires: 7-28-96  
 (This authorization void if drilling not started within 6 months of effective date.)  
 Spud date: \_\_\_\_\_ Agent: \_\_\_\_\_

REMEMBER TO:

- File Drill Pit Application (form CDP-1) with Intent to Install;
- File Completion Form CB-2 within 30 days of spud date;
- Notify appropriate district office 48 hours prior to workover or re-entry;
- Submit plugging report (CB-4) within 30 days after plugging is completed.

14  
4  
2700

cathodic borehole. Please show all the wells, existing cathodic boreholes, pipelines or facilities within 1/2 mile of the proposed borehole.

API NO. 15- \_\_\_\_\_  
 OPERATOR \_\_\_\_\_  
 LEASE \_\_\_\_\_  
 WELL NUMBER \_\_\_\_\_  
 FACILITY NAME \_\_\_\_\_

LOCATION OF WELL: COUNTY Decatur  
 \_\_\_\_\_ 49 feet from south/north line of section  
 \_\_\_\_\_ 2596 feet from east/west line of section  
 SECTION 14 TWP 4S RG 27W

SPOT: QTR/QTR/QTR/QTR OF ACREAGE  
 \_\_\_\_\_ - \_\_\_\_\_ - \_\_\_\_\_ - \_\_\_\_\_

IS SECTION X REGULAR or \_\_\_\_\_ IRREGULAR  
IF SECTION IS IRREGULAR, LOCATE WELL FROM NEAREST CORNER BOUNDARY.

Section corner used: \_\_\_\_\_ NE \_\_\_\_\_ NW \_\_\_\_\_ SE \_\_\_\_\_ SW

**PLAT**

(Show location of intented cathodic borehole.)

(Show footage from nearest lease, unit or outside section boundary line.)

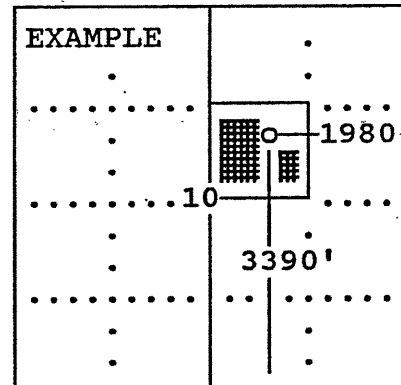
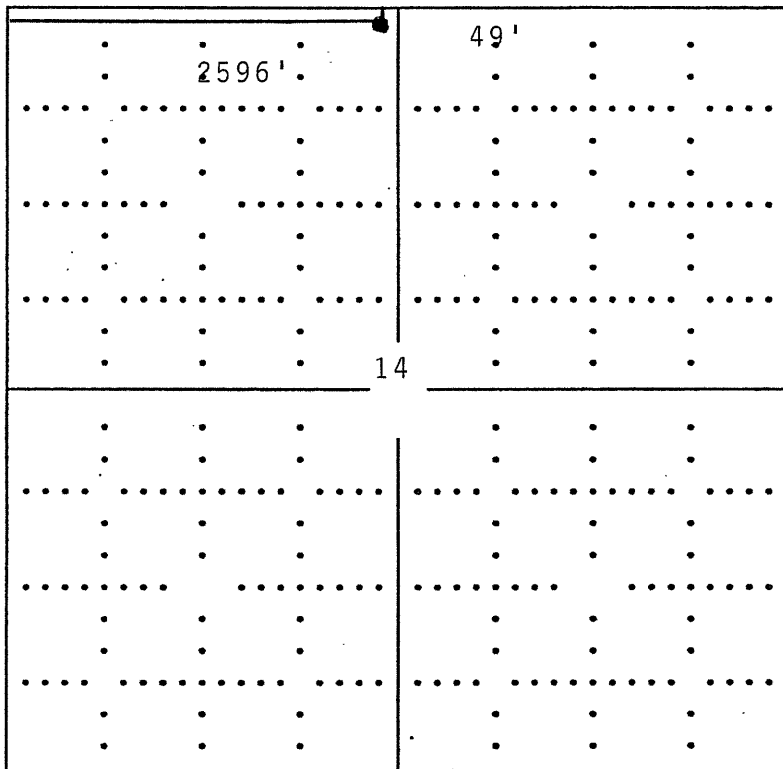

SEWARD CO.

**In plotting the proposed location of the well, you must show:**

- 1) The manner in which you are using the depicted plat by identifying section lines, i.e. 1 section, 1 section with 8 surrounding sections, 4 sections, etc.;
- 2) the distance of the proposed drilling location from the section's south/north and east/west; and
- 3) the distance to the nearest lease, unit or outside section boundary line.

FOR KCC USE:

FORM CB-1 12/93

FORM MUST BE TYPED

EFFECTIVE DATE: 8-2-95

State of Kansas

FORM MUST BE SIGNED

DISTRICT # 4

CATHODIC PROTECTION BOREHOLE INTENT DRAFT

ALL BLANKS MUST BE FILLED IN

SGA? ... Yes  No

Must be approved by the K.C.C. sixty (60) days prior to commencing well.

Expected Spud (Starting) Date 7 month 24 day 95 year

OPERATOR: License # 5952

Name: Amoco Pipeline Company

Address: P.O. Box 246

City/State/Zip: Watkins, CO 80137

Contact Person: Bob Gilmister

Phone: (303)261-0453

CONTRACTOR: License #: Will advise on ACO-1

Name: .....

Type Drilling Equipment:  Mud Rotary  Cable  Air Rotary  Other

CONSTRUCTION FEATURES

Length of Cathodic Surface (Non-Metallic) Casing

Planned to be set: 120' ft.

Length of Conductor pipe (if any?): n/a ft.

Size of the borehole (I.D.): 7-7/8 inches

Cathodic surface casing size: 14 inches

Cathodic surface casing centralizers set at depths of: 2.0;

..... ; .....

Cathodic surface casing will terminate at:  Above surface  Surface Vault  Below Surface Vault

Pitless casing adaptor will be used:  Yes  No at Depth 2 ft.

Anode installation depths are: 110, 120, 130, 140, 150, 160, 170, 180, 190, 200, 210, 220, 230, 240, 250

Spot (Location) Q/Q/Q East  
NE--NE--NW Sec 14 Twp 4 S, Rg 27 X West  
49 feet from South / North line of Section  
2596 feet from East / West line of Section  
(Circle directions from nearest outside corner boundaries)  
IS SECTION  REGULAR  IRREGULAR?  
(Spot well on the Section Plat on Reverse Side)  
County: Decatur

Lease Name: APL #0066 Well #: 2

Facility Name: Ft. Laramie-Freeman 22"  
Ground Surface Elevation: 2595 MSL  
Cathodic Borehole Total Depth: 280 250 ft.  
Depth to Bedrock: ..... ft.

WATER INFORMATION:

Aquifer Penetration: .... None  Single  Multiple

Depth to bottom of fresh water: 100'

Depth to bottom of usable water: 100'

Water well within one-quarter mile:  yes  no

Public water supply well within one mile: .... yes  no

Water Source for Drilling Operations:

.... well  farm pond  stream  other

Water Well Location: .....

.....

DWR Permit #: .....

Standard Dimension Ratio (SDR) is = SC40 PVC

(cathodic surface OD csg. in inches / MWT in inches = SDR)

Annular space between borehole and casing will be grouted with:  Concrete  Bentonite Cement  Neat cement  Bentonite clay

Anode vent pipe will be set at: 4 ft. above surface

Anode conductor (backfill) material TYPE: Lorresco SC-2

Depth to BASE of Backfill installation material: 250 ft.

Depth to TOP of Backfill installation material: 90 ft.

AFFIDAVIT

The undersigned hereby affirms that the drilling, completion and eventual plugging of this well will comply with K.S.A. 55-101, et. seq. It is agreed that the following minimum requirements will be met:

- 1. Notify the appropriate district office prior to spudding of and again before plugging well;
- 2. A copy of the approved notice of intent to drill shall be posted on each drilling rig;
- 3. The minimum amount of cathodic surface casing as specified below shall be set by grouting to the top.
- 4. An agreement between the operator and the district office on plugs and placement is necessary prior to plugging;
- 5. The appropriate district office will be notified before well is either plugged or casing is grouted in;
- 6. IN ALL CASES, NOTIFY DISTRICT OFFICE PRIOR TO ANY CEMENTING.

I hereby certify that the statements made herein are true and to the best of my knowledge and belief.

Date: 6/6/95 Signature of Operator or Agent: [Signature] Title: Corrosion Specialist

FOR KCC USE:  
API # 15- 039-208930000  
Conductor pipe required NONE feet  
Minimum cathodic surface casing required 120' feet  
Approved by: JK 7-28-95  
This authorization expires: 1-28-96  
(This authorization void if drilling not started within 6 months of effective date.)  
Spud date: \_\_\_\_\_ Agent: \_\_\_\_\_

REMEMBER TO:

- File Drill Pit Application (form CDP-1) with Intent to Install;
- File Completion Form CB-2 within 30 days of spud date;
- Notify appropriate district office 48 hours prior to workover or re-entry;
- Submit plugging report (CB-4) within 30 days after plugging is completed.

Mail to: Conservation Division, 200 Colorado Derby Building, 202 W. First St., Wichita, Kansas 67202-1286.

CO 8-1-95

STATE CORPORATION COMMISSION

JUN 7 1995  
6-13-95  
CONSERVATION DIVISION  
WICHITA KANSAS

14  
4  
JLW

cathodic borehole. Please show all the wells, existing cathodic boreholes, pipelines or facilities within 1/2 mile of the proposed borehole.

API NO. 15- \_\_\_\_\_  
 OPERATOR \_\_\_\_\_  
 LEASE \_\_\_\_\_  
 WELL NUMBER \_\_\_\_\_  
 FACILITY NAME \_\_\_\_\_

LOCATION OF WELL: COUNTY Decatur  
49 feet from south/north line of section  
2596 feet from east/west line of section  
 SECTION 14 TWP 4S RG 27W

SPOT: QTR/QTR/QTR/QTR OF ACREAGE  
 \_\_\_\_\_ - \_\_\_\_\_ - \_\_\_\_\_ - \_\_\_\_\_

IS SECTION X REGULAR or \_\_\_\_\_ IRREGULAR  
IF SECTION IS IRREGULAR, LOCATE WELL FROM NEAREST CORNER BOUNDARY.  
 Section corner used: \_\_\_\_\_ NE \_\_\_\_\_ NW \_\_\_\_\_ SE \_\_\_\_\_ SW

**PLAT**

(Show location of intended cathodic borehole.)

(Show footage from nearest lease, unit or outside section boundary line.)

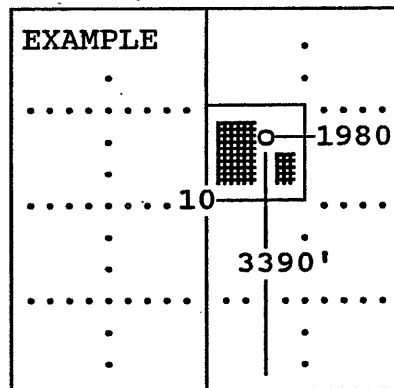
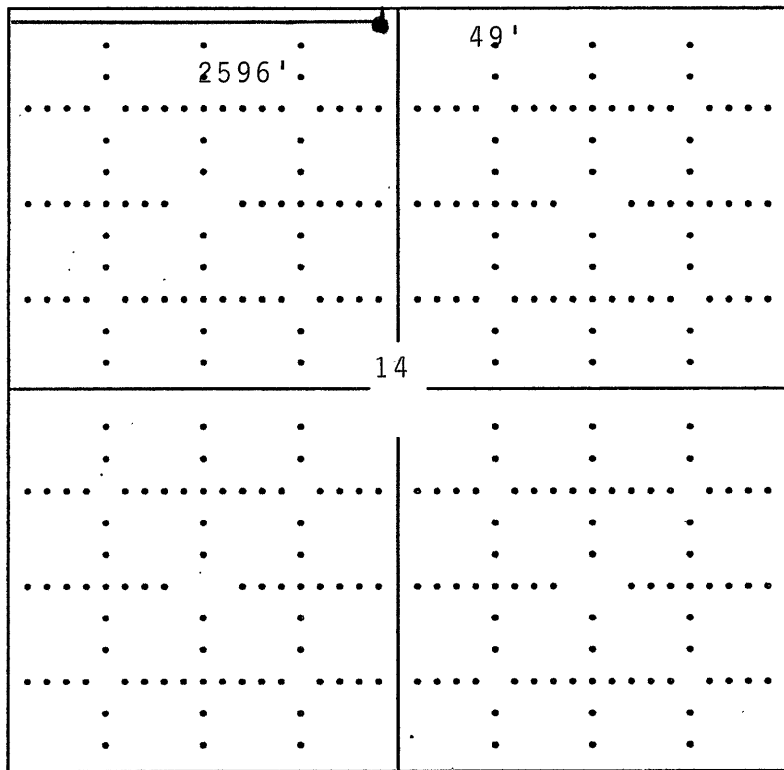

SEWARD CO.

In plotting the proposed location of the well, you must show:

- 1) The manner in which you are using the depicted plat by identifying section lines, i.e. 1 section, 1 section with 8 surrounding sections, 4 sections, etc.;
- 2) the distance of the proposed drilling location from the section's south/north and east/west; and
- 3) the distance to the nearest lease, unit or outside section boundary line.