

15-039-00139-00-00

STATE OF KANSAS
STATE CORPORATION COMMISSION
CONSERVATION DIVISION
211 NORTH BROADWAY
WICHITA, KANSAS

WELL PLUGGING APPLICATION FORM
File One Copy

Lease Owner JOHN O. FARMER, INC. Address Russell, Kansas
(Applicant)

Lease (Farm Name) FARRIS Well No. 1

Well Location SW SW SW Sec. 7 Twp. 4S Rge. (E) - (W) 26

County Decatur Field Name (if any) _____

Total Depth 3983 Oil ___ Gas ___ Dry Hole X

Was well log filed with application? yes If not, explain: _____

Date and hour plugging is desired to begin 2/21/59 1:00 PM

Plugging of the well will be done in accordance with the Rules and Regulations of the State Corporation Commission.

Name of the person on the lease in charge of well for owner _____

Dale Buchheister Address Plainville, Kansas

Plugging Contractor JOHN O. FARMER, INC.

Plugging Contractor's License No. _____

Address Russell, Kansas

Invoice covering assessment for plugging this well should be sent to _____

John O. Farmer, Inc. Address Russell, Kansas

and payment will be guaranteed by applicant

RECEIVED
STATE CORPORATION COMMISSION

FEB 25 1959

CONSERVATION DIVISION
Wichita, Kansas

2-25-59

John O. Farmer
Applicant or Acting Agent
Date February 23, 1959

PLUGGING
FILE SEC. 7 T. 4 R. 26W
BOOK PAGE 20 LINE 20

OPERATOR JOHN O. FARMER, INC.

ADDRESS Russell, Kansas

FORMATION RECORD

Give detailed description and thickness of all formation drilled through, contents of sand, whether dry, water, oil or gas.

26W RGE, TWP 4S, SEC 7, COUNTY Decatur, WELL NO FARRIS

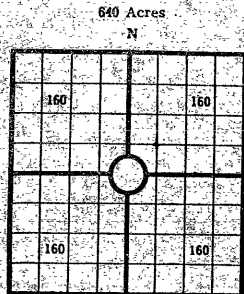

COUNTY Decatur SEC 7 TWP 4S RGE 26W
 COMPANY OPERATING JOHN O. FARMER, INC.
 OFFICE ADDRESS Russell, Kansas
 DRILLING STARTED 2/11, 1959 DRILLING FINISHED 2/21, 1959
 DATE OF FIRST PRODUCTION DISCONTINUED
 WELL LOCATED SW 1/4 SW 1/4 SW 1/4, North of South
 Line and _____ ft. East of West Line of Quarter Section
 Elevation (Relative to sea level) DERRICK FLOOR 2564 GROUND 2561
 CHARACTER OF WELL (Oil, gas or dryhole) Dry

OIL OR GAS SANDS OR ZONES

| Name | From | To | Name | From | To |
|------|------|----|------|------|----|
| 1 | | | 4 | | |
| 2 | | | 5 | | |
| 3 | | | 6 | | |

Perforating Record If Any

Shot Record

| Formation | From | To | No. of Shots | Formation | From | To | Size of Shot |
|-----------|------|----|--------------|-----------|------|----|--------------|
| | | | | | | | |

CASING RECORD

| Amount Set | | | | Amount Pulled | | | | Packer Record | | | |
|------------|-----|-------|------|---------------|-----|-----|-----|---------------|--------|-----------|------|
| Size | Wt. | Thds. | Make | Ft. | In. | Ft. | In. | Size | Length | Depth Set | Make |
| 8-5/8 | | | | 195 | | | | | | | |

Liner Record: Amount _____ Kind _____ Top _____ Bottom _____

CEMENTING AND MUDDING

| Size | Amount Set | | Sacks Cement | Chemical | | Method of Cementing | Amount | Mudding Method | Results (See Note) |
|-------|------------|-----|--------------|----------|------|---------------------|--------|----------------|--------------------|
| | Ft. | In. | | Gal. | Make | | | | |
| 8-5/8 | 195 | | 150 | | | | | | |

Note: What method was used to protect sands if outer strings were pulled?

NOTE: Were bottom hole plugs used? If so, state kind, depth set and results obtained

TOOLS USED

Rotary Tools were used from _____ feet to _____ feet to _____ feet, and from _____ feet to _____ feet, and from _____ feet to _____ feet to _____ feet

Type Rig _____

INITIAL PRODUCTION TEST

Describe initial test: whether by flow through tubing or casing or by pumping

Amount of Oil Production _____ bbls. Size of choke, if any _____ Length of test _____ Water

Production _____ bbls. Gravity of oil _____ Type of Pump if pump is used, describe _____

| Formation | Top | Bottom | Formation | Top | Bottom |
|-----------------|------|--------|---------------------|-----|--------|
| FARM NAME ----- | | | FARRIS #1 | | |
| Surface | 0 | 300 | | | |
| Shale | 300 | 1250 | | | |
| Shale & sand | 1250 | 1650 | | | |
| Shale & shells | 1650 | 1800 | | | |
| Shale | 1800 | 1940 | | | |
| Lime | 1940 | 1950 | | | |
| Shale-redbed | 1950 | 2149 | ELEVATION: | RB | 2566 |
| Anhydrite | 2149 | 2182 | | | |
| Shale-shells | 2182 | 2570 | ELECTRIC LOG TOPS: | | |
| Shale & lime | 2570 | 2910 | Waubunsee Group | | 3258 |
| Lime & shale | 2910 | 3980 | Topeka | | 3338 |
| Arbuckle | 3980 | 3983 | Heebner | | 3512 |
| T.D. | | 3983 | Toronto | | 3538 |
| | | | Lansing | | 3554 |
| | | | B/KC | | 3750 |
| | | | Conglomerate | | 3910 |
| | | | Cherty Conglomerate | | 3919 |
| | | | Arbuckle dolomite | | 3944 |
| | | | T.D. | | 3983 |
| | | | D & A | | |

PLUGGING
FILE SEC 7 T 4 R 26W
BOOK PAGE 20 LINE 20

15-039-00139-00-00

I, the undersigned, being first duly sworn upon oath, state that this well record is true, correct and complete according to the records of this office and to the best of my knowledge and belief.

John O. Farmer President
Name and title of representative of company

Subscribed and sworn to before me this 23rd day of February, 1959
My Commission expires 10/11/62

Lucretia Kennedy Notary Public



15-039-00139-00-00

State Corporation Commission

CONSERVATION DIVISION

(Oil, Gas and Water)

500 Insurance Bldg. 212 N. Market
WICHITA, KANSAS

JEWELL M. OGDEN, Director

GEORGE DOCKING Governor
MARION BEATTY Chairman
HARRY G. WILES Commissioner
RICHARD C. BYRD Commissioner
RAYMOND B. HARVEY Secretary
CLYDE E. MILLIGAN Counsel

March 11, 1959

Well No. 1
Lease Farris
Description SW SW SW 7-4-26W
County Decatur
File No. 20-20

Mr. John O. Farmer, Inc.
Russell, Kansas

Dear Sir:

This is your authority to plug the above subject well in accordance with the Rules and Regulations of the State Corporation Commission.

Very truly yours,

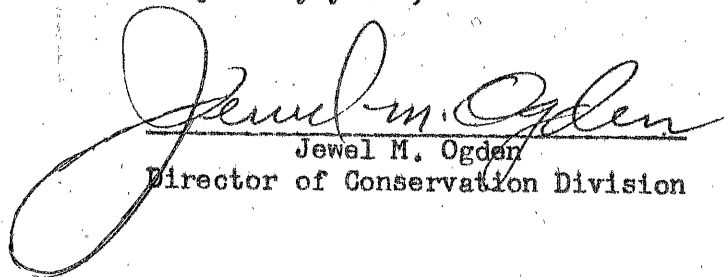
Jewel M. Ogden
Director of Conservation Division

Mr. A. D. Fabricius
is hereby assigned to supervise the plugging of the above named well.

In the event you need any further information regarding this well feel free to write or call me at any time.

J. Lewis Brock
Western Kansas Field Supervisor
P. O. Box 569
Great Bend, Kansas
Phone: GL-33022