

STATE OF KANSAS  
STATE CORPORATION COMMISSION  
CONSERVATION DIVISION  
500 INSURANCE BUILDING  
212 NORTH MARKET  
WICHITA, KANSAS 67202

FORM CP-1

RECEIVED  
STATE CORPORATION COMMISSION  
AUG 6 1970  
CONSERVATION DIVISION  
Wichita, Kansas  
8-6-70

WELL PLUGGING APPLICATION FORM  
File One Copy

15-039-20168-0000

Lease Owner John O. Farmer, Inc., & Consolidated Oil & Gas, Inc.

Address P.O. Box 352, Russell, Kansas

Lease (Farm Name) TACHA Well No. 5

Well Location SW NE SE Sec. 22 Twp. 4S Rge. 27W (E) (W)

County Decatur Field Name (If Any) Tacha

Total Depth 3755' Oil Well  Gas Well  Input Well  SWD Well  D & A

Well Log filed with application Yes or Well Log filed with Plugging Supervisor

Date and hour plugging is desired to begin Completed: 4:45 p.m. 7/29/70

Plugging of the well will be done in accordance with the Rules and Regulations of the State Corporation Commission.

Name of company representative in charge of plugging operations Dale Buchheister

209 North Washington Address Plainville, Kansas

Plugging Contractor John O. Farmer, Inc. License No.

Address P.O. Box 352, Russell, Kansas

Invoice covering assessment for plugging this well should be sent to John O. Farmer, Inc.

P.O. Box 352 Address Russell, Kansas 67665

and payment will be guaranteed by applicant.

Signed: John O. Farmer

Applicant or Acting Agent  
President

Date: August 3, 1970

OPERATOR John O. Farmer, Inc. & Consolidated Oil & Gas, Inc. FORMATION RECORD

ADDRESS Box 352, Russell, Kansas

Give detailed description and thickness of all formation drilled through, contents of sand, whether dry, water, oil or gas.

FARM NAME TACHA WELL NO. 5 COUNTY Decatur SEC. 22 TWP. 4S RGE. 27W

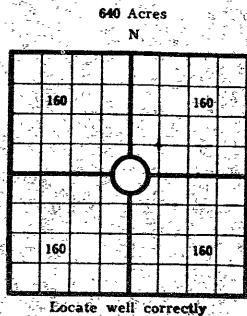

COUNTY Decatur SEC. 22 TWP. 4S RGE. 27W  
 COMPANY OPERATING John O. Farmer, Inc.  
 OFFICE ADDRESS Box 352, Russell, Ks.  
 DRILLING STARTED 7/22/70 DRILLING FINISHED 7/29/70  
 DATE OF FIRST PRODUCTION \_\_\_\_\_ COMPLETED \_\_\_\_\_  
 WELL LOCATED SW 1/4 NE 1/4 SE 1/4, North of South  
 Line and \_\_\_\_\_ ft. East of West Line of Quarter Section  
 Elevation (Relative to sea level) DERRICK FLOOR 2581 GROUND 2578  
 CHARACTER OF WELL (Oil, gas or dryhole) Dryhole

OIL OR GAS SANDS OR ZONES

Name	From	To	Name	From	To
1			4		
2			5		
3			6		

Perforating Record If Any

Shot Record

Formation	From	To	No. of Shots	Formation	From	To	Size of Shot

CASING RECORD

Amount Set						Amount Pulled				Packer Record	
Size	Wt.	Thds.	Make	Ft.	In.	Ft.	In.	Size	Length	Depth Set	Make

Liner Record: Amount \_\_\_\_\_ Kind \_\_\_\_\_ Top \_\_\_\_\_ Bottom \_\_\_\_\_

CEMENTING AND MUDDING

Size	Amount Set		Sacks Cement	Chemical		Method of Cementing	Amount	Mudding Method	Results (See Note)
	Ft.	In.		Gal.	Make				
8 5/8"	203'	160	sx.	cement					

Note: What method was used to protect sands if outer strings were pulled? \_\_\_\_\_

NOTE: Were bottom hole plugs used? \_\_\_\_\_ If so, state kind, depth set and results obtained \_\_\_\_\_

TOOLS USED

Rotary Tools were used from 0 feet to R.T.D. Cable tools were used from \_\_\_\_\_ feet to \_\_\_\_\_ feet, and from \_\_\_\_\_ feet to \_\_\_\_\_ feet, and from \_\_\_\_\_ feet to \_\_\_\_\_ feet.

Type Rig Rotary

INITIAL PRODUCTION TEST

Describe initial test: whether by flow through tubing or casing or by pumping \_\_\_\_\_

Amount of Oil Production \_\_\_\_\_ bbls. Size of choke, if any \_\_\_\_\_ Length of test \_\_\_\_\_ Water

Production \_\_\_\_\_ bbls. Gravity of oil \_\_\_\_\_ Type of Pump if pump is used, describe \_\_\_\_\_

Formation	Top	Bottom	Formation	Top	Bottom
Surface		202			
Shale sand	202	915			
Sand shale	915	1830			
Sand	1830	1956			
Redbed	1956	2155			
Anhydrite	2155	2187			
Shale shells	2187	2590			
Shale lime	2590	2975			
Lime shale	2975	3755			

Sample Tops  
 Tarkio  
 Howard  
 Heebner  
 Toronto  
 Lansing  
 Base Kansas City  
 Rotary T.D.

Tops  
 3231'  
 3320'  
 3515'  
 3543'  
 3559'  
 3752'  
 3755'

18-039-20168-00-00

RECEIVED  
 STATE CORPORATION COMMISSION  
 AUG 6 1970  
 CONSERVATION DIVISION  
 Wichita, Kansas

I, the undersigned, being first duly sworn upon oath, state that this well record is true, correct and complete according to the records of this office and to the best of my knowledge and belief.

Subscribed and sworn to before me this 3 day of August, 19 70  
 My Commission expires: 2/15/71

*John O. Farmer*  
 Name and title of representative of company  
**President**  
*Helen Carlson*  
 Notary Public

State of Kansas



15-039-20168-00-00

State Corporation Commission

CONSERVATION DIVISION

(Oil, Gas and Water)

500 Insurance Bldg. 212 N. Market  
WICHITA, KANSAS 67202

July 31, 1970

WELL PLUGGING AUTHORITY

Well No.	5
Lease	Tacha
Description	SW NE SE 22-4-27W
County	Decatur
Total Depth	3755
Plugging Contractor	Co. Tools

John O. Farmer, Inc.  
370 W. Wichita Ave.  
Russell, Kansas 67665

Gentlemen:

This is your authority to plug the above subject well in accordance with the Rules and Regulations of the State Corporation Commission.

This authority is void after 90 days from the above date.

Very truly yours,

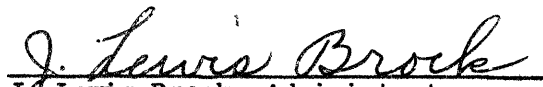
  
J. Lewis Brock, Administrator

Mr. W. L. Nichols Box 157 Morland, Kansas  
is hereby assigned to supervise the plugging of the above  
named well.