

STATE OF KANSAS
STATE CORPORATION COMMISSION
CONSERVATION DIVISION
500 INSURANCE BUILDING
212 NORTH MARKET
WICHITA, KANSAS 67202

FORM CP-1

RECEIVED
STATE CORPORATION COMMISSION
JUL 27 1970
CONSERVATION DIVISION
Wichita, Kansas
17-27-70

WELL PLUGGING APPLICATION FORM
File One Copy

15-039-20165-0000

Lease Owner JOHN O. FARMER, INC. & CONSOLIDATED OIL & GAS, INC.

Address P.O. Box 352, Russell, Kansas 67665

Lease (Farm Name) TACHA Well No. 4

Well Location SW NW SE Sec. 22 Twp. 4S Rge. 27W (E) (W)

County Decatur Field Name (If Any) Tacha

Total Depth 3710' Oil Well Gas Well Input Well SWD Well D & A

Well Log filed with application Yes or Well Log filed with Plugging Supervisor

Date and hour plugging is desired to begin Completed: 11:15 P.M. 7/21/70

Plugging of the well will be done in accordance with the Rules and Regulations of the State Corporation Commission.

Name of company representative in charge of plugging operations Dale Buchheister

209 North Washington Address Plainville, Kansas

Plugging Contractor John O. Farmer, Inc. License No.

Address P.O. Box 352, Russell, Kansas

Invoice covering assessment for plugging this well should be sent to John O. Farmer, Inc.

P.O. Box 352 Address Russell, Kansas 67665

and payment will be guaranteed by applicant.

Signed: John O. Farmer
Applicant or Acting Agent
President

Date: July 24, 1970

OPERATOR John O. Farmer, Inc. & Consolidated Oil & Gas, Inc FORMATION RECORD

ADDRESS Box 352, Russell, Kansas

Give detailed description and thickness of all formation drilled through, contents of sand, whether dry, water, oil or gas.

WELL NO. 4 COUNTY Decatur SEC. 22 TWP. 4S RGE. 27W

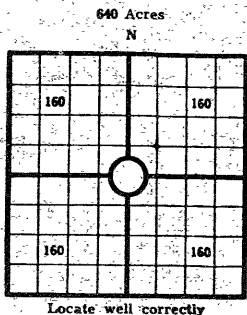

COUNTY Decatur, SEC. 22, TWP. 4S, RGE. 27W
 COMPANY OPERATING John O. Farmer, Inc.
 OFFICE ADDRESS Box 352, Russell, Ks.
 DRILLING STARTED 7/13/70 DRILLING FINISHED 7/21/70
 DATE OF FIRST PRODUCTION _____ COMPLETED _____
 WELL LOCATED SW 1/4 NW 1/4 SE 1/4, North of South
 Line and _____ ft. East of West Line of Quarter Section
 Elevation (Relative to sea level) DERRICK FLOOR 2550 GROUND 2547
 CHARACTER OF WELL (Oil, gas or dryhole) Dryhole

OIL OR GAS SANDS OR ZONES

Name	From	To	Name	From	To
1			4		
2			5		
3			6		

Perforating Record If Any

Shot Record

Formation	From	To	No. of Shots	Formation	From	To	Size of Shot

CASING RECORD

Amount Set						Amount Pulled				Packer Record	
Size	Wt.	Thds.	Make	Ft.	In.	Ft.	In.	Size	Length	Depth Set	Make

Liner Record: Amount _____ Kind _____ Top _____ Bottom _____

CEMENTING AND MUDDING

Size	Amount Set		Sacks Cement	Chemical		Method of Cementing	Amount	Mudding Method	Results (See Note)
	Ft.	In.		Gal.	Make				
8 5/8"	207'		150	sx.	cement				

Note: What method was used to protect sands if outer strings were pulled? _____

NOTE: Were bottom hole plugs used? _____ If so, state kind, depth set and results obtained _____

TOOLS USED

Rotary Tools were used from 0 feet to R.T.D. Cable tools were used from _____ feet to _____ feet, and from _____ feet to _____ feet, and from _____ feet to _____ feet to _____

Type Rig Rotary

INITIAL PRODUCTION TEST

Describe initial test: whether by flow through tubing or casing or by pumping _____

Amount of Oil Production _____ bbls. Size of choke, if any _____ Length of test _____ Water Production _____ bbls. Gravity of oil _____ Type of Pump, if pump is used, describe _____

Formation	Top	Bottom	Formation	Top	Bottom
Surface		207			
Shale	207	1110			
Shale Sand	1110	1490			
Sand	1490	1930			
Redbed	1930	2112			
Anhydrite	2112	2150			
Shale shells	2150	2650			
Shale lime	2650	2910			
Lime shale	2910	3710			
R.T.D.	3710				

Log Tops

Tarkio
 Howard
 Heebner
 Toronto
 Lansing
 B/ Kansas City
 L.T.D.

Top

3190'
 3280'
 3464'
 3494'
 3510'
 3704'
 3710'

15-039-20165-00-00

RECEIVED
 STATE CORPORATION COMMISSION
 JUL 27 1970
 CONSERVATION DIVISION
 WICHITA, KANSAS

I, the undersigned, being first duly sworn upon oath, state that this well record is true, correct and complete according to the records of this office and to the best of my knowledge and belief.

John O. Farmer
 Name and title of representative of company
 President
 Subscribed and sworn to before me this 24th day of July, 1970
 My Commission expires 2/15/77
Helen Carlson
 Notary Public.

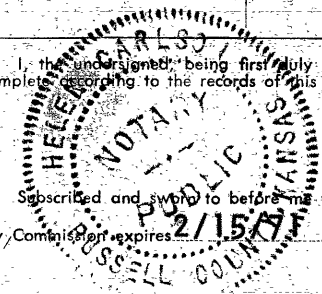

State of Kansas



15-039-20165-00-00

State Corporation Commission

CONSERVATION DIVISION

(Oil, Gas and Water)

500 Insurance Bldg.

212 N. Market

WICHITA, KANSAS 67202

July 24, 1970

WELL PLUGGING AUTHORITY

Well No.	4
Lease	Tachs
Description	SW NW SE 22-4-27W
County	Decatur
Total Depth	3710
Plugging Contractor	Co. Tools

John O. Farmer, Inc.
370 W. Wichita Ave.
Russell, Kansas 67665

Gentlemen:

This is your authority to plug the above subject well in accordance with the Rules and Regulations of the State Corporation Commission.

This authority is void after 90 days from the above date.

Very truly yours,

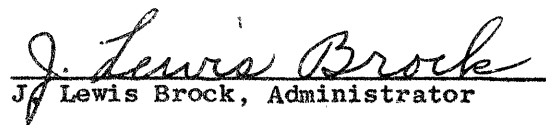
J. Lewis Brock, Administrator

Mr. W. L. Nichols Box 157 Morland, Kansas
is hereby assigned to supervise the plugging of the above named well.