

STATE OF KANSAS
STATE CORPORATION COMMISSION
CONSERVATION DIVISION
800 BITTING BUILDING
WICHITA, KANSAS

15-137-00089-00-00

WELL PLUGGING APPLICATION FORM

File One Copy

Lease Owner Jones, Shelburne & Farmer, Inc. Address Russell, Kansas
(Applicant)

Lease (Farm Name) Sanderson Well No. 1

Well Location SW SW SW Sec. 1 Twp. 4 Rge. (E)-(W) 24

County Norton Field Name (if any) Wildcat

Total Depth 3905 Oil Gas Dry Hole x

Was well log filed with application? yes. If not, explain: _____

Date and hour plugging is desired to begin 12-6-53 4:30 P. M.

Plugging of the well will be done in accordance with the Rules and Regulations of the State Corporation Commission, or with the approval of the following exceptions: Explain fully any exceptions desired.

(Use an additional sheet if necessary) None

Name of the person on the lease in charge of well for owner _____

Clay Wiley Address Russell, Kansas

Name of Plugging Contractor Jones, Shelburne & Farmer, Inc.

Address Russell, Kansas

Invoice covering assessment for plugging this well should be sent to

Jones, Shelburne & Farmer, Inc. Address Russell, Kansas

and payment will be guaranteed by applicant.

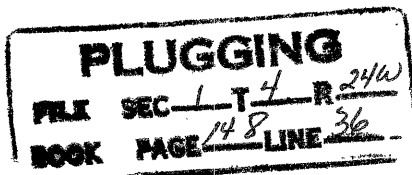

12-11-1953

John W. Farmer
Applicant or Acting Agent

Date December 10, 1953

OPERATOR Jones, Shelburne & Farmer, Inc.

15-137-00089-00-00

FORMATION RECORD

ADDRESS Russell, Kansas

Give detailed description and thickness of all formations drilled through, contents of sand, whether dry, water, oil or gas.

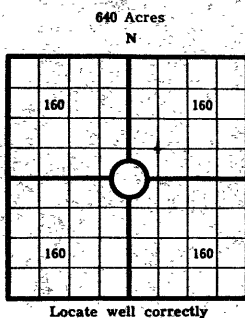

COUNTY Norton SEC 1 TWP 4 RGE 24
 COMPANY OPERATING Jones, Shelburne & Farmer, Inc.
 OFFICE ADDRESS Russell, Kansas
 FARM NAME Sanderson WELL NO. 1
 DRILLING STARTED 11-25-53 DRILLING FINISHED 12-5-53
 DATE OF FIRST PRODUCTION COMPLETED
 WELL LOCATED SW 1/4 SW 1/4 SW 1/4 North of South
 Line and _____ ft. East of West Line of Quarter-Section
 Elevation (Relative to sea level) DERRICK FLOOR 2519 GROUND
 CHARACTER OF WELL (Oil, gas or dryhole) Dry

OIL OR GAS SANDS OR ZONES

Name	From	To	Name	From	To
1			4		
2			5		
3			6		

Perforating Record If Any

Shot Record

Formation	From	To	No. of Shots	Formation	From	To	Size of Shot

CASING RECORD

Amount Set						Amount Pulled		Packer Record			
Size	Wt.	Thds.	Make	Ft.	In.	Ft.	In.	Size	Length	Depth Set	Make
8 5/8				280							

Liner Record: Amount _____ Kind _____ Top _____ Bottom _____

CEMENTING AND MUDDING

Size	Amount Set		Sacks Cement	Chemical		Method of Cementing	Amount	Mudding Method	Results (See Note)
	Ft.	In.		Gal.	Make				
8 5/8	280		125						

Note: What method was used to protect sands if outer strings were pulled? _____

NOTE: Were bottom hole plugs used? _____ If so, state kind, depth set and results obtained _____

TOOLS USED

Rotary Tools were used from _____ feet to _____ feet. Cable tools were used from _____ feet to _____ feet, and from _____ feet to _____ feet, and from _____ feet to _____ feet.

Type Rig _____

INITIAL PRODUCTION TEST

Describe initial test: whether by flow through tubing or casing or by pumping _____

Amount of Oil Production _____ bbls. Size of choke, if any _____ Length of test _____ Water _____

Production _____ bbls. Gravity of oil _____ Type of Pump if pump is used, describe _____

Formation	Top	Bottom	Formation	Top	Bottom
Surface	0	275			
Shale	275	500			
Shale & sand	500	1265			
Shale & shells	1265	1625			
Shale & sand	1625	2107			
Anhydrite	2107	2142			
Shale & shells	2142	2770			
Lime & shale	2770	3045			
Shale & lime	3045	3260			
Lime & shale	3260	3335			
Shale & lime	3335	3515			
Lime & shale	3515	3705			
Shale & lime	3705	3745			
Lime & shale	3745	3835			
Shale & lime	3835	3905			

TOPS:

Elevation 2521
 Heebner 3561
 Toronto 3583
 Lansing 3600
 Base K. C. 3787
 Bonnetarre Sand 3869
 Granite wash 3880
 T. D. 3905

PLUGGING
 FULL SEC. 1-4 R 246
 BACK PAGE 148 LINE 36

I, the undersigned, being first duly sworn upon oath, state that this well record is true, correct and complete according to the records of this office and to the best of my knowledge and belief.

Name and title of representative of company

Subscribed and sworn to before me this 8th day of December 1953

My Commission expires April 23, 1956

Notary Public.



STATE OF KANSAS
STATE CORPORATION COMMISSION
CONSERVATION DIVISION
800 BITTING BUILDING
WICHITA, KANSAS

15-137-00089-00-00

December 11, 1953

Well No.	1
Lease	Sanderson
Description	SE SW SW 1-4-21W
County	Horton
File No.	118-26

Jones, Shelburne, & Farmer
Russell
Kansas

Gentlemen:

This letter is your authority to plug the above subject well, in accordance with the Rules and Regulations of the State Corporation Commission. When you are ready to plug this well, please contact our District Plugging Supervisor, Mr. Eldon Petty, Box 326, Hays, Kans.

STATE CORPORATION COMMISSION
CONSERVATION DIVISION

BY:

J. P. ROBERTS

cc: District Plugging Supervisor