

STATE OF KANSAS  
STATE CORPORATION COMMISSION  
CONSERVATION DIVISION  
211 NORTH BROADWAY  
WICHITA, KANSAS

15-137-00206-00-00

WELL PLUGGING APPLICATION FORM  
File One Copy

Lease Owner D. G. Hansen Address Logan, Kansas  
(Applicant)  
Lease (Farm Name) ESSERT Well No. 1  
Well Location NW NW SE Sec. 3 Twp. 4 Rge. (E) - (W) 24  
County Norton Field Name (if any) Norton Pool  
Total Depth 3855 Oil Gas Dry Hole Dry  
Was well log filed with application? Yes If not, explain: \_\_\_\_\_

Date and hour plugging is desired to begin 10-8-55 9:00 PM

Plugging of the well will be done in accordance with the Rules and Regulations of the State Corporation Commission.

Name of the person on the lease in charge of well for owner \_\_\_\_\_

Dale Buchheister Address Plainville, Kansas

Plugging Contractor Jones, Shelburne & Farmer, Inc.

Plugging Contractor's License No. \_\_\_\_\_

Address Russell, Kansas

Invoice covering assessment for plugging this well should be sent to \_\_\_\_\_

D. G. Hansen Address Logan, Kansas

and payment will be guaranteed by applicant.

John W. Farmer  
Applicant or Acting Agent

Date October 15, 1955

RECEIVED  
STATE CORPORATION COMMISSION  
OCT 20 1955  
CONSERVATION DIVISION  
KANSAS  
**PLUGGING**  
FILE SEC 2 T 4 R 24 W  
BOOK PAGE 8 LINE 2

**OPERATOR** D. C. Hanson

**FORMATION RECORD**

**ADDRESS** Logan, Kansas

Give detailed description and thickness of all formations drilled through, contents of sand, whether dry, water, oil or gas.

FARM NAME Report COUNTY Norton WELL NO. 1 TWP. 4 SEC. 3 RGE. 24

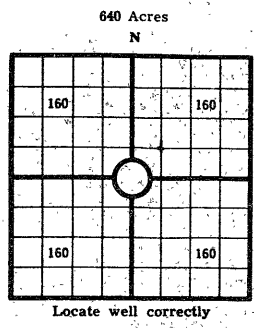

COUNTY Norton SEC 3 TWP 4 RGE 24  
 COMPANY OPERATING D. C. Hanson  
 OFFICE ADDRESS Logan, Kansas  
 FARM NAME Report WELL NO. 1  
 DRILLING STARTED 8-30 1955 DRILLING FINISHED 10-7-55  
 DATE OF FIRST PRODUCTION \_\_\_\_\_ COMPLETED \_\_\_\_\_  
 WELL LOCATED 1/4 1/4 1/4 North of South  
 Line and \_\_\_\_\_ ft. East of West Line of Quarter Section  
 Elevation (Relative to sea level) DERRICK FLOOR 2486 GROUND \_\_\_\_\_  
 CHARACTER OF WELL (Oil, gas or dryhole) Dry

OIL OR GAS SANDS OR ZONES					
Name	From	To	Name	From	To
1			4		
2			5		
3			6		

Perforating Record if Any				Shot Record			
Formation	From	To	No. of Shots	Formation	From	To	Size of Shot

CASING RECORD											
Amount Set						Amount Pulled				Packer Record	
Size	Wt.	Thds.	Make	Ft.	In.	Ft.	In.	Size	Length	Depth Set	Make
8 5/8				280							

CEMENTING AND MUDDING												
Amount Set				Chemical				Method of				Results (See Note)
Size	Ft.	In.	Sacks Cement	Gal.	Make	Method of Cementing	Amount	Mudding Method	Amount	Mudding Method		
8 5/8	280		180									

Note: What method was used to protect sands if outer strings were pulled?

NOTE: Were bottom hole plugs used? If so, state kind, depth set and results obtained

**TOOLS USED**  
 Rotary Tools were used from \_\_\_\_\_ feet to \_\_\_\_\_ feet to \_\_\_\_\_ feet, and from \_\_\_\_\_ feet to \_\_\_\_\_ feet, and from \_\_\_\_\_ feet to \_\_\_\_\_ feet to \_\_\_\_\_ feet.  
 Type Rig \_\_\_\_\_

**INITIAL PRODUCTION TEST**  
 Describe initial test: whether by flow through tubing or casing or by pumping \_\_\_\_\_  
 Amount of Oil Production \_\_\_\_\_ bbls. Size of choke, if any \_\_\_\_\_ Length of test \_\_\_\_\_ Water  
 Production \_\_\_\_\_ bbls. Gravity of oil \_\_\_\_\_ Type of Pump if pump is used, describe \_\_\_\_\_

Formation	Top	Bottom	Formation	Top	Bottom
Shale & sand	0	880			
Shale	880	720			
Shale & sand	720	905			
Sand	905	1115			
Shale	1115	1230			
Sand shale	1230	1370			
Shale	1370	1540			
Shale & shells	1540	1715			
Shale & sand	1715	1835			
Shale & redbed	1835	2050			
Anhydrite	2050	2050			
Shale	2050	2150			
Shale & shells	2150	2275			
Shale line shells	2275	2455			
Line & shale	2455	2455			
Shale	2455	2655			
Shale & line	2655	2615			
Shale	2615	2615			
Shale & line	2615	2890			
Line & shale	2890	2935			
Shale & line	2935	3075			
Line & shale	3075	3140			
Shale & line	3140	3245			
Line & shale	3245	3370			
Line	3370	3750			
Conglomerate	3750	3955			

**TOPS:**  
 Elev. 2480  
 Beebner 3501  
 Toronto 3529  
 Lansing 3544  
 T.D. 3555

RECEIVED  
 STATE COMMISSION  
 OCT 20 1955

PLUGGING  
 FILE SEC 3 T 4 R 244  
 BOOK PAGE 8 LINE 2

I, the undersigned, being first duly sworn upon oath, state that this well record is true, correct and complete according to the records of this office and to the best of my knowledge and belief.

John T. Pross  
 Name and title of representative of company

Subscribed and sworn to before me this 11th day of October 1955  
 My Commission expires July 14, 1959  
Bonnie Pratt  
 Notary Public.



STATE OF KANSAS  
 STATE CORPORATION COMMISSION  
 CONSERVATION DIVISION  
 211 NORTH BROADWAY  
 WICHITA, KANSAS

October 12, 1955

15-137-00206-00-00

Well No.	1
Lease	Essert
Description	NW NW SE 3-1-21W
County	Norton
File No.	8-2

Mr. D. G. Hansen  
 Logan  
 Kansas

Dear Sir:

This letter is your authority to plug the above subject well, in accordance with the Rules and Regulations of the State Corporation Commission. When you are ready to plug this well, please contact our District Plugging Supervisor, Mr. ~~Eidon Paffy, Box 226, Jays, Kansas.~~

STATE CORPORATION COMMISSION  
 CONSERVATION DIVISION

BY: S. S. Greider  
 S. S. Greider  
 WELL PLUGGING SUPERVISOR

cc:  
 District Plugging Supervisor