

STATE OF KANSAS  
STATE CORPORATION COMMISSION  
CONSERVATION DIVISION  
200 Colorado Derby Building  
Wichita, Kansas 67202

FORM CP-1  
Rev. 6/4/84

15-137-00533-00-00

WELL PLUGGING APPLICATION FORM  
(File One Copy)

API NUMBER June 22, 1954 (of this well)  
(This must be listed; if no API# was issued, please note drilling completion date.)

LEASE OPERATOR John O. Farmer, Inc. OPERATORS LICENSE NO. 5135  
ADDRESS P.O. Box 352, Russell, KS 67665 PHONE # (913) 483-3144  
LEASE (FARM) Green WELL NO. #4 WELL LOCATION C W/2 NW COUNTY Norton  
SEC. 1 TWP. 4S RGE. 24W ~~(XXX)~~ (W) TOTAL DEPTH 3832' PLUG BACK TD 3832'

Check One:

OIL WELL  GAS WELL \_\_\_\_\_ D & A \_\_\_\_\_ SWD or INJ WELL \_\_\_\_\_ DOCKET NO. \_\_\_\_\_  
SURFACE CASING SIZE 8-5/8" SET AT 280 CEMENTED WITH 125 SACKS  
CASING SIZE 5-1/2" SET AT 3829 CEMENTED WITH 75 SACKS  
PERFORATED AT Open hole, 3829-32 (3')

CONDITION OF WELL: GOOD \_\_\_\_\_ POOR \_\_\_\_\_ CASING LEAK  JUNK IN HOLE \_\_\_\_\_

OPERATOR'S SUGGESTED METHOD OF PLUGGING THIS WELL \_\_\_\_\_

(If additional space is needed use back of form)

IS WELL LOG ATTACHED TO THIS APPLICATION AS REQUIRED?  Yes IS ACO-1 FILED? Well drilled  
(If not, explain) (If not, explain) prior to inception of ACO-1

DATE AND HOUR PLUGGING IS DESIRED TO BEGIN 1:00 P.M., 11-15-84

PLUGGING OF THIS WELL WILL BE DONE IN ACCORDANCE WITH K.S.A. 55-101 et seq AND THE RULES AND REGULATIONS OF THE STATE CORPORATION COMMISSION.

NAME OF COMPANY REPRESENTATIVE AUTHORIZED TO BE IN CHARGE OF PLUGGING OPERATIONS: Lawrence Eichman PHONE # (913) 434-2444  
RECEIVED  
STATE CORPORATION COMMISSION  
10-30-1984  
OCT 30 1984

ADDRESS R. R. 1, Plainville, KS 67663 CONSERVATION DIVISION  
Wichita, Kansas

PLUGGING CONTRACTOR John O. Farmer, Inc. LICENSE NO. 5135

ADDRESS P.O. Box 352, Russell, KS 67665 PHONE # (913) 483-3144

PAYMENT WILL BE GUARANTEED BY OPERATOR OR AGENT SIGNED: John O. Farmer  
(Operator or Agent)

DATE: October 29, 1984

(6)

OPERATOR

Jones, Shillington & Farmer, Inc.

15-137-00533-00-00

FORMATION RECORD

ADDRESS

Well, Kansas

Give detailed description and thickness of all formations drilled through, contents of sand, whether dry, water, oil or gas.

RGE  
TWP  
SEC  
COUNTY  
WELL NO  
FARM NAME

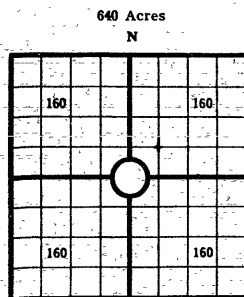

640 Acres  
N  
COUNTY Wichita SEC 1 TWP 4 RGE 24  
COMPANY OPERATING Jones, Shillington & Farmer, Inc.  
OFFICE ADDRESS Well, Kansas  
FARM NAME \_\_\_\_\_ WELL NO \_\_\_\_\_  
DRILLING STARTED 1975 DRILLING FINISHED \_\_\_\_\_ 19\_\_\_\_  
DATE OF FIRST PRODUCTION \_\_\_\_\_ COMPLETED \_\_\_\_\_  
WELL LOCATED 1/4 1/4 1/4 North of South  
Line and \_\_\_\_\_ ft. East of West line of Quarter Section  
Elevation (Relative to sea level) DERRICK FLOOR \_\_\_\_\_ GROUND \_\_\_\_\_  
CHARACTER OF WELL (Oil, gas or dryhole) \_\_\_\_\_

OIL OR GAS SANDS OR ZONES

Name	From	To	Name	From	To
1			4		
2			5		
3			6		

Perforating Record If Any

Shot Record

Formation	From	To	No. of Shots	Formation	From	To	Size of Shot

CASING RECORD

Amount Set						Amount Pulled				Packer Record	
Size	Wt.	Thds.	Make	Ft.	In.	Ft.	In.	Size	Length	Depth Set	Make
5 3/8				200							
5 1/2				300							

Liner Record: Amount \_\_\_\_\_ Kind \_\_\_\_\_ Top \_\_\_\_\_ Bottom \_\_\_\_\_

CEMENTING AND MUDDING

Size	Amount Set		Sacks Cement	Chemical		Method of Cementing	Amount	Mudding Method	Results (See Note)
	Ft.	In.		Gal.	Make				
5 1/2	300		125						

Note: What method was used to protect sands if outer strings were pulled? \_\_\_\_\_

NOTE: Were bottom hole plugs used? \_\_\_\_\_ If so, state kind, depth set and results obtained \_\_\_\_\_

TOOLS USED

Rotary Tools were used from \_\_\_\_\_ feet to \_\_\_\_\_ feet to \_\_\_\_\_ feet, and from \_\_\_\_\_ feet to \_\_\_\_\_ feet, and from \_\_\_\_\_ feet to \_\_\_\_\_ feet.

Type Rig \_\_\_\_\_

INITIAL PRODUCTION TEST

Describe initial test: whether by flow through tubing or casing or by pumping \_\_\_\_\_

Amount of Oil Production \_\_\_\_\_ bbls. Size of choke, if any \_\_\_\_\_ Length of test \_\_\_\_\_ Water

Production \_\_\_\_\_ bbls. Gravity of oil \_\_\_\_\_ Type of Pump if pump is used, describe \_\_\_\_\_

Formation	Top	Bottom	Formation	Top	Bottom
Shale & sand	0	259			
Shale sand shale	259	1530			
Shale & shale	1530	1720			
Sand	1720	1835			
Shale shale rather	1835	2080			
Anhydrite	2080	2111			
Shale & shale	2111	2275			
Shale & lime	2275	2375			
Lime & shale	2375	2485			
Shale & lime	2485	2550			
Lime & shale	2550	2660			
Shale & lime	2660	2760			
Lime & shale	2760	2860			
Shale & lime	2860	2950			
Lime & shale	2950	3025			
Shale & lime	3025	3170			
Shale & lime	3170	3295			
Lime & shale	3295	3795			
Shale & lime	3795	3830			
Anhydrite	3830	3830			

TOBS:  
Elev. 2506  
Depth 3520  
3830  
Lm. 3572  
Anh. 3828  
T. D. 3830

RECEIVED  
STATE CORPORATION COMMISSION  
OCT 30 1984  
CONSERVATION DIVISION  
Wichita, Kansas

I, the undersigned, being first duly sworn upon oath, state that this well record is true, correct and complete according to the records of this office and to the best of my knowledge and belief.

*John J. ...*  
Name and title of representative of company

Subscribed and sworn to before me this \_\_\_\_\_ day of \_\_\_\_\_ 1975

My Commission expires \_\_\_\_\_

*Bonnie Perryhill*  
Notary Public

State of Kansas



JOHN CARLIN  
MICHAEL LENNEN  
R. C. (PETE) LOUX  
PHILLIP R. DICK  
JUDITH MCCONNELL  
BRIAN J. MOLINE

GOVERNOR  
CHAIRMAN  
COMMISSIONER  
COMMISSIONER  
EXECUTIVE SECRETARY  
GENERAL COUNSEL

State Corporation Commission

CONSERVATION DIVISION

(Oil, Gas and Water)  
200 Colorado Derby Building  
202 West 1st Street  
WICHITA, KANSAS 67202-1286

THIS NOTICE

JAN 30 1985

October 30, 1984

15-137-00 533-00-00

EXPIRES

WELL PLUGGING NOTICE

Green #4  
C W/2 NW  
Sec. 1-4S-24W  
Norton County

John O. Farmer, Inc.  
P. O. Box 352  
Russell, KS 67665

Gentlemen:

This is your notice to plug the above subject well in accordance with the Rules and Regulations of the State Corporation Commission.

This notice is void after ninety (90) days from the above date.

Sincerely,

Jack M. McCord, Director

Please submit your proposal for plugging the above captioned well to  
DIST. #6 1014 Cody Hays, KS 67601

five days prior to plugging the well (KAR-82-3-113).