

STATE OF KANSAS
 STATE CORPORATION COMMISSION
 200 Colorado Derby Building
 Wichita, Kansas 67202

WELL PLUGGING RECORD
 K.A.R.-82-3-117

API NUMBER 15-039-20,152-00-00

LEASE NAME Tacha

WELL NUMBER #2

990 Ft. from S Section Line

1650 Ft. from E Section Line

SEC. 22 TWP. 4S RGE. 27 ~~XXXX~~ W)

COUNTY Decatur

Date Well Completed 4-18-70

11:15 A.M.

Plugging Commenced 6-28-88

Plugging Completed 12:30 P.M.
6-28-88

TYPE OR PRINT
 NOTICE: Fill out completely
 and return to Cons. Div.
 office within 30 days.

LEASE OPERATOR John O. Farmer, Inc.

ADDRESS P.O. Box 352, Russell, KS 67665

PHONE# (913) 483-3144 OPERATORS LICENSE NO. 5135

Character of Well Oil

(Oil, Gas, D&A, SWD, Input, Water Supply Well)

The plugging proposal was approved on June 23, 1988 (date)

by Dennis Hamel (KCC District Agent's Name).

Is ACO-1 filed? No If not, is well log attached? Yes

Producing Formation Lansing /KC Depth to Top 3476' Bottom 3660' T.D. 3695'

Show depth and thickness of all water, oil and gas formations.

OIL, GAS OR WATER RECORDS

CASING RECORD

Formation	Content	From	To	Size	Put in	Pulled out
Lansing/KC	oil	3476'	3660'	8-5/8"	211'	-0-
				5-1/2"	3691'	-0-

Describe in detail the manner in which the well was plugged, indicating where the mud fluid was placed and the method or methods used in introducing it into the hole. If cement or other plugs were used, state the character of same and depth placed, from feet to feet each set.

Down 5-1/2" casing @ 1000# maximum pressure - mixed 4 sks. hulls w/200 sks. cement and shut in @ 900#.

Down 8-5/8" casing (annulus) @ 400# maximum pressure - mixed 2 sks. hulls w/100 sks. cement and shut in @ 200#.

(If additional description is necessary, use BACK of this form.)

Name of Plugging Contractor John O. Farmer, Inc. License No. 5135

Address P.O. Box 352, Russell, KS 67665

STATE OF Kansas COUNTY OF Russell, ss.

John O. Farmer III ~~Operator~~ (Operator) of above-described well, being first duly sworn on oath, says: That I have knowledge of the facts, statements, and matters herein contained in the log of the above-described well as filed that the same are true and correct, so he depose and testify.

RECEIVED
 STATE CORPORATION COMMISSION

(Signature) John O. Farmer III

(Address) P.O. Box 352, Russell, KS 67665

SUBSCRIBED AND SWORN TO before me this 7th day of July, 19 88

CONSERVATION DIVISION
 Wichita, Kansas

Margaret A. Schulte
 Notary Public

My Commission Expires:

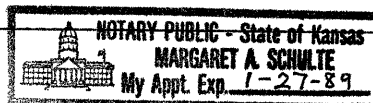

Margaret A. Schulte

OPERATOR John O. Farmer, Inc.

ADDRESS Box 352, Russell, Kansas

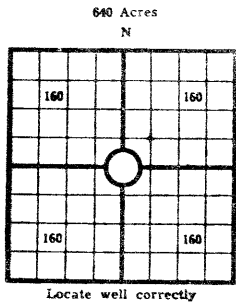

COUNTY Decatur, SEC. 22, TWP. 4S, RGE. 27W
 COMPANY OPERATING John O. Farmer, Inc.
 OFFICE ADDRESS Box 352, Russell, Ks.
 DRILLING STARTED 4/9, 1970, DRILLING FINISHED 4/18 1970
 DATE OF FIRST PRODUCTION _____ COMPLETED _____
 WELL LOCATED NE 1/4 SW 1/4 BE 1/4, North of South
 Line and _____ ft. East of West Line of Quarter Section
 Elevation (Relative to sea level) DERRICK FLOOR 2534 GROUND 2531
 CHARACTER OF WELL (Oil, gas or dryhole) Oil

OIL OR GAS SANDS OR ZONES

Name	From	To	Name	From	To
1			4		
2			5		
3			6		

Perforating Record If Any

Shot Record

Formation	From	To	No. of Shots	Formation	From	To	Size of Shot

CASING RECORD

Amount Set						Amount Pulled		Packer Record			
Size	Wt.	Thds.	Make	Ft.	In.	Ft.	In.	Size	Length	Depth Set	Make

Liner Record: Amount _____ Kind _____ Top _____ Bottom _____

CEMENTING AND MUDDING

Size	Amount Set		Sacks Cement	Chemical		Method of Cementing	Amount	Mudding Method	Results (See Note)
	Ft.	In.		Gal.	Make				
5/8"	211'		150 sx.			cement			
1/2"	3691'		175 sx.			cement			

Note: What method was used to protect sands if outer strings were pulled? _____

NOTE: Were bottom hole plugs used? _____ If so, state kind, depth set and results obtained _____

TOOLS USED

Rotary Tools were used from 0 feet to R.T.D. Cable tools were used from _____ feet to _____ feet, and from _____ feet to _____ feet, and from _____ feet to _____ feet
 Type Rig Rotary

INITIAL PRODUCTION TEST

Describe initial test: whether by flow through tubing or casing or by pumping _____

Amount of Oil Production _____ bbls. Size of choke, if any _____ Length of test _____ Water

Production _____ bbls Gravity of oil _____ Type of Pump if pump is used, describe _____

FORMATION RECORD

Give detailed description and thickness of all formation drilled through, contents of sand, whether dry, water, oil or gas.

Formation	Top	Bottom	Formation	Top	Bottom
Surface		211			
Shale	211	1000			
Sand Shale	1000	1580			
Sand	1750	1900			
Redbed	1900	2098			
Anhydrite	2098	2137			
Shale shells	2137	2285			
Shale lime	2285	2585			
Shale	2585	2875			
Lime shale	2875	3440			
Lime	3440	3695'			
T.D.					

RECEIVED
STATE CORPORATION COMMISSION

JUL 8 1988

7-8-88
CONSERVATION DIVISION
Wichita, Kansas

Log Tops

Tarkio
Howard
Heebner
Toronto
Lansing
Base Kansas C.
Log T.D.

Tops

3173'
3262'
3445'
3476'
3491'
3684'
3695'

15-039-20152-00-20

I, the undersigned, being first duly sworn upon oath, state that this well record is true, correct and complete according to the records of this office and to the best of my knowledge and belief.

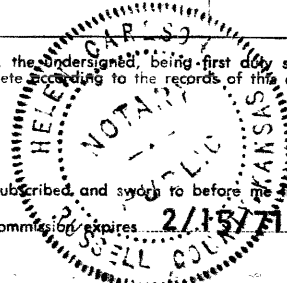

John O. Farmer
Name and title of representative of company President
Subscribed and sworn to before me this 23rd day of April, 1970
My Commission expires 2/15/71
Helen Carlson
Notary Public.

Helen Carlson

WELL NO. 2 COUNTY Decatur SEC. 22, TWP. 4S, RGE. 27W