

STATE OF KANSAS
 STATE CORPORATION COMMISSION
 200 Colorado Derby Building
 Wichita, Kansas 67202

WELL PLUGGING RECORD
 K.A.R.-82-3-117

15-137-00588-00-00
 Drilling Completed
 May, 1954

TYPE OR PRINT
 NOTICE: Fill out completely
 and return to Cons. Div.
 office within 30 days.

API NUMBER _____
 LEASE NAME Schoen "B"
 WELL NUMBER #3
3960 Ft. from S Section Line
660 Ft. from E Section Line
 SEC. 2 TWP. 4S RGE. 24 ~~XXXX~~(W)
 COUNTY Norton
 Date Well Completed 5-14-54
 Plugging Commenced 12:50 P.M.
5-12-88
 Plugging Completed 2:00 P.M.
5-12-88

LEASE OPERATOR John O. Farmer, Inc.
 ADDRESS P.O. Box 352, Russell, KS 67665
 PHONE# (913) 483-3144 OPERATORS LICENSE NO. 5135
 Character of Well Oil
 (Oil, Gas, D&A, SWD, Input, Water Supply Well)

The plugging proposal was approved on May 7, 1988 (date)
 by Dennis Hamel (KCC District Agent's Name).
 Is ACO-1 filed? No If not, is well log attached? Yes

Producing Formation Arbuckle Depth to Top 3809' Bottom 3813' T.D. 3813'
 Show depth and thickness of all water, oil and gas formations.

OIL, GAS OR WATER RECORDS			CASING RECORD			
Formation	Content	From	To	Size	Put in	Pulled out
Arbuckle	Oil	3809'	13'	8 5/8"	280'	-0-
				5-1/2"	3809'	-0-

Describe in detail the manner in which the well was plugged, indicating where the mud fluid was placed and the method or methods used in introducing it into the hole. If cement or other plugs were used, state the character of same and depth placed, from feet to feet each set.
Down 5-1/2" casing @ 600# maximum pressure. Mixed 4 sks. hulls w/175 sks. cement and shut in @ 300#.
Down annulus (8-5/8" casing) @ 400# maximum pressure. Mixed 1 sk. hulls w/75 sks. cement and shut in @ 200#. The casing was perforated 3 shots @ 1350' prior to cementing.
 (If additional description is necessary, use BACK of this form.)

Name of Plugging Contractor John O. Farmer, Inc. License No. 5135 1988
 Address P.O. Box 352, Russell, KS 67665
 STATE OF Kansas COUNTY OF Russell, ss.

RECEIVED
 STATE CORPORATION COMMISSION
 MAY 27 1988
 05-27-1988
 CONSERVATION DIVISION
 Wichita, Kansas

John O. Farmer III (Employee of Operator) or (Operator) of above-described well, being first duly sworn on oath, says: That I have knowledge of the facts, statements, and matters herein contained and the log of the above-described well as filed that the same are true and correct, so help me God.

(Signature) John O. Farmer III
 (Address) P.O. Box 352, Russell, KS 67665

SUBSCRIBED AND SWORN TO before me this 26th day of May, 19 88
Margaret A. Schulte
 Notary Public

My Commission Expires: _____
 NOTARY PUBLIC - State of Kansas
 MARGARET A. SCHULTE
 My Appt. Exp. 1-27-89

OPERATOR Jones, Shelburne & Farmer, Inc.

ADDRESS Russell, Kansas

15-137-00588-00-00 FORMATION RECORD

Give detailed description and thickness of all formations drilled through, contents of sand, whether dry, water, oil or gas.

SEC. 2, TWP. 4, RGE. 24
NORTON COUNTY
WELL NO. 3
FARM NAME Schoen B

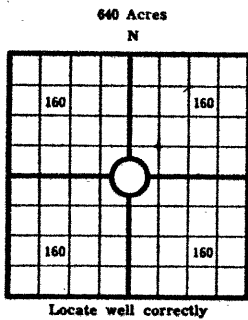

COUNTY Norton SEC 2 TWP 4 RGE 24
 COMPANY OPERATING Jones, Shelburne & Farmer, Inc.
 OFFICE ADDRESS Russell, Kansas
 FARM NAME Schoen B WELL NO. 3
 DRILLING STARTED 5-5-54 DRILLING FINISHED 5-11-54
 DATE OF FIRST PRODUCTION _____ COMPLETED _____
 WELL LOCATED 6 1/2 15/4 _____ North of South
 Line and _____ ft. East of West Line of Quarter Section
 Elevation (Relative to sea level) DERRICK FLOOR 2466 GROUND _____
 CHARACTER OF WELL (Oil, gas or dryhole) Oil

OIL OR GAS SANDS OR ZONES

Name	From	To	Name	From	To
1			4		
2			5		
3			6		

Perforating Record If Any

Shot Record

Formation	From	To	No. of Shots	Formation	From	To	Size of Shot

CASING RECORD

Amount Set							Amount Pulled		Packer Record		
Size	Wt.	Thds.	Make	Ft.	In.	Ft.	In.	Size	Length	Depth Set	Make
5/8				20							
5/8				309							

Liner Record: Amount _____ Kind _____ Top _____ Bottom _____

CEMENTING AND MUDDING

Size	Amount Set		Sacks Cement	Chemical		Method of Cementing	Amount	Mudding Method	Results (See Note)
	Ft.	In.		Gal.	Make				
5/8	20		125						
5/8	309		75						

Note: What method was used to protect sands if outer strings were pulled? _____

NOTE: Were bottom hole plugs used? _____ If so, state kind, depth set and results obtained _____

TOOLS USED

Rotary Tools were used from _____ feet to _____ feet. Cable tools were used from _____ feet to _____ feet, and from _____ feet to _____ feet, and from _____ feet to _____ feet.

Type Rig _____

INITIAL PRODUCTION TEST

Describe initial test: whether by flow through tubing or casing or by pumping _____

Amount of Oil Production _____ bbls. Size of choke, if any _____ Length of test _____ Water

Production _____ bbls. Gravity of oil _____ Type of Pump if pump is used, describe _____

Formation	Top	Bottom	Formation	Top	Bottom
Shale & sand	0	285	RECEIVED STATE CORPORATION COMMISSION MAY 27 1988 CONSERVATION DIVISION Wichita, Kansas		
Shale & shells	285	1485			
Shale & shells	1485	1720			
Sand	1720	1825			
Shale, shells & redbed	1825	1950			
Redbed	1950	2059			
Anhydrite	2059	2090			
Shale & shells	2090	2180			
Shale & lime	2180	2375			
Lime & shale	2375	2550			
Shale & lime	2550	2810			
Lime & shale	2810	2990			
Shale & lime	2990	3090			
Lime & shale	3090	3165			
Shale & lime	3165	3290			
Lime & shale	3290	3390			
Shale & lime	3390	3580			
Lime & shale	3580	3765			
Shale & lime	3765	3800			
Artuckle	3800	3813			

TOPS:
 Elevation 2466 R.B.
 Heebner 3508
 Toronto 3535
 Lansing 3550
 Base of L.C. 3732
 Artuckle 3808
 T.D. 3813

I, the undersigned, being first duly sworn upon oath, state that this well record is true, correct and complete according to the records of this office and to the best of my knowledge and belief.

John Farmer, Pres.
 Name and title of representative of company

Subscribed and sworn to before me this 19th day of May, 1954
 My Commission expires April 23, 1956
Donnie Perryhill
 Notary Public.