

STATE OF KANSAS
STATE CORPORATION COMMISSION

Give All Information Completely
Make Required Affidavit
Mail or Deliver Report to:
Conservation Division
State Corporation Commission
800 Bittling Building
Wichita, Kansas

WELL PLUGGING RECORD

15-037-00090-00-00

Norton County, Sec. 2 Twp. 4 Rge. (E) 24 (W)

Location as "NE/CNW/SW" or footage from lines NE NE SW
Lease Owner Jones, Shelburne & Farmer, Inc.
Lease Name Radloff Well No. 1
Office Address Russell, Kansas
Character of Well (completed as Oil, Gas or Dry Hole) Oil
Date well completed August 12 19 53
Application for plugging filed 9-18 19 55
Application for plugging approved 9-18 19 55
Plugging commenced 9-18 19 55
Plugging completed 9-28 19 55
Reason for abandonment of well or producing formation dry

NORTH

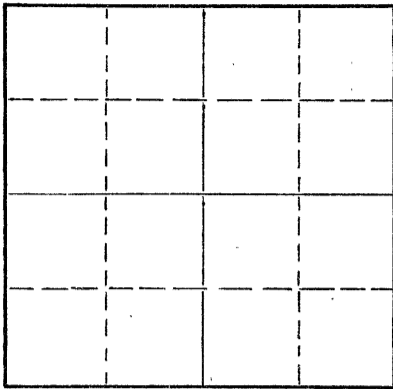

Locate well correctly on above
Section Plat

If a producing well is abandoned, date of last production _____ 19 ____
Was permission obtained from the Conservation Division or its agents before plugging was commenced? yes

Name of Conservation Agent who supervised plugging of this well Eldon Petty
Producing formation _____ Depth to top _____ Bottom _____ Total Depth of Well 3802 Feet
Show depth and thickness of all water, oil and gas formations.

OIL, GAS OR WATER RECORDS

CASING RECORD

FORMATION	CONTENT	FROM	TO	SIZE	PUT IN	PULLED OUT
				8 5/8	300	None
				5 1/2	3797	52 joints

Describe in detail the manner in which the well was plugged, indicating where the mud fluid was placed and the method or methods used in introducing it into the hole. If cement or other plugs were used, state the character of same and depth placed, from _____ feet to _____ feet for each plug set.

- Dumped 50 gallon sand on bottom, top of sand 3790-dumped 4 sacks cement on top of sand, shot pipe off at 3097.
- Spotted oil, unable to get over 14 inches tension, shot pipe at 2092, still stuck, shot pipe at 2000 and shot pipe at 1598.
- Pulled 52 joints pipe, muddied hole to 260', set rock bridge and ran 15 sacks cement, muddied hole to 35', set rock bridge to 30' and ran 10 sacks cement to top

RECEIVED
STATE CORPORATION COMMISSION
OCT 24 1955
10-24-1955
CONSERVATION DIVISION
Wichita, Kansas

(If additional description is necessary, use BACK of this sheet)
Name of Plugging Contractor West Supply Co.
Address Chase, Kansas

STATE OF Kansas, COUNTY OF Russell, ss.
John O. Farmer (employee of owner) or (owner or operator) of the above-described well, being first duly sworn on oath, says: That I have knowledge of the facts, statements, and matters herein contained and the log of the above-described well as filed and that the same are true and correct. So help me God.

(Signature) John O. Farmer
Russell, Kansas (Address)

SUBSCRIBED AND SWORN TO before me this 22nd day of October, 19 55

My commission expires July 14, 1958

Bernie Pratt
Notary Public.

PLUGGING
FILE SEC 2 T 4 R 24W
BOOK PAGE 149 LINE 23

ADDRESS Russell, Kansas

Give detailed description and thickness of all formations drilled through, contents of sand, whether dry, water, oil or gas.

FARM NAME Radloff
 WELL NO. 1
 COUNTY Norton
 SEC. 2
 TWP. 4
 RGE. 24

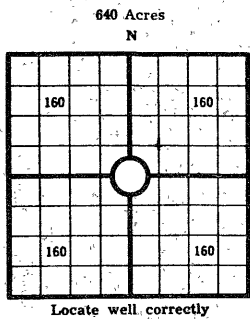

COUNTY Norton SEC. 2 TWP. 4 RGE. 24
 COMPANY OPERATING Jones, Shelburne & Farmer, Inc.
 OFFICE ADDRESS Russell, Kansas
 FARM NAME Radloff WELL NO. 1
 DRILLING STARTED 7-17 1953 DRILLING FINISHED 7-28 1953
 DATE OF FIRST PRODUCTION _____ COMPLETED _____
 WELL LOCATED NE 1/4 NE 1/4 SW 1/4 North of South
 Line and _____ ft. East of West Line of Quarter Section
 Elevation (Relative to sea level) DERRICK FLOOR 2469 GROUND _____
 CHARACTER OF WELL (Oil, gas or dryhole): Oil

Formation	Top	Bottom	Formation	Top	Bottom
Shale	0	20			
Shale & sand	20	1125			
Shale, shells & sand	1125	1625			
Shale & shells	1625	1700			
Sand	1700	1780			
Shale & shells	1780	2033			
Anhydrite	2033	2067			
Shale & shells	2067	2275			
Shale & lime	2275	2990			
Lime & shale	2990	3115			
Shale & lime	3115	3200			
Lime & shale	3200	3545			
Lime	3545	3645			
Lime & shale	3645	3800			
Lime	3800	3802			

TOPS:

- Elev 2469 R.B.
- Heebner 3494
- Toronto 3519
- Lanling 3534
- Arbuckle 3795
- T.D. 3802

RECEIVED
 CORPORATION COMMISSION
 PUGGING
 FILE SEC. 2-1-7-19 249
 OCT 27 1955
 CONSERVATION DIVISION
 Wichita, Kansas

OIL OR GAS SANDS OR ZONES

Name	From	To	Name	From	To
1			4		
2			5		
3			6		

Perforating Record If Any Shot Record

Formation	From	To	No. of Shots	Formation	From	To	Size of Shot

CASING RECORD

Amount Set				Amount Pulled				Packer Record			
Size	Wt.	Thds.	Make	Ft.	In.	Ft.	In.	Size	Length	Depth Set	Make
5/8				300							
1/2				3797							

Liner Record: Amount _____ Kind _____ Top _____ Bottom _____

CEMENTING AND MUDDING

Size	Amount Set		Sacks Cement	Chemical		Method of Cementing	Amount	Mudding Method	Results (See Note)
	Ft.	In.		Gal.	Make				
5/8	3797		100						
5/8	300		200						

Note: What method was used to protect sands if outer strings were pulled? _____

NOTE: Were bottom hole plugs used? _____ If so, state kind, depth set and results obtained _____

TOOLS USED

Rotary Tools were used from _____ feet to _____ Cable tools were used from _____ feet to _____ feet, and from _____ feet to _____ feet, and from _____ feet to _____ feet to _____

Type Rig _____

INITIAL PRODUCTION TEST

Describe initial test: whether by flow through tubing or casing or by pumping _____

Amount of Oil Production _____ bbls. Size of choke, if any _____ Length of test _____ Water Production _____ bbls. Gravity of oil _____ Type of Pump if pump is used, describe _____

I, the undersigned, being first duly sworn upon oath, state that this well record is true, correct and complete according to the records of this office and to the best of my knowledge and belief.

John E. Ferment Vice-Pres.
 Name and title of representative of company

Subscribed and sworn to before me this 22nd day of October, 1955
 My Commission expires July 14, 1958
Pamela Pratt
 Notary Public.