

15-137-~~883~~33-00-00

STATE OF KANSAS  
STATE CORPORATION COMMISSION  
200 Colorado Derby Building  
Wichita, Kansas 67202

WELL PLUGGING RECORD  
K.A.R.-82-3-117

(Drilled Prior to  
Inception of

API NUMBER API# 6-22-54

LEASE NAME Green

WELL NUMBER #4

SPOT LOCATION C W/2 NW

SEC. 1 TWP. 4S RGE. 24 W (W)

COUNTY Norton

Date Well Completed 6-22-54  
10:00 A.M.

Plugging Commenced 12-3-84  
10:45 A.M.

Plugging Completed 12-3-84

TYPE OR PRINT  
NOTICE: Fill out completely  
and return to Cons. Div.  
office within 30 days.

LEASE OPERATOR John O. Farmer, Inc.

ADDRESS P.O. Box 352, Russell, KS 67665

PHONE # (913) 483-3144 OPERATORS LICENSE NO. 5135

Character of Well Oil  
(Oil, Gas, D&A, SWD, Input, Water Supply Well)

Did you notify the KCC/KDHE Joint District Office prior to plugging this well? Yes

Which KCC/KDHE Joint Office did you notify? District #6

Is ACO-1 filed? No if not, is well log attached? Yes

Producing formation Arbuckle Depth to top 3828' bottom 3832' T.D. 3832'

Show depth and thickness of all water, oil and gas formations.

OIL, GAS OR WATER RECORDS | CASING RECORD

Formation	Content	From	To	Size	Put in	Pulled out
Arbuckle	oil & water	3828'	32'	8-5/8"	280'	-0-
				5-1/2"	3829'	-0-

Describe in detail the manner in which the well was plugged, indicating where the mud fluid was placed and the method or methods used in introducing it into the hole. If cement or other plugs were used state, the character of same and depth placed, from feet to feet each set. Plugged with 285 sks. down 5-1/2" casing and 35 sacks down 8-5/8" casing. Used a total of 6 sacks of hulls.

(If additional description is necessary, use BACK of this form.)

Name of Plugging Contractor John O. Farmer, Inc. License No. 5135  
Address P.O. Box 352, Russell, KS 67665

RECEIVED  
STATE CORPORATION COMMISSION

STATE OF Kansas COUNTY OF Russell, ss.

John O. Farmer III

(operator) of above-described well, being first duly sworn on oath, says: That I have knowledge of the facts, statements, and matters herein contained and the log of the above-described well as filed that the same are true and correct, so help me God.

(Signature) John O. Farmer III

(Address) P.O. Box 352, Russell, KS 67665

DEC 14 1984  
12-14-1984  
CONSERVATION DIVISION  
Wichita, Kansas



SUBSCRIBED AND SWORN TO before me this 13th day of December, 1984

Margaret A. Schulte  
Notary Public  
Margaret A. Schulte

My Commission expires: January 27, 1985

OPERATOR Jones, Shalburne & Farmer, Inc.

15-137-00533-00-00

FORMATION RECORD

ADDRESS Russell, Kansas

Give detailed description and thickness of all formations drilled through, contents of sand, whether dry, water, oil or gas.

24  
 RGE  
 4  
 TWP  
 1  
 SEC  
 4  
 COUNTY  
 NORTON  
 4  
 WELL NO  
 GREEN  
 FARM NAME

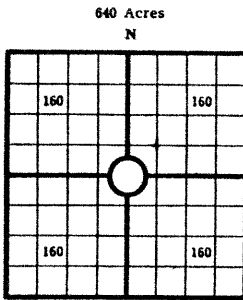

COUNTY Norton SEC 1 TWP 4 RGE 24  
 COMPANY OPERATING Jones, Shalburne & Farmer, Inc.  
 OFFICE ADDRESS Russell, Kansas  
 FARM NAME Green WELL NO 4  
 DRILLING STARTED 6-15-54, DRILLING FINISHED 6-22-54  
 DATE OF FIRST PRODUCTION \_\_\_\_\_ COMPLETED \_\_\_\_\_  
 WELL LOCATED C W/2 NW/4 \_\_\_\_\_ North of South  
 Line and \_\_\_\_\_ ft. East of West line of Quarter Section  
 Elevation (Relative to sea level) DERRICK FLOOR 2506 GROUND \_\_\_\_\_  
 CHARACTER OF WELL (Oil, gas or dryhole) oil

OIL OR GAS SANDS OR ZONES

Name	From	To	Name	From	To
1			4		
2			5		
3			6		

Perforating Record if Any

Shot Record

Formation	From	To	No. of Shots	Formation	From	To	Size of Shot

CASING RECORD

Amount Set						Amount Pulled		Packer Record	
Size	Wt.	Thds.	Make	Ft.	In.	Ft.	In.	Size	Length
2 5/8				280					
5 1/2				3829					

Liner Record: Amount \_\_\_\_\_ Kind \_\_\_\_\_ Top \_\_\_\_\_ Bottom \_\_\_\_\_

CEMENTING AND MUDDING

Size	Amount Set		Sacks Cement	Chemical		Method of Cementing	Amount	Mudding Method	Results (See Note)
	Ft.	In.		Gal.	Make				
5 1/2	280		125						
5 1/2	3829		75						

Note: What method was used to protect sands if outer strings were pulled? \_\_\_\_\_

NOTE: Were bottom hole plugs used? \_\_\_\_\_ If so, state kind, depth set and results obtained \_\_\_\_\_

TOOLS USED

Rotary Tools were used from \_\_\_\_\_ feet to \_\_\_\_\_ Cable tools were used from \_\_\_\_\_ feet to \_\_\_\_\_ feet, and from \_\_\_\_\_ feet to \_\_\_\_\_ feet, and from \_\_\_\_\_ feet to \_\_\_\_\_ feet to \_\_\_\_\_

Type Rig \_\_\_\_\_

INITIAL PRODUCTION TEST

Describe initial test: whether by flow through tubing or casing or by pumping \_\_\_\_\_

Amount of Oil Production \_\_\_\_\_ bbls. Size of choke, if any \_\_\_\_\_ Length of test \_\_\_\_\_ Water

Production \_\_\_\_\_ bbls. Gravity of oil \_\_\_\_\_ Type of Pump if pump is used, describe \_\_\_\_\_

Formation	Top	Bottom	Formation	Top	Bottom
Shale & sand	0	299			
Shale sand shells	299	1530			
Shale & shells	1530	1720			
Sand	1720	1835			
Shale shells redbed	1835	2083			
Anhydrite	2083	2114			
Shale & shells	2114	2175			
Shale & lime	2175	2375			
Lime & shale	2375	2535			
Shale & lime	2535	2850			
Lime & shale	2850	3020			
Shale & lime	3020	3120			
Lime & shale	3120	3260			
Shale & lime	3260	3350			
Lime & shale	3350	3475			
Shale & lime	3475	3570			
Shale & lime	3570	3635			
Lime & shale	3635	3755			
Shale & lime	3755	3828			
Dolomite	3828	3832			

RECEIVED  
 STATE CORPORATION COMMISSION  
 DEC 14 1984  
 CONSERVATION DIVISION  
 Wichita, Kansas

TOPS:  
 Elev. 2506  
 Hoob 3528  
 DERRICK  
 Len 3571  
 Arb. 3828  
 T. D. 3832

I, the undersigned, being first duly sworn upon oath, state that this well record is true, correct and complete according to the records of this office and to the best of my knowledge and belief.

*John Shalburne, Jr.*  
 Name and title of representative of company

Subscribed and sworn to before me this 25th day of June, 1954  
 My Commission expires April 23, 1956  
*Bonnie Berryhell*  
 Notary Public