

R
STATE OF KANSAS
STATE CORPORATION COMMISSION
CONSERVATION DIVISION
500 INSURANCE BUILDING
212 NORTH MARKET
WICHITA 2, KANSAS

RECEIVED
COMMISSION
DEC 8 1959
12-8-59
CONSERVATION DIVISION
Wichita, Kansas

WELL PLUGGING APPLICATION FORM
File One Copy

Lease Owner JOHN O. FARMER, INC. 15-023-00027-00-00
(Applicant)
Address Russell, Kansas

Lease (Farm Name) ANDERSON Well No. 1

Well Location SW NW Sec. 28 Twp. 4S Rge. (E) (W) 39

County Cheyenne Field Name (if any) _____

Total Depth 5190 Oil Well _____ Gas Well _____ Input Well _____ SWD Well _____ D & A X

Was well log filed with application? yes If not, explain: _____

Date and hour plugging is desired to begin 11/29/59 7:30 AM

Plugging of the well will be done in accordance with the Rules and Regulations of the State Corporation Commission.

Name of person on the lease in charge of well for owner _____
Dale Buchheister Address Plainville, Kansas

Plugging Contractor JOHN O. FARMER, INC. License No. _____
Address Russell, Kansas

Invoice covering assessment for plugging this well should be sent to _____
JOHN O. FARMER, INC. Address Russell, Kansas

and payment will be guaranteed by applicant.

Signed: John O. Farmer
Applicant or Acting Agent

Date: December 3, 1959

OPERATOR JOHN O. FARMER, INC.

FORMATION RECORD

ADDRESS Russell, Kansas

Give detailed description and thickness of all formation drilled through, contents of sand, whether dry, water, oil or gas.

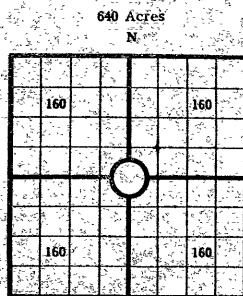

COUNTY Cheyenne SEC. 28, TWP. 4S, RGE. 39W
 COMPANY OPERATING JOHN O. FARMER, INC.
 OFFICE ADDRESS RUSSELL, KANSAS
 DRILLING STARTED 11/10, 1959, DRILLING FINISHED 11/29, 1959
 DATE OF FIRST PRODUCTION COMPLETED
 WELL LOCATED SW 1/4 NW 1/4 North of South
 Line and _____ ft. East of West Line of Quarter Section
 Elevation (Relative to sea level) DERRICK FLOOR 3512 GROUND 3509
 CHARACTER OF WELL (Oil, gas or dryhole) Dry

OIL OR GAS SANDS OR ZONES

Name	From	To	Name	From	To
1			4		
2			5		
3			6		

Perforating Record if Any

Shot Record

Formation	From	To	No. of Shots	Formation	From	To	Size of Shot

CASING RECORD

Amount Set						Amount Pulled			Packer Record		
Size	Wt.	Thds.	Make	Ft.	In.	Ft.	In.	Size	Length	Depth Set	Make
8-5/8				325							

Liner Record: Amount _____ Kind _____ Top _____ Bottom _____

CEMENTING AND MUDDING

Size	Amount Set		Sacks Cement	Chemical		Method of Cementing	Amount	Mudding Method	Results (See Note)
	Ft.	In.		Gal.	Make				
8-5/8	325		175						

Note: What method was used to protect sands if outer strings were pulled?

NOTE: Were bottom hole plugs used? _____ If so, state kind, depth set and results obtained _____

TOOLS USED

Rotary Tools were used from _____ feet to _____ feet to _____ feet and from _____ feet to _____ feet, and from _____ feet to _____ feet, and from _____ feet to _____ feet.

Type Rig _____

INITIAL PRODUCTION TEST

Describe initial test: whether by flow through tubing or casing or by pumping _____

Amount of Oil Production _____ bbls. Size of choke, if any _____ Length of test _____ Water
 Production _____ bbls. Gravity of oil _____ Type of Pump if pump is used, describe _____

Formation	Top	Bottom	Formation	Top	Bottom
FARM NAME			ANDERSON #1		
Surface	0	324			
Shale	324	1600			
Shale & sand	1600	2100			
Shle, sand & shells	2100	2310	FORMATION TOES:		
Shale & shells	2310	2615	ELEVATION: RB	3514	
Shale, sand & shells	2615	2780	sample log		
Shale & shells	2780	2915	Topeka	4164	4163
Shale, lime w/ gyps strings	2915	2975	Huebner	4307	4292
Shale & lime	2975	3100	Toronto	4327	4329
Shale & redbed	3100	3280	Lansing	4350	4344
Shale & shells	3280	3452	B/KC	4645	4634
Lime & shale	3452	3464	Marmaton	4660	4646
Shale & lime	3464	4064	Cherokee	4811	4810
Lime & shale	4064	5085	Mississippi	5090	5090
Shale & Lime	5085	5090	Total depth	5190	5190
Lime & shale	5090	5190	D & A		
T.D.		5190			

RECEIVED
 STATE CORPORATION COMMISSION
 DEC 8 1959
 DIVISION

I, the undersigned, being first duly sworn upon oath, state that this well record is true, correct and complete according to the records of this office and to the best of my knowledge and belief.

John O. Farmer Pres.
 Name and title of representative of company

Subscribed and sworn to before me this 3rd day of December, 1959My Commission expires 10/11/62

Lucille Ramsey
 Notary Public

WELL NO. 1 COUNTY Cheyenne TWP. 4S RGE. 39W FARM NAME ANDERSON

State of Kansas



15-023-00027-00-00

State Corporation Commission

CONSERVATION DIVISION

(Oil, Gas and Water)

500 Interstate Bldg. 212 N. Market

WICHITA, KANSAS

JEWEL M. OGDEN, Director

GEORGE DOCKING Governor
 HARRY G. WILES Chairman
 MARION BEATTY Commissioner
 RICHARD C. BYRD Commissioner
 RAYMOND B. HARVEY Secretary
 J. ROBERT WILSON Counsel

WELL PLUGGING AUTHORITY December 9, 1959

Well No. 1
 Lease Anderson
 Description SW NW 28-4-39W
 County Cheyenne

John O. Farmer Inc.
Russell, Kansas

Gentlemen:

This is your authority to plug the above subject well in accordance with the Rules and Regulations of the State Corporation Commission.

This authority is void after 90 days from the above date.

Very truly yours,

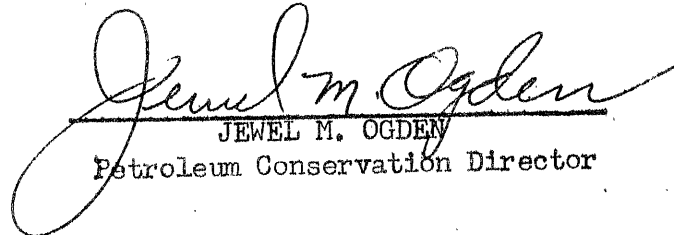
 JEWEL M. OGDEN
 Petroleum Conservation Director

Mr. Fabricius is hereby assigned to supervise the plugging of the above named well.

In the event you need any further information regarding this well feel free to write or call me at any time.

J. Lewis Brock
 Western Kansas Field Supervisor
 P. O. Box 569
 Great Bend, Kansas
 Phone: GL-33022