

STATE CORPORATION COMMISSION OF KANSAS
OIL & GAS CONSERVATION DIVISION
WELL COMPLETION OR RECOMPLETION FORM
ACO-1 WELL HISTORY

DESCRIPTION OF WELL AND LEASE

Operator: License # 4548
Name Oneok Exploration Company
Address P. O. Box 871
City/State/Zip Tulsa, Oklahoma 74105

Purchaser.....

Operator Contact Person Wm. Clark Southmayd
Phone 918-588-7700

Contractor: License # 5302
Name Red Tiger Drilling Company

Wellsite Geologist Bob Posey
Phone (316) 624-5919

Designate Type of Completion
 New Well Re-Entry Workover
 Oil S.W.D. Temp Abd
 Gas Inj Delayed Comp.
 Dry Other (Core, Water Supply etc.)

If OWWO: old well info as follows:
Operator
Well Name
Comp. Date Old Total Depth.....

WELL HISTORY

Drilling Method:
 Mud Rotary Air Rotary Cable
5/21/86 5/31/86 6/1/86
Spud Date Date Reached TD Completion Date
4,790'
Total Depth PBTD
Amount of Surface Pipe Set and Cemented at Well Street 414.96
Multiple Stage Cementing Collar Used at Well Street Yes No
If yes, show depth set.....feet
If alternate 2 completion, cement circulated from.....feet depth to.....w/.....SX cnt

RECEIVED
STATE CORPORATION COMMISSION
6-16-86
JUN 16 1986

API NO. 15-023-20,246-00-00
County Cheyenne
220' SW of
C SW/4 NE/4 Sec. 14 Twp. 4S Rge. 37W East West

3160 Ft North from Southeast Corner of Section
2120 Ft West from Southeast Corner of Section
(Note: Locate well in section plat below)

Lease Name Seymour Well # 1-14

Field Name Wildcat

Producing Formation.....

Elevation: Ground 3374' KB 3379'

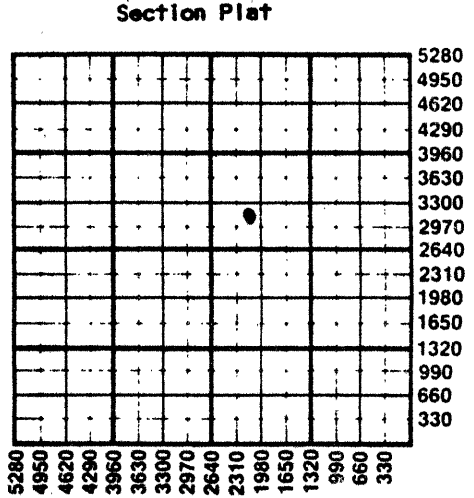

WATER SUPPLY INFORMATION
Disposition of Produced Water: Disposal Repressuring
Docket #

Questions on this portion of the ACO-1 call:
Water Resources Board (913) 296-3717
Source of Water:
Division of Water Resources Permit #.....
 Groundwater 4800 Ft North from Southeast Corner
(Well) 3000 Ft West from Southeast Corner of
Sec 14 Twp 4 Rge 37 East West
Seymour Farms, Bird City, Ks. 67731
 Surface Water.....Ft North from Southeast Corner
(Stream, pond etc).....Ft West from Southeast Corner
Sec Twp Rge East West
 Other (explain).....
(purchased from city, R.W.D. #)

INSTRUCTIONS: This form shall be completed in duplicate and filed with the Kansas Corporation Commission, 200 Colorado Derby Building, Wichita, Kansas 67202, within 90 days after completion or recompletion of any well. Rule 82-3-130 and 82-3-107 apply. Information on side two of this form will be held confidential for a period of 12 months if requested in writing and submitted with the form. See rule 82-3-107 for confidentiality in excess of 12 months. One copy of all wireline logs and drillers time log shall be attached with this form. Submit CP-4 form with all plugged wells. Submit CP-111 form with all temporarily abandoned wells.

All requirements of the statutes, rules and regulations promulgated to regulate the oil and gas industry have been fully complied with and the statements herein are complete and correct to the best of my knowledge.

Signature Wm. Clark Southmayd
Title Drilling and Production Engineer Date 6/9/86

Subscribed and sworn to before me this 9th day of June 1986
Notary Public Helen L. Heath

Date Commission Expires November 24, 1989

K.C.C. OFFICE USE ONLY
F Letter of Confidentiality Attached
C Wireline Log Received
C Drillers Time Log Received
Distribution
 KCC S.W.D./Rep NGPA
 KGS Plug Other
(Specify)

SIDE TWO

Operator Name Oneok Exploration Co. Lease Name..... Seymour Well #..... 1-14

Sec..... 14 Twp..... 4S Rge..... 37W East West County..... Cheyenne

WELL LOG

INSTRUCTIONS: Show important tops and base of formations penetrated. Detail all cores. Report all drill stem tests giving interval tested, time tool open and closed, flowing and shut-in pressures, whether shut-in pressure reached static level, hydrostatic pressures, bottom hole temperature, fluid recovery, and flow rates if gas to surface during test. Attach extra sheet if more space is needed. Attach copy of log.

Drill Stem Tests Taken <input checked="" type="checkbox"/> Yes <input type="checkbox"/> No Samples Sent to Geological Survey <input checked="" type="checkbox"/> Yes <input type="checkbox"/> No Cores Taken <input type="checkbox"/> Yes <input checked="" type="checkbox"/> No	Formation Description <input checked="" type="checkbox"/> Log <input type="checkbox"/> Sample
----------------------------------------------------------------------------------------------------------------------------------------------------------------------------------------------------------------------------------------------------------------------------------------	--------------------------------------------------------------------------------------------------

DST #1 4274'-4280' IHP 1961, IFF 34#, FFF 34#, 20 min. IFC 34#, FFC 1047#, 40 min. ISF 38#, FSF 38#, 20 min. ISC 38#, FSC 980#, 40 min. FHP 2091# Rec. 2' mud DST #2 4326'-4332' IHP 2188#, IFF 62#, FFF 62#, 40 min. IFC 67#, FFC 1343#, 60 min. ISF 67#, FSF 67#, 40 min. ISC 67#, FSC 1289#, 60 min. FHP 2163# Rec. 10' mud DST #3 4644'-4650' IHP 2384#, IFF 54#, FFF 58#, 40 min. IFC 58#, FFC 824#, 60 min. ISF 58#, FSF 58#, 40 min. ISC 58#, FSC 599#, 60 min. FHP 2372# Rec. 10' mud. DST #4 IHP 2471#, IFF 67#, FFF 67#, 20 min. IFC 67#, FFC 399#, 60 min.; ISC 67#, FSC 67#, 20 min.; ISC 67#, FSC 183#, 60 min. FHP 2413#	<table border="0" style="width:100%"> <tr> <th style="text-align:left">Name</th> <th style="text-align:left">Top</th> <th style="text-align:left">Bottom</th> </tr> <tr> <td>Lansing</td> <td>4232</td> <td></td> </tr> <tr> <td>Lansing "A"</td> <td>4280*</td> <td></td> </tr> <tr> <td>Lansing "B"</td> <td>4353*</td> <td></td> </tr> <tr> <td>Lansing "C"</td> <td>4408</td> <td></td> </tr> <tr> <td>Marmaton</td> <td>4566</td> <td></td> </tr> <tr> <td>Pawnee</td> <td>4626</td> <td></td> </tr> <tr> <td>Fort Scott</td> <td>4656*</td> <td></td> </tr> <tr> <td>Cherokee</td> <td>4718*</td> <td></td> </tr> </table> <p>*Intervals tested with DST</p>	Name	Top	Bottom	Lansing	4232		Lansing "A"	4280*		Lansing "B"	4353*		Lansing "C"	4408		Marmaton	4566		Pawnee	4626		Fort Scott	4656*		Cherokee	4718*	
Name	Top	Bottom																										
Lansing	4232																											
Lansing "A"	4280*																											
Lansing "B"	4353*																											
Lansing "C"	4408																											
Marmaton	4566																											
Pawnee	4626																											
Fort Scott	4656*																											
Cherokee	4718*																											

CASING RECORD <input checked="" type="checkbox"/> New <input type="checkbox"/> Used Report all strings set-conductor, surface, intermediate, production, etc.							
Purpose of String	Size Hole Drilled	Size Casing Set (in O.D.)	Weight Lbs/Ft.	Setting Depth	Type of Cement	#Sacks Used	Type and Percent Additives
Surface	12 1/4"	8 5/8"	24#	422'	60/40 poz.	260	2% Gel 3%CC
PERFORATION RECORD				Acid, Fracture, Shot, Cement Squeeze Record			
Shots Per Foot	Specify Footage of Each Interval Perforated	(Amount and Kind of Material Used)		Depth			
TUBING RECORD				Liner Run <input type="checkbox"/> Yes <input type="checkbox"/> No			
Date of First Production		Producing Method <input type="checkbox"/> Flowing <input type="checkbox"/> Pumping <input type="checkbox"/> Gas Lift <input type="checkbox"/> Other (explain).....					
Estimated Production Per 24 Hours	Oil	Gas	Water	Gas-Oil Ratio		Gravity	
	Bbls	MCF	Bbls			CFPB	

METHOD OF COMPLETION		Production Interval
Disposition of gas: <input type="checkbox"/> Vented <input type="checkbox"/> Open Hole <input type="checkbox"/> Perforation	<input type="checkbox"/> Sold <input type="checkbox"/> Other (Specify)
<input type="checkbox"/> Used on Lease	<input type="checkbox"/> Dually Completed
	<input type="checkbox"/> Commingled