

For KCC Use: 11-21-04
Effective Date: _____
District # 1
SGA? Yes No

KANSAS CORPORATION COMMISSION
OIL & GAS CONSERVATION DIVISION **OWWO**

Form C-1
December 2002
Form must be Typed
Form must be Signed
All blanks must be Filled

NOTICE OF INTENT TO DRILL

Must be approved by KCC five (5) days prior to commencing well

Expected Spud Date November 22nd, 2004
month day year

OPERATOR: License# 32798
Name: Hart Energies, L.L.C.
Address: 11051 So. Memorial, #200
City/State/Zip: Tulsa, OK 74133
Contact Person: William G. Hart
Phone: 918-369-3315

CONTRACTOR: License# 5892
Name: Berentz Drilling Co., Inc.

Spot SE SE Sec. 2 Twp. 31 S. R. 10
330 feet from N / S Line of Section
330 feet from E / W Line of Section
Is SECTION Regular Irregular?

(Note: Locate well on the Section Plat on reverse side)

County: Barber
Lease Name: Marlyne Well #: 1
Field Name: Spivey-Grabbs

Is this a Prorated / Spaced Field? Yes No
Target Information(s): Arbuckle
Nearest Lease or unit boundary: 330'

Ground Surface Elevation: 1747 RB feet MSL
Water well within one-quarter mile: Yes No
Public water supply well within one mile: Yes No

Depth to bottom of fresh water: 180' 150'
Depth to bottom of usable water: 180'
Surface Pipe by Alternate: 1 2

Length of Surface Pipe Planned to be set: 266' (OWWO)
Length of Conductor Pipe required: none
Projected Total Depth: 5300'
Formation at Total Depth: Arbuckle

Water Source for Drilling Operations:
 Well Farm Pond Other
DWR Permit #: 20040209

(Note: Apply for Permit with DWR)

Will Cores be taken? Yes No
If Yes, proposed zone: _____

Well Drilled For: Oil Gas OWWO Seismic; # of Holes _____ Other _____
 Enh Rec Storage Disposal
Well Class: Infield Pool Ext. Wildcat Other _____
Type Equipment: Mud Rotary Air Rotary Cable

If OWWO: old well information as follows:
Operator: Petroleum, Inc.
Well Name: #1 Rankin
Original Completion Date: 10-12-56 Original Total Depth: 4549'

Directional, Deviated or Horizontal wellbore? Yes No
If Yes, true vertical depth: _____
Bottom Hole Location: _____
KCC DKT #: _____

AFFIDAVIT

The undersigned hereby affirms that the drilling, completion and eventual plugging of this well will comply with K.S.A. 55 et. seq.
It is agreed that the following minimum requirements will be met:

1. Notify the appropriate district office **prior** to spudding of well;
2. A copy of the approved notice of intent to drill **shall be** posted on each drilling rig;
3. The minimum amount of surface pipe as specified below **shall be set** by circulating cement to the top; in all cases surface pipe **shall be set** through all unconsolidated materials plus a minimum of 20 feet into the underlying formation.
4. If the well is dry hole, an agreement between the operator and the district office on plug length and placement is necessary **prior to plugging**;
5. The appropriate district office will be notified before well is either plugged or production casing is cemented in;
6. If an ALTERNATE II COMPLETION, production pipe shall be cemented from below any usable water to surface within **120 days** of spud date.
Or pursuant to Appendix "B" - Eastern Kansas surface casing order #133,891-C, which applies to the KCC District 3 area, alternate II cementing must be completed within 30 days of the spud date or the well shall be plugged. **In all cases, NOTIFY district office** prior to any cementing.

I hereby certify that the statements made herein are true and to the best of my knowledge and belief.

Date: 11/11/04 Signature of Operator or Agent: William G. Hart Title: Member
Remember to Member HART Energies, L.L.C.

For KCC Use ONLY
API # 15 - 007-00239-0001
Conductor pipe required NONE feet
Minimum surface pipe required 266 feet per Alt. 1
Approved by: RJP 11-16-04
This authorization expires: 5-16-05
(This authorization void if drilling not started within 6 months of effective date.)
Spud date: _____ Agent: _____

- File Drill Pit Application (form CDP-1) with Intent to Drill;
- File Completion Form ACO-1 within 120 days of spud date;
- File acreage attribution plat according to field proration orders;
- Notify appropriate district office 48 hours prior to workover or re-entry;
- Submit plugging report (CP-4) after plugging is completed;
- Obtain written approval before disposing or injecting salt water.
- If this permit has expired (See: authorized expiration date) please check the box below and return to the address below.
 Well Not Drilled - Permit Expired
Signature of Operator or Agent: _____
Date: _____

Mail to: KCC - Conservation Division, 130 S. Market - Room 2078, Wichita, Kansas 67202

RECEIVED
NOV 15 2004
KCC WICHITA

IN ALL CASES PLOT THE INTENDED WELL ON THE PLAT BELOW

Plat of acreage attributable to a well in a prorated or spaced field

If the intended well is in a prorated or spaced field, please fully complete this side of the form. If the intended well is in a prorated or spaced field complete the plat below showing that the well will be properly located in relationship to other wells producing from the common source of supply. Please show all the wells and within 1 mile of the boundaries of the proposed acreage attribution unit for gas wells and within 1/2 mile of the boundaries of the proposed acreage attribution unit for oil wells.

API No. 15 - _____
Operator: Hart Energies, L.L.C.
Lease: Marlyne
Well Number: #1
Field: Spivey Grabbs

Location of Well: County: Barber
330 feet from N / S Line of Section
330 feet from E / W Line of Section
Sec. 2 Twp. 31 S. R. 10 East West

Number of Acres attributable to well: 320
QTR / QTR / QTR of acreage: _____ - S/2

Is Section: Regular or Irregular

If Section is Irregular, locate well from nearest corner boundary.
Section corner used: NE NW SE SW

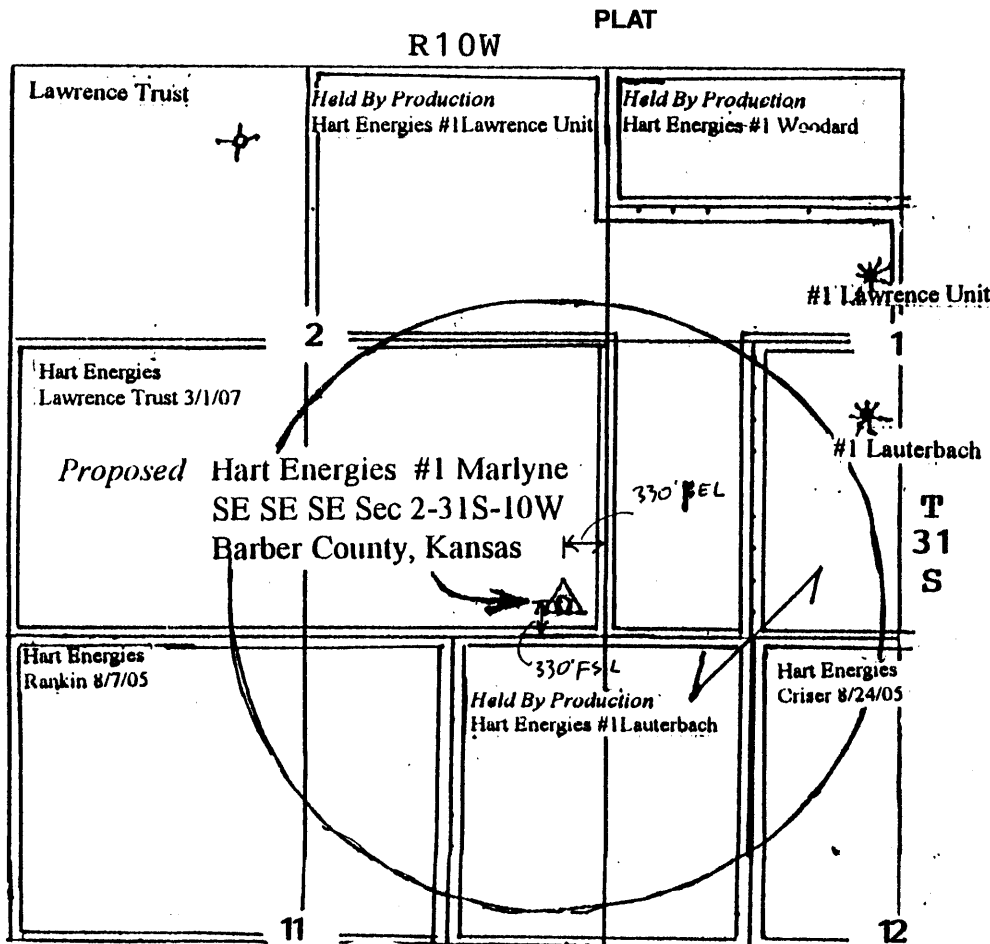

KANSAS

CORPORATION COMMISSION

KATHLEEN SEBELIUS, GOVERNOR

BRIAN J. MOLINE, CHAIR

ROBERT E. KREHBIEL, COMMISSIONER

MICHAEL C. MOFFET, COMMISSIONER

November 16, 2004

Mr. William G. Hart
Hart Energies, LLC
11051 So. Memorial #200
Tulsa, OK 74133

RE: Drilling Pit Application
Marlyne Lease Well No. 1
SE/4 Sec. 02-31S-10W
Barber County, Kansas

Dear Mr. Hart:

District staff has inspected the above referenced location and has determined that the reserve pit shall be constructed **without slots**, the bottom shall be flat and reasonably level, and the free fluids must be removed. The fluids are to be removed from the reserve pit as soon as practical after drilling operations have ceased.

If production casing is set all completion fluids shall be removed on a daily basis.

The fluids should be taken to an authorized disposal well. Please call the District Office at (620) 225-8888 when the fluids have been removed. Also, please file the enclosed CDP-5 form, Surface Pond Waste Transfer, within 30 days of fluid removal.

A copy of this letter should be posted in the doghouse along with the approved Intent to Drill. If you have any questions or concerns please feel free to contact the undersigned at the above address.

Sincerely,



Kathy Haynes
Environmental Protection and Remediation Department

cc: S Durrant