

For KCC Use:  
 Effective Date: 12.22.04  
 District # 3  
 SGA?  Yes  No

KANSAS CORPORATION COMMISSION  
 OIL & GAS CONSERVATION DIVISION

Form C-1  
 December 2002  
 Form must be Typed  
 Form must be Signed  
 All blanks must be Filled

NOTICE OF INTENT TO DRILL

Must be approved by KCC five (5) days prior to commencing well

Expected Spud Date December 20 2004  
month day year

Spot N/2-S1/2 - SW - SW Sec. 22 Twp. 26 S. R. 18  East  West  
450 feet from  N /  S Line of Section  
4650 feet from  E /  W Line of Section  
 Is SECTION  Regular  Irregular?

OPERATOR: License# 5488 (6.30.05)  
 Name: TWM Production Company  
 Address: 1150 Highway 39  
 City/State/Zip: Chanute, Kansas 66720  
 Contact Person: Michael or Carol Wimsett  
 Phone: 620-431-4137

(Note: Locate well on the Section Plat on reverse side)

County: Allen  
 Lease Name: Dice Well #: F-4  
 Field Name: Humboldt/Chanute

CONTRACTOR: License# 5491 (6.30.05)  
 Name: W & W Production Company

Is this a Prorated / Spaced Field?  Yes  No

Well Drilled For: Well Class: Type Equipment:  
 Oil  Enh Rec  Infield  Mud Rotary  
 Gas  Storage  Pool Ext.  Air Rotary  
 OWWO  Disposal  Wildcat  Cable  
 Seismic; # of Holes  Other  
 Other

Target Formation(s): Bartlesville  
 Nearest Lease or unit boundary: 450

Ground Surface Elevation: \_\_\_\_\_ feet MSL

Water well within one-quarter mile:  Yes  No

Public water supply well within one mile:  Yes  No

Depth to bottom of fresh water: 100

Depth to bottom of usable water: 150

Surface Pipe by Alternate:  1  2

Length of Surface Pipe Planned to be set: 20'

Length of Conductor Pipe required: None

Projected Total Depth: 1000

Formation at Total Depth: Bartlesville

Water Source for Drilling Operations:  
 Well  Farm Pond Other \_\_\_\_\_

DWR Permit #: \_\_\_\_\_

(Note: Apply for Permit with DWR )

Will Cores be taken?  Yes  No

If Yes, proposed zone: \_\_\_\_\_

If OWWO: old well information as follows:

Operator: \_\_\_\_\_

Well Name: \_\_\_\_\_

Original Completion Date: \_\_\_\_\_ Original Total Depth: \_\_\_\_\_

Directional, Deviated or Horizontal wellbore?  Yes  No

If Yes, true vertical depth: \_\_\_\_\_

Bottom Hole Location: \_\_\_\_\_

KCC DKT #: \_\_\_\_\_

AFFIDAVIT

The undersigned hereby affirms that the drilling, completion and eventual plugging of this well will comply with K.S.A. 55-1101. It is agreed that the following minimum requirements will be met:

1. Notify the appropriate district office **prior** to spudding of well;
2. A copy of the approved notice of intent to drill **shall be** posted on each drilling rig;
3. The minimum amount of surface pipe as specified below **shall be set** by circulating cement to the top; in all cases surface pipe **shall be set** through all unconsolidated materials plus a minimum of 20 feet into the underlying formation.
4. If the well is dry hole, an agreement between the operator and the district office on plug length and placement is necessary **prior to plugging**;
5. The appropriate district office will be notified before well is either plugged or production casing is cemented in;
6. If an ALTERNATE II COMPLETION, production pipe shall be cemented from below any usable water to surface within **120 days** of spud date. Or pursuant to Appendix "B" - Eastern Kansas surface casing order #133,891-C, which applies to the KCC District 3 area, alternate II cementing must be completed within 30 days of the spud date or the well shall be plugged. **In all cases, NOTIFY district office** prior to any cementing.

I hereby certify that the statements made herein are true and to the best of my knowledge and belief.

Date: December 13, 2004 Signature of Operator or Agent: Carol A. Wimsett Title: Office Manager

**For KCC Use ONLY**  
 API # 15 - 001-29174.00-00  
 Conductor pipe required NONE feet  
 Minimum surface pipe required 20 feet per Alt. 2  
 Approved by: RSP 12.17.04  
 This authorization expires: 6.17.05  
 (This authorization void if drilling not started within 6 months of effective date.)  
 Spud date: \_\_\_\_\_ Agent: \_\_\_\_\_

Remember to:

- File Drill Pit Application (form CDP-1) with Intent to Drill;
- File Completion Form ACO-1 within 120 days of spud date;
- File acreage attribution plat according to field proration orders;
- Notify appropriate district office 48 hours prior to workover or re-entry;
- Submit plugging report (CP-4) after plugging is completed;
- Obtain written approval before disposing or injecting salt water.
- If this permit has expired (See: authorized expiration date) please check the box below and return to the address below.

Well Not Drilled - Permit Expired  
 Signature of Operator or Agent: \_\_\_\_\_  
 Date: \_\_\_\_\_

Mail to: KCC - Conservation Division, 130 S. Market - Room 2078, Wichita, Kansas 67202

RECEIVED  
 DEC 16 2004  
 KCC WICHITA

22 26 185

**IN ALL CASES PLOT THE INTENDED WELL ON THE PLAT BELOW**

*Plat of acreage attributable to a well in a prorated or spaced field*

**If the intended well is in a prorated or spaced field, please fully complete this side of the form.** If the intended well is in a prorated or spaced field complete the plat below showing that the well will be properly located in relationship to other wells producing from the common source of supply. Please show all the wells and within 1 mile of the boundaries of the proposed acreage attribution unit for gas wells and within 1/2 mile of the boundaries of the proposed acreage attribution unit for oil wells.

API No. 15 - \_\_\_\_\_  
Operator: TWM Production Company  
Lease: Dice  
Well Number: F-4  
Field: Humboldt/Chanute  
Number of Acres attributable to well: \_\_\_\_\_  
QTR / QTR / QTR of acreage: S/2 - SW - SW

Location of Well: County: Allen  
450 feet from  N /  S Line of Section  
4650 feet from  E /  W Line of Section  
Sec. 22 Twp. 26 S. R. 18  East  West  
Is Section:  Regular or  Irregular  
**If Section is Irregular, locate well from nearest corner boundary.**  
Section corner used:  NE  NW  SE  SW

**PLAT**

*(Show location of the well and shade attributable acreage for prorated or spaced wells.)  
(Show footage to the nearest lease or unit boundary line.)*

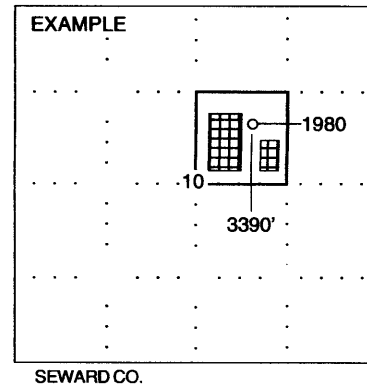
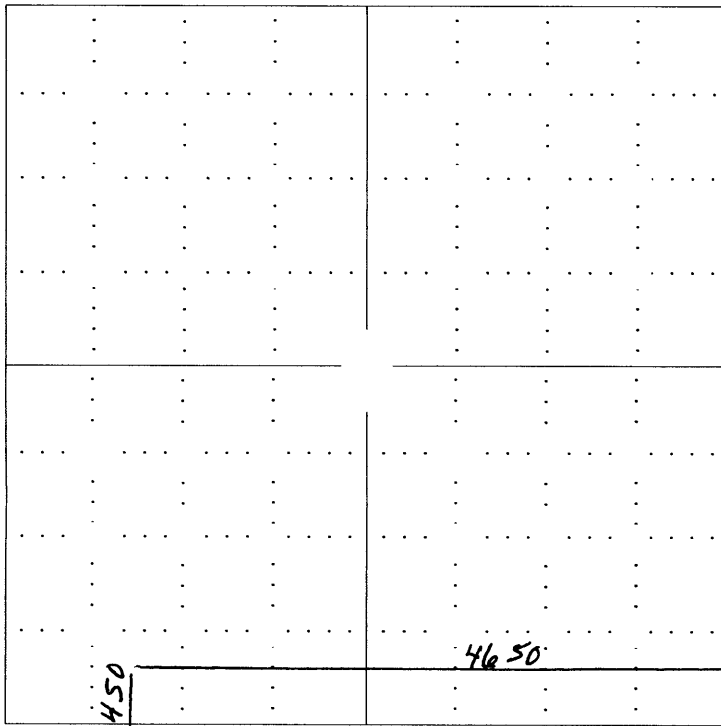

**NOTE: In all cases locate the spot of the proposed drilling locaton.**

**In plotting the proposed location of the well, you must show:**

1. The manner in which you are using the depicted plat by identifying section lines, i.e. 1 section, 1 section with 8 surrounding sections, 4 sections, etc.
2. The distance of the proposed drilling location from the section's south / north and east / west.
3. The distance to the nearest lease or unit boundary line.
4. If proposed location is located within a prorated or spaced field a certificate of acreage attribution plat must be attached: (CO-7 for oil wells; CG-8 for gas wells).

RECEIVED  
DEC 16 2004  
KONMICHITA