

STATE CORPORATION COMMISSION OF KANSAS
OIL & GAS CONSERVATION DIVISION

WELL COMPLETION OR RECOMPLETION FORM
ACO-1 WELL HISTORY

DESCRIPTION OF WELL AND LEASE

Operator: License # 6771
Name Ozark Enterprises
Address Box 427
Logan, Kansas
City/State/Zip 67646

Purchaser: Inland Crude Purchasing
Wichita, Ks

Operator Contact Person Steve Morrison
Phone 913-689-4276

Contractor: License # 9087
Name R&C Drilling Co., Inc.

Wellsite Geologist Robert Elder
Phone

Designate Type of Completion
 New Well Re-Entry Workover

Oil SWD Temp Abd
 Gas Inj Delayed Comp
 Dry Other (Core, Water Supply etc)

If OWWO: old well info as follows:
Operator
Well Name
Comp. Date Old Total Depth

WELL HISTORY

Drilling Method:
 Mud Rotary Air Rotary Cable
1-23-85 1-30-85 2-28-85
Spud Date Date Reached TD Completion Date
3265
Total Depth PBDT

Amount of Surface Pipe Set and Cemented at 212 feet
Multiple Stage Cementing Collar Used? Yes No
If yes, show depth set 1260 feet
If alternate 2 completion, cement circulated from 1260 feet depth to 120 w/ 350 SX cmt

API NO. 15-147-20-472-00-00
County PHILLIPS
C. ~~W/2 NE NE~~ Sec 2 Twp. 5 Rge. 18 East West

4650 Ft North from Southeast Corner of Section
3940 Ft West from Southeast Corner of Section
(Note: Locate well in section plat below)

Lease Name Armstrong Well # 5

Field Name Lazy OK SE

Producing Formation LKC

Elevation: Ground 1826 KB 1831

Section Plat

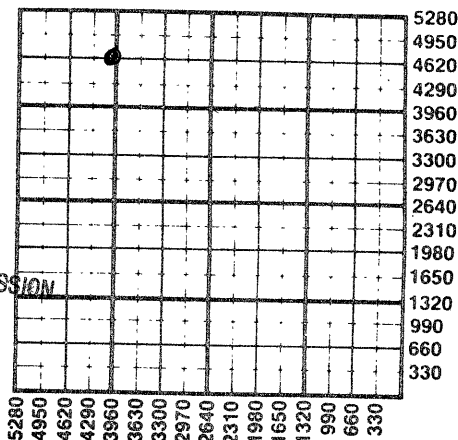

4-11-85

RECEIVED
STATE CORPORATION COMMISSION
APR 11 1985
CONSERVATION DIVISION
Wichita, Kansas

WATER SUPPLY INFORMATION

Disposition of Produced Water: Disposal Repressuring
Docket #

Questions on this portion of the ACO-1 call:
Water Resources Board (913) 296-3717

Source of Water:
Division of Water Resources Permit #

Groundwater.....Ft North from Southeast Corner
(Well)Ft West from Southeast Corner of
Sec Twp Rge East West

Surface Water.....Ft North from Southeast Corner
(Stream, pond etc).....Ft West from Southeast Corner
Sec Twp Rge East West

Other (explain) Pond (Raymond Morgan).....
(purchased from city, R.W.D. #)

INSTRUCTIONS: This form shall be completed in duplicate and filed with the Kansas Corporation Commission, 200 Colorado Derby Building, Wichita, Kansas 67202, within 90 days after completion or recompletion of any well. Rule 82-3-130 and 82-3-107 apply.

Information on side two of this form will be held confidential for a period of 12 months if requested in writing and submitted with the form. See rule 82-3-107 for confidentiality in excess of 12 months. One copy of all wireline logs and drillers time log shall be attached with this form. Submit CP-4 form with all plugged wells. Submit CP-111 form with all temporarily abandoned wells.

All requirements of the statutes, rules and regulations promulgated to regulate the oil and gas industry have been fully complied with and the statements herein are complete and correct to the best of my knowledge.

Signature *Stephen S. Morrison*

Title OPERATOR Date 4-10-85

Subscribed and sworn to before me this 4th day of April 1985

Notary Public *Carolyn S. Morrison*

Date Commission Expires 12-21-87

Carolyn S. Morrison
NOTARY PUBLIC
State of Kansas
EXPIRES 12-21-87

K.C.C. OFFICE USE ONLY
F Letter of Confidentiality Attached
C Wireline Log Received
C Drillers Timelog Received
Distribution
 KCC SWD/Rep NGPA
 KGS Plug Other
(Specify)

Sec. 5 Twp. 5 Rge. 18 W

SIDE TWO

Operator Name Ozark Enterprises Lease Name Armstrong Well # 5

Sec. 2 Twp. 5 Rge. 18 East West County Phillips

WELL LOG

INSTRUCTIONS: Show important tops and base of formations penetrated. Detail all cores. Report all drill stem tests giving interval tested, time tool open and closed, flowing and shut-in pressures, whether shut-in pressure reached static level, hydrostatic pressures, bottom hole temperature, fluid recovery, and flow rates if gas to surface during test. Attach extra sheet if more space is needed. Attach copy of log.

Drill Stem Tests Taken Yes No
 Samples Sent to Geological Survey Yes No
 Cores Taken Yes No

Formation Description
 Log Sample

0' - 212' Sand & Clay
 212' - 1256' Sand & Shale
 1256' - 1279' Anhydrite
 1279' - 1605' Shale
 1605' - 1922' Shale & Sand
 1922' - 3205' Lime & Shale
 3205' - 3265' Lime R.T.D.

Name	Top	Bottom
Anhydrite	1250	1273
Topeka	2770	
Heebner	2970	
Toronto	2993	
Lansing	3011	
BKC	3236	
Total Depth	3265	

DST # 1 (Misrun)

Know other DST'S

CASING RECORD <input checked="" type="checkbox"/> New <input type="checkbox"/> Used							
Report all strings set-conductor, surface, intermediate, production, etc.							
Purpose of String	Size Hole Drilled	Size Casing Set (in O.D.)	Weight Lbs/Ft.	Setting Depth	Type of Cement	#Sacks Used	Type and Percent Additives
Surface	12 1/4	8 5/8	24lb.	212'	common	140	2% Gel, 3% CC
First Stage	7 7/8	4 1/2	101b.	3264'	.60/40	125	2% CC 5% gel
Second Stage	7 7/8	4 1/2	101b.	3264		350	60-40 Poz 5% gel
PERFORATION RECORD				Acid, Fracture, Shot, Cement Squeeze Record			
Shots Per Foot	Specify Footage of Each Interval Perforated			(Amount and Kind of Material Used)			Depth
2	3226-3230 I-zone			1250 gal 15% NE			
2	3188-3191 J-zone			H, I, J zone communicated retreated			
2	3168-3171 I-Zone			with 2500 gal 15% NE with Salt & Benzoid			
2	3146-3149 H-zone			flakes as plug diverters			
TUBING RECORD				Liner Run <input type="checkbox"/> Yes <input checked="" type="checkbox"/> No			
Size 2 3/8		Set At 3220		Packer at none			
Date of First Production		Producing Method					
3-1-85		<input type="checkbox"/> Flowing <input checked="" type="checkbox"/> Pumping <input type="checkbox"/> Gas Lift <input type="checkbox"/> Other (explain).....					
Estimated Production Per 24 Hours	Oil	Gas	Water	Gas-Oil Ratio	Gravity		
	27 bbl		55 bbl		36		
	Bbls	MCF	Bbls	CFPB			

METHOD OF COMPLETION

Production Interval

Disposition of gas: Vented Open Hole Perforation
 Sold Other (Specify) 3146-3230
 Used on Lease Dually Completed
 Conmingled