

EFFECTIVE DATE: 7-30-90

* Correction

FORM MUST BE TYPED
FORM C-1 4/90

State of Kansas

FORM MUST BE SIGNED
ALL BLANKS MUST BE FILLED

NOTICE OF INTENTION TO DRILL

Must be approved by the K.C.C. five (5) days prior to commencing well
Approx.

* Expected Spud Date Aug 13 1990
month day year

NW/4 SE/4 SE/4 Sec 18 Twp 5 S, Rg 20 East
West

OPERATOR: License # 5447
Name: OXY USA INC.
Address: 110 S. Main, #800
City/State/Zip: Wichita, Kansas 67202
Contact Person: Andrew McCalmont
Phone: (316) 265-5624

1275 feet from South line of Section
710 feet from East line of Section
(Note: Locate well on Section Plat on Reverse Side)

County: Phillips
Lease Name: Kowitz Well #: 2D
Field Name: Unnamed

* CONTRACTOR: License #: 5302
* Name: Red Tiger Drilling Company

Is this a Prorated Field? no yes no
Target Formation(s): Arbuckle
Nearest lease or unit boundary: 710'
Ground Surface Elevation: 2090 feet MSL
Domestic well within 330 feet: no yes no
Municipal well within one mile: no yes no
Depth to bottom of fresh water: 120
Depth to bottom of usable water: 700
Surface Pipe by Alternate: 1 2
Length of Surface Pipe Planned to be set: 375'
Length of Conductor pipe required: ---
Projected Total Depth: 3750'
Formation at Total Depth: Granite Wash
Water Source for Drilling Operations:
... well ... farm pond other

Well Drilled For: Well Class: Type Equipment:
... Oil ... Inj Infield Mud Rotary
... Gas ... Storage ... Pool Ext. ... Air Rotary
... OWWO Disposal ... Wildcat ... Cable
... Seismic; ... # of Holes

If OWWO: old well information as follows:

Operator: _____
Well Name: _____
Comp. Date: _____ Old Total Depth _____

Directional, Deviated or Horizontal wellbore? no yes no

If yes, total depth location: _____

WAS: Contact Person: Raymond Nui; Contractor Unknown; ALT I; surface pipes required - 720'

If yes, proposed zone: _____

IS: Contact Person: Andrew McCalmont; Contractor: Red Tiger #5302; ALT II; surface pipes required - 250'

AFFIDAVIT

The undersigned hereby affirms that the drilling, completion and eventual plugging of this well will comply with K.S.A. 55-101, et. seq.

It is agreed that the following minimum requirements will be met:

1. The appropriate district office shall be notified before setting surface pipe;
2. The minimum amount of surface pipe as specified above shall be set by circulating cement to the top; in all cases surface pipe shall be set through all unconsolidated materials plus a minimum of 20 feet into the underlying formation;
3. If the well is dry, a plugging proposal shall be submitted to the district office. An agreement between the operator and the district office on plug length and placement is necessary prior to plugging;
4. The appropriate district office will be notified before well is either plugged or production casing is cemented in;
5. If an Alternate II completion, production pipe shall be cemented from below any usable water to surface within 120 days of spud date. In all cases, notify district office prior to any cementing.

I hereby certify that the statements made herein are true and to the best of my knowledge and belief.

Date: Aug 9, 1990 Signature of Operator or Agent: Andrew McCalmont Title: Engineer

FOR KCC USE:
API # 15- 147-20,516-00-00
Conductor pipe required None feet
Minimum surface pipe required 250 feet per Alt. 2
Approved by: Andrew McCalmont 9-25-90
EFFECTIVE DATE: 7-30-90
This authorization expires: 1-25-91
(This authorization void if drilling not started within 6 months of effective date.)
Spud date: _____ Agent: _____

RECEIVED
STATE OF KANSAS
CONSERVATION DIVISION
Wichita, Kansas
AUG 10 1990
18 5 2060

REMEMBER TO:

- File Drill Pit Application (form CDP-1) with Intent to Drill;
- File Completion Form ACO-1 within 120 days of spud date;
- File acreage attribution plat according to field proration orders;
- Notify appropriate district office 48 hours prior to workover or re-entry;
- Submit plugging report (CP-4) after plugging is completed;
- Obtain written approval before disposing or injecting salt water.

PLAT OF ACREAGE ATTRIBUTABLE TO A WELL

State Corporation Commission, Conservation Division
200 Colorado Derby Bldg. Wichita, Kansas 67202

OPERATOR OXY USA INC. LOCATION OF WELL:
 LEASE Kowitz 1275 feet north of SE corner
 WELL NUMBER 2D 710 feet west of SE corner
 FIELD Unnamed SE/4 Sec. 18 T 5S R 20 ~~W~~
 COUNTY Phillips
 NO. OF ACRES ATTRIBUTABLE TO WELL 10 IS SECTION X REGULAR IRREGULAR?
 DESCRIPTION OF ACREAGE Pasture IF IRREGULAR, LOCATE WELL FROM NEAREST
 CORNER BOUNDARY.

NOTE: If plat depicted is insufficient for your circumstances, you may attach your own scaled or surveyed plat.

PLAT

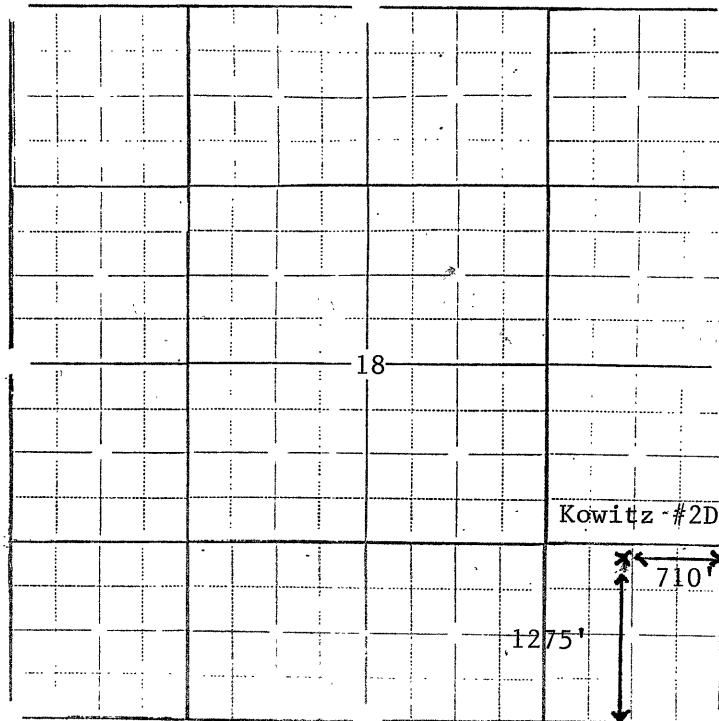

In plotting the proposed location of the well, you must show:

- 1) The manner in which you are using the depicted plat by identifying section lines, i.e. 1 section, 1 section with 8 surrounding partial sections, 4 sections, 16 sections, etc.;
- 2) the well's location relative to the location of other wells producing from the same common source of supply in adjoining drilling units, pursuant to K.A.R. 82-3-108, 82-3-207, 82-3-312, or special orders of the Commission;
- 3) the distance of the proposed drilling location from the section's east and south lines; and
- 4) the distance to the nearest lease or unit boundary line.

I hereby certify that the statements made herein are true and to the best of my knowledge and belief.

Signature of Operator or Agent Andrew McCalmont

Date August 9, 1990 Title Engineer