

Expected Spud Date November 3, 1990 SE SE NE Sec 32 Twp 5 S, Rg 20 East   
 month day year West

OPERATOR: License # 5058  
 Name: GRIGGS OIL, INC.  
 Address: 107 N. Market, #800  
 City/State/Zip: Wichita, KS 67202  
 Contact Person: Jack Griggs  
 Phone: 316-267-7779

2970 feet from South line of Section  
330 feet from East line of Section  
 (Note: Locate well on Section Plat on Reverse Side)

CONTRACTOR: License #: 5302  
 Name: RED TIGER DRILLING COMPANY

County: Phillips  
 Lease Name: Ray "A" Well #: 5  
 Field Name: N/A RAY

Well Drilled For: Well Class: Type Equipment:  
 Oil ... Inj  Infield  Mud Rotary  
 ... Gas ... Storage ... Pool Ext. ... Air Rotary  
 ... OWO ... Disposal ... Wildcat ... Cable  
 ... Seismic; ... # of Holes

Is this a Prorated Field? ... yes  no   
 Target Formation(s): Reagan Sand  
 Nearest lease or unit boundary: 330  
 Ground Surface Elevation: N/A feet MSL

If OWMO: old well information as follows:  
 Operator: \_\_\_\_\_  
 Well Name: \_\_\_\_\_  
 Comp. Date: \_\_\_\_\_ Old Total Depth \_\_\_\_\_

Domestic well within 330 feet: ... yes  no   
 Municipal well within one mile: ... yes  no   
 Depth to bottom of fresh water: 90'  
 Depth to bottom of usable water: 1110'

Directional, Deviated or Horizontal wellbore? ... yes  no   
 If yes, total depth location: \_\_\_\_\_

Surface Pipe by Alternate: ... 1  2   
 Length of Surface Pipe Planned to be set: 200  
 Length of Conductor pipe required: N/A  
 Projected Total Depth: 3650  
 Formation at Total Depth: Reagan Sand

Water Source for Drilling Operations:  
 ... well ... farm pond  other   
 DWR Permit #: N/A  
 Will Cores Be Taken?: ... yes  no   
 If yes, proposed zone: \_\_\_\_\_

**AFFIDAVIT**

The undersigned hereby affirms that the drilling, completion and eventual plugging of this well will comply with K.S.A. 55-101, et. seq.

- It is agreed that the following minimum requirements will be met:
1. The appropriate district office shall be notified before setting surface pipe;
  2. The minimum amount of surface pipe as specified above shall be set by circulating cement to the top; in all cases surface pipe shall be set through all unconsolidated materials plus a minimum of 20 feet into the underlying formation;
  3. If the well is dry, a plugging proposal shall be submitted to the district office. An agreement between the operator and the district office on plug length and placement is necessary prior to plugging;
  4. The appropriate district office will be notified before well is either plugged or production casing is cemented in;
  5. If an Alternate II completion, production pipe shall be cemented from below any usable water to surface within 120 days of spud date. In all cases, notify district office prior to any cementing.

I hereby certify that the statements made herein are true and to the best of my knowledge and belief.

Date: 10-30-90 Signature of Operator or Agent: D. Ann Brennan Title: Rig Coordinator  
 By Red Tiger Drilling Company

FOR KCC USE:

API # 15- 147-20,526-00-00  
 Conductor pipe required None feet  
 Minimum surface pipe required 300 feet per Alt. ②  
 Approved by: MAN 10-31-90  
 EFFECTIVE DATE: 11-5-90  
 This authorization expires: 4-30-91  
 (This authorization void if drilling not started within 6 months of effective date.)  
 Spud date: \_\_\_\_\_ Agent: \_\_\_\_\_

RECEIVED  
 STATE CORPORATION COMMISSION  
 CONSERVATION DIVISION  
 Wichita, Kansas  
 OCT 30 1990

32 5 2000

**WALC**  
**CONTACT DISTRICT OFFICE PRIOR TO SPUDDING FOR APPROVAL**

**KCC OFFICE USE ONLY**  
 W 11-1-90 D \_\_\_\_\_  
 CT 8:30 AM CT \_\_\_\_\_  
 MW

- REMEMBER TO:
- File Drill Pit Application (form CDP-1) with Intent to Drill;
  - File Completion Form ACO-1 within 120 days of spud date;
  - File acreage attribution plat according to field proration orders;
  - Notify appropriate district office 48 hours prior to workover or re-entry;
  - Submit plugging report (CP-4) after plugging is completed;
  - Obtain written approval before disposing or injecting salt water.

**PLAT OF ACREAGE ATTRIBUTABLE TO A WELL**

State Corporation Commission, Conservation Division  
200 Colorado Derby Bldg. Wichita, Kansas 67202

OPERATOR GRIGGS OIL, INC. LOCATION OF WELL:  
 LEASE Ray "A" 2970 feet north of SE corner  
 WELL NUMBER 5 330 feet west of SE corner  
 FIELD Unknown Sec. 32 T 5S R 20W E/W  
 COUNTY Phillips  
 NO. OF ACRES ATTRIBUTABLE TO WELL 80 IS SECTION x REGULAR     IRREGULAR?  
 DESCRIPTION OF ACREAGE SE SE NE IF IRREGULAR, LOCATE WELL FROM NEAREST  
 CORNER BOUNDARY.

NOTE: If plat depicted is insufficient for your circumstances, you may attach your own scaled or surveyed plat.

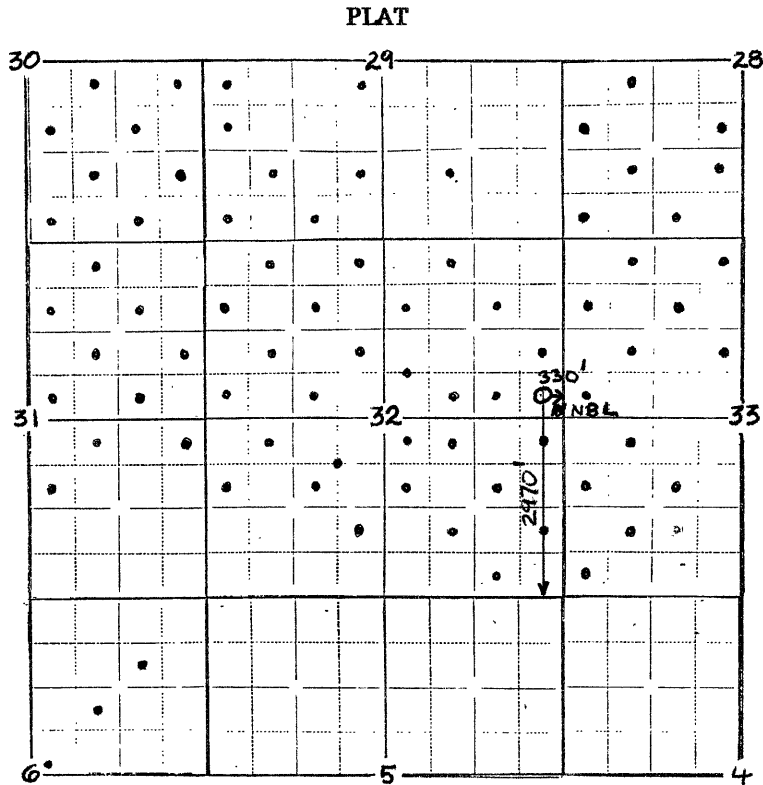

In plotting the proposed location of the well, you must show:

- 1) The manner in which you are using the depicted plat by identifying section lines, i.e. 1 section, section with 8 surrounding partial sections, 4 sections, 16 sections, etc.;
- 2) the well's location relative to the location of other wells producing from the same common source of supply in adjoining drilling units, pursuant to K.A.R. 82-3-108, 82-3-207, 82-3-312, or special orders of the Commission;
- 3) the distance of the proposed drilling location from the section's east and south lines; and
- 4) the distance to the nearest lease or unit boundary line.

I hereby certify that the statements made herein are true and to the best of my knowledge and belief.

Signature of Operator or Agent *D. Ann Brennan*  
 Date 10-30-90 Title Rig Coordinator

CONTACT DISTRICT  
 OFFICE PHOENIX  
 TO STENOGRAPHER  
 FOR APPROVAL  
 FOR OFFICE USE ONLY