

ORIGINAL SIDE ONE

KCC

MAY 30

STATE CORPORATION COMMISSION OF KANSAS  
OIL & GAS CONSERVATION DIVISION  
WELL COMPLETION FORM  
ACO-1 WELL HISTORY  
DESCRIPTION OF WELL AND LEASE

RELEASED

520-92  
MAY 20 1992

API NO. 15- 147-20529-00-00  
County Phillips  
NW NE SW Sec. 32 Twp. 5S Rge. 20  East West

CONFIDENTIAL

Operator: License # 5447  
Name: OXY USA, Inc.  
Address P.O. Box 26100

City/State/Zip Okla. City, OK 73126-0100  
Purchaser: CITGO

Operator Contact Person: Raymond Hui  
Phone (405) 749-2471

Contractor: Name: Allen Drilling Company  
License: 5418'

Wellsite Geologist: William Keller

Designate Type of Completion  
 New Well  Re-Entry  Workover  
 Oil  SWD  Temp. Abd.  
 Gas  Inj  Delayed Comp.  
 Dry  Other (Core, Water Supply, etc.)

If OWMO: old well info as follows:  
Operator:

Well Name:  
Comp. Date Old Total Depth

Drilling Method:  
 Mud Rotary  Air Rotary  Cable  
2-12-91 2-17-91 4-13-91  
Spud Date Date Reached TD Completion Date

2310 Ft. North from Southeast Corner of Section  
3650 Ft. West from Southeast Corner of Section  
(NOTE: Locate well in section plat below.)

Lease Name Johnson B Well # 12

Field Name Ray

Producing Formation Reagan

Elevation: Ground 2189' KB 2194'

Total Depth 3654' PBTD 3616'

RECEIVED  
STATE CORPORATION COMMISSION

MAY 08 1991

CONSERVATION DIVISION  
Wichita, Kansas

58-91

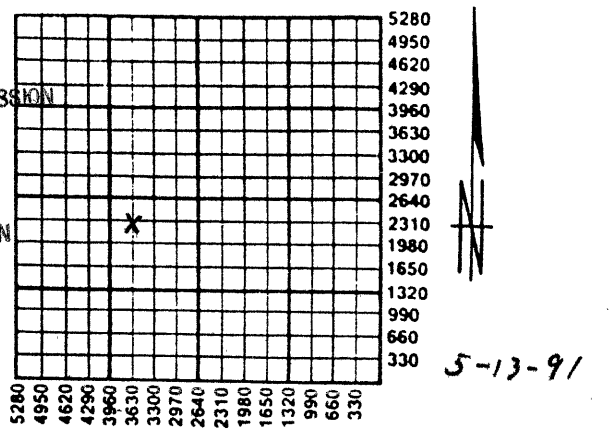

Amount of Surface Pipe Set and Cemented at 377 Feet

Multiple Stage Cementing Collar Used?  Yes  No

If yes, show depth set DV Tool at 1734' Feet

If Alternate II completion, cement circulated from 1734 feet depth to 0 w/ 400 sx cmt.

INSTRUCTIONS: This form shall be completed in triplicate and filed with the Kansas Corporation Commission, 200 Colorado Derby Building, Wichita, Kansas 67202, within 120 days of the spud date of any well. Rule 82-3-130, 82-3-107 and 82-3-106 apply. Information on side two of this form will be held confidential for a period of 12 months if requested in writing and submitted with the form. See rule 82-3-107 for confidentiality in excess of 12 months. One copy of all wireline logs and drillers time log shall be attached with this form. ALL CEMENTING TICKETS MUST BE ATTACHED. Submit CP-4 form with all plugged wells. Submit CP-111 form with all temporarily abandoned wells. Any recompletion, workover or conversion of a well requires filing of ACO-2 within 120 days from commencement date of such work.

All requirements of the statutes, rules and regulations promulgated to regulate the oil and gas industry have been fully complied with and the statements herein are complete and correct to the best of my knowledge.

Signature [Signature]  
Title Operations Drilling Manager Date 4-29-91

Subscribed and sworn to before me this 29th day of April, 1991.

Notary Public [Signature]  
Date Commission Expires 4-16-94

K.C.C. OFFICE USE ONLY  
F  Letter of Confidentiality Attached  
C  Wireline Log Received  
C  Drillers Timelog Received  
  
Distribution  
 KCC  SWD/Rep  NGPA  
 KGS  Plug  Other  
(Specify)

**SIDE TWO**

Operator Name OXY USA, Inc. Lease Name Johnson B Well # 12  
 Sec. 32 Twp. 5S Rge. 20  East  West  
 County Phillips

**INSTRUCTIONS:** Show important tops and base of formations penetrated. Detail all cores. Report all drill stem tests giving interval tested, time tool open and closed, flowing and shut-in pressures, whether shut-in pressure reached static level, hydrostatic pressures, bottom hole temperature, fluid recovery, and flow rates if gas to surface during test. Attach extra sheet if more space is needed. Attach copy of log.

Drill Stem Tests Taken (Attach Additional Sheets.) <input type="checkbox"/> Yes <input checked="" type="checkbox"/> No Samples Sent to Geological Survey <input checked="" type="checkbox"/> Yes <input type="checkbox"/> No Cores Taken <input type="checkbox"/> Yes <input checked="" type="checkbox"/> No Electric Log Run (Submit Copy.) <input checked="" type="checkbox"/> Yes <input type="checkbox"/> No  Ran Dual Induction/GR/SP.	<table border="1" style="width:100%; border-collapse: collapse;"> <tr> <th colspan="3" style="text-align: center;">Formation Description</th> </tr> <tr> <td></td> <td style="text-align: center;"><input checked="" type="checkbox"/> Log</td> <td style="text-align: center;"><input type="checkbox"/> Sample</td> </tr> <tr> <th style="text-align: left;">Name</th> <th style="text-align: center;">Top</th> <th style="text-align: center;">Bottom</th> </tr> <tr> <td>Topeka</td> <td style="text-align: center;">3135</td> <td style="text-align: center;">3205</td> </tr> <tr> <td>Le Compton</td> <td style="text-align: center;">3205</td> <td style="text-align: center;">3247</td> </tr> <tr> <td>Oread</td> <td style="text-align: center;">3247</td> <td style="text-align: center;">3294</td> </tr> <tr> <td>Heebner</td> <td style="text-align: center;">3294</td> <td style="text-align: center;">3318</td> </tr> <tr> <td>Toronto</td> <td style="text-align: center;">3318</td> <td style="text-align: center;">3335</td> </tr> <tr> <td>LKC</td> <td style="text-align: center;">3335</td> <td style="text-align: center;">3539</td> </tr> <tr> <td>Basal Penn.</td> <td style="text-align: center;">3539</td> <td style="text-align: center;">3586</td> </tr> <tr> <td>Reagan</td> <td style="text-align: center;">3586</td> <td style="text-align: center;">3654</td> </tr> </table>	Formation Description				<input checked="" type="checkbox"/> Log	<input type="checkbox"/> Sample	Name	Top	Bottom	Topeka	3135	3205	Le Compton	3205	3247	Oread	3247	3294	Heebner	3294	3318	Toronto	3318	3335	LKC	3335	3539	Basal Penn.	3539	3586	Reagan	3586	3654
Formation Description																																		
	<input checked="" type="checkbox"/> Log	<input type="checkbox"/> Sample																																
Name	Top	Bottom																																
Topeka	3135	3205																																
Le Compton	3205	3247																																
Oread	3247	3294																																
Heebner	3294	3318																																
Toronto	3318	3335																																
LKC	3335	3539																																
Basal Penn.	3539	3586																																
Reagan	3586	3654																																

CASING RECORD <input checked="" type="checkbox"/> New <input type="checkbox"/> Used							
Report all strings set-conductor, surface, intermediate, production, etc.							
Purpose of String	Size Hole Drilled	Size Casing Set (In O.D.)	Weight Lbs./Ft.	Setting Depth	Type of Cement	# Sacks Used	Type and Percent Additives
Surface	12 1/4"	8 5/8"	24#	377'	Cl.A	270	3% cc
Production	7 7/8"	5 1/2"	15.5#	3651'	*Pls refer to csg info below.		
PERFORATION RECORD				Acid, Fracture, Shot, Cement Squeeze Record (Amount and Kind of Material Used)			
Shots Per Foot	Specify Footage of Each Interval Perforated			Depth			
4	Reagan 3588-3590'			Not treated			
TUBING RECORD		Size	Set At	Packer At	Liner Run <input type="checkbox"/> Yes <input checked="" type="checkbox"/> No		
		2 7/8"	3543'				
Date of First Production		Producing Method <input type="checkbox"/> Flowing <input checked="" type="checkbox"/> Pumping <input type="checkbox"/> Gas Lift <input type="checkbox"/> Other (Explain)					
4-13-91							
Estimated Production Per 24 Hours		Oil Bbls.	Gas Mcf	Water Bbls.	Gas-Oil Ratio	Gravity	
		141	-	-			

Disposition of Gas:  Vented  Sold  Used on Lease (If vented, submit ACO-18.)

**METHOD OF COMPLETION**

Open Hole  Perforation  Dually Completed  Commingled  Other (Specify) \_\_\_\_\_

Production Interval 3588-3590

\*Production Csg Info: Pumped 50 sx 50/50 Poz. A w/10% salt + 2% gel., followed by 125 sx standard EA-2 + 5% Cal-Seal. Pumped 400 sx 12.7# gel light w/44#/SX flo.



KCC

P.O. BOX 951046  
DALLAS, TX 75395-1046

HALLIBURTON SERVICES MAY 30

ORIGINAL

A Halliburton Company

CONFIDENTIAL

INVOICE NO.	DATE
904569	02/17/1991

CASE NO./PLANT NAME <i>Johnson B #12</i>		WELL/PLANT LOCATION PHILLIPS	STATE KS	WELL/PLANT OWNER OXY USA	
WELL LOCATION	CONTRACTOR ALLEN DRLG	JOB PURPOSE CEMENT PRODUCTION CASING		TICKET DATE 02/17/1991	
NO.	CUSTOMER AGENT	VENDOR NO.	CUSTOMER P.O. NUMBER	SHIPPED VIA	FILE NO.
67	JIM NOWELL	<u>E-26</u>		COMPANY TRUCK	10501

OXY USA INC.  
REGIONAL OFFICE  
ATT: G. I. MCFARLAND  
PO BOX 26100  
OKLAHOMA CITY, OK 73126-0100

DIRECT CORRESPONDENCE TO:  
FIRST OKLAHOMA TOWER  
210 WEST PARK AVENUE  
SUITE 2050  
OKLAHOMA CITY, OK 73102-5601

9-1572346 X 2360.1/724

LINE REF. NO	DESCRIPTION	QUANTITY	U/M	UNIT PRICE	AMOUNT
3-127	CAL SEAL	6	SK	19.70	118.20
3-968	SALT	541	LB	.10	54.10
3-775	HALAD-322	59	LB	5.95	351.05
3-970	D-AIR 1, POWDER	29	LB	2.55	73.95
4-316	HALLIBURTON LIGHT W/STANDARD	400	SK	6.10	2,440.00
3-210	FLOCELE	100	LB	1.30	130.00
3-968	SALT	400	LB	.10	40.00
3-207	BULK SERVICE CHARGE	602	CFT	1.10	662.20
3-306	MILEAGE CMTG MAT DEL OR RETURN	1362.35	TMI	.75	1,021.76
3-307	MILEAGE SURCHARGE-CEMENT MAT.	1362.35	TMI	.10	136.24

INVOICE SUBTOTAL

DISCOUNT-(BID)  
INVOICE BID AMOUNT

\*-KANSAS STATE SALES TAX  
\*-DECATUR COUNTY SALES TAX

RECEIVED  
STATE CORPORATION COMMISSION

MAY 08 1991

CONSERVATION DIVISION  
Wichita, Kansas

13,409.65  
2,650.68  
10,758.97  
341.18  
80.29

OKLAHOMA CITY, OK

DISB. APPL.		DATE REC'D	
		MAR 6 1991	
CO-ENT-SEP	LOC-CODE	DUE DATE	OR. REC. NO.
327-77	1332		
S/S TAX	NC	FC	S/D
		508	
ACCTG. APPL.		FORM. CHG.	

RELEASED

MAY 20 1992

FROM CONFIDENTIAL

INVOICE TOTAL - PLEASE PAY THIS AMOUNT =====> \$11,180.44

FIX JOB TKT TERMS INVOICES PAYABLE NET BY THE 20TH OF THE FOLLOWING MONTH AFTER DATE OF INVOICE UPON CUSTOMER'S DEFAULT IN PAYMENT OF CUSTOMER'S ACCOUNT BY THE LAST DAY OF THE MONTH FOLLOWING THE MONTH IN WHICH THE INVOICE IS DATED. CUSTOMER AGREES TO PAY INTEREST THEREON AFTER DEFAULT AT THE HIGHEST LAWFUL CONTRACT RATE APPLICABLE BUT NEVER TO EXCEED 18% PER ANNUM IN THE EVENT IT BECOMES NECESSARY TO EMPLOY AN ATTORNEY TO ENFORCE COLLECTION OF SAID ACCOUNT. CUSTOMER AGREES TO PAY ALL COLLECTION COSTS AND ATTORNEY FEES IN THE AMOUNT OF 20% OF THE AMOUNT OF THE UNPAID ACCOUNT

COPY

REMIT TO:

P.O. BOX 951046  
DALLAS, TX 75395-1046

KCC

HALLIBURTON SERVICES MAY 30

VOICE

ORIGINAL

A Halliburton Company

CONFIDENTIAL

INVOICE NO	DATE
051262	02/12/1991

WELL LEASE NO./PLANT NAME	WELL/PLANT LOCATION	STATE	WELL/PLANT OWNER
ANSON B-12	PHILIPS	KS	OXY USA INC.

SERVICE LOCATION	CONTRACTOR	JOB PURPOSE	TICKET DATE
BERLIN	ALLEN	CEMENT SURFACE CASING	02/12/1991

ACCT. NO	CUSTOMER AGENT	VENDOR NO	CUSTOMER P.O. NUMBER	SHIPPED VIA	FILE NO
559167	JIM NOWELL	E-26		COMPANY TRUCK	10336

RELEASED

OXY USA INC.  
REGIONAL OFFICE  
ATT: G. I. MCFARLAND  
PO BOX 26100  
OKLAHOMA CITY, OK 73126-0100

MAY 20 1992

FROM CONFIDENTIAL

DIRECT CORRESPONDENCE TO:  
FIRST OKLAHOMA TOWER  
210 WEST PARK AVENUE  
SUITE 2050  
OKLAHOMA CITY, OK 73102-5601

PRICE REF NO	DESCRIPTION	QUANTITY	U/M	UNIT PRICE	AMOUNT
PRICING AREA - MID CONTINENT					
000-117	MILEAGE	50	MI	2.35	117.50
		1	UNT		
000-118	MILEAGE SURCHARGE-CEMENT-LAND	50	MI	.40	20.00
		1	UNT		
001-016	CEMENTING CASING	376	FT	480.00	480.00
		1	UNT		
030-503	CMTG PLUG LA-11,CP-1,CP-3, TOP	8	5/8 IN	90.00	90.00
		1	EA		
40	CENTRALIZER 8-5/8" MOBEL S-4	3	EA	53.00	159.00
807.93059					
504-308	STANDARD CEMENT	270	SK	6.75	1,822.50
509-406	ANHYDROUS CALCIUM CHLORIDE	10	SK	26.25	262.50
507-210	FLOCELE	66	LB	1.30	85.80
500-207	BULK SERVICE CHARGE	294	CFT	1.10	323.40
500-306	MILEAGE CMTG MAT DEL OR RETURN	657.15	TMI	.75	492.86
500-307	MILEAGE SURCHARGE-CEMENT MAT.	657.15	TMI	.10	65.72
	INVOICE SUBTOTAL				3,919.28
	DISCOUNT-(BID)				766.71-
	INVOICE BID AMOUNT				3,152.57
	*-KANSAS STATE SALES TAX				106.99
	*-DECATUR COUNTY SALES TAX				25.17
	INVOICE TOTAL - PLEASE PAY THIS AMOUNT				\$3,284.73

RECEIVED  
STATE CORPORATION COMMISSION

MAY 08 1991

CONSERVATION DIVISION  
Wichita, Kansas

91572346X 2360.1/224

32

006

BB

AFFIX JOB TKT

TERMS INVOICES PAYABLE NET BY THE 20TH OF THE FOLLOWING MONTH AFTER DATE OF INVOICE. UPON CUSTOMER'S DEFAULT IN PAYMENT OF CUSTOMER'S ACCOUNT BY THE LAST DAY OF THE MONTH FOLLOWING THE MONTH IN WHICH THE INVOICE IS DATED, CUSTOMER AGREES TO PAY INTEREST THEREON AFTER DEFAULT AT THE HIGHEST LAWFUL CONTRACT RATE APPLICABLE BUT NEVER TO EXCEED 18% PER ANNUM. IN THE EVENT IT BECOMES NECESSARY TO EMPLOY AN ATTORNEY TO ENFORCE COLLECTION OF SAID ACCOUNT, CUSTOMER AGREES TO PAY ALL COLLECTION COSTS AND ATTORNEY FEES IN THE AMOUNT OF 20% OF THE AMOUNT OF THE UNPAID ACCOUNT.

FORM 1900-R4

PAGE: