

ORIGINAL

CONFIDENTIAL RELEASED

SIDE ONE

SEP 06 1991

STATE CORPORATION COMMISSION OF KANSAS
OIL & GAS CONSERVATION DIVISION
WELL COMPLETION FORM
ACO-1 WELL HISTORY
DESCRIPTION OF WELL AND LEASE

REC'D
8-22-90

API NO. 15- 147-20514-00-00
County Phillips FROM CONFIDENTIAL

NW NW SE Sec. 32 Twp. 5S Rge. 20 X East West

2310' Ft. North from Southeast Corner of Section

2310' Ft. West from Southeast Corner of Section
(NOTE: Locate well in section plat below.)

Lease Name Ray A Well # 8

Field Name Ray

Producing Formation Reagan

Elevation: Ground 2156' KB 2161'

Total Depth 3613' PBTD 3563'

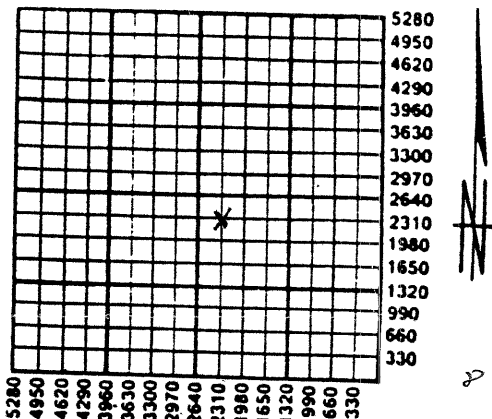

8-30-90

Amount of Surface Pipe Set and Cemented at 329' Feet

Multiple Stage Cementing Collar Used? X Yes ___ No

If yes, show depth set DV Tool at 1718' Feet

If Alternate II completion, cement circulated from 1718 feet depth to 0 w/ 350 sx cmt.

Operator: License # 5447

Name: OXY USA Inc.

Address P. O. Box 26100

Oklahoma City, OK 73126-0100

City/State/Zip

Purchaser: Permian

Operator Contact Person: Raymond Hui

Phone (405) 749-2471

Contractor: Name: Allen Drilling Company

License: 5418

Wellsite Geologist: Bill Keller

Designate Type of Completion

X New Well ___ Re-Entry ___ Workover

X Oil ___ SWD ___ Temp. Abd.

___ Gas ___ Inj ___ Delayed Comp.

___ Dry ___ Other (Core, Water Supply, etc.)

If OWMO: old well info as follows:

Operator:

Well Name:

Comp. Date Old Total Depth

Drilling Method:

X Mud Rotary ___ Air Rotary ___ Cable

7-2-90 7-8-90 7-29-90

Spud Date Date Reached TD Completion Date

INSTRUCTIONS: This form shall be completed in triplicate and filed with the Kansas Corporation Commission, 200 Colorado Derby Building, Wichita, Kansas 67202, within 120 days of the spud date of any well. Rule 82-3-130, 82-3-107 and 82-3-106 apply. Information on side two of this form will be held confidential for a period of 12 months if requested in writing and submitted with the form. See rule 82-3-107 for confidentiality in excess of 12 months. One copy of all wireline logs and drillers time log shall be attached with this form. ALL CEMENTING TICKETS MUST BE ATTACHED. Submit CP-4 form with all plugged wells. Submit CP-111 form with all temporarily abandoned wells. Any recompletion, workover or conversion of a well requires filing of ACO-2 within 120 days from commencement date of such work.

All requirements of the statutes, rules and regulations promulgated to regulate the oil and gas industry have been fully complied with and the statements herein are complete and correct to the best of my knowledge.

Signature Vic Tumlinson John M. White

Title Operations Drilling Manager Date 8-21-90

Subscribed and sworn to before me this 21st day of August 19 90.

Notary Public Kay Ann Kilmer

Date Commission Expires 4-16-94

K.C.C. OFFICE USE ONLY
F Letter of Confidentiality Attached
C Wireline Log Received
C Drillers Timelog Received
Distribution
KCC SWD/Rep NGPA
KGS Plug Other (Specify)

ORIGINAL

SIDE TWO

Operator Name OXY USA Inc. Lease Name Ray A Well # 8
 Sec. 32 Twp. 5 Rge. 20 East West
 County Phillips

INSTRUCTIONS: Show important tops and base of formations penetrated. Detail all cores. Report all drill stem tests giving interval tested, time tool open and closed, flowing and shut-in pressures, whether shut-in pressure reached static level, hydrostatic pressures, bottom hole temperature, fluid recovery, and flow rates if gas to surface during test. Attach extra sheet if more space is needed. Attach copy of log.

Drill Stem Tests Taken Yes No
 (Attach Additional Sheets.)
 Samples Sent to Geological Survey Yes No
 Cores Taken Yes No
 Electric Log Run Yes No
 (Submit Copy.)

Ran Dual Induction Laterolog; Micro Log;
 Spect. Density Dual Spaced Neutron II Log;
 TOC at 2570'

RELEASED
SEP 06 1991
FROM CONFIDENTIAL

Name	Formation Description	
	<input checked="" type="checkbox"/> Log	<input type="checkbox"/> Sample
	Top	Bottom
Hebner	3269'	
Toronto	3297'	
LKC	3311'	
Base KC	3506'	
TD		3613'
PBTD		3563'

CASING RECORD New Used
 Report all strings set-conductor, surface, intermediate, production, etc.

Purpose of String	Size Hole Drilled	Size Casing Set (In O.D.)	Weight Lbs./Ft.	Setting Depth	Type of Cement	# Sacks Used	Type and Percent Additives
Surface	12 1/4"	8 5/8"	24#	329'	C1.A	200	3% CaCl
Production	7 7/8"	5 1/2"	14#	3612'	*Pls refer to csg info below.		

Shots Per Foot	PERFORATION RECORD Specify Footage of Each Interval Perforated	Acid, Fracture, Shot, Cement Squeeze Record (Amount and Kind of Material Used)	Depth
4	Reagan 3551-53'	No acidized	-

TUBING RECORD Size 2 3/8" Set At 3516' Packer At _____ Liner Run Yes No

Date of First Production	Producing Method	Estimated Production Per 24 Hours	Oil Bbls.	Gas Mcf	Water Bbls.	Gas-Oil Ratio	Gravity
7-24-90	<input type="checkbox"/> Flowing <input checked="" type="checkbox"/> Pumping <input type="checkbox"/> Gas Lift <input type="checkbox"/> Other (Explain)		152	-	-		

Disposition of Gas: Vented Sold Used on Lease (If vented, submit ACO-18.)

METHOD OF COMPLETION

Open Hole Perforation Dually Completed Commingled
 Other (Specify) _____

Production Interval 3551-53'

*Production Csg Info: Cemented 1st stage w/175 sx. + 1/4 #/sx Flo. Cemented 2nd stage w/330 sx + 1/4# Flo.

HALLIBURTON SERVICES

ORIGINAL

A Halliburton Company

863628 07/07/1990

WELL LEASE NO./PLANT NAME		WELL NAME/LOCAT		STATE	WELL/PLANT OWNER
RAY A.A.		PHILLIPS		KS	OXY USA
SERVICE LOCATION		CONTRACTOR	JOB PURPOSE		TICKET DATE
BERLIN		ALLEN DRILLING	CREW PRODUCTION CASING		07/07/1990
ACCT. NO.	CUSTOMER AGENT	VENDOR NO.	CUSTOMER P.O. NUMBER	SHIPPED VIA	FILE NO.
659167	DONALD SHELDEN	E-26		COMPANY TRUCK	9783

OXY USA INC.
 REGIONAL OFFICE
 ATT: G. I. MCFARLAND
 PO BOX 26100
 OKLAHOMA CITY, OK 73126-0100

RELEASED

SEP 06 1991

DIRECT CORRESPONDENCE TO
 SUITE 600
 COLORADO DERBY BUILDING
 WICHITA, KS 67202-0000

FROM CONFIDENTIAL

PRICE REF NO	DESCRIPTION	QUANTITY	U/M	UNIT PRICE	AMOUNT
509-968	SALT	300	LB	.05	15.00
500-207	BULK SERVICE CHARGE	538	---	1.10	591.80
500-306	MILEAGE CNTG MAT DEL OR RETURN	1099.17	TMI	.75	824.38
INVOICE SUBTOTAL					12,644.79
DISCOUNT-(BID)					3,258.79
INVOICE BID AMOUNT					9,386.00
*-KANSAS STATE SALES TAX					399.32
*-DECATUR COUNTY SALES TAX					90.50
91572104 X 23601/724					
32 006 db BB					
INVOICE TOTAL - PLEASE PAY THIS AMOUNT					\$9,756.36

AFFIX JOB TRK

TERMS: INVOICES PAYABLE NET BY THE 20TH OF THE FOLLOWING MONTH AFTER DATE OF INVOICE UPON CUSTOMER'S DEFAULT IN PAYMENT OF CUSTOMER'S ACCOUNT BY THE LAST DAY OF THE MONTH FOLLOWING THE MONTH IN WHICH THE INVOICE IS DATED. CUSTOMER AGREES TO PAY INTEREST THEREON AFTER DEFAULT AT THE HIGHEST LAWFUL CONTRACT RATE APPLICABLE BUT NEVER TO EXCEED 18% PER ANNUM. IN THE EVENT IT BECOMES NECESSARY TO EMPLOY AN ATTORNEY TO ENFORCE COLLECTION OF SAID ACCOUNT, CUSTOMER AGREES TO PAY ALL COLLECTION COSTS AND ATTORNEY FEES IN THE AMOUNT OF 20% OF THE AMOUNT OF THE UNPAID ACCOUNT.

HALLIBURTON SERVICES

ORIGINAL

A Halliburton Company

WELL LEASE NO./PLANT NAME		WELL LEASE NO./LOCUS		STATE	WELL LEASE NO.
RAY A 8		PHILLIPS		KS	OXY USA
SERVICE LOCATION		CONTRACTOR		JOB PURPOSE	
JBERLIN		ALLEN DRILLING		CEMENT PRODUCTION CASING	
ACCT NO.		CUSTOMER AGENT		VENDOR NO.	
59167		DONALD SHELDEN		E-26	
CUSTOMER P.O. NUMBER		SHIPPED VIA		FILE NO.	
		COMPANY TRUCK		97633	
				07/07/1990	

CONFIDENTIAL

OXY USA INC.
REGIONAL OFFICE
ATTN: G. I. MCFARLAND
PO BOX 26100
OKLAHOMA CITY, OK 73126-0100

DIRECT CORRESPONDENCE TO:
SUITE 600
COLORADO DEBBY BUILDING
MICHIGAN, KS 67202-0000

RELEASED

PRICE REF NO	DESCRIPTION	QTY	UNIT	UNIT PRICE	AMOUNT
PRICING AREA - MID CONTINENT					
000-117	MILEAGE FROM CONF	45	MI	2.35	105.75
001-016	CEMENTING CASING	3612	FT	1,145.00	1,145.00
007-161	MULT STAGE CEMENTING-ADD STAGE	1	STG	950.00	950.00
018-317	SUPER FLUSH	12	SK	74.00	888.00
26	INSERT VALVE F. 5.- 5 1/2" 8RD	1	EA	223.00	223.00
847.6318					
27	FILL-UP UNIT 5 1/2"-6 5/8"	1	EA	30.00	30.00
815.19311					
71	MULT STAGE CEMENTER 5 1/2" DRD	1	EA	2,450.00	2,450.00
813.10354					
75	PLUG SET 5 1/2"	1	EA	400.00	400.00
812.0162					
40	CENTRALIZER 5-1/2" MODEL S-4	1	EA	440.00	440.00
807.93022					
320	CEMENT BASKET 5 1/2"	1	EA	90.00	90.00
800.8883					
350	HALLIBURTON WELD-A	1	LB	11.00	11.00
890.10802					
504-308	STANDARD CEMENT	25	SK	6.75	168.75
506-105	POZNIX A	25	SK	3.50	87.50
506-121	HALLIBURTON-GEL 2X	1	SK	.00	N/C
509-968	SALT	239	LB	.09	21.51
507-775	HALAD-322	63	LB	5.75	362.25
507-210	FLOCELE	13	LB	1.30	16.90
504-308	STANDARD CEMENT	125	SK	6.75	843.75
507-775	HALAD-322	118	LB	5.75	678.50
507-210	FLOCELE	31	LB	1.30	40.30
504-316	HALLIBURTON LIGHT W/STANDARD	350	SK	6.10	2,135.00
507-210	FLOCELE	86	LB	1.30	111.40

***** CONTINUED ON NEXT PAGE *****

AFFIX JOB TKT

TERMS: INVOICES PAYABLE NET BY THE 20TH OF THE FOLLOWING MONTH AFTER DATE OF INVOICE. UPON CUSTOMER'S DEFAULT IN PAYMENT OF CUSTOMER'S ACCOUNT BY THE LAST DAY OF THE MONTH FOLLOWING THE MONTH IN WHICH THE INVOICE IS DATED, CUSTOMER AGREES TO PAY INTEREST THEREON AFTER DEFAULT AT THE HIGHEST LAWFUL CONTRACT RATE APPLICABLE BUT NEVER TO EXCEED 18% PER ANNUM. IN THE EVENT IT BECOMES NECESSARY TO EMPLOY AN ATTORNEY TO ENFORCE COLLECTION OF SAID ACCOUNT, CUSTOMER AGREES TO PAY ALL COLLECTION COSTS AND ATTORNEY FEES IN THE AMOUNT OF 20% OF THE AMOUNT OF THE UNPAID ACCOUNT.

HALLIBURTON SERVICES

ORIGINAL

INVOICE

A Halliburton Company

INVOICE NO. 863473 07/02/1990

WELL LEASE NO./PLANT NAME RAY 'A' 8		WELL/PLANT LOCATION PHILLIPS		STATE KS	WELL/PLANT OWNER OXY USA INC.
SERVICE LOCATION BERLIN		CONTRACTOR ALLEN DRLG.	JOB PURPOSE CEMENT SURFACE CASING		TICKET DATE 07/02/1990
ACCT. NO. 659167	CUSTOMER AGENT DONALD E. SHELDEN	VENDOR NO. E-26	CUSTOMER P.O. NUMBER	SHIPPED VIA COMPANY TRUCK	FILE NO. 97652

OXY USA INC.
REGIONAL OFFICE
ATTN: G. I. MCFARLAND
PO BOX 26100
OKLAHOMA CITY, OK 73126-0100

CONFIDENTIAL

DIRECT CORRESPONDENCE TO:
SUITE 600
COLORADO DERBY BUILDING
WICHITA, KS 67202-0000

RELEASED

PRICE REF. NO.	DESCRIPTION	QUANTITY	UNIT	UNIT PRICE	AMOUNT
PRICING AREA - MID CONTINENT					
000-117	MILEAGE	45	MI	2.35	105.75
001-016	CEMENTING CASING	337	FT	480.00	480.00
030-503	CMTG PLUG LA-11, CP-1, CP-3, TOP	8	5/8 IN	59.00	472.00
40	CENTRALIZER 8-5/8" MODEL 9-4	3	EA	52.00	156.00
807.93059					
504-308	STANDARD CEMENT	200	SK	6.75	1350.00
509-406	ANHYDROUS CALCIUM CHLORIDE	6	SK	45.00	270.00
507-210	FLOCELE	50	TY	1.30	65.00
500-207	BULK SERVICE CHARGE	216	CFT	1.15	248.40
500-306	MILEAGE CMTG MAT DEL OR RETURN	432	MI	.75	324.00
INVOICE SUBTOTAL					2,940.05
DISCOUNT - (BID) 1%					529.19
INVOICE BID AMOUNT					2,410.86
*- KANSAS STATE SALES TAX					80.00
*- DECATUR COUNTY SALES TAX					18.81
<i>91572104 x 2360.1/724</i>					
INVOICE TOTAL - PLEASE PAY THIS AMOUNT					\$2,509.67

32

006

BB BR

AFFIX JOB TRK

TERMS: INVOICES PAYABLE NET BY THE 20TH OF THE FOLLOWING MONTH AFTER DATE OF INVOICE UPON CUSTOMER'S DEFAULT IN PAYMENT OF CUSTOMER'S ACCOUNT BY THE LAST DAY OF THE MONTH FOLLOWING THE MONTH IN WHICH THE INVOICE IS DATED. CUSTOMER AGREES TO PAY INTEREST THEREON AFTER DEFAULT AT THE HIGHEST LAWFUL CONTRACT RATE APPLICABLE, BUT NEVER TO EXCEED 18% PER ANNUM. IN THE EVENT IT BECOMES NECESSARY TO EMPLOY AN ATTORNEY TO ENFORCE COLLECTION OF SAID ACCOUNT, CUSTOMER AGREES TO PAY ALL COLLECTION COSTS AND ATTORNEY FEES IN THE AMOUNT OF 20% OF THE AMOUNT OF THE UNPAID ACCOUNT.