

For KCC Use: Effective Date: 1-1-05 District # 2 SGA? Yes No

KANSAS CORPORATION COMMISSION OIL & GAS CONSERVATION DIVISION

Form C-1 December 2002 Form must be Typed Form must be Signed All blanks must be Filled

NOTICE OF INTENT TO DRILL

Must be approved by KCC five (5) days prior to commencing well

Expected Spud Date January 3, 2005 OPERATOR: License# 32977 Name: Dorado Gas Resources LLC Address: 14550 East Easter Ave., Ste. 1000 City/State/Zip: Centennial, CO 80112 Contact Person: Steven Tedesco Phone: 720-889-0510

CONTRACTOR: License# 32854 Name: Gulick Drilling

Spot Ap. SE-NE-NW-SW Sec. 31 Twp. 30 S. R. 8 East West 2217 feet from N / S Line of Section 3696 feet from E / W Line of Section Irregular Is SECTION Regular Irregular?

(Note: Locate well on the Section Plat on reverse side)

County: Cowley Lease Name: Ferguson Ranch Well #: 11-31 Field Name: Wildcat

Is this a Prorated / Spaced Field? Yes No Target Formation(s): Arbuckle

Nearest Lease or unit boundary: 2217 FSL, 3696 FAWEL Ground Surface Elevation: 1480 feet MSL

Water well within one-quarter mile: Yes No Public water supply well within one mile: Yes No

Depth to bottom of fresh water: 300 Depth to bottom of usable water: 430

Surface Pipe by Alternate: 1 2 Length of Surface Pipe Planned to be set: 450 feet

Length of Conductor Pipe required: None Projected Total Depth: 3300

Formation at Total Depth: Arbuckle Water Source for Drilling Operations: Well Farm Pond Other

DWR Permit #: Will Cores be taken? Yes No

(Note: Apply for Permit with DWR)

If Yes, proposed zone:

Well Drilled For: Oil Enh Rec Gas Storage OWWO Disposal Seismic; # of Holes Other Well Class: Infield Pool Ext. Wildcat Other Type Equipment: Mud Rotary Air Rotary Cable

If OWWO: old well information as follows: Operator: Well Name: Original Completion Date: Original Total Depth:

Directional, Deviated or Horizontal wellbore? Yes No

If Yes, true vertical depth:

Bottom Hole Location:

KCC DKT #:

AFFIDAVIT

The undersigned hereby affirms that the drilling, completion and eventual plugging of this well will comply with K.S.A. 55 et. seq. It is agreed that the following minimum requirements will be met:

- 1. Notify the appropriate district office prior to spudding of well;
2. A copy of the approved notice of intent to drill shall be posted on each drilling rig;
3. The minimum amount of surface pipe as specified below shall be set by circulating cement to the top; in all cases production pipe shall be set through all unconsolidated materials plus a minimum of 20 feet into the underlying formation.
4. If the well is dry hole, an agreement between the operator and the district office on plug length and placement is necessary prior to plugging;
5. The appropriate district office will be notified before well is either plugged or production casing is cemented in;
6. If an ALTERNATE II COMPLETION, production pipe shall be cemented from below any usable water to surface within 120 days of spud date. Or pursuant to Appendix "B" - Eastern Kansas surface casing order #133,891-C, which applies to the KCC District 3 area, alternate II cementing must be completed within 30 days of the spud date or the well shall be plugged. In all cases, NOTIFY district office prior to any cementing.

I hereby certify that the statements made herein are true and to the best of my knowledge and belief.

Date: December 22, 2004 Signature of Operator or Agent: [Signature] Title: Manager of Geology

For KCC Use ONLY

API # 15 - 035-24217-00-00 Conductor pipe required NONE feet Minimum surface pipe required 450 feet per Alt. (1) X Approved by: DPLW 12-27-04 This authorization expires: 1-27-05 (This authorization void if drilling not started within 6 months of effective date.) Spud date: Agent:

Remember to:

- File Drill Pit Application (form GDP-1) with Intent to Drill;
- File Completion Form ACO-1 within 120 days of spud date;
- File acreage attribution plat according to field proration orders;
- Notify appropriate district office 48 hours prior to workover or re-entry;
- Submit plugging report (CP-4) after plugging is completed;
- Obtain written approval before disposing or injecting salt water.
- If this permit has expired (See: authorized expiration date) please check the box below and return to the address below.

Well Not Drilled - Permit Expired Signature of Operator or Agent: Date:

Mail to: KCC - Conservation Division, 130 S. Market - Room 2078, Wichita, Kansas 67202

RECEIVED KANSAS CORPORATION COMMISSION DEC 27 2004 CONSERVATION DIVISION WICHITA, KS

31 30 82

IN ALL CASES PLOT THE INTENDED WELL ON THE PLAT BELOW

Plat of acreage attributable to a well in a prorated or spaced field

If the intended well is in a prorated or spaced field, please fully complete this side of the form. If the intended well is in a prorated or spaced field complete the plat below showing that the well will be properly located in relationship to other wells producing from the common source of supply. Please show all the wells and within 1 mile of the boundaries of the proposed acreage attribution unit for gas wells and within 1/2 mile of the boundaries of the proposed acreage attribution unit for oil wells.

API No. 15 - _____
 Operator: Dorado Gas Resources LLC
 Lease: Ferguson Ranch
 Well Number: 11-31
 Field: Wildcat
 Number of Acres attributable to well: 40
 QTR / QTR / QTR of acreage: _____ - _____ - SW

Location of Well: County: Cowley
2112 2217 feet from N / S Line of Section
3696 feet from E / W Line of Section
 Sec. 31 Twp. 30 S. R. 8 East West

Is Section: Regular or Irregular

If Section is Irregular, locate well from nearest corner boundary.

Section corner used: NE NW SE SW

PLAT

*(Show location of the well and shade attributable acreage for prorated or spaced wells.)
 (Show footage to the nearest lease or unit boundary line.)*

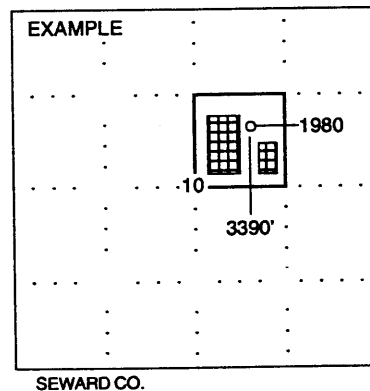
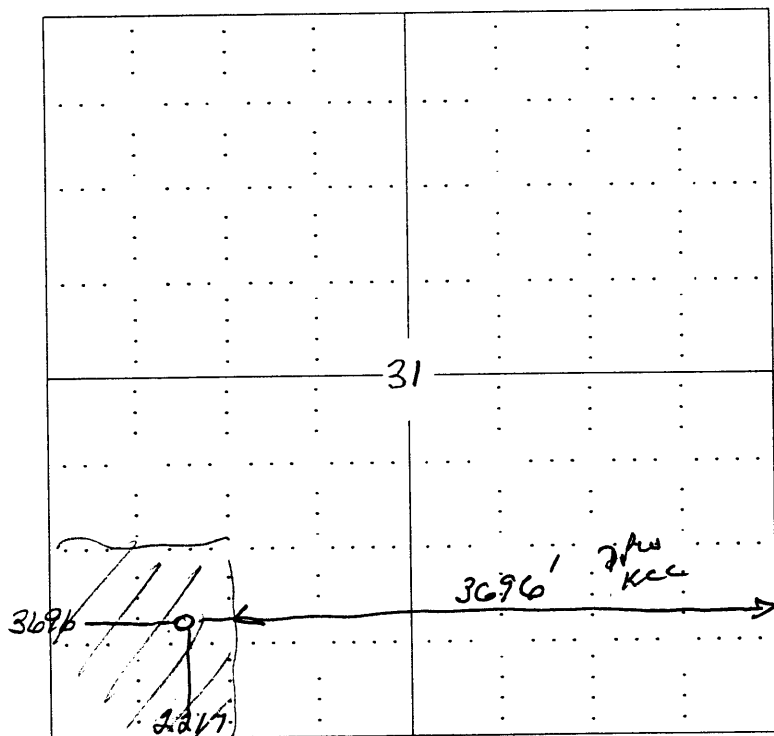

NOTE: In all cases locate the spot of the proposed drilling location.

In plotting the proposed location of the well, you must show:

1. The manner in which you are using the depicted plat by identifying section lines, i.e. 1 section, 1 section with 8 surrounding sections, 4 sections, etc.
2. The distance of the proposed drilling location from the section's south / north and east / west.
3. The distance to the nearest lease or unit boundary line.
4. If proposed location is located within a prorated or spaced field a certificate of acreage attribution plat must be attached: (CO-7 for oil wells; CG-8 for gas wells).