

For KCC Use:  
Effective Date: 4/12-7-04  
District # \_\_\_\_\_  
SGA? ☒ Yes ☐ No

KANSAS CORPORATION COMMISSION  
OIL & GAS CONSERVATION DIVISION

NOTICE OF INTENT TO DRILL

Must be approved by KCC five (5) days prior to commencing well

Form C-1  
September 1999  
Form must be Typed  
Form must be Signed  
All blanks must be Filled

Expected Spud Date 12 09 04  
month day year

OPERATOR: License# 30420 (6-30-05)  
Name: V.J.I. Natural Resources Inc.  
Address: 30-38 48th St.  
City/State/Zip: Astoria, New York 11103  
Contact Person: Jason Dinges  
Phone: 785-625-8360

CONTRACTOR: License# 33237 (5-30-05)  
Name: Anderson Drilling Co.

Well Drilled For: ☒ Oil ☐ Enh Rec ☐ Infield ☒ Mud Rotary  
☐ Gas ☐ Storage ☐ Pool Ext. ☐ Air Rotary  
☐ OWWO ☐ Disposal ☒ Wildcat ☐ Cable  
☐ Seismic; # of Holes ☐ Other  
☐ Other

If OWWO: old well information as follows:

Operator: \_\_\_\_\_  
Well Name: \_\_\_\_\_  
Original Completion Date: \_\_\_\_\_ Original Total Depth: \_\_\_\_\_

Directional, Deviated or Horizontal wellbore? ☐ Yes ☐ No

If Yes, true vertical depth: \_\_\_\_\_

Bottom Hole Location: RECEIVED

KCC DKT #: \_\_\_\_\_

\* Look for Lost DEC 01 2004  
Circ. zones  
Above Anhydrite

KCC WICHITA

AFFIDAVIT

The undersigned hereby affirms that the drilling, completion and eventual plugging of this well will comply with K.S.A. 55-101, et. seq.  
It is agreed that the following minimum requirements will be met:

1. Notify the appropriate district office **prior** to spudding of well;
2. A copy of the approved notice of intent to drill **shall be** posted on each drilling rig;
3. The minimum amount of surface pipe as specified below **shall be set** by circulating cement to the top; in all cases surface pipe **shall be set** through all unconsolidated materials plus a minimum of 20 feet into the underlying formation.
4. If the well is dry hole, an agreement between the operator and the district office on plug length and placement is necessary **prior to plugging**;
5. The appropriate district office will be notified before well is either plugged or production casing is cemented in;
6. If an ALTERNATE II COMPLETION, production pipe shall be cemented from below any usable water to surface within **120 days** of spud date. **In all cases, NOTIFY district office** prior to any cementing.

I hereby certify that the statements made herein are true and to the best of my knowledge and belief.

Date: 11-29-04 Signature of Operator or Agent: Jason Dinges Title: Agent

For KCC Use ONLY

API # 15 - 051-25374.00-00  
Conductor pipe required NONE feet  
Minimum surface pipe required 200 feet per Alt. + ②  
Approved by: RJP 12-2-04  
This authorization expires: 6-2-05  
(This authorization void if drilling not started within 6 months of effective date.)  
Spud date: \_\_\_\_\_ Agent: \_\_\_\_\_

Spot \_\_\_\_\_ East ☐  
\_\_\_\_\_ West ☒  
\_\_\_\_\_ SW - SW - NW Sec. 15 Twp. 15 S. R. 19  
\_\_\_\_\_ 2310 feet from S / 10 (circle one) Line of Section  
\_\_\_\_\_ 330 feet from E / 10 (circle one) Line of Section  
Is SECTION ☒ Regular \_\_\_\_\_ Irregular?

(Note: Locate well on the Section Plat on reverse side)

County: Ellis

Lease Name: Haselhorst Trust Well #: 1

Field Name: Wildcat

Is this a Prorated / Spaced Field? ☐ Yes ☒ No

Target Formation(s): Reagan Sand

Nearest Lease or unit boundary: 330

Ground Surface Elevation: \_\_\_\_\_ 2008est feet MSL

Water well within one-quarter mile: ☐ Yes ☒ No

Public water supply well within one mile: ☐ Yes ☒ No

Depth to bottom of fresh water: 401 180

Depth to bottom of usable water: 400 520 PERMIAN

Surface Pipe by Alternate: \_\_\_\_\_ 1 ☒ 2

Length of Surface Pipe Planned to be set: 260'

Length of Conductor Pipe required: none

Projected Total Depth: 3660

Formation at Total Depth: Reagan Sandstone

Water Source for Drilling Operations:

Well ☒ Farm Pond \_\_\_\_\_ Other \_\_\_\_\_

DWR Permit #: \_\_\_\_\_

(Note: Apply for Permit with DWR ☒)

Will Cores be taken? ☐ Yes ☒ No

If Yes, proposed zone: \_\_\_\_\_

Remember to:

- File Drill Pit Application (form CDP-1) with Intent to Drill;
- File Completion Form ACO-1 within 120 days of spud date;
- File acreage attribution plat according to field proration orders;
- Notify appropriate district office 48 hours prior to workover or re-entry;
- Submit plugging report (CP-4) after plugging is completed;
- Obtain written approval before disposing or injecting salt water.

15 15 1922

**IN ALL CASES PLOT THE INTENDED WELL ON THE PLAT BELOW**

Plat of acreage attributable to a well in a prorated or spaced field

If the intended well is in a prorated or spaced field, please fully complete this side of the form. If the intended well is in a prorated or spaced field complete the plat below showing that the well will be properly located in relationship to other wells producing from the common source of supply. Please show all the wells and within 1 mile of the boundaries of the proposed acreage attribution unit for gas wells and within 1/2 mile of the boundaries of the proposed acreage attribution unit for oil wells.

API No. 15 - \_\_\_\_\_

Operator: V.J.I. Natural Resources Inc.Lease: Haselhorst TrustWell Number: 1Field: Wildcat

Number of Acres attributable to well: \_\_\_\_\_

QTR / QTR / QTR of acreage: \_\_\_\_\_ - \_\_\_\_\_ - \_\_\_\_\_

Location of Well: County: Ellis\_\_\_\_\_ 2310 feet from S / N (circle one) Line of Section\_\_\_\_\_ 330 feet from E / W (circle one) Line of SectionSec. 15 Twp. 15 S. R. 19 ☐ East ☒ WestIs Section x Regular or \_\_\_\_\_ Irregular

If Section is Irregular, locate well from nearest corner boundary.

Section corner used: \_\_\_\_\_ NE \_\_\_\_\_ NW \_\_\_\_\_ SE \_\_\_\_\_ SW

**PLAT**

(Show location of the well and shade attributable acreage for prorated or spaced wells.)

(Show footage to the nearest lease or unit boundary line.)

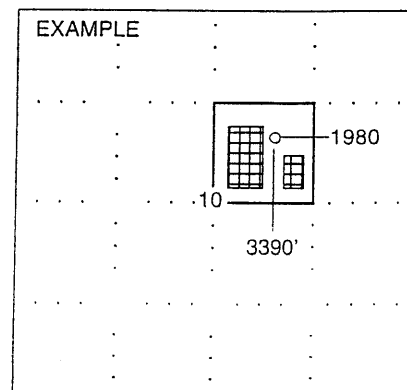
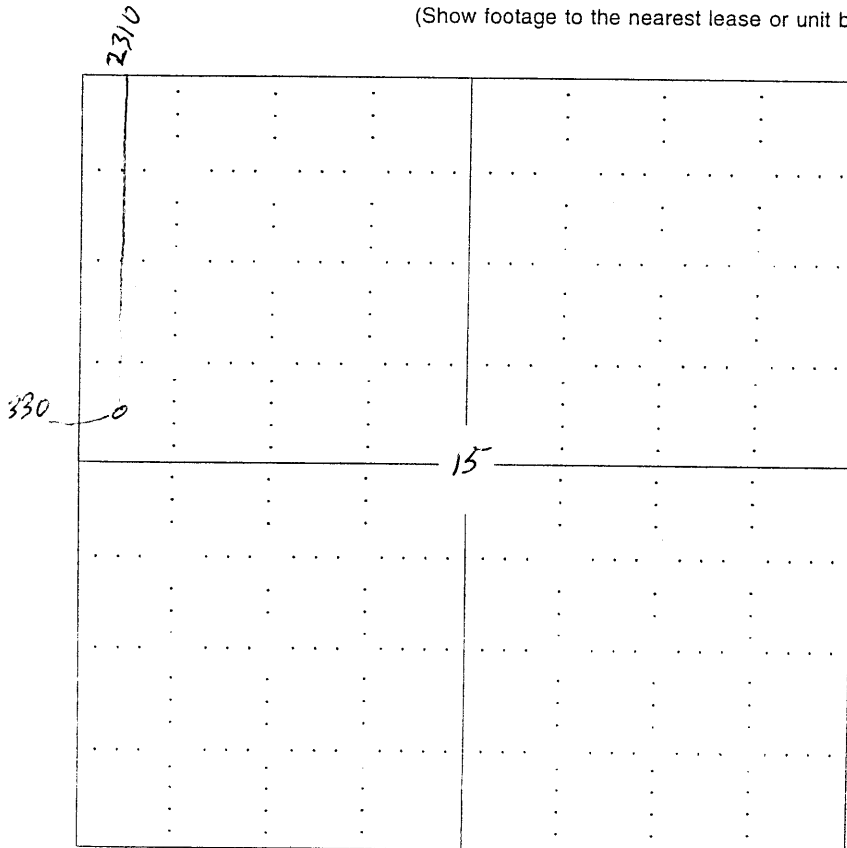
**NOTE: In all cases locate the spot of the proposed drilling location.****In plotting the proposed location of the well, you must show:**

1. The manner in which you are using the depicted plat by identifying section lines, i.e. 1 section, 1 section with 8 surrounding sections, 4 sections, etc.
2. The distance of the proposed drilling location from the section's south / north and east / west.
3. The distance to the nearest lease or unit boundary line.
4. If proposed location is located within a prorated or spaced field a certificate of acreage attribution plat must be attached: (CO-7 for oil wells; CG-8 for gas wells).

# KANSAS

CORPORATION COMMISSION

KATHLEEN SEBELIUS, GOVERNOR

BRIAN J. MOLINE, CHAIR

ROBERT E. KREHBIEL, COMMISSIONER

MICHAEL C. MOFFET, COMMISSIONER

December 1, 2004

Mr. Jason Dinges  
V.J.I. Natural Resources, Inc.  
30 -38 48<sup>th</sup> St.  
Astoria, New York 11103

RE: Drilling Pit Application  
Haselhorst Trust Lease Well No. 1  
NW/4 Sec. 15-15S-19W  
Ellis County, Kansas

Dear Mr. Dinges:

District staff has inspected the above referenced location and has determined that the reserve pit shall be constructed **without slots**, the bottom shall be flat and reasonably level, and the free fluids must be removed as soon as practical after drilling operations have ceased. Be aware of artesian flow if elevations are low. **Pease keep all pits away from any draws.**

**If production casing is set all completion fluids shall be removed on a daily basis.**

The fluids should be taken to an authorized disposal well. Please call the District Office at (785) 625-0550 when the fluids have been removed. Also please file the enclosed CDP-5 form, Surface Pond Waste Transfer, within 30 days of fluid removal.

**A copy of this letter should be posted in the doghouse along with the approved Intent to Drill.**

If you have any questions or concerns please feel free to contact the undersigned at the above address.

Sincerely,

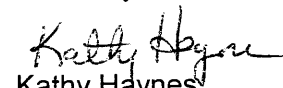

Kathy Haynes  
Environmental Protection and Remediation Department

cc: H Deines