

For KCC Use: 12.28.04
 Effective Date: _____
 District #: 4
 SGA? Yes No

KANSAS CORPORATION COMMISSION
 OIL & GAS CONSERVATION DIVISION

NOTICE OF INTENT TO DRILL

Must be approved by KCC five (5) days prior to commencing well

Form C-1
 September 1999
 Form must be Typed
 Form must be Signed
 All blanks must be Filled

Expected Spud Date 1 10 05
 month / day year

OPERATOR: License# 5145
 Name: Dreiling Oil, Inc.
 Address: Box 550
 City/State/Zip: Hays, KS 67601
 Contact Person: Terry Piesker
 Phone: 785 625-8327

CONTRACTOR: License# 31548
 Name: Discovery Drilling

Well Drilled For:	Well Class:	Type Equipment:
<input checked="" type="checkbox"/> Oil	<input type="checkbox"/> Enh Rec	<input checked="" type="checkbox"/> Infield
<input type="checkbox"/> Gas	<input type="checkbox"/> Storage	<input checked="" type="checkbox"/> Mud Rotary
<input type="checkbox"/> OWWO	<input type="checkbox"/> Disposal	<input type="checkbox"/> Air Rotary
<input type="checkbox"/> Seismic; # of Holes _____	<input type="checkbox"/> Wildcat	<input type="checkbox"/> Cable
<input type="checkbox"/> Other _____	<input type="checkbox"/> Other _____	

If OWWO: old well information as follows:

Operator: _____
 Well Name: _____
 Original Completion Date: _____ Original Total Depth: _____

Directional, Deviated or Horizontal wellbore? Yes No

If Yes, true vertical depth: _____

Bottom Hole Location: _____

KCC DKT #: _____

**Unit Boundary - info recieved*

Spot 230' N of
NE - NE - SE Sec. 5 Twp. 14 S. R. 17 East West
2540 feet from (S) / (circle one) Line of Section
330 feet from (E) / (circle one) Line of Section
 Is SECTION Regular Irregular?

(Note: Locate well on the Section Plat on reverse side)

County: Ellis
 Lease Name: Hoffman/Dinkel Well #: 1
 Field Name: Younger

Is this a Prorated / Spaced Field? Yes No

Target Formation(s): LKC & Arbuckle

Nearest Lease or unit boundary: 330'

Ground Surface Elevation: 2024' feet MSL

Water well within one-quarter mile: Yes No

Public water supply well within one mile: Yes No

Depth to bottom of fresh water: 180'

Depth to bottom of usable water: 640'

Surface Pipe by Alternate: 1 2

Length of Surface Pipe Planned to be set: 200+

Length of Conductor Pipe required: None

Projected Total Depth: 3600'

Formation at Total Depth: Arbuckle

Water Source for Drilling Operations:

Well _____ Farm Pond Other _____

DWR Permit #: _____

(Note: Apply for Permit with DWR)

Will Cores be taken? Yes No

If Yes, proposed zone: _____

AFFIDAVIT

RECEIVED

DEC 23 2004

KCC WICHITA

The undersigned hereby affirms that the drilling, completion and eventual plugging of this well will comply with K.S.A. 55-1001. It is agreed that the following minimum requirements will be met:

1. Notify the appropriate district office prior to spudding of well;
2. A copy of the approved notice of intent to drill shall be posted on each drilling rig;
3. The minimum amount of surface pipe as specified below shall be set by circulating cement to the top; in all cases surface pipe shall be set through all unconsolidated materials plus a minimum of 20 feet into the underlying formation.
4. If the well is dry hole, an agreement between the operator and the district office on plug length and placement is necessary prior to plugging;
5. The appropriate district office will be notified before well is either plugged or production casing is cemented in;
6. If an ALTERNATE II COMPLETION, production pipe shall be cemented from below any usable water to surface within 120 days of spud date. In all cases, NOTIFY district office prior to any cementing.

I hereby certify that the statements made herein are true and to the best of my knowledge and belief.

Date: 12/2/04 Signature of Operator or Agent: Terry W. Piesker Title: Explora. & Develop. Man.

For KCC Use ONLY

API # 15 - 051-25380-00-00

Conductor pipe required NONE feet

Minimum surface pipe required 200 feet per Alt. 2

Approved by RJP 12-23-04

This authorization expires: 6-23-05

(This authorization void if drilling not started within 6 months of effective date.)

Spud date: _____ Agent: _____

Remember to:

- File Drill Pit Application (form CDP-1) with Intent to Drill;
- File Completion Form ACO-1 within 120 days of spud date;
- File acreage attribution plat according to field proration orders;
- Notify appropriate district office 48 hours prior to workover or re-entry;
- Submit plugging report (CP-4) after plugging is completed;
- Obtain written approval before disposing or injecting salt water.

5
14
17

IN ALL CASES PLOT THE INTENDED WELL ON THE PLAT BELOW

Plat of acreage attributable to a well in a prorated or spaced field

If the intended well is in a prorated or spaced field, please fully complete this side of the form. If the intended well is in a prorated or spaced field complete the plat below showing that the well will be properly located in relationship to other wells producing from the common source of supply. Please show all the wells and within 1 mile of the boundaries of the proposed acreage attribution unit for gas wells and within 1/2 mile of the boundaries of the proposed acreage attribution unit for oil wells.

API No. 15 - _____
 Operator: Dreiling Oil, Inc.
 Lease: Hoffman/Dinkel
 Well Number: 1
 Field: Younger
 Number of Acres attributable to ~~well~~: 40 Unit
 QTR / QTR / QTR of acreage: _____

Location of Well: County: Ellis
 _____ 2540 _____ feet from (S) / N (circle one) Line of Section
 _____ 330 _____ feet from (E) / W (circle one) Line of Section
 Sec. 5 Twp. 14 S. R. 17 East West

Is Section x Regular or _____ Irregular

If Section is Irregular, locate well from nearest corner boundary.
 Section corner used: ___NE ___NW ___SE ___SW

PLAT

(Show location of the well and shade attributable acreage for prorated or spaced wells.)
 (Show footage to the nearest lease or unit boundary line.)

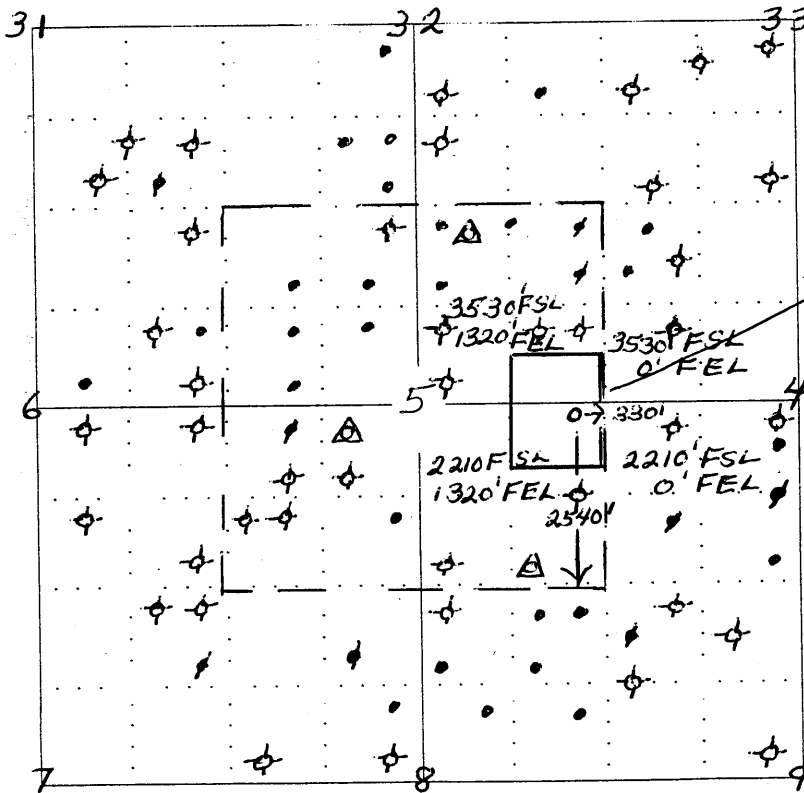

*Hoffman/Dinkel Unit
 40 Acre Unit*

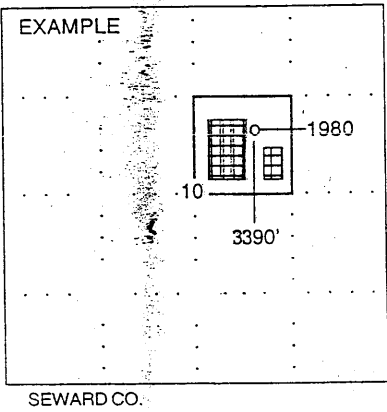

NOTE: In all cases locate the spot of the proposed drilling location.

In plotting the proposed location of the well, you must show:

1. The manner in which you are using the depicted plat by identifying section lines, i.e. 1 section, 1 section with 8 surrounding sections, 4 sections, etc.
2. The distance of the proposed drilling location from the section's south / north and east / west.
3. The distance to the nearest lease or unit boundary line.
4. If proposed location is located within a prorated or spaced field a certificate of acreage attribution plat must be attached: (CO-7 for oil wells; CG-8 for gas wells).