

For KCC Use:
Effective Date: 12.21.04
District # 3
SGA? Yes No

KANSAS CORPORATION COMMISSION
OIL & GAS CONSERVATION DIVISION
NOTICE OF INTENT TO DRILL

Form C-1
December 2002
Form must be Typed
Form must be Signed
All blanks must be Filled

Must be approved by KCC five (5) days prior to commencing well

Expected Spud Date December 21, 2004
month day year

OPERATOR: License# 33397 (4-30-05)
Name: Running Foxes Petroleum, Inc.
Address: 14550 E. Easter Avenue, Suite 1000
City/State/Zip: Centennial, CO 80112
Contact Person: Steven Tedesco
Phone: 303.671.742

CONTRACTOR: License# 5786 (8-30-05)
Name: McGowan Drilling

Well Drilled For: Oil, Gas, OWWO, Seismic, Other
Well Class: Enh Rec, Storage, Disposal, Other
Type Equipment: Infield, Pool Ext, Wildcat, Other, Mud Rotary, Air Rotary, Cable

If OWWO: old well information as follows:
Operator:
Well Name:
Original Completion Date:
Original Total Depth:

Directional, Deviated or Horizontal wellbore? Yes No
If Yes, true vertical depth:
Bottom Hole Location:
KCC DKT #:

Spot C SE SW Sec. 14 Twp. 26 S. R. 23
660 feet from N S Line of Section
1980 feet from E W Line of Section
Is SECTION Regular Irregular?

(Note: Locate well on the Section Plat on reverse side)
County: Bourbon
Lease Name: Martin Trust Well #: 14-14
Field Name: Petersburg East

Is this a Prorated / Spaced Field? Yes No
Target Formation(s): Cherokee Coals
Nearest Lease or unit boundary: 660 feet from South line of drilling unit

Ground Surface Elevation: 920 feet MSL
Water well within one-quarter mile: Yes No
Public water supply well within one mile: Yes No
Depth to bottom of fresh water: > 100 feet
Depth to bottom of usable water: > 200 feet
Surface Pipe by Alternate: 1 2
Length of Surface Pipe Planned to be set: 20 feet
Length of Conductor Pipe required: None
Projected Total Depth: 550 feet
Formation at Total Depth: Mississippian
Water Source for Drilling Operations: Well Farm Pond Other
DWR Permit #:

(Note: Apply for Permit with DWR)
Will Cores be taken? Yes No
If Yes, proposed zone:

AFFIDAVIT

RECEIVED
KANSAS CORPORATION COMMISSION

DEC 15 2004

CONSERVATION DIVISION

The undersigned hereby affirms that the drilling, completion and eventual plugging of this well will comply with K.S.A. 55 et. seq.
It is agreed that the following minimum requirements will be met:

- 1. Notify the appropriate district office prior to spudding of well;
2. A copy of the approved notice of intent to drill shall be posted on each drilling rig;
3. The minimum amount of surface pipe as specified below shall be set by circulating cement to the top; in all cases surface pipe shall be set through all unconsolidated materials plus a minimum of 20 feet into the underlying formation.
4. If the well is dry hole, an agreement between the operator and the district office on plug length and placement is necessary prior to plugging;
5. The appropriate district office will be notified before well is either plugged or production casing is cemented in;
6. If an ALTERNATE II COMPLETION, production pipe shall be cemented from below any usable water to surface within 120 days of spud date. Or pursuant to Appendix "B" - Eastern Kansas surface casing order #133,891-C, which applies to the KCC District 3 area, alternate II cementing must be completed within 30 days of the spud date or the well shall be plugged. In all cases, NOTIFY district office prior to any cementing.

I hereby certify that the statements made herein are true and to the best of my knowledge and belief.

Date: 12/14/04 Signature of Operator or Agent: Dennis D. Biteman Title: Agent

For KCC Use ONLY
API # 15 - 011-23052-00-00
Conductor pipe required NONE feet
Minimum surface pipe required 20 feet per Alt.
Approved by: RJP 12.16.04
This authorization expires: 6.16.05
Spud date: Agent:

Remember to:
- File Drill Pit Application (form CDP-1) with Intent to Drill;
- File Completion Form ACO-1 within 120 days of spud date;
- File acreage attribution plat according to field proration orders;
- Notify appropriate district office 48 hours prior to workover or re-entry;
- Submit plugging report (CP-4) after plugging is completed;
- Obtain written approval before disposing or injecting salt water.
- If this permit has expired (See: authorized expiration date) please check the box below and return to the address below.
Well Not Drilled - Permit Expired
Signature of Operator or Agent:
Date:

1426234

**IN ALL CASES PLOT THE INTENDED WELL ON THE PLAT BELOW**

*Plat of acreage attributable to a well in a prorated or spaced field*

*If the intended well is in a prorated or spaced field, please fully complete this side of the form. If the intended well is in a prorated or spaced field complete the plat below showing that the well will be properly located in relationship to other wells producing from the common source of supply. Please show all the wells and within 1 mile of the boundaries of the proposed acreage attribution unit for gas wells and within 1/2 mile of the boundaries of the proposed acreage attribution unit for oil wells.*

API No. 15 - \_\_\_\_\_  
 Operator: Running Foxes Petroleum, Inc.  
 Lease: Martin Trust  
 Well Number: 14-14  
 Field: Petersburg East  
 Number of Acres attributable to well: 80  
 QTR / QTR / QTR of acreage: C - SE - SW

Location of Well: County: Bourbon  
660 feet from  N /  S Line of Section  
1980 feet from  E /  W Line of Section  
 Sec. 14 Twp. 26 S. R. 23  East  West

Is Section:  Regular or  Irregular

If Section is Irregular, locate well from nearest corner boundary.  
 Section corner used:  NE  NW  SE  SW

**PLAT**

*(Show location of the well and shade attributable acreage for prorated or spaced wells.)  
 (Show footage to the nearest lease or unit boundary line.)*

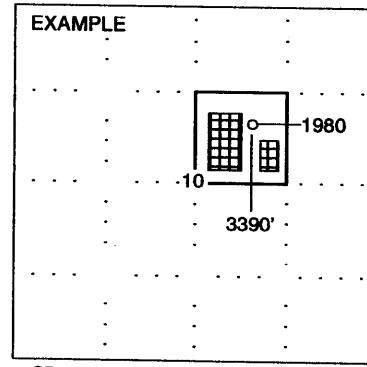
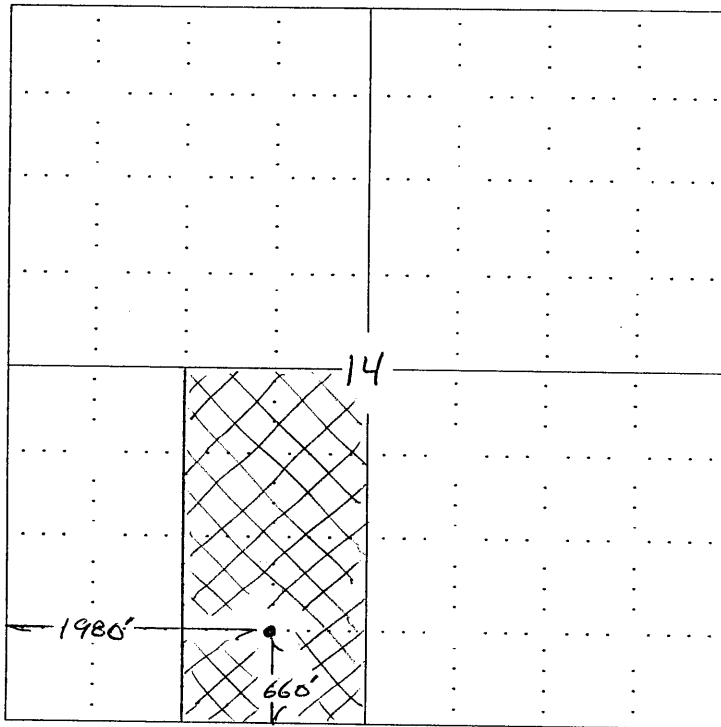

**NOTE: In all cases locate the spot of the proposed drilling location.**

**In plotting the proposed location of the well, you must show:**

1. The manner in which you are using the depicted plat by identifying section lines, i.e. 1 section, 1 section with 8 surrounding sections, 4 sections, etc.
2. The distance of the proposed drilling location from the section's south / north and east / west.
3. The distance to the nearest lease or unit boundary line.
4. If proposed location is located within a prorated or spaced field a certificate of acreage attribution plat must be attached: (CO-7 for oil wells; CG-8 for gas wells).