

For KCC Use: 1-18-2005
Effective Date: 3
District # _____
SGA? Yes No

KANSAS CORPORATION COMMISSION
OIL & GAS CONSERVATION DIVISION
NOTICE OF INTENT TO DRILL

Form C-1
September 1999
Form must be Typed
Form must be Signed
All blanks must be Filled

Must be approved by KCC five (5) days prior to commencing well

Expected Spud Date 1 5 05
month day year
OPERATOR: License# 33247 (5-30-05)
Name: Petro Oil & Gas, Inc.
Address: P.O. Box 34
City/State/Zip: Piqua, KS 66761
Contact Person: F.L. Ballard
Phone: 620-468-2885

CONTRACTOR: License# 33072 (7-30-05)
Name: Well Refined Drilling Company

Well Drilled For:		Well Class:		Type Equipment:	
<input type="checkbox"/> Oil	<input type="checkbox"/> Enh Rec	<input checked="" type="checkbox"/> Infield	<input type="checkbox"/> Mud Rotary	<input type="checkbox"/> Mud Rotary	
<input checked="" type="checkbox"/> Gas	<input type="checkbox"/> Storage	<input type="checkbox"/> Pool Ext.	<input checked="" type="checkbox"/> Air Rotary	<input checked="" type="checkbox"/> Air Rotary	
<input type="checkbox"/> OWO	<input type="checkbox"/> Disposal	<input type="checkbox"/> Wildcat	<input type="checkbox"/> Cable	<input type="checkbox"/> Cable	
<input type="checkbox"/> Seismic; _____ # of Holes	<input type="checkbox"/> Other				
<input type="checkbox"/> Other					

If OWWO: old well information as follows:
Operator: _____
Well Name: _____
Original Completion Date: _____ Original Total Depth: _____

Directional, Deviated or Horizontal wellbore? Yes No
If Yes, true vertical depth: _____
Bottom Hole Location: _____
KCC DKT #: _____

Spot N/2 East
SW NW NW Sec. 19 Twp. 30 S. R. 18 West
4460 feet from S (circle one) Line of Section
4930 feet from E (circle one) Line of Section
Is SECTION Regular Irregular?
(Note: Locate well on the Section Plat on reverse side)
County: Neosho
Lease Name: Ron Stafford Well #: 2
Field Name: Morehead
Is this a Prorated / Spaced Field? Yes No
Target Formation(s): Mississippi
Nearest Lease or unit boundary: 350
Ground Surface Elevation: 960 feet MST
Water well within one-quarter mile: Yes No
Public water supply well within one mile: Yes No
Depth to bottom of fresh water: 150+
Depth to bottom of usable water: 300+
Surface Pipe by Alternate: 1 2
Length of Surface Pipe Planned to be set: 20'
Length of Conductor Pipe required: none
Projected Total Depth: 1200
Formation at Total Depth: Mississippi
Water Source for Drilling Operations:
Well _____ Farm Pond _____ Other none Air drilled
DWR Permit #: _____
(Note: Apply for Permit with DWR)
Will Cores be taken? Yes No
If Yes, proposed zone: _____

AFFIDAVIT

The undersigned hereby affirms that the drilling, completion and eventual plugging of this well will comply with K.S.A. 55-101, et. seq.
It is agreed that the following minimum requirements will be met:

1. Notify the appropriate district office *prior* to spudding of well;
2. A copy of the approved notice of intent to drill *shall be* posted on each drilling rig;
3. The minimum amount of surface pipe as specified below *shall be set* by circulating cement to the top; in all cases surface pipe *shall be set* through all unconsolidated materials plus a minimum of 20 feet into the underlying formation.
4. If the well is dry hole, an agreement between the operator and the district office on plug length and placement is necessary *prior to plugging*;
5. The appropriate district office will be notified before well is either plugged or production casing is cemented in;
6. If an ALTERNATE II COMPLETION, production pipe shall be cemented from below any usable water to surface within **120 days** of spud date. *In all cases, NOTIFY district office* prior to any cementing.

I hereby certify that the statements made herein are true and to the best of my knowledge and belief.

Date: 12/09/04 Signature of Operator or Agent: J.L. Ballard Title: Agent

RECEIVED
DEC 13 2004
KCC WICHITA

For KCC Use ONLY
API # 15 - 133-26278 00 00
Conductor pipe required None feet
Minimum surface pipe required 20 feet per Alt. 20
Approved by: RJPI-12-2005
This authorization expires: 7-13-2005
(This authorization void if drilling not started within 6 months of effective date.)
Spud date: _____ Agent: _____

- Remember to:
- File Drill Pit Application (form CDP-1) with Intent to Drill;
 - File Completion Form ACO-1 within 120 days of spud date;
 - File acreage attribution plat according to field proration orders;
 - Notify appropriate district office 48 hours prior to workover or re-entry;
 - Submit plugging report (CP-4) after plugging is completed;
 - Obtain written approval before disposing or injecting salt water.

19
30
183

IN ALL CASES PLOT THE INTENDED WELL ON THE PLAT BELOW

Plat of acreage attributable to a well in a prorated or spaced field

If the intended well is in a prorated or spaced field, please fully complete this side of the form. If the intended well is in a prorated or spaced field complete the plat below showing that the well will be properly located in relationship to other wells producing from the common source of supply. Please show all the wells and within 1 mile of the boundaries of the proposed acreage attribution unit for gas wells and within 1/2 mile of the boundaries of the proposed acreage attribution unit for oil wells.

API No. 15 - 133-26278-0000
 Operator: _____
 Lease: _____
 Well Number: _____
 Field: _____
 Number of Acres attributable to well: _____
 QTR / QTR / QTR of acreage: _____

Location of Well: County: _____
 _____ feet from S / N (circle one) Line of Section
 _____ feet from E / W (circle one) Line of Section
 Sec. _____ Twp. _____ S. R. _____ East West
 Is Section _____ Regular or _____ Irregular
 If Section Is Irregular, locate well from nearest corner boundary.
 Section corner used: ___NE ___NW ___SE ___SW

PLAT

*(Show location of the well and shade attributable acreage for prorated or spaced wells.)
 (Show footage to the nearest lease or unit boundary line.)*

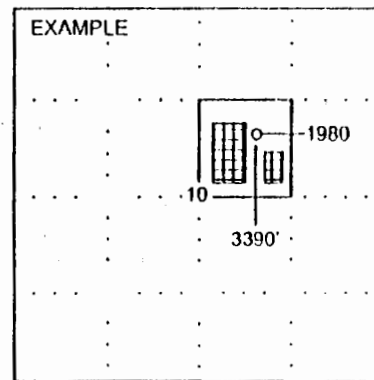
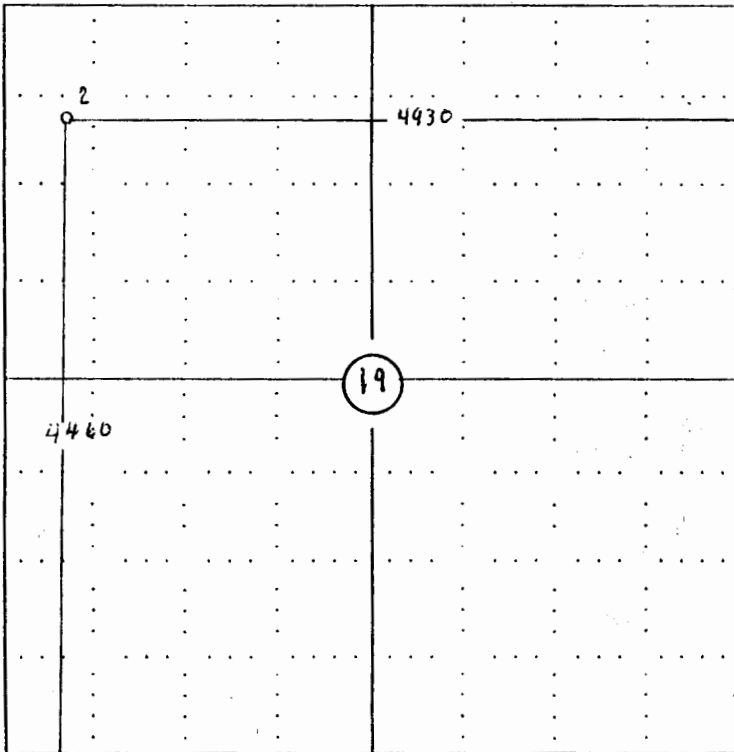

NOTE: In all cases locate the spot of the proposed drilling location.

In plotting the proposed location of the well, you must show:

1. The manner in which you are using the depicted plat by identifying section lines, i.e. 1 section, 1 section with 8 surrounding sections, 4 sections, etc.
2. The distance of the proposed drilling location from the section's south / north and east / west.
3. The distance to the nearest lease or unit boundary line.
4. If proposed location is located within a prorated or spaced field a certificate of acreage attribution plat must be attached: (CO-7 for oil wells; CG-8 for gas wells).