

FOR KCC USE:

FORM C-1 7/91

FORM MUST BE TYPED

FORM MUST BE SIGNED

ALL BLANKS MUST BE FILLED

EFFECTIVE DATE: 3-31-91  
DISTRICT # 4  
SGA? ... Yes  No

State of Kansas  
NOTICE OF INTENTION TO DRILL

Must be approved by the K.C.C. five (5) days prior to commencing well

Expected Spud Date 4 3 92  
month day year

Spot NW NW NE Sec 33 Twp 5S S, Rg 22W East West

OPERATOR: License # 4767  
Name: Ritchie Exploration, Inc.  
Address: 125 N. Market, Suite 1000  
City/State/Zip: Wichita, Kansas 67202  
Contact Person: Jeff Christian  
Phone: (316) 267-4375

330' feet from South North line of Section  
2310' feet from East / West line of Section  
IS SECTION  REGULAR  IRREGULAR?

CONTRACTOR: License #: 30606  
Name: Murfin Drilling Company

(NOTE: Locate well on the Section Plat on Reverse Side)  
County: Norton  
Lease Name: Minks Well #: 1  
Field Name: unknown  
Is this a Prorated/Spaced Field? ... yes  no  
Target Formation(s): Lansing/Kansas City  
Nearest lease or unit boundary: 330'  
Ground Surface Elevation: 2344' feet MSL  
Water well within one-quarter mile: ... yes  no  
Public water supply well within one mile: ... yes  no  
Depth to bottom of fresh water: 120'  
Depth to bottom of usable water: 1130'  
Surface Pipe by Alternate: ... 1  2  
Length of Surface Pipe Planned to be set: 240'  
Length of Conductor pipe required: none  
Projected Total Depth: 3900'  
Formation at Total Depth: Arbuckle  
Water Source for Drilling Operations:  
... well ... farm pond  other

Well Drilled For: Well Class: Type Equipment:  
 Oil ... Enh Rec ... Infield  Mud Rotary  
... Gas ... Storage  Pool Ext. ... Air Rotary  
... OWWO ... Disposal ... Wildcat ... Cable  
... Seismic; ... # of Holes ... Other

If OWWO: old well information as follows:  
Operator: \_\_\_\_\_  
Well Name: \_\_\_\_\_  
Comp. Date: \_\_\_\_\_ Old Total Depth \_\_\_\_\_

Directional, Deviated or Horizontal wellbore? ... yes  no  
If yes, true vertical depth: \_\_\_\_\_  
Bottom Hole Location: \_\_\_\_\_

AFFIDAVIT

The undersigned hereby affirms that the drilling, completion and eventual plugging of this well will comply with K.S.A. 55-101, et. seq.  
It is agreed that the following minimum requirements will be met:

- 1. Notify the appropriate district office prior to spudding of well;
- 2. A copy of the approved notice of intent to drill shall be posted on each drilling rig;
- 3. The minimum amount of surface pipe as specified below shall be set by circulating cement to the top; in all cases surface pipe shall be set through all unconsolidated materials plus a minimum of 20 feet into the underlying formation;
- 4. If the well is dry hole, an agreement between the operator and the district office on plug length and placement is necessary prior to plugging;
- 5. The appropriate district office will be notified before well is either plugged or production casing is cemented in;
- 6. IF AN ALTERNATE II COMPLETION, PRODUCTION PIPE SHALL BE CEMENTED FROM BELOW ANY USABLE WATER TO SURFACE WITHIN 120 DAYS OF SPUD DATE. IN ALL CASES, NOTIFY DISTRICT OFFICE PRIOR TO ANY CEMENTING.

I hereby certify that the statements made herein are true and to the best of my knowledge and belief.  
Date: 3-2-92 Signature of Operator or Agent: Kevin J. Kasha Title: Geologist



FOR KCC USE:  
API # 15- 137-20781-00-00  
Conductor pipe required None feet  
Minimum surface pipe required 240 feet per Alt. ● ②  
Approved by: MW 3-26-92  
This authorization expires: 9-26-92  
(This authorization void if drilling not started within 6 months of effective date.)  
Spud date: \_\_\_\_\_ Agent: \_\_\_\_\_

RECEIVED  
KANSAS CORPORATION COMMISSION  
MAR 25 1992  
CONSERVATION DIVISION  
WICHITA, KS

- REMEMBER TO:
- File Drill Pit Application (form CDP-1) with Intent to Drill;
  - File Completion Form ACO-1 within 120 days of spud date;
  - File acreage attribution plat according to field proration orders;
  - Notify appropriate district office 48 hours prior to workover or re-entry;
  - Submit plugging report (CP-4) after plugging is completed;
  - Obtain written approval before disposing or injecting salt water.

Mail to: Conservation Division, 200 Colorado Derby Building, 202 W. First St., Wichita, Kansas 67202-1286.

2200

IN ALL CASES PLOT THE INTENDED WELL ON THE PLAT BELOW

PLAT OF ACREAGE ATTRIBUTABLE TO A WELL IN A PRORATED OR SPACED FIELD

If the intended well is in a prorated or spaced field, please fully complete this side of the form. If the intended well is in a prorated or spaced field complete the plat below showing that the well will be properly located in relationship to other wells producing from the common source of supply. Please show all the wells within 1 mile of the boundaries of the proposed acreage attribution unit for gas wells and within 1/2 mile of the boundaries of the proposed acreage attribution unit for oil wells.

API NO. 15- \_\_\_\_\_  
 OPERATOR Ritchie Exploration, Inc. LOCATION OF WELL: COUNTY Norton  
 LEASE Minks \_\_\_\_\_ 330 feet from south/north line of section  
 WELL NUMBER 1 \_\_\_\_\_ 2310 feet from east/west line of section  
 FIELD unknown \_\_\_\_\_ SECTION 33 TWP 5S RG 22W

NUMBER OF ACRES ATTRIBUTABLE TO WELL 10 IS SECTION X REGULAR or \_\_\_\_\_ IRREGULAR  
 QTR/QTR/QTR OF ACREAGE NW - NW - NE IF SECTION IS IRREGULAR, LOCATE WELL FROM NEAREST CORNER BOUNDARY.

Section corner used: \_\_\_\_\_ NE \_\_\_\_\_ NW \_\_\_\_\_ SE \_\_\_\_\_ SW

**PLAT**

(Show location of the well and shade attributable acreage for prorated or spaced wells.)  
 (Show footage to the nearest lease or unit boundary line.)

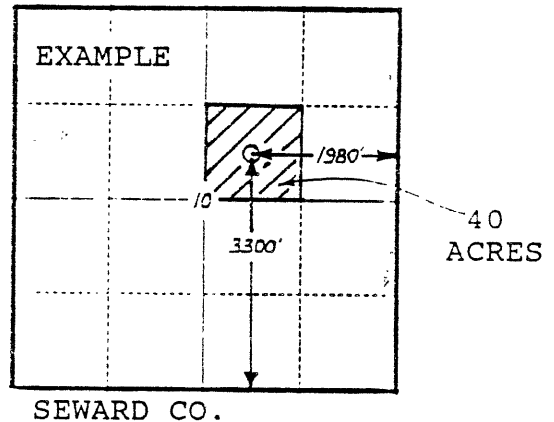
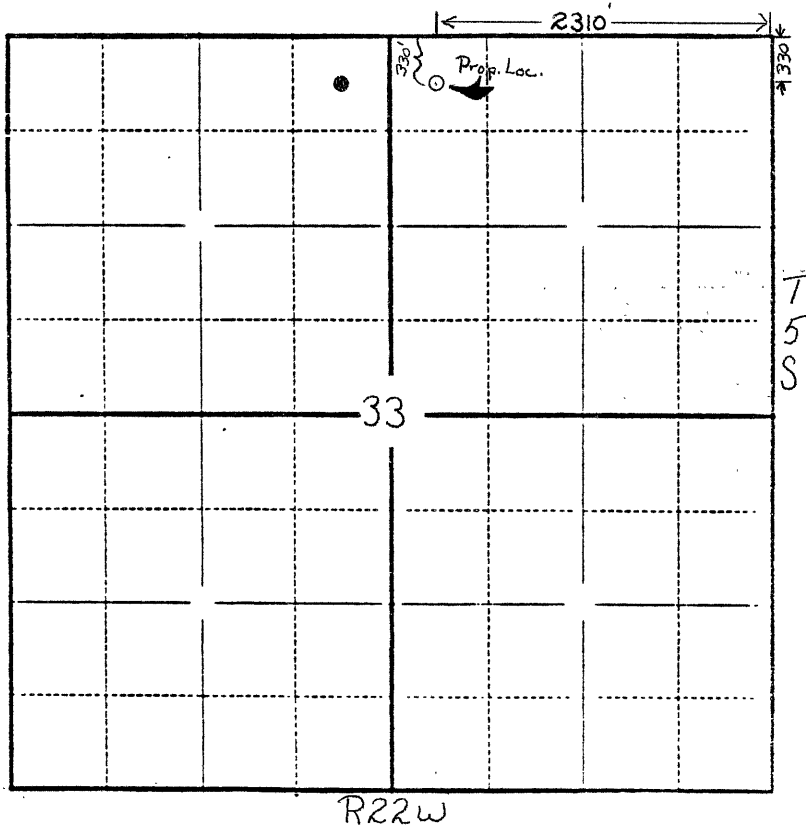

In plotting the proposed location of the well, you must show:

- 1) The manner in which you are using the depicted plat by identifying section lines, i.e. 1 section, 1 section with 8 surrounding sections, 4 sections, etc.;
- 2) the distance of the proposed drilling location from the section's south/north and east/west lines; and
- 3) the distance to the nearest lease or unit boundary line.

