

For KCC Use:
Effective Date: 1-29-2005
District # _____
SGA? Yes No

KANSAS CORPORATION COMMISSION
OIL & GAS CONSERVATION DIVISION

Form C-1
December 2002
Form must be Typed
Form must be Signed
All blanks must be Filled

NOTICE OF INTENT TO DRILL

Must be approved by KCC five (5) days prior to commencing well

Expected Spud Date 02 1 2005
month day year

Spot AP 40'S & 110'E 05
W/2 SE - NW Sec. 11 Twp. 35 S. R. 30
 East
 West
2020 feet from N / S Line of Section
1,770 feet from E / W Line of Section
Is SECTION Regular Irregular?

OPERATOR: License# 3911 (8-30-2005)
Name: Rama Operating Co., Inc.
Address: P.O. Box 159
City/State/Zip: Stafford, KS. 67578
Contact Person: Robin Austin
Phone: (620) 234-5191

(Note: Locate well on the Section Plat on reverse side)
County: Meade
Lease Name: Adams Well #: 8-11
Field Name: Adams Ranch West

CONTRACTOR: License# 5142 (6-30-2005)
Name: Sterling Drilling Co., Inc

Is this a Prorated / Spaced Field? Yes No
Target Information(s): Chase group & Toronto
Nearest Lease or unit boundary: 510

Well Drilled For: Well Class: Type Equipment
 Oil Enh Rec Infield Mud Rotary
 Gas Storage Pool Ext. Air Rotary
 OWWO Disposal Wildcat Cable
 Seismic; # of Holes Other
 Other

Ground Surface Elevation: 2426 feet MSL
Water well within one-quarter mile: Yes No
Public water supply well within one mile: Yes No
Depth to bottom of fresh water: 400
Depth to bottom of usable water: unconsolidated + 20 600

If OWWO: old well information as follows:
Operator: _____
Well Name: _____
Original Completion Date: _____ Original Total Depth: _____

Surface Pipe by Alternate: 1 2
Length of Surface Pipe Planned to be set: 1465
Length of Conductor Pipe required: 40
Projected Total Depth: 4,300

Directional, Deviated or Horizontal wellbore? Yes No
If Yes, true vertical depth: _____
Bottom Hole Location: _____
KCC DKT #: _____

Formation at Total Depth: Toronto
Water Source for Drilling Operations:
 Well Farm Pond Other
DWR Permit #: _____

(Note: Apply for Permit with DWR)
Will Cores be taken? Yes No
If Yes, proposed zone: _____

AFFIDAVIT

The undersigned hereby affirms that the drilling, completion and eventual plugging of this well will comply with K.S.A. 55 et. seq. JAN 14 2005
It is agreed that the following minimum requirements will be met:

KCC WICHITA

1. Notify the appropriate district office **prior** to spudding of well;
2. A copy of the approved notice of intent to drill **shall be** posted on each drilling rig;
3. The minimum amount of surface pipe as specified below **shall be set** by circulating cement to the top; in all cases surface pipe **shall be set** through all unconsolidated materials plus a minimum of 20 feet into the underlying formation.
4. If the well is dry hole, an agreement between the operator and the district office on plug length and placement is necessary **prior to plugging**;
5. The appropriate district office will be notified before well is either plugged or production casing is cemented in;
6. If an ALTERNATE II COMPLETION, production pipe shall be cemented from below any usable water to surface within **120 days** of spud date.
Or pursuant to Appendix "B" - Eastern Kansas surface casing order #133,891-C, which applies to the KCC District 3 area, alternate II cementing must be completed within 30 days of the spud date or the well shall be plugged. **In all cases, NOTIFY district office** prior to any cementing.

I hereby certify that the statements made herein are true and to the best of my knowledge and belief.
Date: 1-12-2005 Signature of Operator or Agent: [Signature] Title: Vice-president

For KCC Use ONLY
API # 15 - 119-21145-00-06
Conductor pipe required NONE feet
Minimum surface pipe required 620 feet per Alt. (1)
Approved by: RJP 1-24-2005
This authorization expires: 7-24-2005
(This authorization void if drilling not started within 6 months of effective date.)
Spud date: _____ Agent: _____

Remember to:
- File Drill Pit Application (form CDP-1) with Intent to Drill;
- File Completion Form ACO-1 within 120 days of spud date;
- File acreage attribution plat according to field proration orders;
- Notify appropriate district office 48 hours prior to workover or re-entry;
- Submit plugging report (CP-4) after plugging is completed;
- Obtain written approval before disposing or injecting salt water.
- If this permit has expired (See: authorized expiration date) please check the box below and return to the address below.
 Well Not Drilled - Permit Expired
Signature of Operator or Agent: _____
Date: _____

11
35
30W

IN ALL CASES PLOT THE INTENDED WELL ON THE PLAT BELOW

Plat of acreage attributable to a well in a prorated or spaced field

If the intended well is in a prorated or spaced field, please fully complete this side of the form. If the intended well is in a prorated or spaced field complete the plat below showing that the well will be properly located in relationship to other wells producing from the common source of supply. Please show all the wells and within 1 mile of the boundaries of the proposed acreage attribution unit for gas wells and within 1/2 mile of the boundaries of the proposed acreage attribution unit for oil wells.

API No. 15 - _____
 Operator: Rama Operating Co., Inc.
 Lease: Adams
 Well Number: 8-11
 Field: Adams Ranch West
 Number of Acres attributable to well: 160
 QTR / QTR / QTR of acreage: 150 S - Se - Nw

Location of Well: County: Meade
2020 feet from N / S Line of Section
1,770 feet from E / W Line of Section
 Sec. 11 Twp. 35 S. R. 30 East West

Is Section: Regular or Irregular

If Section is Irregular, locate well from nearest corner boundary.
 Section corner used: NE NW SE SW

PLAT

*(Show location of the well and shade attributable acreage for prorated or spaced wells.)
 (Show footage to the nearest lease or unit boundary line.)*

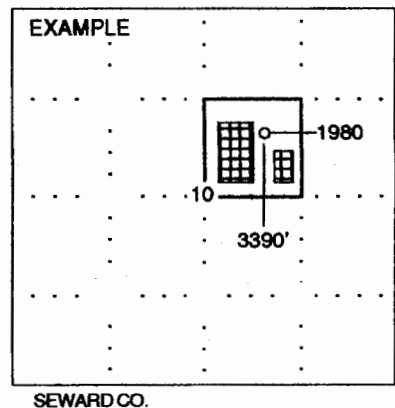
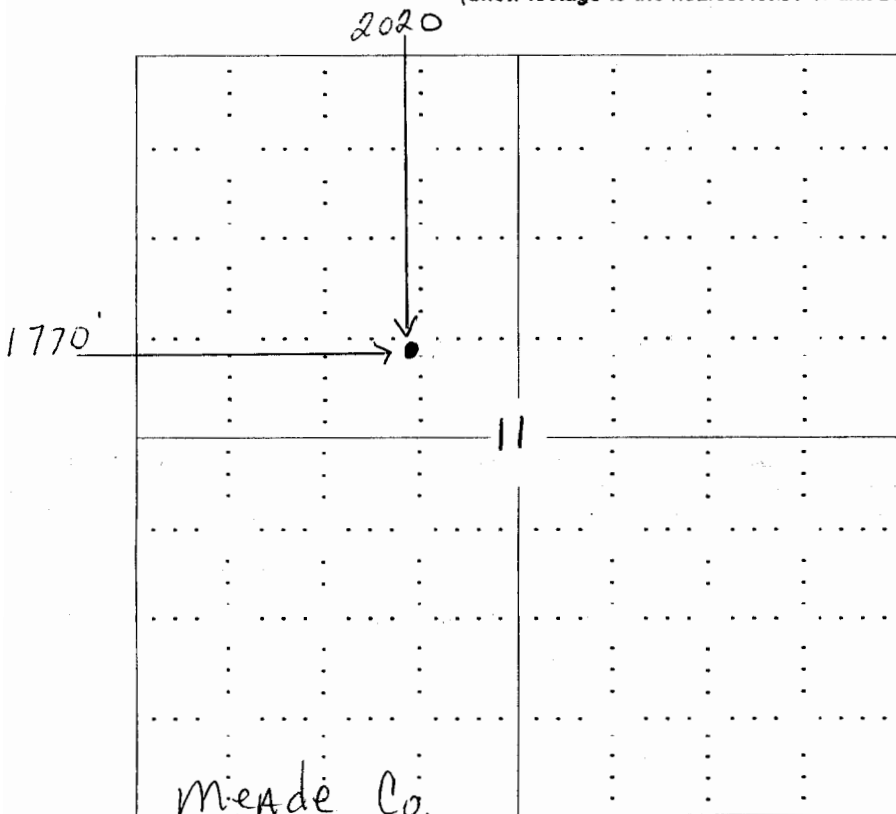

NOTE: In all cases locate the spot of the proposed drilling locaton.

In plotting the proposed location of the well, you must show:

1. The manner in which you are using the depicted plat by identifying section lines, i.e. 1 section, 1 section with 8 surrounding sections, 4 sections, etc.
2. The distance of the proposed drilling location from the section's south / north and east / west.
3. The distance to the nearest lease or unit boundary line.
4. If proposed location is located within a prorated or spaced field a certificate of acreage attribution plat must be attached: (CO-7 for oil wells;

KANSAS

CORPORATION COMMISSION

KATHLEEN SEBELIUS, GOVERNOR

BRIAN J. MOLINE, CHAIR

ROBERT E. KREHBIEL, COMMISSIONER

MICHAEL C. MOFFET, COMMISSIONER

January 24, 2005

Robin Austin
Rama Operating Co., Inc.
PO Box 159
Stafford, KS 67578

RE: Drilling Pit Application
Adams Lease Well No. 8-11
NW/4 Sec. 11-35S-30W
Meade County, Kansas

Dear Mr. Austin:

District staff has inspected the above referenced location and has determined that the reserve pit shall be constructed **without slots**, the bottom shall be flat and reasonably level, and the free fluids must be removed. The fluids are to be removed from the reserve pit as soon as the Hutchinson Salt section has been drilled through and displacement of the fluids into the reserve pit has occurred. The fluids should be removed again as soon as practical after drilling operations have ceased.

If production casing is set all completion fluids shall be removed on a daily basis.

The fluids should be taken to an authorized disposal well. Please call the District Office at (620) 225-8888 when the fluids have been removed. Also please file the enclosed CDP-5 form, Surface Pond Waste Transfer, within 30 days of fluid removal.

A copy of this letter should be posted in the doghouse along with the approved Intent to Drill.

If you have any questions or concerns please feel free to contact the undersigned at the above address.

Sincerely,

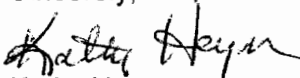

Kathy Haynes

Environmental Protection and Remediation Department

cc: S Durrant