

For KCC Use:
 Effective Date: 1-23-2005
 District # 1
 SGA? Yes No

KANSAS CORPORATION COMMISSION
 OIL & GAS CONSERVATION DIVISION

Form C-1
 December 2002
Form must be Typed
Form must be Signed
All blanks must be Filled

NOTICE OF INTENT TO DRILL

Must be approved by KCC five (5) days prior to commencing well

Expected Spud Date February 2 2005
month day year

Spot 120' W of East
 E/2 - W/2 - SE Sec. 17 Twp. 22 S. R. 13 West
1320 feet from N / S Line of Section
1770 feet from E / W Line of Section

OPERATOR: License# 30742 (6-30-05)
 Name: Palomino Petroleum, Inc.
 Address: 4924 SE 84th St.
 City/State/Zip: Newton, Kansas 67114-8827
 Contact Person: Klee R. Watchous
 Phone: (316) 799-1000

Is SECTION Regular Irregular?
 (Note: Locate well on the Section Plat on reverse side)

CONTRACTOR: License# 5123 (6-30-05)
 Name: Pickrell Drilling Company, Inc.

County: Stafford
 Lease Name: Golden Belt Feeders Well #: 1
 Field Name: None (Wildcat)

Well Drilled For: Well Class: Type Equipment:
 Oil Enh Rec Infield Mud Rotary
 Gas Storage Pool Ext. Air Rotary
 OWO Disposal Wildcat Cable
 Seismic; # of Holes Other
 Other

Is this a Prorated / Spaced Field? Yes No
 Target Formation(s): LKC, Arbuckle
 Nearest Lease or unit boundary: 870
 Ground Surface Elevation: 1904 feet MSL
 Water well within one-quarter mile: Yes No
 Public water supply well within one mile: Yes No

If OWWO: old well information as follows:
 Operator: _____
 Well Name: _____
 Original Completion Date: _____ Original Total Depth: _____

Depth to bottom of fresh water: ~~200~~ 240
 Depth to bottom of usable water: ~~240~~ 280
 Surface Pipe by Alternate: 1 2
 Length of Surface Pipe Planned to be set: ~~2000~~ 300' MIN
 Length of Conductor Pipe required: None
 Projected Total Depth: 3850
 Formation at Total Depth: Arbuckle

Directional, Deviated or Horizontal wellbore? Yes No
 If Yes, true vertical depth: _____
 Bottom Hole Location: _____
 KCC DKT #: _____

Water Source for Drilling Operations:
 Well Farm Pond Other
 DWR Permit #: Contractor will apply

(Note: Apply for Permit with DWR)
 Will Cores be taken? Yes No
 If Yes, proposed zone: _____

AFFIDAVIT

The undersigned hereby affirms that the drilling, completion and eventual plugging of this well will comply with K.S.A. 55 et. seq.
 It is agreed that the following minimum requirements will be met:

1. Notify the appropriate district office **prior** to spudding of well;
2. A copy of the approved notice of intent to drill **shall be** posted on each drilling rig;
3. The minimum amount of surface pipe as specified below **shall be set** by circulating cement to the top; in all cases surface pipe **shall be set** through all unconsolidated materials plus a minimum of 20 feet into the underlying formation.
4. If the well is dry hole, an agreement between the operator and the district office on plug length and placement is necessary **prior to plugging**;
5. The appropriate district office will be notified before well is either plugged or production casing is cemented in;
6. If an ALTERNATE II COMPLETION, production pipe shall be cemented from below any usable water to surface within **120 days** of spud date.
 Or pursuant to Appendix "B" - Eastern Kansas surface casing order #133,891-C, which applies to the KCC District 3 area, alternate II cementing must be completed within 30 days of the spud date or the well shall be plugged. **In all cases, NOTIFY district office** prior to any cementing.

I hereby certify that the statements made herein are true and to the best of my knowledge and belief.

Date: January 13, 2005 Signature of Operator or Agent: Klee R. Watchous Title: President

For KCC Use ONLY
 API # 15 - 185-23292-00-00
 Conductor pipe required NONE feet
 Minimum surface pipe required 300 feet per Alt. 1
 Approved by: RJP-18-2005
 This authorization expires: 7-18-2005
 (This authorization void if drilling not started within 6 months of effective date.)
 Spud date: _____ Agent: _____

Remember to:

- File Drill Pit Application (form CDP-1) with Intent to Drill;
- File Completion Form ACO-1 within 120 days of spud date;
- File acreage attribution plat according to field proration orders;
- Notify appropriate district office 48 hours prior to workover or re-entry;
- Submit plugging report (CP-4) after plugging is completed;
- Obtain written approval before disposing or injecting salt water.
- If this permit has expired (See: authorized expiration date) please check the box below and return to the address below.

Well Not Drilled - Permit Expired
 Signature of Operator or Agent: _____
 Date: _____

Mail to: KCC - Conservation Division, 130 S. Market - Room 2078, Wichita, Kansas 67202

17
22
13w

IN ALL CASES PLOT THE INTENDED WELL ON THE PLAT BELOW

Plat of acreage attributable to a well in a prorated or spaced field

If the intended well is in a prorated or spaced field, please fully complete this side of the form. If the intended well is in a prorated or spaced field complete the plat below showing that the well will be properly located in relationship to other wells producing from the common source of supply. Please show all the wells and within 1 mile of the boundaries of the proposed acreage attribution unit for gas wells and within 1/2 mile of the boundaries of the proposed acreage attribution unit for oil wells.

API No. 15 - 185-23292-00-00
 Operator: Palomino Petroleum, Inc.
 Lease: Golden Belt Feeders
 Well Number: 1
 Field: None (Wildcat)
 Number of Acres attributable to well: _____
 QTR / QTR / QTR of acreage: E/2 - W/2 - SE

Location of Well: County: Stafford
1320 feet from N / S Line of Section
1770 feet from E / W Line of Section
 Sec. 17 Twp. 22 S. R. 13 East West
 Is Section: Regular or Irregular
If Section is Irregular, locate well from nearest corner boundary.
 Section corner used: NE NW SE SW

PLAT

*(Show location of the well and shade attributable acreage for prorated or spaced wells.)
 (Show footage to the nearest lease or unit boundary line.)*

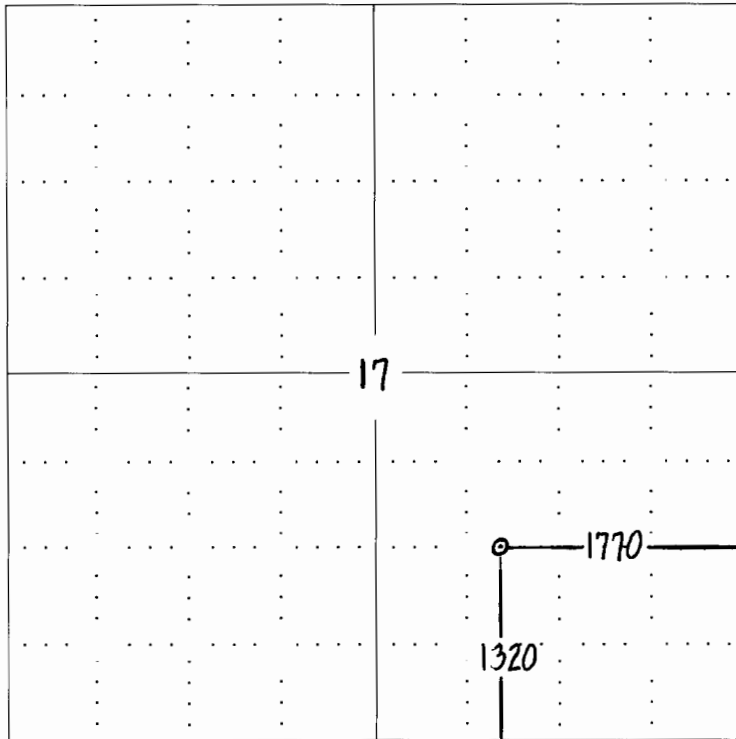

**RECEIVED
 JAN 14 2005
 KCC WICHITA**

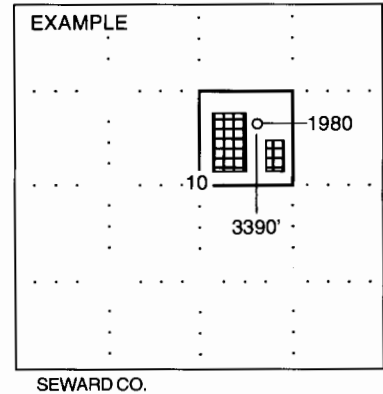

**NOTE: In all cases locate the spot of the proposed drilling location.
 Stafford Co.**

In plotting the proposed location of the well, you must show:

1. The manner in which you are using the depicted plat by identifying section lines, i.e. 1 section, 1 section with 8 surrounding sections, 4 sections, etc.
2. The distance of the proposed drilling location from the section's south / north and east / west.
3. The distance to the nearest lease or unit boundary line.
4. If proposed location is located within a prorated or spaced field a certificate of acreage attribution plat must be attached: (CO-7 for oil wells; CG-8 for gas wells).

KANSAS

CORPORATION COMMISSION

KATHLEEN SEBELIUS, GOVERNOR
BRIAN J. MOLINE, CHAIR
ROBERT E. KREHBIEL, COMMISSIONER
MICHAEL C. MOFFET, COMMISSIONER

January 14, 2005

Mr. Klee R. Watchous
Palomino Petroleum, Inc.
4924 SE 84th St.
Newton, KS 67114-8827

RE: Drilling Pit Application
Golden Belt Feeders Lease Well No. 1
SE/4 Sec. 17-22S-13W
Stafford County, Kansas

Dear Mr. Watchous:

This office has been informed that steel pits are to be used at this location. Please inform the Commission in writing as to which disposal well you will utilize to dispose of the contents in the steel pits and the amount of fluid which will be disposed.

Should a haul-off pit be necessary, please complete the enclosed CDP-1. This location will have to be inspected prior to approval of the haul-off pit application.

Sincerely,

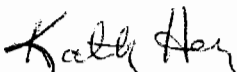

Kathy Haynes
Environmental Protection and Remediation Department

cc: S Durrant