

For KCC Use: 2.2-05  
Effective Date: \_\_\_\_\_  
District # 1  
SGA?  Yes  No

KANSAS CORPORATION COMMISSION  
OIL & GAS CONSERVATION DIVISION  
**NOTICE OF INTENT TO DRILL**

Form C-1  
December 2002  
**Form must be Typed**  
**Form must be Signed**  
**All blanks must be Filled**

Must be approved by KCC five (5) days prior to commencing well

Expected Spud Date February 10, 2005  
month day year

Spot AP E/2 NE SW NE Sec. 12 Twp. 22 S. R. 12  East  West

OPERATOR: License# 32,432 (2.28.05)  
Name: La Veta Oil & Gas, LLC  
Address: P.O. Box 780  
City/State/Zip: Middleburg, VA 20118  
Contact Person: Benny C. Griffin  
Phone: 620-458-9222

1610 feet from  N /  S Line of Section  
1400 feet from  E /  W Line of Section  
Is SECTION  Regular  Irregular?

CONTRACTOR: License# 5822 (6.30.05)  
Name: Val Energy

(Note: Locate well on the Section Plat on reverse side)

County: Stafford  
Lease Name: Hammeke Well #: 1  
Field Name: Maxville MAX

Is this a Prorated / Spaced Field?  Yes  No  
Target Formation(s): Arbuckle  
Nearest Lease or unit boundary: 1400' East

Well Drilled For:  Oil  Gas  OWD  Seismic; # of Holes  Other  
 Enh Rec  Storage  Disposal  
Well Class:  Infield  Pool Ext.  Wildcat  Other  
Type Equipment:  Mud Rotary  Air Rotary  Cable

Ground Surface Elevation: 1795 feet MSL  
Water well within one-quarter mile:  Yes  No  
Public water supply well within one mile:  Yes  No

Depth to bottom of fresh water: 52' 150  
Depth to bottom of usable water: 52' 180  
Surface Pipe by Alternate:  1  2

If OWWO: old well information as follows:  
Operator: \_\_\_\_\_  
Well Name: \_\_\_\_\_  
Original Completion Date: \_\_\_\_\_ Original Total Depth: \_\_\_\_\_

Length of Surface Pipe Planned to be set: 325'  
Length of Conductor Pipe required: NONE RECEIVED  
Projected Total Depth: 3150

Directional, Deviated or Horizontal wellbore?  Yes  No

Formation at Total Depth: Arbuckle JAN 26 2005

If Yes, true vertical depth: \_\_\_\_\_

Water Source for Drilling Operations:  Well  Farm Pond  Other KCC WICHITA

Bottom Hole Location: \_\_\_\_\_

DWR Permit #: \_\_\_\_\_

KCC DKT #: \_\_\_\_\_

(Note: Apply for Permit with DWR )  
Will Cores be taken?  Yes  No

If Yes, proposed zone: \_\_\_\_\_

**AFFIDAVIT**

The undersigned hereby affirms that the drilling, completion and eventual plugging of this well will comply with K.S.A. 55 et. seq.  
It is agreed that the following minimum requirements will be met:

1. Notify the appropriate district office **prior** to spudding of well;
2. A copy of the approved notice of intent to drill **shall be** posted on each drilling rig;
3. The minimum amount of surface pipe as specified below **shall be set** by circulating cement to the top; in all cases surface pipe **shall be set** through all unconsolidated materials plus a minimum of 20 feet into the underlying formation.
4. If the well is dry hole, an agreement between the operator and the district office on plug length and placement is necessary **prior to plugging**;
5. The appropriate district office will be notified before well is either plugged or production casing is cemented in;
6. If an ALTERNATE II COMPLETION, production pipe shall be cemented from below any usable water to surface within **120 days** of spud date.  
Or pursuant to Appendix "B" - Eastern Kansas surface casing order #133,891-C, which applies to the KCC District 3 area, alternate ii cementing must be completed within 30 days of the spud date or the well shall be plugged. **In all cases, NOTIFY district office** prior to any cementing.

I hereby certify that the statements made herein are true and to the best of my knowledge and belief.

Date: 1/25/05 Signature of Operator or Agent: [Signature] Title: Agent

**For KCC Use ONLY**  
API # 15 - 185-23297-0000  
Conductor pipe required NONE feet  
Minimum surface pipe required 200 feet per Alt. 1  
Approved by RJP 1-28.05  
This authorization expires: 7.28.05  
(This authorization void if drilling not started within 6 months of effective date.)  
Spud date: \_\_\_\_\_ Agent: \_\_\_\_\_

**Remember to:**

- File Drill Pit Application (form CDP-1) with Intent to Drill;
- File Completion Form ACO-1 within 120 days of spud date;
- File acreage attribution plat according to field proration orders;
- Notify appropriate district office 48 hours prior to workover or re-entry;
- Submit plugging report (CP-4) after plugging is completed;
- Obtain written approval before disposing or injecting salt water.
- If this permit has expired (See: authorized expiration date) please check the box below and return to the address below.

Well Not Drilled - Permit Expired  
Signature of Operator or Agent: \_\_\_\_\_  
Date: \_\_\_\_\_

Mail to: KCC - Conservation Division, 130 S. Market - Room 2078, Wichita, Kansas 67202

12  
22  
12W

**IN ALL CASES PLOT THE INTENDED WELL ON THE PLAT BELOW**

*Plat of acreage attributable to a well in a prorated or spaced field*

**If the intended well is in a prorated or spaced field, please fully complete this side of the form.** If the intended well is in a prorated or spaced field complete the plat below showing that the well will be properly located in relationship to other wells producing from the common source of supply. Please show all the wells and within 1 mile of the boundaries of the proposed acreage attribution unit for gas wells and within 1/2 mile of the boundaries of the proposed acreage attribution unit for oil wells.

API No. 15 - \_\_\_\_\_  
 Operator: La Veta Oil & Gas, LLC  
 Lease: Hammeke  
 Well Number: 1  
 Field: Maxville

Location of Well: County: Stafford  
1610 feet from  N /  S Line of Section  
1400 feet from  E /  W Line of Section  
 Sec. 12 Twp. 22 S. R. 12  East  West

Number of Acres attributable to well: \_\_\_\_\_  
 QTR / QTR / QTR of acreage: NE - SW - NE

Is Section:  Regular or  Irregular

**If Section is Irregular, locate well from nearest corner boundary.**  
 Section corner used:  NE  NW  SE  SW

**PLAT**

*(Show location of the well and shade attributable acreage for prorated or spaced wells.)  
 (Show footage to the nearest lease or unit boundary line.)*

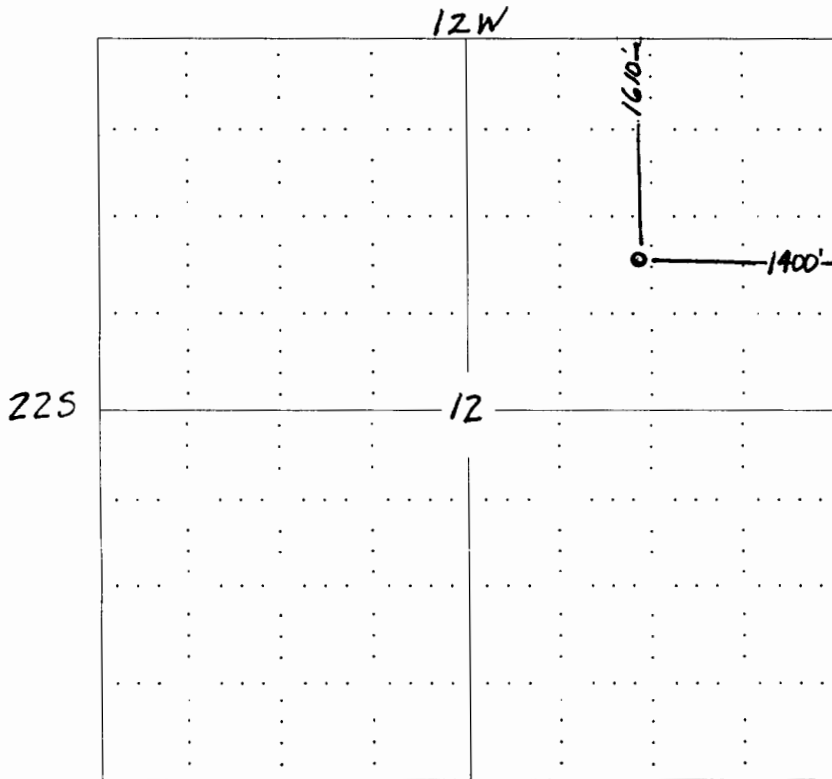

RECEIVED  
 JAN 26 2005  
 KCC WICHITA

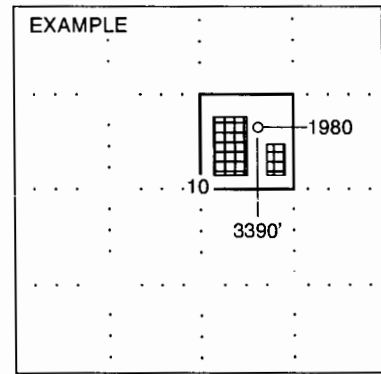

SEWARD CO.

**NOTE: In all cases locate the spot of the proposed drilling locaton.**

**In plotting the proposed location of the well, you must show:**

1. The manner in which you are using the depicted plat by identifying section lines, i.e. 1 section, 1 section with 8 surrounding sections, 4 sections, etc.
2. The distance of the proposed drilling location from the section's south / north and east / west.
3. The distance to the nearest lease or unit boundary line.
4. If proposed location is located within a prorated or spaced field a certificate of acreage attribution plat must be attached: (C0-7 for oil wells; CG-8 for gas wells).

# KANSAS

CORPORATION COMMISSION

KATHLEEN SEBELIUS, GOVERNOR  
BRIAN J. MOLINE, CHAIR  
ROBERT E. KREHBIEL, COMMISSIONER  
MICHAEL C. MOFFET, COMMISSIONER

January 28, 2005

Mr. Benny C. Griffin  
La Veta Oil & Gas LLC  
PO Box 780  
Middleburg, VA 20118

Re: Drilling Pit Application  
Hammeke Lease Well No. 1  
NE/4 Sec. 12-22S-12W  
Stafford County, Kansas

Dear Mr. Griffin:

District staff has inspected the location and has determined that an unsealed condition will present a pollution threat to water resources.

District staff has instructed that no earthen pits are to be used at the location. Steel pits are to be used. Please inform the Commission in writing as to which disposal well you will utilize to dispose of the contents in the steel pits and the amount of fluid which will be disposed.

**Should a haul-off pit be necessary, please complete the enclosed CDP-1.** This location will have to be inspected prior to approval of the haul-off pit application.

Sincerely,

  
Kathy Haynes  
Environmental Protection and Remediation Department

Cc: S Durrant