

For KCC Use:
Effective Date: 1-29-2005
District # 1
SGA? Yes No

NOTICE OF INTENT TO DRILL

Must be approved by KCC five (5) days prior to commencing well

Expected Spud Date APR 16 2005
month day year

Spot NO NW/4 SE/4 SE/4 Sec 36 Twp 30 S. R. 38W East West

OPERATOR: License # 04824 (2-28-2005)
Name: PIONEER NATURAL RESOURCES USA, INC.
Address: 5205 N. O'CONNOR BLVD. - ROOM 1325
City/State/Zip: IRVING, TEXAS 75039
Contact Person: LINDA KELLY
Phone: 972-969-3946

1250 feet from N / S Line of Section
1250 feet from E / W Line of Section
Is SECTION X Regular Irregular?
(Note: Locate well on Section Plat on Reverse Side)

CONTRACTOR: License #: WILL ADVISE ON ACO-1
Name: Must be Licensed by KCC

County: GRANT
Lease Name: JARVIS Well #: 4-36R
Field Name: HUGOTON

Well Drilled For: Well Class: Type Equipment:

Is this a Prorated/Spaced Field? Yes No
Target Formation(s): CHASE
Nearest Lease or unit boundary: 1250

- | | | | |
|--|-----------------------------------|------------------------------------|--|
| <input type="checkbox"/> Oil | <input type="checkbox"/> Enh Rec | <input type="checkbox"/> Infield | <input checked="" type="checkbox"/> Mud Rotary |
| <input checked="" type="checkbox"/> Gas | <input type="checkbox"/> Storage | <input type="checkbox"/> Pool Ext. | <input type="checkbox"/> Air Rotary |
| <input type="checkbox"/> OWWO | <input type="checkbox"/> Disposal | <input type="checkbox"/> Wildcat | <input type="checkbox"/> Cable |
| <input type="checkbox"/> Seismic; # of Holes | <input type="checkbox"/> Other | | |
| <input checked="" type="checkbox"/> Other <u>REPLACEMENT</u> | | | |

Ground Surface Elevation: 3119 feet MSL
Water well within one-quarter mile: yes no
Public water supply within one mile: yes no

If OWWO: old well information as follows:
Operator: _____
Well Name: _____
Original Completion Date: _____ Original Total Depth: _____

Depth to bottom of fresh water: 500
Depth to bottom of usable water: 580
Surface Pipe by Alternate: 1 2 600' MIN

Directional, Deviated or Horizontal wellbore? Yes No
If yes, true vertical depth: _____
Bottom Hole Location _____
KCC DKT # _____

Length of Surface Pipe Planned to be set: _____
Length of Conductor pipe required: NONE
Projected Total Depth: 3200' explor only/PBTD 2950'

*** SEE ATTACHED
PANDMA LETTER**

**RECEIVED
JAN 24 2005
KCC WICHITA**

Formation at Total Depth: CHASE
Water Source for Drilling Operations:
Well Farm Pond Other

DWR Permit #: _____
(Note: Apply for Permit with DWR)
Will Cores Be Taken?: Yes No

AFFIDAVIT

The undersigned hereby affirms that the drilling, completion and eventual plugging of this well will comply with K.S.A. 55- 101 et, seq. It is agreed that the following minimum requirements will be met:

1. Notify the appropriate district office **prior** to spudding of well;
2. A copy of the approved notice of intent to drill **shall be** posted on each drilling rig;
3. The minimum amount of surface pipe as specified below **shall be set** by circulating cement to the top; in all cases surface pipe **shall be set** through all unconsolidated materials plus a minimum of 20 feet into the underlying formation;
4. If the well is dry hole, an agreement between the operator and the district office on plug length and placement is **necessary prior to plugging**;
5. The appropriate district office will be notified before well is either plugged or production casing is cemented in;
6. If an ALTERNATE II COMPLETION, production pipe shall be cemented from below any usable water to surface within **120 days** of spud date. Or pursuant to Appendix "B" - Eastern Kansas surface casing order #133,891-C, which applies to the KCC District 3 area, alternate II cementing must be completed within 30 days of the spud date or the well shall be plugged. **In all cases, NOTIFY district office** prior to any cementing.

I hereby certify that the statements made herein are true and to the best of my knowledge and belief.

Date: January 12, 2005 Signature of Operator or Agent: Linda's Kelly Title: ENGINEERING TECH

For KCC Use ONLY
 API # 15- 007-21603-00-00
 Conductor pipe required NONE feet
 Minimum surface pipe required 600 feet per Alt 1
 Approved by: RSP 1-24-2005
 This authorization expires: 7-24-2005
 (This authorization void if drilling not started within 6 months of effective date.)
 Spud date: _____ Agent: _____

Remember to:

- File Drill Pit Application (form CDP-1) with Intent to Drill;
- File Completion Form ACO-1 within 120 days of spud date;
- File acreage attribution plat according to field proration orders;
- Notify appropriate district office 48 hours prior to workover or re-entry;
- Submit plugging report (CP-4) after plugging is completed;
- Obtain written approval before disposing or injecting salt water.
- If permit has expired (See: authorized expiration date) please check the box below and return to the address below

Well Not Drilled - Permit Expired
 Signature of Operator or Agent: _____
 Date: _____

36
30
383

IN ALL CASES PLOT THE INTENDED WELL ON THE PLAT BELOW

Plat of acreage attributable to a well in a prorated or spaced field

If the intended well is in a prorated or spaced field, please fully complete this side of the form. If the intended well is in a prorated or spaced field complete the plat below showing that the well will be properly located in relationship to other wells producing from the common source of supply. Please show all the wells within 1 mile of the boundaries of the proposed acreage attribution unit for gas wells and within 1/2 mile of the boundaries of the proposed acreage attribution unit for oil wells.

API No. 15- _____
 Operator PIONEER NATURAL RESOURCES
 Lease JARVIS
 Well Number 4-36R
 Field HUGOTON

Location of Well: County: GRANT
 _____ 1250 feet from N / S Line of Section
 _____ 1250 feet from E / W Line of Section
 Sec 36 Twp 30 S. R. 38W East West

Number of Acres attributable to well: 640
 QTR/QTR/QTR of acreage: NW/4 - SE/4 - SE/4

Is Section Regular or Irregular
If Section is irregular, locate well from nearest corner boundary.
 Section corner used: NE NW SE SW

PLAT

*(Show location of the well and shade attributable acreage for prorated or spaced wells.)
 (Show footage to nearest lease or unit boundary line)*

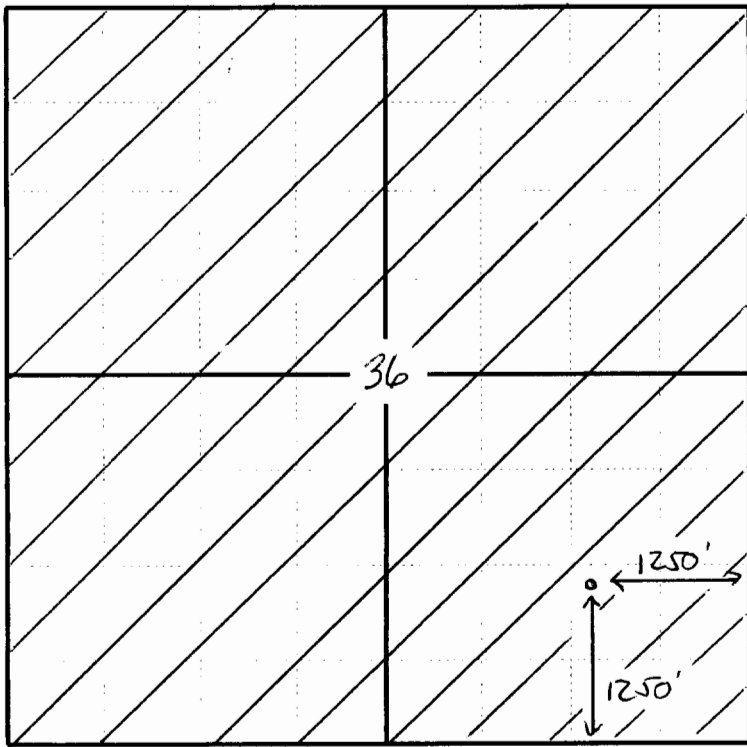

GRANT CO.

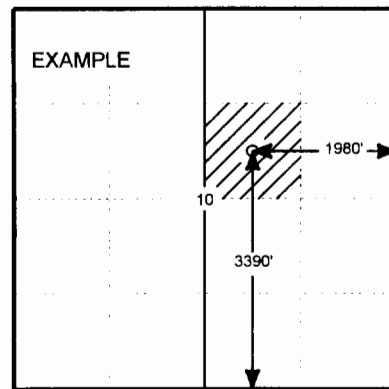

SEWARD CO.

In plotting the proposed location of the well, you must show;

1. The manner in which you are using the depicted plat by identifying section lines, i.e. 1 section, 1 section with 8 surrounding sections, 4 sections, etc.;
2. The distance of the proposed drilling location from the section's south/north and east/west; and 3.
3. The distance to the nearest lease or unit boundary line.
4. If proposed location is located within a prorated or spaced field a certificate of acreage attribution plat must be attached: (CO-7 for oil wells; CG-8 for gas wells).