

For KCC Use:

Effective Date: 1-17-2004

District # _____

SGA? Yes No

KANSAS CORPORATION COMMISSION OIL & GAS CONSERVATION DIVISION NOTICE OF INTENT TO DRILL

Must be approved by KCC five (5) days prior to commencing well

Form C-1

December 2002

Form must be Typed

Form must be Signed

All blanks must be Filled

Expected Spud Date January 26, 2005
month day year

OPERATOR: License# 5056 (6.30.2005)

Name: F.G. Holl Company, L.L.C.

Address: 9431 E. Central, Suite #100

City/State/Zip: Wichita, Kansas 67206-2543

Contact Person: Franklin R. Greenbaum

Phone: (316) 684-8481

CONTRACTOR: License# 5142 (6.30.2005)

Name: Sterling Drilling Company, Rig #1

Well Drilled For:		Well Class:	Type Equipment:
<input checked="" type="checkbox"/> Oil	<input type="checkbox"/> Enh Rec	<input type="checkbox"/> Infield	<input checked="" type="checkbox"/> Mud Rotary
<input checked="" type="checkbox"/> Gas	<input type="checkbox"/> Storage	<input type="checkbox"/> Pool Ext.	<input type="checkbox"/> Air Rotary
<input type="checkbox"/> OWD	<input type="checkbox"/> Disposal	<input checked="" type="checkbox"/> Wildcat	<input type="checkbox"/> Cable
<input type="checkbox"/> Seismic; # of Holes _____	<input type="checkbox"/> Other _____		
<input type="checkbox"/> Other _____			

If OWWO: old well information as follows:

Operator: _____

Well Name: _____

Original Completion Date: _____ Original Total Depth: _____

Directional, Deviated or Horizontal wellbore? Yes No

if Yes, true vertical depth: _____

Bottom Hole Location: _____

KCC DKT #: _____

Spot 150' S. of
SE NE SW Sec. 26 Twp. 21 S. R. 15
 East
 West

1500 feet from N / S Line of Section
2310 feet from E / W Line of Section

Is SECTION Regular Irregular?

(Note: Locate well on the Section Plat on reverse side)

County: Pawnee

Lease Name: SCHARTZ Well #: 1-26

Field Name: Wildcat

Is this a Prorated / Spaced Field? Yes No

Target Information(s): Arbuckle

Nearest Lease or unit boundary: 330'

Ground Surface Elevation: 1964 Est. feet MSL

Water well within one-quarter mile: Yes No

Public water supply well within one mile: Yes No

Depth to bottom of fresh water: 240'

Depth to bottom of usable water: 280'

Surface Pipe by Alternate: 1 2

Length of Surface Pipe Planned to be set: 800'

Length of Conductor Pipe required: NONE

Projected Total Depth: 3950

Formation at Total Depth: Arbuckle

Water Source for Drilling Operations: JAN 12 2005

Well Farm Pond Other

DWR Permit #: KCC WICHITA (Contractor will apply)

(Note: Apply for Permit with DWR)

Will Cores be taken? Yes No

If Yes, proposed zone: _____

AFFIDAVIT

The undersigned hereby affirms that the drilling, completion and eventual plugging of this well will comply with K.S.A. 55 et. seq.

It is agreed that the following minimum requirements will be met:

1. Notify the appropriate district office **prior** to spudding of well;
2. A copy of the approved notice of intent to drill **shall be** posted on each drilling rig;
3. The minimum amount of surface pipe as specified below **shall be set** by circulating cement to the top; in all cases surface pipe **shall be set** through all unconsolidated materials plus a minimum of 20 feet into the underlying formation.
4. If the well is dry hole, an agreement between the operator and the district office on plug length and placement is necessary **prior to plugging**;
5. The appropriate district office will be notified before well is either plugged or production casing is cemented in;
6. If an ALTERNATE II COMPLETION, production pipe shall be cemented from below any usable water to surface within **120 days** of spud date. Or pursuant to Appendix "B" - Eastern Kansas surface casing order #133,891-C, which applies to the KCC District 3 area, alternate II cementing must be completed within 30 days of the spud date or the well shall be plugged. **In all cases, NOTIFY district office** prior to any cementing.

I hereby certify that the statements made herein are true and to the best of my knowledge and belief.

Date: 01/10/2004 Signature of Operator or Agent: Franklin R. Greenbaum Title: Exploration Manager

For KCC Use ONLY

API # 15 - 145-21510-0000

Conductor pipe required NONE feet

Minimum surface pipe required 300 feet per Alt. (1)

Approved by RJP 1-12-2005

This authorization expires: 7-12-2005
(This authorization void if drilling not started within 6 months of effective date.)

Spud date: _____ Agent: _____

- Remember to:**
- File Drill Pit Application (form CDP-1) with intent to Drill;
 - File Completion Form ACO-1 within 120 days of spud date;
 - File acreage attribution plat according to field proration orders;
 - Notify appropriate district office 48 hours prior to workover or re-entry;
 - Submit plugging report (CP-4) after plugging is completed;
 - Obtain written approval before disposing or injecting salt water.
- If this permit has expired (See: authorized expiration date) please check the box below and return to the address below.
- Well Not Drilled - Permit Expired
- Signature of Operator or Agent: _____
Date: _____

Mail to: KCC - Conservation Division, 130 S. Market - Room 2078, Wichita, Kansas 67202

26
21
15W

IN ALL CASES PLOT THE INTENDED WELL ON THE PLAT BELOW

Plat of acreage attributable to a well in a prorated or spaced field

If the intended well is in a prorated or spaced field, please fully complete this side of the form. If the intended well is in a prorated or spaced field complete the plat below showing that the well will be properly located in relationship to other wells producing from the common source of supply. Please show all the wells and within 1 mile of the boundaries of the proposed acreage attribution unit for gas wells and within 1/2 mile of the boundaries of the proposed acreage attribution unit for oil wells.

API No. 15 - 145-21510-00-00
 Operator: F.G. Holl Company, L.L.C.
 Lease: SCHARTZ
 Well Number: 1-26
 Field: Wildcat

Location of Well: County: Pawnee
1500 feet from N / S Line of Section
2310 feet from E / W Line of Section
 Sec. 26 Twp. 21 S. R. 15 East West

Number of Acres attributable to well: _____
 QTR / QTR / QTR of acreage: SE - NE - SW

Is Section: Regular or Irregular

If Section is Irregular, locate well from nearest corner boundary.

Section corner used: NE NW SE SW

PLAT

*(Show location of the well and shade attributable acreage for prorated or spaced wells.)
 (Show footage to the nearest lease or unit boundary line.)*

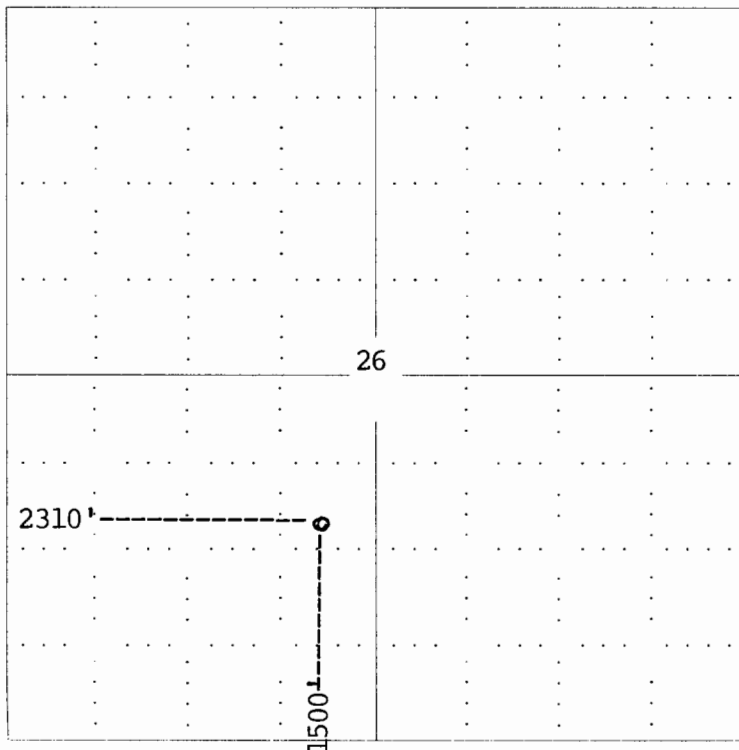

RECEIVED
 JAN 12 2013
 KCC WICHITA

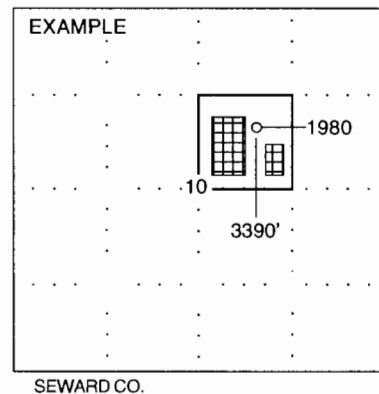

NOTE: In all cases locate the spot of the proposed drilling locaton.

In plotting the proposed location of the well, you must show:

1. The manner in which you are using the depicted plat by identifying section lines, i.e. 1 section, 1 section with 8 surrounding sections, 4 sections, etc.
2. The distance of the proposed drilling location from the section's south / north and east / west.
3. The distance to the nearest lease or unit boundary line.
4. If proposed location is located within a prorated or spaced field a certificate of acreage attribution plat must be attached: (CO-7 for oil wells; CG-8 for gas wells).

KANSAS

CORPORATION COMMISSION

KATHLEEN SEBELIUS, GOVERNOR
BRIAN J. MOLINE, CHAIR
ROBERT E. KREHBIEL, COMMISSIONER
MICHAEL C. MOFFET, COMMISSIONER

January 11, 2005

Mr. Franklin Greenbaum
F.G. Holl Company, LLC
9431 E. Central Ste 100
Wichita, KS 67206-2543

RE: Drilling Pit Application
Schartz Lease Well No. 1-26
SW/4 Sec. 26-21S-15W
Pawnee County, Kansas

Dear Mr. Greenbaum:

District staff has inspected the above referenced location and has determined that the reserve pit shall be constructed **without slots**, the bottom shall be flat and reasonably level, and the free fluids must be removed. The fluids are to be removed from the reserve pit as soon as the Hutchinson Salt section has been drilled through and displacement of the fluids into the reserve pit has occurred. The fluids should be removed again as soon as practical after drilling operations have ceased.

If production casing is set all completion fluids shall be removed on a daily basis.

The fluids should be taken to an authorized disposal well. Please call the District Office at (620) 225-8888 when the fluids have been removed. Also please file the enclosed CDP-5 form, Surface Pond Waste Transfer, within 30 days of fluid removal.

A copy of this letter should be posted in the doghouse along with the approved Intent to Drill.
If you have any questions or concerns please feel free to contact the undersigned at the above address.

Sincerely,



Kathy Haynes

Environmental Protection and Remediation Department

cc: S Durrant