

STATE OF KANSAS
STATE CORPORATION COMMISSION
CONSERVATION DIVISION
245 North Water
WICHITA, KANSAS 67202

Rev. 6-3-74
FORM CP-1

RECEIVED
STATE CORPORATION COMMISSION

JAN 05 1978
01-05-1978
CONSERVATION DIVISION
Wichita, Kansas

WELL PLUGGING APPLICATION FORM
File One Copy

API Number 15 - 039 - 20,396 00-00 (of this well)
Lease Owner Abercrombie Drilling, Inc.
Address 801 Union Center, Wichita, Kansas 67202
Lease (Farm Name) Henningsen Well No. 1
Well Location ^{200' W} NW NE Section 21 Sec. Twp. 5S Rge. (E) 30 (W)
County Decatur Total Depth 4140 Field Name
Oil Well X Gas Well Input Well SWD Well Rotary D & A
Well Log attached with this application as required Yes
Date and hour plugging is desired to begin January 9, 1978, 8:00 a.m.

PLUGGING OF THIS WELL WILL BE DONE IN ACCORDANCE WITH K.S.A. 55-128 OF THE RULES AND REGULATIONS OF THE STATE CORPORATION COMMISSION.

Name of company representative authorized to be in charge of plugging operations:

William Craig Address 702 S. 2nd, Hill City, Ks. 67642

Plugging Contractor Abercrombie Drilling, Inc. License No. 7246

Address 801 Union Center, Wichita, Kansas 67202

Invoice covering assessment for plugging this well should be sent to:

Name Abercrombie Drilling, Inc.

Address 801 Union Center, Wichita, Kansas 67202

and payment will be guaranteed by applicant or acting agent.

Signed: Jack L. Partridge
Applicant or Acting Agent
Jack L. Partridge, Ass't. Sec.-Treas.
Date: January 4, 1978

KANSAS DRILLERS LOG

API No. 15 — 039 — 20,336 - 00 - 00
 County Number

S. 21 T. 5S R. 30 XXX W

Loc. 200' W of NW NE

County Decatur

Operator
 Abercrombie Drilling, Inc.

Address
 801 Union Center, Wichita, Kansas 67202

Well No. 1 Lease Name HENNINGSSEN

Footage Location
 660 feet from (N) XX line 2180 feet from (E) XXX line

Principal Contractor Abercrombie Drilling, Inc. Geologist Charles Johnson

Spud Date May 14, 1976 Total Depth 4140' P.B.T.D.

Date Completed May 21, 1976 Oil Purchaser KOCH

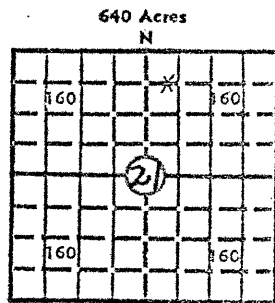

Locate well correctly
 Elev.: Gr. 2884'
 DF 2890' KB 2892'

CASING RECORD

Report of all strings set— surface, intermediate, production, etc.

Purpose of string	Size hole drilled	Size casing set (in O.D.)	Weight lbs/ft.	Setting depth	Type cement	Sacks	Type and percent additives
Surface	12 1/4"	8 5/8"	28#	207 K.B.	Sunset	160	None
Production	7 7/8"	4 1/2"	10 1/2#	4127'	50/50 Posmix	50	12 1/2# of gilsonite per sack
					Common	150	10% salt and 4# friction reducer

LINER RECORD

PERFORATION RECORD

Top, ft.	Bottom, ft.	Sacks cement	Shots per ft.	Depth interval
				4127-4140'
			8	4016-4020'

TUBING RECORD

Size	Setting depth	Packer set at	Open Hole	Depth interval
				4127-4140'
				4016-4020'

ACID, FRACTURE, SHOT, CEMENT SQUEEZE RECORD

Amount and kind of material used	Depth interval treated
2000 gal. non emulsifying	4127-4140'
500 gal. 15% non emulsifying	4016-4020'

INITIAL PRODUCTION

Date of first production 6-15-76 Producing method (flowing, pumping, gas lift, etc.) Pumping

RATE OF PRODUCTION PER 24 HOURS
 Oil 90 bbls. Gas MCF 50 Water 50 bbls. Gas-oil ratio CFPB

Disposition of gas (vented, used on lease or sold) Producing interval(s) 4127-4140'; 4016-4020'

INSTRUCTIONS: As provided in KCC Rule 82-2-125, within 90 days after completion of a well, one completed copy of this Drillers Log shall be transmitted to the State Geological Survey of Kansas, 4150 Monroe Street, Wichita, Kansas 67209. Copies of this form are available from the Conservation Division, State Corporation Commission, 3830 So. Meridian (P.O. Box 17027), Wichita, Kansas 66217. Phone AC 316-522-2206. If confidential custody is desired, please note Rule 82-2-125. Drillers Logs will be on open file in the Oil and Gas Division, State Geological Survey of Kansas, Lawrence, Kansas 66044.

Operator

Abercrombie Drilling, Inc.

DESIGNATE TYPE OF COMP.: OIL, GAS, DRY HOLE, SWDW, ETC.:

Well No.

1

Lease Name

HENNINGSEN

Oil Well

S 21 T 5S R 30~~XX~~
W

WELL LOG

Show all important zones of porosity and contents thereof; cored intervals, and all drill-stem tests, including depth interval tested, cushion used, time tool open, flowing and shut-in pressures, and recoveries.

SHOW GEOLOGICAL MARKERS, LOGS RUN, OR OTHER DESCRIPTIVE INFORMATION.

FORMATION DESCRIPTION, CONTENTS, ETC.

TOP

BOTTOM

NAME

DEPTH

Clay, Sand & Rock

0

187

Shale

187

2285

Sand

2285

2330

Shale & Sand

2330

2619

Anhydrite

2619

2658

Shale & Sand

2658

2682

Shale

2682

2910

Lime & Shale

2910

3065

Shale & Lime

3065

3595

Lime & Shale

3595

3705

Lime

3705

3819

Lime & Shale

3819

4035

Lime

4035

4140

Rotary Total Depth

4140

CONSERVATION DIVISION
Wichita, Kansas

JAN 05 1978

RECEIVED
STATE CORPORATION COMMISSION

DST #1 (4003'-4035') 30", 30", 60", 60". Strong blow. Rec. 390' gip. 1230' free oil. 36° 180' VHO & GCM, 120' oil wtr IFP 26-343#; FFP 370-595#; IBHP 1254#; FBHP 1254#.

DST #2 (4108'-4140') 30", 30", 60", 60". Fair blow. Rec. 240' gas in the pipe. 40' clean gassy oil 36°, 30' HO&GCM IFP 13-21#; FFP 26-34#; IBHP 436#; FBHP 648#.

USE ADDITIONAL SHEETS, IF NECESSARY, TO COMPLETE WELL RECORD.

Date Received

Jerry A. Langrehr
Signature

Jerry A. Langrehr, Executive Vice President

Title

June 2, 1976

Date

State of Kansas



15-039-20336-00-00

State Corporation Commission

CONSERVATION DIVISION

(Oil, Gas and Water)
245 North Water
WICHITA, KANSAS 67202

January 5, 1978

WELL PLUGGING AUTHORITY

Well No.	1
Lease	Henningsen
Description	200' W NW NE Sec. 21-5-30W
County	Decatur
Total Depth	4140
Plugging Contractor	Abercrombie Drilling, Inc.

Abercrombie Drilling, Inc.
801 Union Center
Wichita, Kansas 67202

Gentlemen:

This is your authority to plug the above subject well in accordance with the Rules and Regulations of the State Corporation Commission.

This authority is void after 90 days from the above date.

Yours very truly,

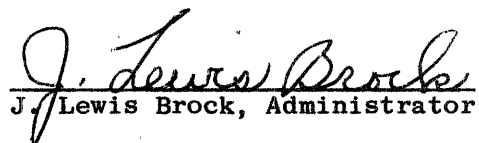
J. Lewis Brock, Administrator

Mr. Gilbert Balthazor, P.O. Box 9, Route #1, Palco, Kansas 67657
is hereby assigned to supervise the plugging of the above
named well.